

B 1 18631

SEQUENCE NO. (MDE USE ONLY)

STATE OF MARYLAND PERMIT TO DRILL WELL

STATE PERMIT NUMBER

HO-94-2910 fill in this form completely

W514687 please print or type

Date Received (APA) 12/3/00

OWNER INFORMATION

Thompson, Dale Builders 630 Woodside Court Columbia MD

LOCATION OF WELL

Howard Pindellwoods SECTION 44 46 LOT 27 NEAREST TOWN Fulton MILES FROM TOWN 3

DRILLER INFORMATION

Ralph Mayne M S D 117 Ralph Mayne Well Drilling 17024 Hardy RD. Mt. Airy, MD

DIRECTION OF WELL FROM TOWN

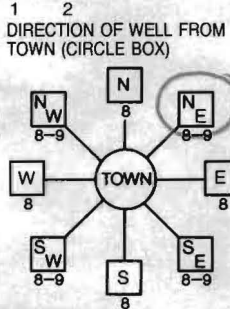

meandering stream near what road

ON WHICH SIDE OF ROAD DISTANCE FROM ROAD ENTER FT OR MI

WELL INFORMATION APPROX. PUMPING RATE 5 AVERAGE DAILY QUANTITY NEEDED 500

NOT TO BE FILLED IN BY DRILLER HEALTH DEPARTMENT APPROVAL

Howard 13 COUNTY NAME COUNTY NO. STATE SIGNATURE DATE ISSUED 01/08/01

- USE FOR WATER (CIRCLE APPROPRIATE BOX) DOMESTIC POTABLE SUPPLY & RESIDENTIAL IRRIGATION

APPROXIMATE DEPTH OF WELL 150 FEET APPROXIMATE DIAMETER OF WELL 6" NEAREST INCH

SHOW MAJOR FEATURES OF BOX & LOCATE WELL WITH AN X SOURCES OF DRILLING WATER 1. well No insp. A

METHOD OF DRILLING (circle one)

AIR-ROTary JETTED ROTARY (Hydraulic Rotary) CABLE REVERSE-ROTary DRIVE-POINT

REPLACEMENT OR DEEPEMED WELLS (CIRCLE APPROPRIATE BOX)

- THIS WELL WILL NOT REPLACE AN EXISTING WELL THIS WELL WILL REPLACE A WELL THAT WILL BE ABANDONED AND SEALED

DRAW A SKETCH BELOW SHOWING LOCATION OF WELL IN RELATION TO NEARBY TOWNS AND ROADS AND GIVE DISTANCE FROM WELL TO NEAREST ROAD JUNCTION

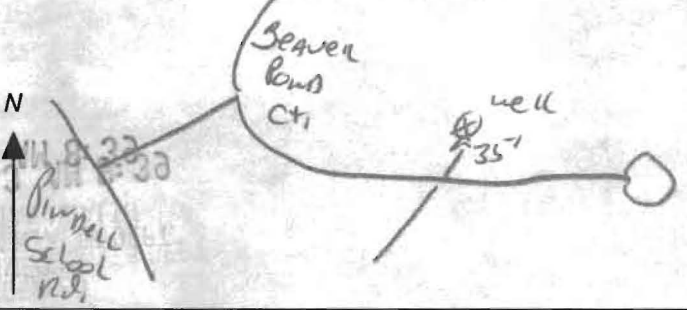

PERMIT NUMBER OF WELL TO BE REPLACED OR DEEPEMED (IF AVAILABLE)

Not to be filled in by driller (MDE OR COUNTY USE ONLY) APPROP. PERMIT NUMBER 16000 G A P 012 (01) PERMIT No. HO-94-2910

SPECIAL CONDITIONS

NOTE - APPROVING AUTHORITIES SHOULD USE SEPARATE SHEET IF NEEDED -

9/24/02
Anytime

HOWARD COUNTY HEALTH DEPARTMENT
BUREAU OF ENVIRONMENTAL HEALTH
WATER AND SEWERAGE PROGRAM
TEL: (410)313-2640 FAX: (410)313-2648

Information Form for the Installation of the Well Pump, Pitless Adapter, and Supply Piping

NOTE: The installer is responsible for requesting an inspection prior to 9 am on the day of the desired inspection. No work is to be covered until approved by the Health Department. All installations must comply with the National Standard Plumbing Code (NSPC, as amended locally) and COMAR 26.04.04 (MD Well Construction Regulations). Submission of a complete form is required prior to Use and Occupancy approval.

Company Name: CHARLES A. KLEIN & SON, INC. Telephone #: (410) 549-6960
Address: 5220 KLEIN MILL ROAD
SPRINGVILLE, MD 21784

(Must circle one) Licensed Plumber Licensed Well Driller Licensed Well Pump Installer
License # and name of individual responsible for the field installation:
Name (Print): CHARLES A. KLEIN, JR. License #: 6521

*A licensed individual must perform the actual installation. Apprentices must be under the direct supervision of a licensed journeyman or master plumber, pump installer or well driller. Licenses may be subjected to field verification.

Name of Property Owner: Dale Thompson Telephone #: (410) 995-6731
Subdivision: PINDELL WOODS Lot #: 27 Well Tag #: HO-94-2910 ✓
Site Address: 2013 MEANDERING STREAM WAY
FULTON, MD 20759

Submersible Pump Data Pitless Adapter Well Cap and Electric Conduit
Make: Jacuzzi Make: Harvard Two piece watertight cap: ✓
Model #: 5345-13P-52 Model #: PT-800 Screened, vented well cap: ✓
Pump Capacity: 5 GPM Depth: 42" (36" min) Cap secured to casing: ✓
Well Yield: 2.5 GPM NSF approved: Conduit min 1 1/2" B.G.: ✓
Depth of well encountered at time of pump installation: 210 feet Conduit secured to well cap: ✓
If pump capacity exceeds well yield, a low water cut off switch is required by NSPC 1990 Section 17.8.4
Torque arrestors or Cable guards are required - Must circle one
Safety rope, if used, attached to inside of well casing with eye bolt:

Piping to house House Connection
Type: polyethylene PVC sleeved to undisturbed soil at wall penetration: Yes
PSI: 1/2" (150 psi min) Approximate length of sleeve:
Depth of supply line: (36" min) Sleeve caulked and sealed properly: ✓

The water supply line is required to be at least ten feet from the septic tank, pump chamber, sewage piping, distribution box, drainfields, and sewage reserve area. If this cannot be accomplished, contact this office for approval prior to installation.

Signature of company representative responsible for installation: Charles A. Klein, Jr. date: 9/24/02
CHARLES A. KLEIN, JR.

For Health Department Use Only - Not to be completed by Installer

Date Insp. Requested: Date Insp. Approved: 9/24/02 (SO)
Inspection Data: Pitless adapter and water supply line at least 36" below grade
Two piece cap installed and attached to casing securely
Elec. conduit extends at least 18" below grade/attached to cap properly
Safety rope installed inside of well casing
Correct well tag attached properly and casing 8" above finished grade
Water supply line sleeved adequately at house connection
Adequate grout observed below pitless adapter

2/3/03 tag replaced (SO)