

4/14/71

PERMIT

P 15844

A 09294

SEWAGE DISPOSAL SYSTEM

MARYLAND STATE DEPARTMENT OF HEALTH

HOWARD COUNTY

ELLICOTT CITY

INDEXED

DISTRICT 5

DATE 4-12-71

Souder Builders, Inc. IS PERMITTED TO INSTALL X ALTER

ADDRESS RD #2, Dayton, Md. PHONE 286-3408

A SEWAGE DISPOSAL-SYSTEM LOCATED AT _____

SUBDIVISION CLARKSVILLE RIDGE ROAD Maiden Lane LOT 35, Sec. 3

PROPERTY OWNER Michael Chicioluo

ADDRESS Maiden Lane, Clarksville, Md. 21029

SPECIFICATIONS 3 - Bedrooms

DRAIN FIELD _____ DEPTH _____ FEET, BOTTOM AREA _____ SQ. FT.

SEEPAGE PITS _____ ABSORBENT SIDE-WALL AREA _____ SQ. FT.

SEPTIC TANK CAPACITY 1000 GALLONS

FOR GARBAGE GRINDER, INCREASE DISPOSAL AREA 22% & TANK CAPACITY 50%.

OTHER Dry Well - 300 sq. ft. absorbent sidewall area below inlet pipe. Locate Drywell 134 ft. from front lot line and 39 ft. from right side line as lot is seen when facing it from Maiden Lane. Dry well Maximum depth 13 ft. *John 4/15/71*

PERMIT VOID AFTER THREE YEARS.

NOTE: ALL PIPE FROM HOUSE TO TANK MUST BE CAST IRON.

PLANS APPROVED BY F. F. Fletcher DATE 11-5-64

FILL SEPTIC TANK AND DISTRIBUTION BOX WITH WATER BEFORE CALLING FOR AN INSPECTION. COVER NO WORK UNTIL INSPECTED AND APPROVED.

NEITHER THE HOWARD COUNTY COMMISSIONERS NOR THE HEALTH DEPARTMENT IS RESPONSIBLE FOR THE SUCCESSFUL OPERATION OF ANY SYSTEM.

A 09294

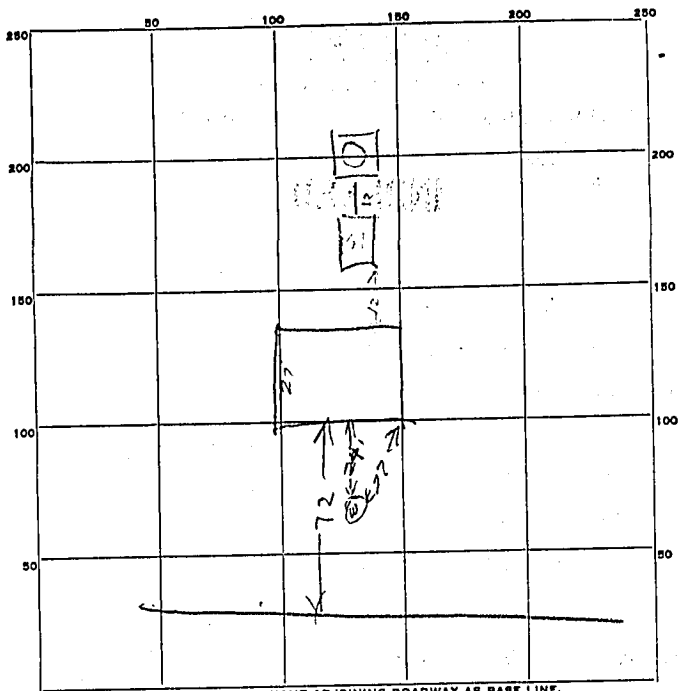

INDICATE NORTH. - NAME ADJOINING ROADWAY AS BASE LINE.

72
77
12
10
121

PERMIT CARD _____

SEPTIC TANK, LEVEL OK-1000

CLEANOUTS _____

60 13
0
51

DISTRIBUTION BOX, LEVEL _____

TILE FIELD, DEPTH _____ FT. TRENCH WIDTH _____ FT.

GRAVEL DEPTH _____ IN. TOTAL LENGTH _____ FT.

52 22
118 9
213

NUMBER OF TRENCHES _____ TOTAL BOTTOM AREA _____

SEEPAGE PITS, INSIDE DIAMETER 9 FT. DEPTH BELOW INLET 9 FT.

412
9
389

ABSORBENT AREA 489 SQ. FT. not counting stone
counting stone

REMARKS 1 1 71 - Dry Well 1, set in 2 FT. below ground

Perimeter of Dry Well is 52 FT
Water Well not installed

DATE SYSTEM APPROVED _____

INSPECTOR _____

9/14/71 Raymond Fudge