

4-13' holes
on 10,000 sq. ft.
Preliminary

APPLICATION

A 23899

SEWAGE DISPOSAL TESTING

P _____

STATE OF MARYLAND - DEPARTMENT OF HEALTH AND MENTAL HYGIENE

HOWARD COUNTY HEALTH DEPARTMENT
ENVIRONMENTAL HEALTH SERVICES
P. O. BOX 476, ELLICOTT CITY, MARYLAND 21043
TELEPHONE: 465-5000, EXT. 356

DISTRICT Third

DATE 9/9/76

TO: THE COUNTY HEALTH OFFICER
ELLICOTT CITY, MARYLAND

I, HEREBY, APPLY FOR THE NECESSARY TEST IN ORDER TO CONSTRUCT (OR RECONSTRUCT) A SEWAGE DISPOSAL SYSTEM.

PROPERTY OWNER S. Elwood Anderson
12,799 Triadelphia Road
ADDRESS Howard County, Maryland PHONE _____
Any questions call:
Boender - 465-7777

PROPERTY LOCATION:

SUBDIVISION Wayside EStates LOT NO. 9, Section 3

ROAD AND DESCRIPTION Scheel Ct.

SIZE OF LOT 40,000 sq. ft. TYPE BLDG. 3 or 4 bedroom
NUMBER OF BEDROOMS _____

IF NOT SINGLE RESIDENCE DESCRIBE _____

THE SYSTEM INSTALLED UNDER THIS APPLICATION IS ACCEPTABLE ONLY UNTIL PUBLIC FACILITIES BECOME AVAILABLE.

SIGNATURE OF APPLICANT /s/ G. Albert Scheel, Jr.

APPROVED BY Raymond Hodge FOR Drywell DATE 10/7/77
(KIND OF SYSTEM)

REJECTED BY _____ FOR _____ DATE _____
(KIND OF SYSTEM)

HOLD PENDING FURTHER TESTS _____ DATE _____

REASONS FOR REJECTION OR HOLDING _____

THIS IS NOT A PERMIT

APPLICATION

A 23899

SEWAGE DISPOSAL TESTING

P _____

STATE OF MARYLAND - DEPARTMENT OF HEALTH AND MENTAL HYGIENE

HOWARD COUNTY HEALTH DEPARTMENT
ENVIRONMENTAL HEALTH SERVICES
P. O. BOX 476, ELLICOTT CITY, MARYLAND 21043
TELEPHONE: 465-5000, EXT. 356

DISTRICT Third

DATE 9/9/76

TO: THE COUNTY HEALTH OFFICER
ELLICOTT CITY, MARYLAND

I, HEREBY, APPLY FOR THE NECESSARY TEST IN ORDER TO CONSTRUCT (OR RECONSTRUCT) A SEWAGE DISPOSAL SYSTEM.

PROPERTY OWNER S. Elwood Anderson
ADDRESS 12,799 Triadelphia Road
Howard County, Maryland PHONE Any questions call:
Roender - 465-7777

PROPERTY LOCATION:

SUBDIVISION Wayside Estates LOT NO. 9, Section 3

ROAD AND DESCRIPTION Schoel Ct.

SIZE OF LOT 40,000 sq. ft. TYPE BLDG. 5 or 4 bedroom
NUMBER OF BEDROOMS

IF NOT SINGLE RESIDENCE DESCRIBE _____

THE SYSTEM INSTALLED UNDER THIS APPLICATION IS ACCEPTABLE ONLY UNTIL PUBLIC FACILITIES BECOME AVAILABLE.

SIGNATURE OF APPLICANT /s/ G. Albert Scheel, Jr.

APPROVED BY _____ FOR _____ DATE _____
(KIND OF SYSTEM)

REJECTED BY _____ FOR _____ DATE _____
(KIND OF SYSTEM)

HOLD PENDING FURTHER TESTS _____ DATE _____

REASONS FOR REJECTION OR HOLDING _____

THIS IS NOT A PERMIT

A23898

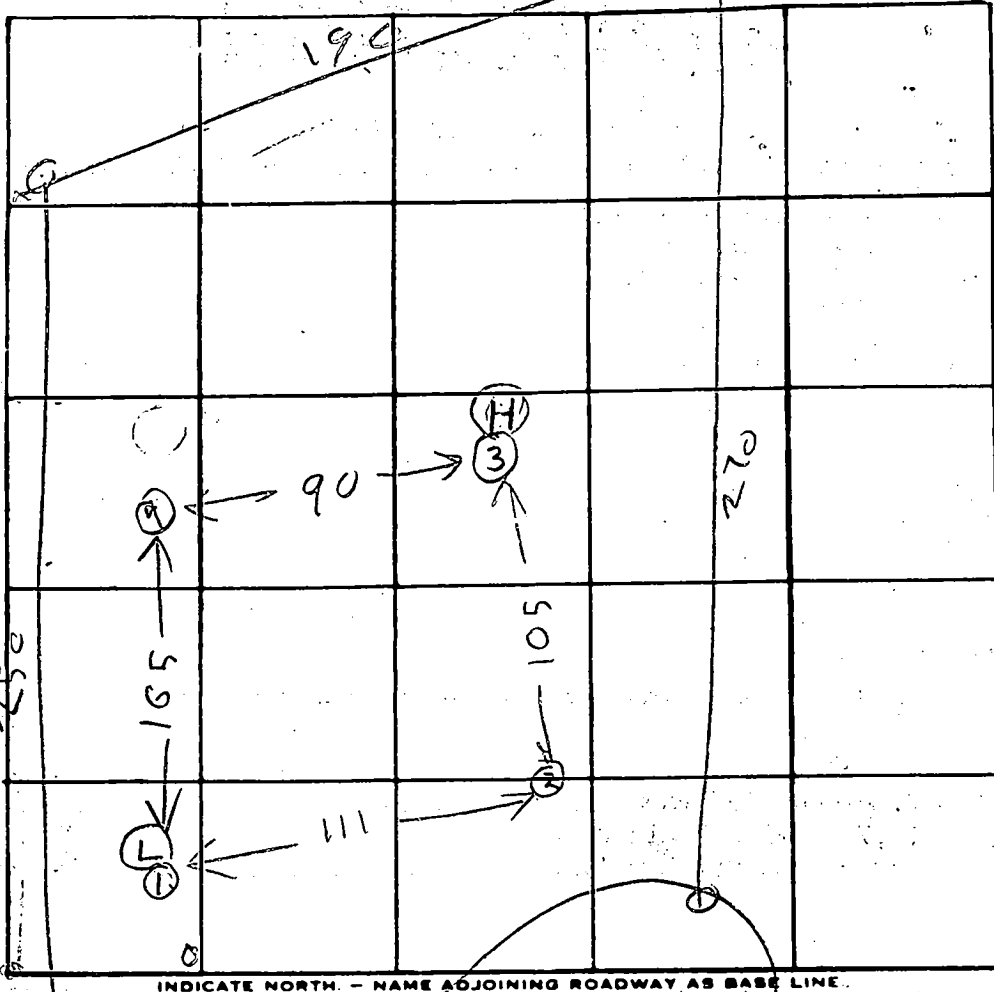

53
37
3
X 25.1
180' BR
Inv 4
Bot 8

SCHUBERT

DATE	TEST NO.	DEPTH	PRE-WET		TEST - 1" DROP		TIME	ELEVATIONS
			START	STOP	START	STOP		
9/21/76	1D	13	1045	1047	1047	1049	2	LOWEST
	1S	4	1047	1048	1048	1049	1	
	2D	13 1/2	1100	1104	1104	1116	12	MEDIUM LEVEL
	2S	5	1100	1106	1106	1116	10	
	3D	13	1109	1115	1115	1126	9	HIGHEST US FOR DW
	3S	5	1110	1111	1111	1112	1	
	4D	13 1/2	1119	1121	1121	1126	5	MEDIUM LEVEL
9/21/76	4S	4	1118	1119	1119	1121	2	

REMARKS: Max Depth 5 ft Artime 5 min

TYPE OF SOIL: _____

TESTED BY: R. Hedges ALSO PRESENT: _____

Lot 9