

Bureau of Environmental Health
 7178 Gateway Drive Columbia, MD 21046
 (410) 313-2640 Fax (410) 313-2648
 TDD (410) 313-2323 Toll Free 1-866-313-6300
 website: www.hchealth.org

Maura J. Rossman, M.D., Health Officer

RECEIPT DATE: 3/12/2013 **ONSITE SEWAGE DISPOSAL SYSTEM** P 544568

PERMIT
REPAIR

INSTALLATION APPROVAL DATE: 3/28/2013 A _____

PROPERTY ADDRESS: 3230 Jones Road, Woodbine, MD 21797

SUBDIVISION: Petty Subdivision LOT: 6 TAX ID: 04-346327

CONTRACTOR: Fogles Septic Clean Inc. EMAIL: kurt@foglesinc.com

CONTRACTOR ADDRESS: 580 Obrecht Road, Sykesville, MD 21784 PHONE: 410-795-5670

PROPERTY OWNER: Stephen Freitag EMAIL: _____

OWNER ADDRESS: 3230 Jones Road PHONE: 410-802-1024

SEPTIC TANK SIZE (GALLONS): _____

PUMP CHAMBER CAPACITY (GALLONS): _____ PUMP SIZE: _____

NUMBER OF BEDROOMS: 5 HOUSE SQ. FT. _____ APPLICATION RATE: _____

DISTRIBUTION SYSTEM: GRAVITY FED LOW PRESSURE DOSED

TRENCHES:	LINEAR FEET REQUIRED: _____	INLET DEPTH: _____
	TRENCH WIDTH: _____	MAXIMUM BOTTOM DEPTH: _____
	MINIMUM SPACE BETWEEN TRENCHES: _____	EFFECTIVE AREA BEGINNING DEPTH: _____
LOCATION:	TO BE STAKED BY SANITARIAN DURING PRE-CONSTRUCTION INSPECTION.	
NOTES:		

ISSUED BY: _____ ISSUE DATE: _____ EXPIRATION DATE: _____

- NOTE: CONTRACTOR MUST SCHEDULE A PRE-CONSTRUCTION INSPECTION PRIOR TO BEGINNING ANY INSTALLATION
- NOTE: CONTRACTOR MUST SCHEDULE AN INSPECTION AND GAIN APPROVAL OF ALL COMPONENTS PRIOR TO COVERING
- NOTE: STONE MUST BE APPROVED BY HEALTH DEPARTMENT AND GRAVEL TICKET MUST BE AVAILABLE FOR REVIEW.
- NOTE: WATERTIGHT SEPTIC TANKS REQUIRED
- NOTE: ALL PARTS OF SEPTIC SYSTEM SHALL BE AT LEAST 100 FEET DOWNGRADE FROM ANY WATER WELL
- NOTE: MANHOLE RISERS REQUIRED ON ALL SEPTIC TANKS AND PUMP CHAMBERS
- NOTE: AN ELECTRICAL PERMIT IS REQUIRED FOR INSTALLATION OF ANY ELECTRICAL COMPONENTS OF THE SYSTEM

NEITHER THE HOWARD COUNTY COUNCIL NOR THE HEALTH DEPARTMENT IS RESPONSIBLE FOR THE SUCCESSFUL OPERATION OF ANY SYSTEM.

PERMITTEE RESPONSIBLE FOR OBTAINING FINAL APPROVAL ON THIS PERMIT.

CALL 410-313-1771 TO SCHEDULE INSPECTIONS.

NOT TO SCALE

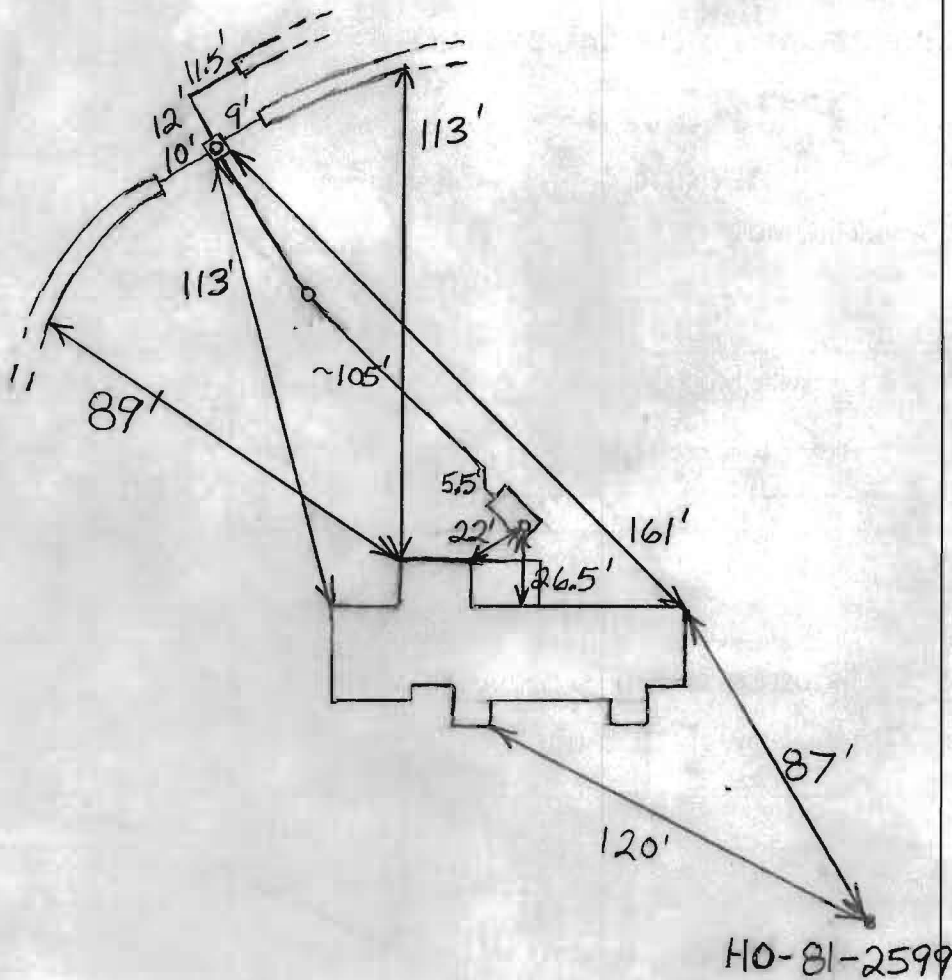

ROAD NAME

TRENCH/DRAINFIELD DATA

WIDTH	INLET	BOTTOM
_____	_____	_____

NUMBER OF TRENCHES _____

TOTAL LENGTH _____

ABSORPTION AREA _____

DISTRIBUTION BOX LEVEL Levelers

DISTRIBUTION BOX BAFFLE Yes

DISTRIBUTION BOX PORT Yes

SEPTIC TANK DATA

SEPTIC TANK 1 LEVEL _____

MANUFACTURER _____

CAPACITY _____ GAL

SEAM LOC Midseam

TANK LID DEPTH 1.5

BAFFLES Yes

BAFFLE FILTER No

MANHOLE LOC None

6" PORT LOC Front

WATERTIGHT TEST No

SLOTTED No

DATE ON LID None

~~PUMP/SEPTIC TANK LEVEL N/A~~

~~MANUFACTURER _____~~

~~CAPACITY _____ GAL~~

~~SEAM LOC _____~~

~~TANK LID DEPTH _____~~

~~BAFFLES _____~~

~~BAFFLE FILTER _____~~

~~MANHOLE LOC _____~~

~~6" PORT LOC _____~~

~~WATERTIGHT TEST _____~~

~~SLOTTED _____~~

~~DATE ON LID _____~~

PRE-CONSTRUCTION:

3/27/2013 Pipe in septic system is cheap black drain pipe and parts of it near the dist. box are clogged with roots. Trugler is going to replace all of it with proper pipe and new dist. box. (BB)

INSTALLATION:

3/28/2013 New line installed from tank to dist. box. New box installed and new lines to trenches installed, Tree removed. (BB)

FINAL INSPECTOR B. Baker

DATE OF APPROVAL 3/28/2013