

# APPLICATION

PERCOLATION TESTING

A 37983

P \_\_\_\_\_

DISTRICT 5th

DATE 21 Oct 86

HOWARD COUNTY HEALTH DEPARTMENT  
BUREAU OF ENVIRONMENTAL HEALTH  
P.O. BOX 476 ELLICOTT CITY, MARYLAND 21043  
TELEPHONE: 461-9933

*2/24/87  
prev OK'd pending  
approved plat  
(B)*

*2/24/87  
1:30 PM  
11-18-86  
11-22-86  
100-11-11-86*

TO: THE COUNTY HEALTH OFFICER  
ELLICOTT CITY, MARYLAND

I, HEREBY, APPLY FOR THE NECESSARY TEST IN ORDER TO CONSTRUCT (OR RECONSTRUCT) A SEWAGE DISPOSAL SYSTEM.

PROPERTY OWNER Marrin & Lynda Whittaker

ADDRESS 4215 Lenthicum Rd Dayton, MD 21036 PHONE 531-2178 (home)  
688-8114 work

PROSPECTIVE BUYER \_\_\_\_\_

ADDRESS \_\_\_\_\_ PHONE \_\_\_\_\_

PROPERTY LOCATION:

SUBDIVISION 4225 LOT NO. \_\_\_\_\_

ROAD AND DESCRIPTION Lenthicum Rd

TAX MAP \_\_\_\_\_ PARCEL # 1

SIZE OF LOT 5.617 acres TYPE BLDG. Single Family Dwelling  
(SINGLE FAMILY DWELLING OR COMMERCIAL)

THE SYSTEM INSTALLED UNDER THIS APPLICATION IS ACCEPTABLE ONLY UNTIL PUBLIC FACILITIES BECOME AVAILABLE. I FULLY UNDERSTAND THE FEE CONNECTED WITH THE FILING OF THIS PERC TEST APPLICATION IS NON-REFUNDABLE UNDER ANY CIRCUMSTANCES. I ALSO AGREE TO COMPLY

WITH ALL M.O.S.H.A. REQUIREMENTS IN TESTING THIS LOT. Lynda C. Whittaker  
(SIGNATURE OF APPLICANT)

APPROVED BY \_\_\_\_\_ FOR \_\_\_\_\_ BLDG. PERMIT SIGNED DATE 7/16/87  
AND RETURNED

REJECTED BY \_\_\_\_\_ FOR \_\_\_\_\_ DATE \_\_\_\_\_

HOLD PENDING FURTHER TESTS water & clean forms BP 13363 DATE \_\_\_\_\_

REASONS FOR REJECTION OR HOLDING 11/18/86 Reperc in Different areas in Wet Season B. Hodges, 2/24/87 shallow system OK'd after office review. SYSTEM MUST BE INSTALLED FIRST

# THIS IS NOT A PERMIT

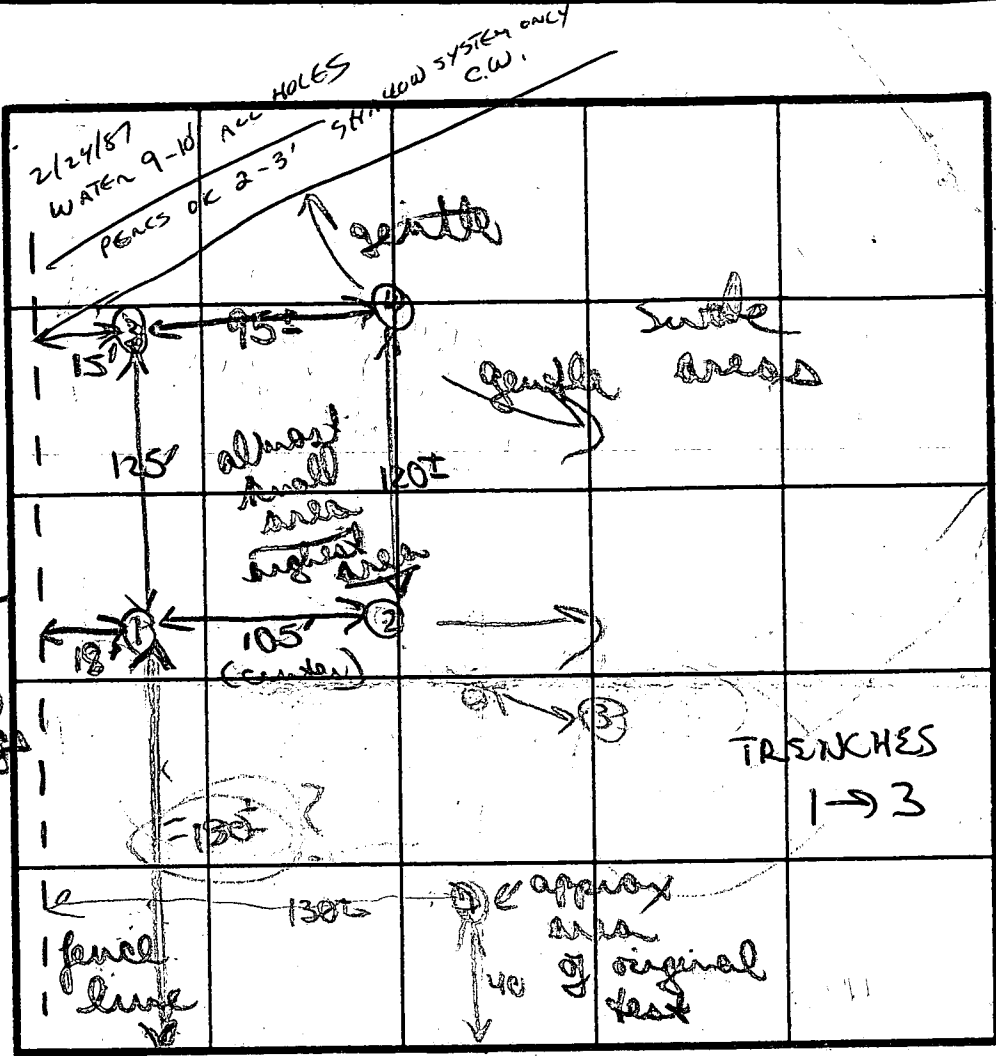

SOIL PROFILE

0'

Brown clay/silt

2 1/2'

to brown silty mica clay

10' H<sub>2</sub>O

②

Brown/clay silt clay

3'

Brown silty mica

uniform

H<sub>2</sub>O 10'

H<sub>2</sub>O

③ + 4

silty mica clay mix

getting slough

12-1079

H<sub>2</sub>O 18' 6"

TRENCHES 1 → 3

200 lb / BORM

INLET 2'

MAX D 3 1/2

SYSTEM 1ST

INDICATE NORTH - NAME ADJOINING ROADWAY AS BASE LINE.

LINTHICUM RD

DATE	TEST NO.	DEPTH	PRE-WET		TEST - 1" DROP		TIME	
			START	STOP	START	STOP		
2/24/87	①	3' S	1256	1257	1257	1259	2MIN	
		6' M	1256	1258	1258	102	4MIN	
	H <sub>2</sub> O 18' D	11' D	bottom (see profile)					
	②	3' S	1257	103	103	115	12MIN	
	H <sub>2</sub> O 10' D	11' D	bottom (see profile)					
	③	2 1/2' S	100	103	103	106	3MIN	
	H <sub>2</sub> O 10' D	11' D	bottom (see profile)					
	④	2' S	102	104	104	108	4MIN	
	H <sub>2</sub> O	11 1/2' D	bottom (see profile)					

REMARKS: H<sub>2</sub>O in all holes ≈ 10' possible shallow system phenomenon

TYPE OF SOIL: brown silty clay; to silty mica

TESTED BY: B. Nefan

ALSO PRESENT: Jack, owner, Rocky

# APPLICATION

PERCOLATION TESTING

A 37983

P \_\_\_\_\_

HOWARD COUNTY HEALTH DEPARTMENT  
BUREAU OF ENVIRONMENTAL HEALTH  
P.O. BOX 476 ELLICOTT CITY, MARYLAND 21043  
TELEPHONE: 461-9933

DISTRICT 5A

DATE 21 Oct 86

TO: THE COUNTY HEALTH OFFICER  
ELLICOTT CITY, MARYLAND

I, HEREBY, APPLY FOR THE NECESSARY TEST IN ORDER TO CONSTRUCT (OR RECONSTRUCT) A SEWAGE DISPOSAL SYSTEM.

PROPERTY OWNER Marvin & Lynda Whittaker

ADDRESS 4215 Linthicum Rd Dayton MD 21036 PHONE 531-2178 home  
688-8114 work

PROSPECTIVE BUYER \_\_\_\_\_

ADDRESS \_\_\_\_\_ PHONE \_\_\_\_\_

PROPERTY LOCATION:

SUBDIVISION \_\_\_\_\_ LOT NO. \_\_\_\_\_

ROAD AND DESCRIPTION Linthicum Rd

TAX MAP \_\_\_\_\_ PARCEL # 1

SIZE OF LOT 5.617 TYPE BLDG. Single Family Dwelling  
(SINGLE FAMILY DWELLING OR COMMERCIAL)

THE SYSTEM INSTALLED UNDER THIS APPLICATION IS ACCEPTABLE ONLY UNTIL PUBLIC FACILITIES BECOME AVAILABLE. I FULLY UNDERSTAND THE FEE CONNECTED WITH THE FILING OF THIS PERC TEST APPLICATION IS NON-REFUNDABLE UNDER ANY CIRCUMSTANCES. I ALSO AGREE TO COMPLY

WITH ALL M.O.S.H.A. REQUIREMENTS IN TESTING THIS LOT. Lynda C. Whittaker  
(SIGNATURE OF APPLICANT)

APPROVED BY \_\_\_\_\_ FOR \_\_\_\_\_ DATE \_\_\_\_\_

REJECTED BY \_\_\_\_\_ FOR \_\_\_\_\_ DATE \_\_\_\_\_

HOLD PENDING FURTHER TESTS \_\_\_\_\_ DATE \_\_\_\_\_

REASONS FOR REJECTION OR HOLDING \_\_\_\_\_

# THIS IS NOT A PERMIT

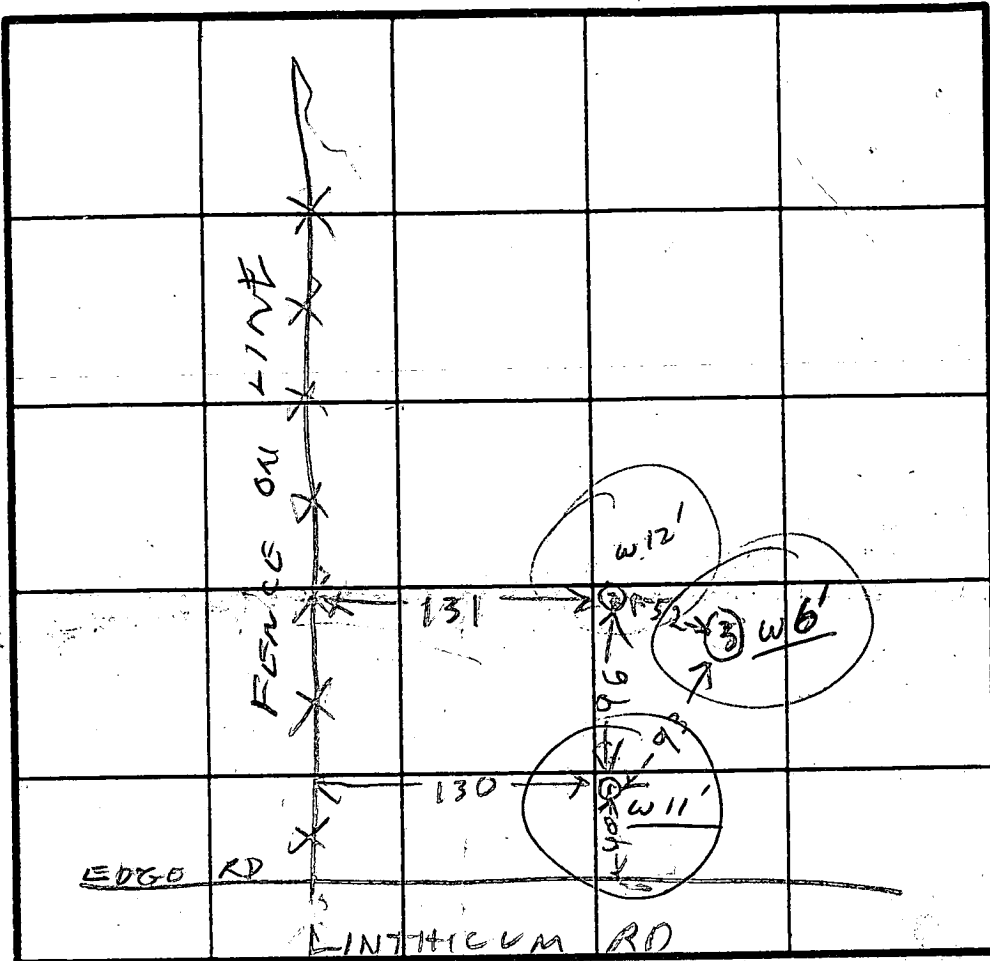
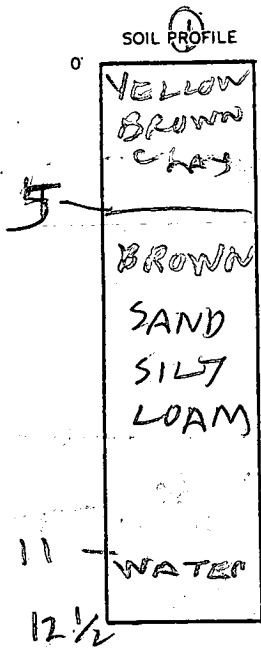

HOLE ELEVATION  
② = HIGHEST  
① = MEDIUM  
③ = LOWEST  
79  
81  
0

INDICATE NORTH - NAME ADJOINING ROADWAY AS BASE LINE.

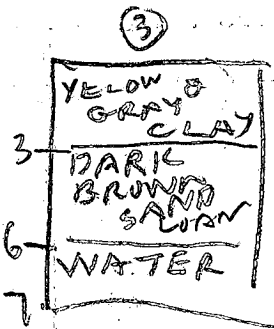
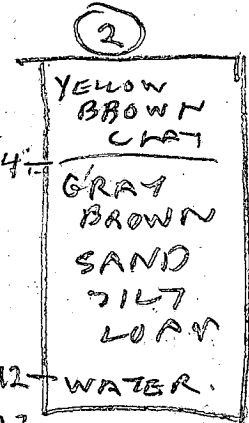

DATE	TEST NO.	DEPTH	PRE-WET		TEST - 1" DROP		TIME
			START	STOP	START	STOP	
11/28/66	1 S	5.5	1259	152	53 mm	SLOW	
	1 V	12.5	WATER	11	11		
	2 S	5	112	152	little pore	SLOW	
	2 V	13	WATER	12	12		
	3 V	7	WATER	6	6		

99  
32  
96  
93

REMARKS - BEPERC INDIFFERENT AREA IN WBT SEASON

TYPE OF SOIL \_\_\_\_\_

TESTED BY R HODGES  
 ALSO PRESENT  
 BACKHILL BOB ARMOLD  
 ANTHONY MARVIN WHITTAKER