



Building Permit Application

Howard County Maryland
Department of Inspections, Licenses and Permits
3430 Court House Drive
Permits: 410-313-2455
www.howardcountymd.gov

Date Received: _____

Permit No.: B15001702

Proposing Address: 2350 Marriottsville Rd.
 City: Marriottsville State: MD Zip Code: 21104
 Subdivision: _____
 Parcel: _____
 Map Coordinates: _____

Proposed Use: Landfill
 Estimated Construction Cost: \$ 1,000
 Description of Work: 2ea temporary construction trailers w/ no sewer or water hookup
2 - 8'x32' trailers

Occupant or Tenant: _____
 Has tenant space previously occupied? Yes No
 Contact Name: _____
 Address: _____
 City: _____ State: _____ Zip Code: _____
 Phone: _____ Fax: _____
 Email: _____

Commercial Building Characteristics	Residential Building Characteristics
Height: <u>1 story</u>	<input type="checkbox"/> SF Dwelling <input type="checkbox"/> SF Townhouse
No. of stories: _____	Depth _____ Width _____
Gross area, sq. ft./floor: <u>500</u>	1 st floor: _____
Area of construction (sq. ft.): <u>800</u>	2 nd floor: _____
Use group: _____	Basement: _____
Construction type: _____	<input type="checkbox"/> Finished Basement
<input type="checkbox"/> Reinforced Concrete	<input type="checkbox"/> Unfinished Basement
<input type="checkbox"/> Structural Steel	<input type="checkbox"/> Crawl Space
<input type="checkbox"/> Masonry	<input type="checkbox"/> Slab on Grade
<input type="checkbox"/> Wood Frame	No. of Bedrooms: _____
<input type="checkbox"/> State Certified Modular	<input type="checkbox"/> Multi-family Dwelling
	No. of efficiency units: _____
	No. of 1 BR units: _____
	No. of 2 BR units: _____
	No. of 3 BR units: _____
	Other Structure: _____
	Dimensions: _____
	Footings: _____
	Roof: _____
	<input type="checkbox"/> State Certified Modular
	<input type="checkbox"/> Manufactured Home

Property Owner's Name: HC DPW
 Address: 6751 Columbia Gateway Dr. Suite 514
 City: Columbia State: MD Zip Code: 21046
 Phone: 410-313-6370 Fax: _____
 Email: jdaunis@howardcountymd.gov

Applicant's Name & Mailing Address, (if other than stated herein)
 Applicant's Name: Corey Shea
 Address: 10330 Old Columbia Rd. Suite 102
 City: Columbia State: MD Zip Code: 21046
 Phone: 301-490-9100 Fax: _____
 Email: Corey.shea@aceservinc.com

Contractor Company: ACE Services
 Contact Person: Corey Shea
 Address: 10330 Old Columbia Rd. Suite 102
 City: Columbia State: MD Zip Code: 21046
 License No.: 13961379
 Phone: 301-490-9100 Fax: _____
 Email: Corey.shea@aceservinc.com

Engineer/Architect Company: NA
 Responsible Design Prof.: _____
 Address: _____
 City: _____ State: _____ Zip Code: _____
 Phone: _____ Fax: _____
 Email: _____

Utilities	
Water Supply	
<input type="checkbox"/> Public	
<input checked="" type="checkbox"/> Private	
Sewage Disposal	
<input type="checkbox"/> Public	
<input checked="" type="checkbox"/> Private	
Electric: <input checked="" type="checkbox"/> Yes <input type="checkbox"/> No	
Gas: <input type="checkbox"/> Yes <input checked="" type="checkbox"/> No	
Heating System	
<input checked="" type="checkbox"/> Electric <input type="checkbox"/> Oil	
<input type="checkbox"/> Natural Gas <input type="checkbox"/> Propane Gas	
<input type="checkbox"/> Other: _____	
Sprinkler System:	
<input type="checkbox"/> Yes <input checked="" type="checkbox"/> No	
Grading Permit Number: <u>No grading req'd</u>	
Building Shell Permit Number: _____	

THE UNDERSIGNED HEREBY CERTIFIES AND AGREES AS FOLLOWS: (1) THAT HE/SHE IS AUTHORIZED TO MAKE THIS APPLICATION; (2) THAT THE INFORMATION IS CORRECT; (3) THAT HE/SHE WILL COMPLY WITH ALL REGULATIONS OF HOWARD COUNTY WHICH ARE APPLICABLE THERETO; (4) THAT HE/SHE WILL PERFORM NO WORK ON THE ABOVE REFERENCED PROPERTY NOT SPECIFICALLY DESCRIBED IN HIS APPLICATION; (5) THAT HE/SHE GRANTS COUNTY OFFICIALS THE RIGHT TO ENTER ONTO THIS PROPERTY FOR THE PURPOSE OF INSPECTING THE WORK PERMITTED AND POSTING NOTICES.

Applicant's Signature: Corey Shea
 Print Name: Corey Shea
 Date: 5/7/15
 Email Address: Corey.shea@aceservinc.com
 Title/Company: ACE Services

Print Name: Corey Shea
 Date: 5/7/15
 * mail to contractor *

Checks Payable to: DIRECTOR OF FINANCE OF HOWARD COUNTY

PLEASE WRITE NEATLY & LEGIBLY
 FOR OFFICE USE ONLY

AGENCY	DATE	SIGNATURE OF APPROVAL
State Highways		
Building Officials		
PSZA (Zoning)	<u>5/15/15</u>	<u>M. Sachs</u>
PSZA (Engineering)	<u>5/15/15</u>	<u>Corey Shea</u>
Health		

DPZ SETBACK INFORMATION
Front: _____
Rear: _____
Side: _____
Side St.: _____
All minimum setbacks met? <input checked="" type="checkbox"/> Yes <input type="checkbox"/> No
Is Entrance Permit Required? <input type="checkbox"/> Yes <input checked="" type="checkbox"/> No
Historic District? <input type="checkbox"/> Yes <input checked="" type="checkbox"/> No
Lot Coverage for New Town Zone: _____
SDP/Red-line approval date: _____

Filing Fee	\$
Permit Fee	\$
Tech Fee	\$
Excise Tax	\$
PSFS	\$
Guaranty Fund	\$
Add'l per Fee	\$
Total Fees	\$
Sub- Total Paid	\$
Balance Due	\$
Check	#

Distribution of Copies: White: Building Officials Green: PSZA,Zoning Yellow: PSZA,Engineering Pink: Health Gold: SHA

Locations: Updated Forms\Building applmp 8.2012.docx

Capital Project C0317

*ACE office trailer (8'x32')

-no water/sewer hookUp

-trailer will be anchored w/driven anchors
and hurricane ties & blocked up w/cinder blocks

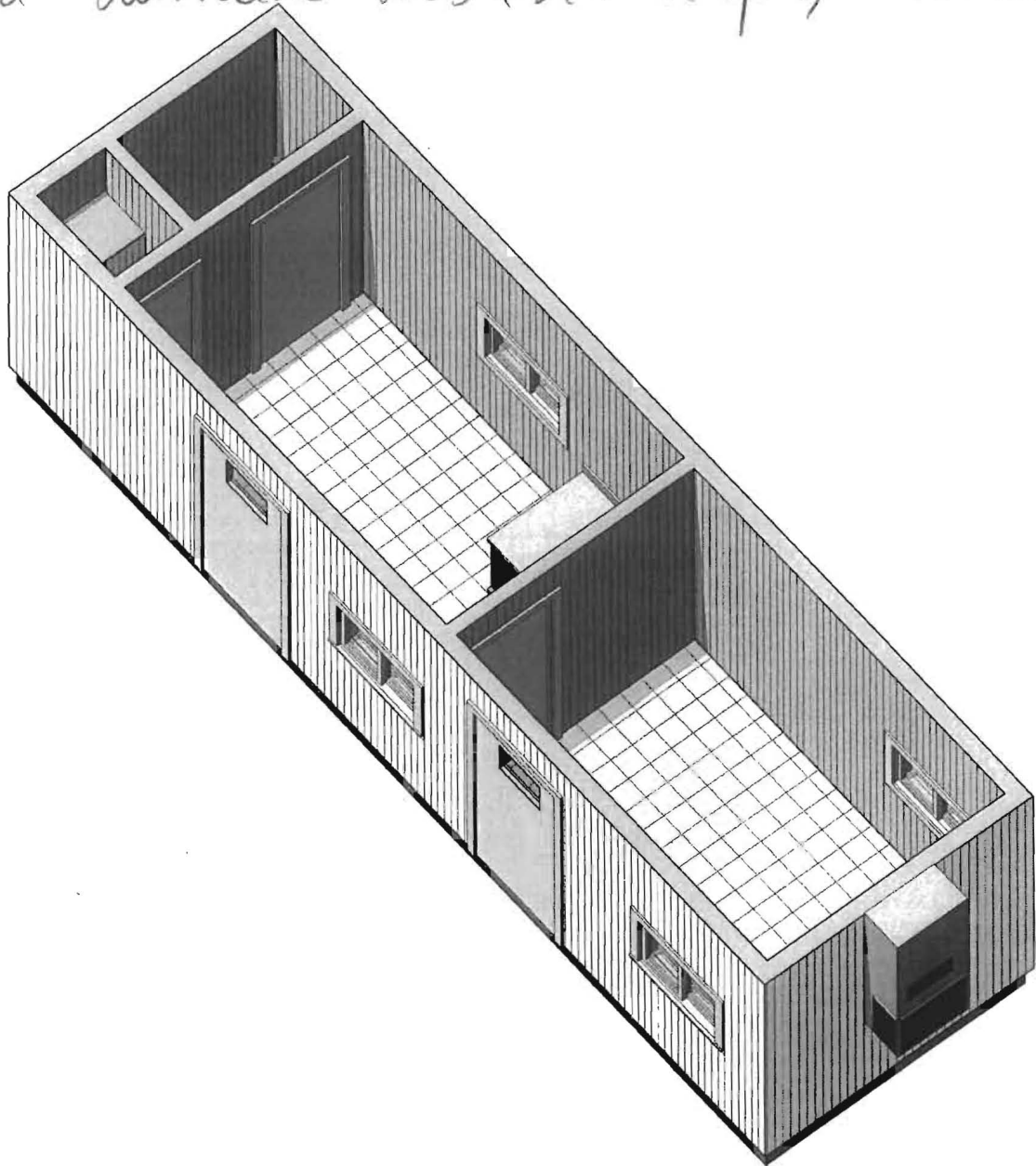

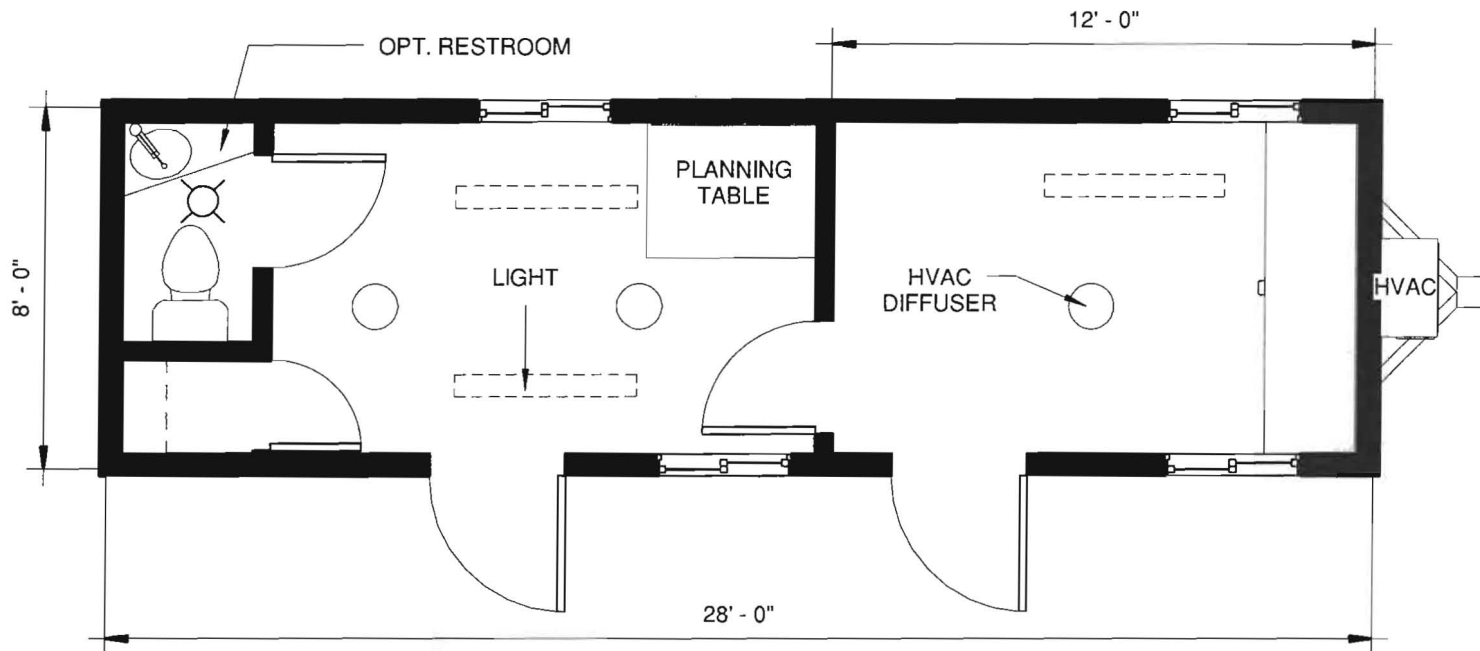

AM-832C
OFFICE TRAILER

* Engineer trailer (8' x 32')

- no water/sewer hookup
- trailer will be anchored w/ driven anchors and hurricane ties

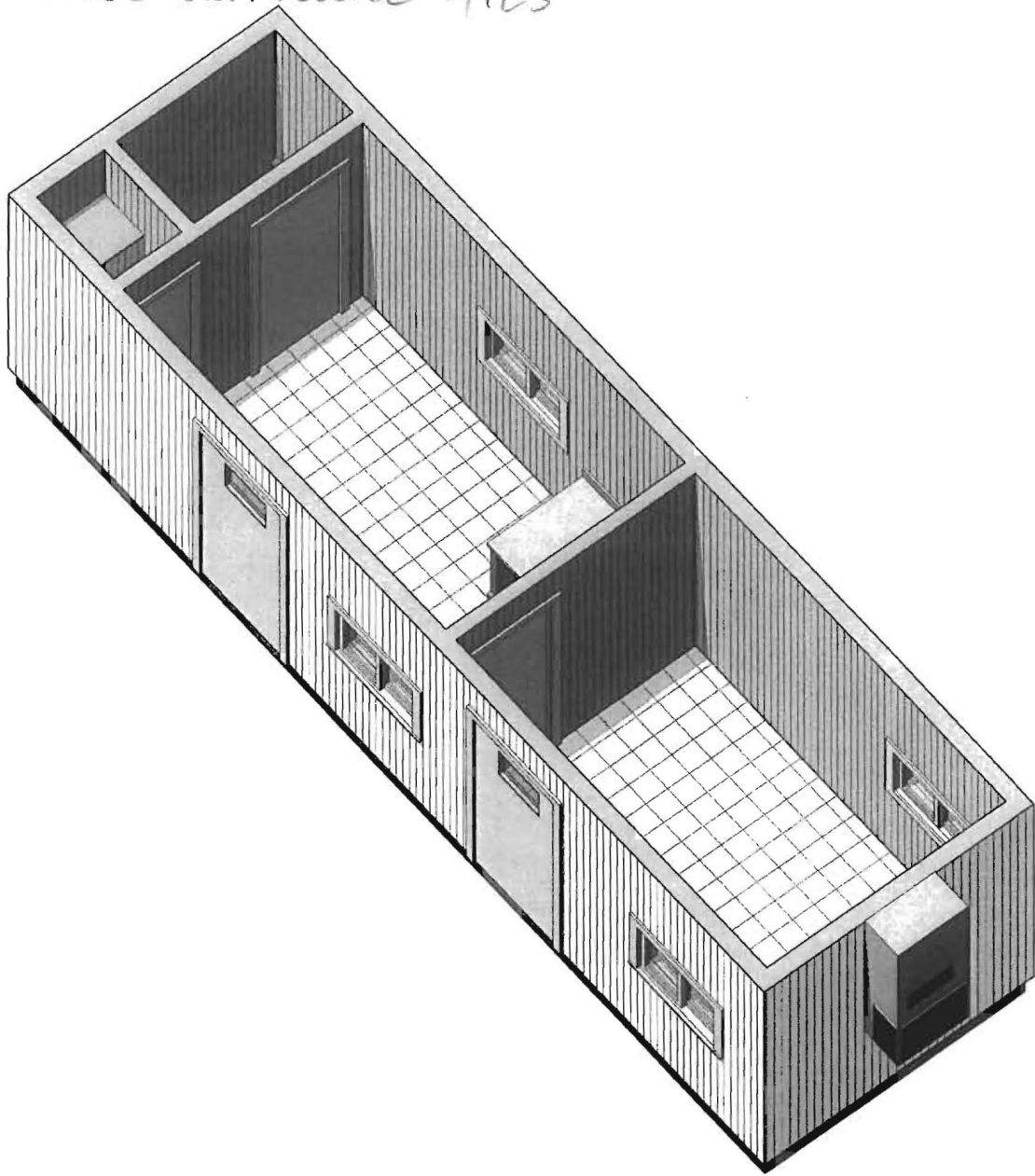

AM-832C
OFFICE TRAILER

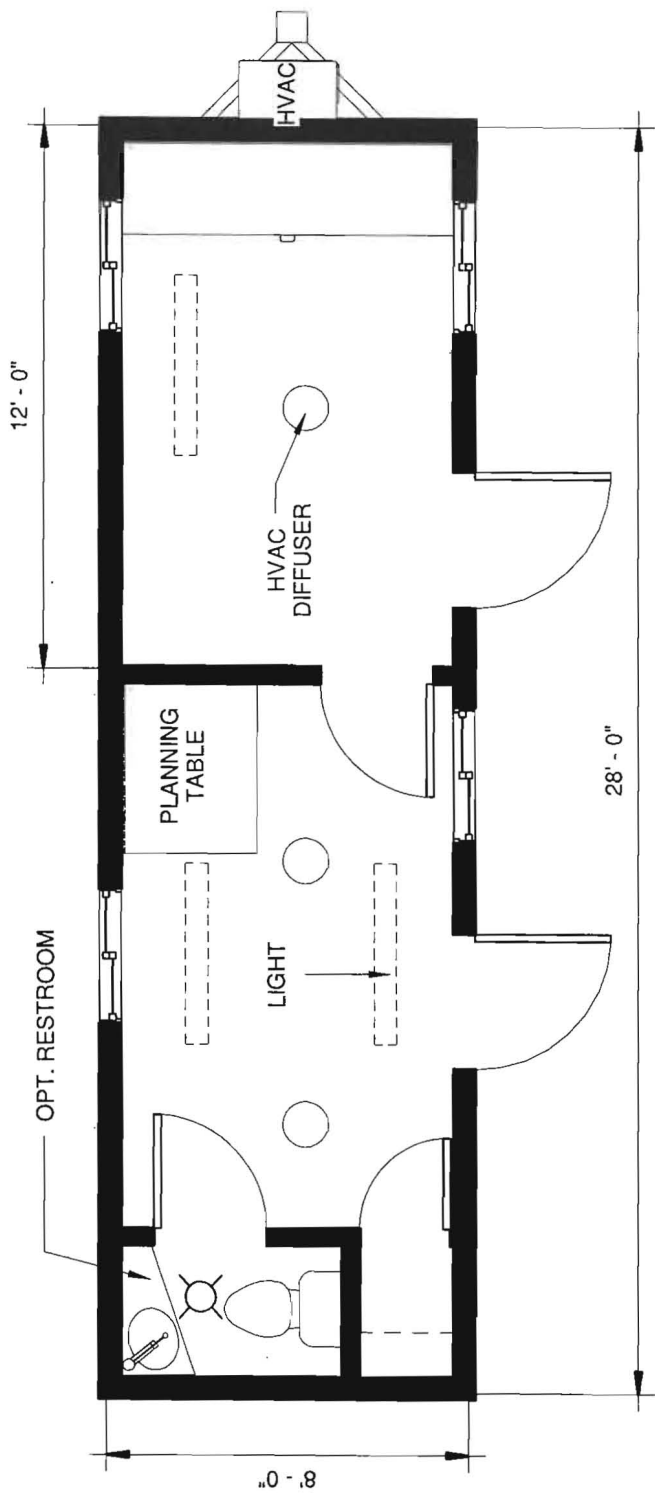

AM-832C
OFFICE TRAILER

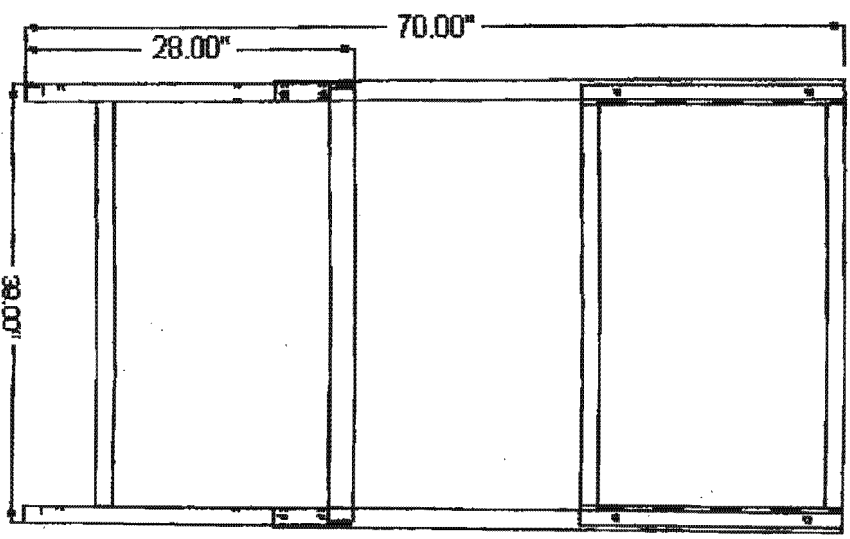
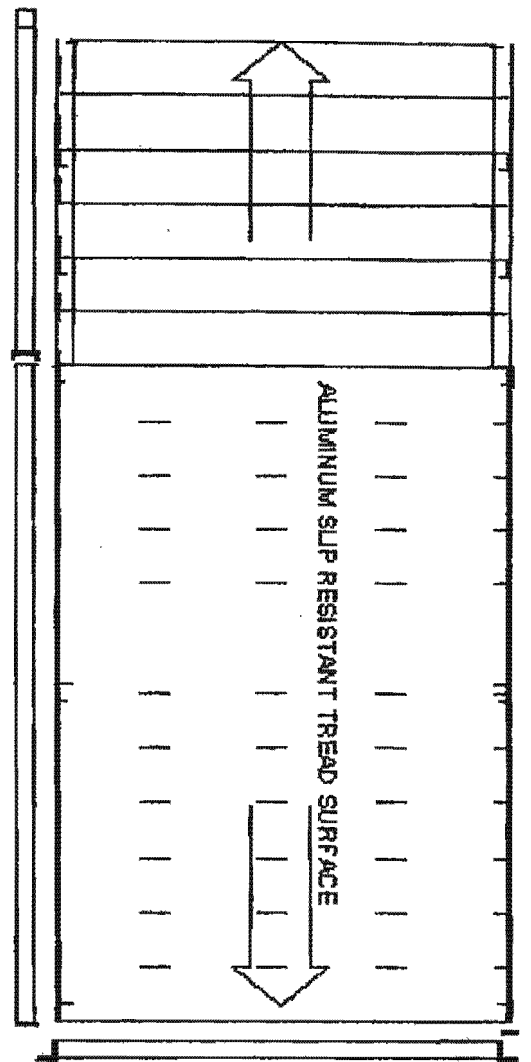
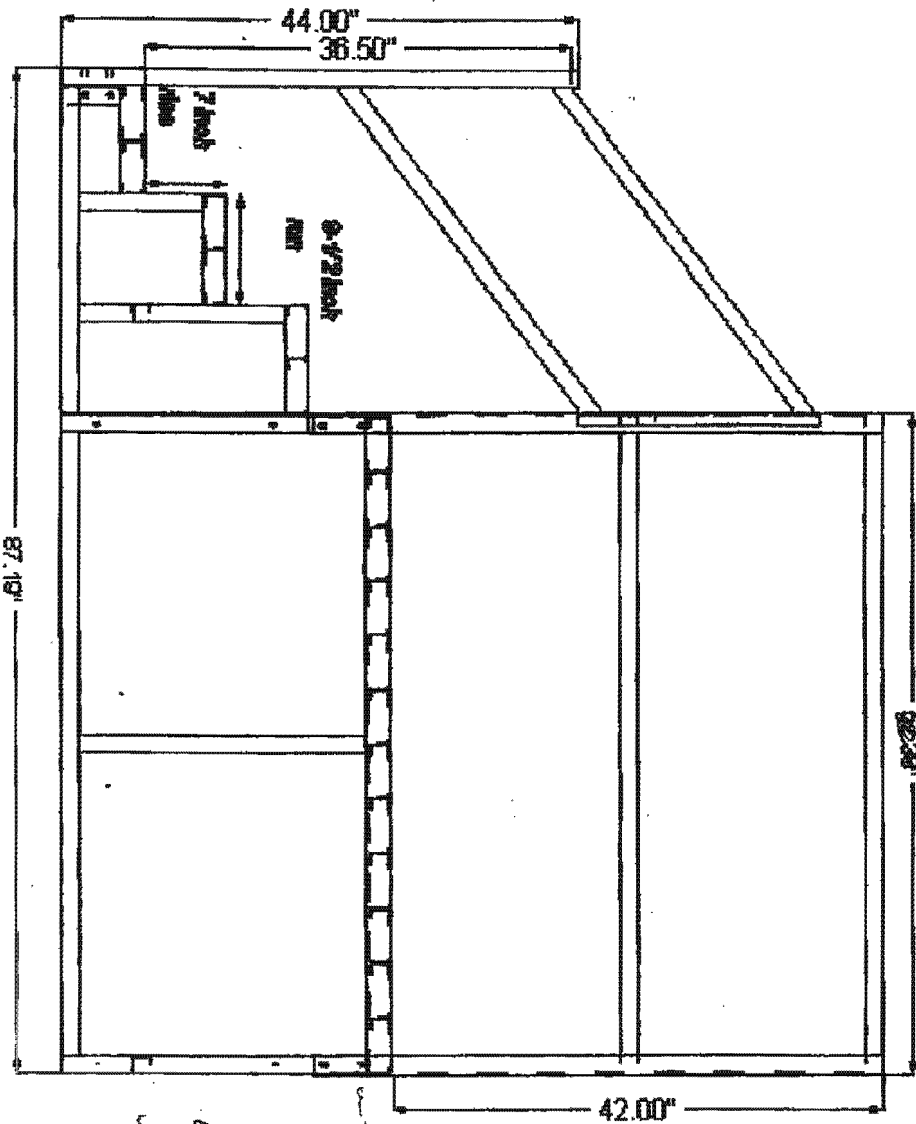

Back View

P.N.: ALB220 25' ALUMINUM STEPI/LATTO RAIL UNIT ACCUMULATOR HOIST INSULATION SYSTEM		
DATE: 01/12/2008 TIME: 10:11 AM DRAWN BY: J.S.N. CHECKED BY: M. J. H.	ALB 220 25' ALUMINUM STEPI/LATTO RAIL UNIT ACCUMULATOR HOIST INSULATION SYSTEM	

INSTALLATION INFORMATION

Anchor Installation

1. Position anchor at a slight back angle (10°) so that when fully installed, the anchor head will be inside any skirting or side wall.
2. Install anchor to +/- 2/3 depth, then install stabilizer vertically, within 3"-4" of anchor shaft, parallel to wall of home.
3. Fully drive anchor, attach strap (see proper strap tensioning), and pretension strap to pull anchor rod against the stabilizer plate.

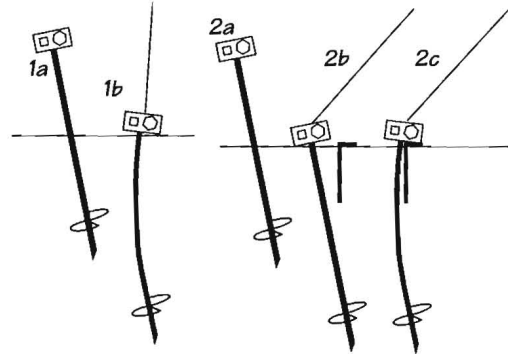

Manual Anchor Installation

1. Dig holes to a depth of 2/3 of the anchor length. Install anchor with rod or length of pipe for leverage.
2. Replace earth in hole after anchor/plate is installed at full depth. Pack dirt with a tamping rod every 6 inches of fill.
3. Testing may be required in loose soil conditions to check that anchor has proper holding power.

Important:
Anchor must be installed to full depth. Anchor head must be at ground level or at the top of the stabilizer plate which is fully installed to ground level.

Electric Drive Machine Installation

Operating Instructions:

1. Attach adapter head to shaft of the EDM motor, tighten set screw.
2. Place extension handle in the end of the EDM if needed.
3. Place anchor head into adapter, line up anchor shaft with EDM shaft, for easier installation.
4. Flip forward/reverse switch to forward.
5. Place anchor tip in location where anchor is to be buried. Hold on/off switch to install.



Adapter fits anchors and Soil Test Probe



EDM Adapter Head.



Two man operation makes easy work of anchor installation

Electric Drive Machine Cautions and Warnings:

- Before installation of any ground anchor, determine that the ground anchors to be installed will not be near any underground electrical cables, phone lines, water lines, sewer pipes, or gas lines. Failure to do so may result in serious injury or death
- The EDM is designed for operation by two people.
- Do not allow the EDM to be wedged against the home or other solid objects, when operating the EDM.
- Electrical cord must be a minimum of 14-2 wire size w/ground up to 25 ft. of cord. Longer cords must be 12-2 wire size w/ground or lower.
- Never operate the EDM in wet or rainy conditions.
- Frayed or patched electrical cords should never be used with the EDM.
- Care should be taken to keep electrical cords away from anchors.
- Never operate drive machine without the GFI power cord. Damage to motor and injury to operator can result from by passing the GFI.
- The GFI will shut off power when a ground fault is detected. The GFI will also shut off power when it detects low voltage improper amps required to drive the motor. Many times the problem will be the use of an extension cord that is too long or is too light in gage.

INSTALLATION INFORMATION

Stabilization Plates



Class 4B Stabilizer Plate
17-1/2" x 13-1/2"
Galvanized: Part # 59286



12" wide Stabilizer Plate
Black Paint: Part #59292
Galvanized: Part #59292G



ABS Stabilizer Plate
10" x 24"
Part # 59293



Quik-Set Stabilizer Plate
Black Paint: Part #59291
Galvanized: #59291G

Anchor Stabilizer

In order to prevent lateral movement of manufactured homes subjected to high wind loads and to comply with HUD's Wind Zone I, II, & III requirements, all lateral frame ties must be attached to a properly stabilized ground anchor. (Two approved methods illustrated below.)

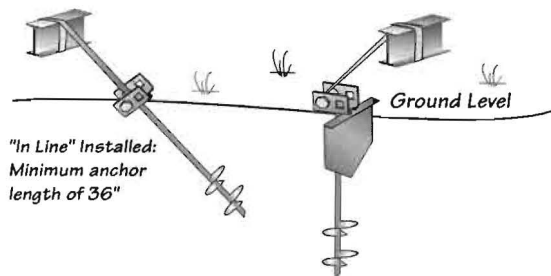

Stabilizer Plate Installation

1. Refer to any and all local, state and federal regulations.
2. Use the Soil Test Probe at the anchor location in order to match soil class with the anchor/stabilizer.. (See Page 11)
3. Partially install anchor to allow 14" to 16" remaining above ground level.
4. Utilizing oversized hammer, vertically install stabilizer plate, nesting anchor rod in between formed channels on outside of stabilizer plate (between anchor and frame).
5. Fully install anchor so that head is at the surface of the soil (1" tolerance, if necessary) and pretension anchor until touching stabilizer plate.

ABS Stabilizer Plate

Part # 59293

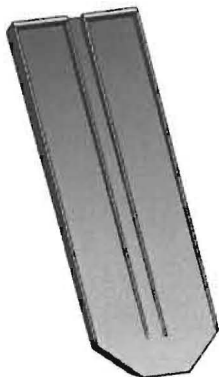

1. Determine correct anchor to be used with the home installation and use the manufacturer instruction for installation, following all safety precautions.
2. Using an electric drive machine, install anchor to a depth of approximately 28 inches at a slight back angle.
3. Dig out an 8" wide area so that the ABS stabilizer will be placed on undisturbed soil at a 10 to 15 degree angle toward the home. The bottom center of the plate should be touching the anchor rod.
4. Complete the installation of the ground anchor until the bottom of the anchor head is flush with the ground.
5. Attach proper strap and tension strap until anchor head is flush against the ABS plate and strap is tight. At this point, soil should be tamped into the vacant area behind the anchor rod, tamping approximately 6" and repeating until the vacant area is flush with the surface of the surrounding ground.

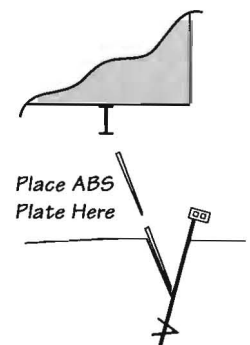

INSTALLATION INFORMATION

Quik-Set Stabilizer

Installation

Black Paint Part: #59291
Galvanized Part: #59291G

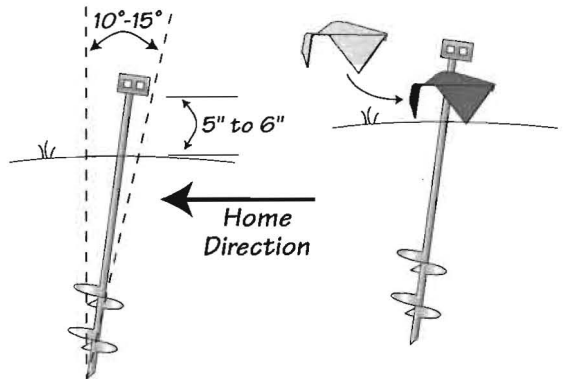

1. Install ground anchor inside skirting line at a slight back angle of 10° - 15°.
2. While anchor head is still 5" to 6" above ground level: install Quik Set stabilization plate around anchor shaft, referring to the direction imprinted on the top of the plate.
3. Install ground anchor until Quik-Set plate is fully set. Hammering may be required at the corners to insure plate being fully driven.
4. Install strap(s) to anchor head and pretension according to approved methods. Maximum anchor load in conjunction with the "Quik-Set" device is 4725 lbs. (ultimate).

Deep Set Anchor/Stabilizer Instructions

1. Confirm soil classification using standard torque probe at 36" below ground surface, make certain readings meet or exceed 350 in lbs. (Class 2 and 3 soils) at the depths of 12" & 36".
2. Clear loose vegetation where anchor will be installed. Install anchor vertically to its' full depth. Stabilizer plate at the top of anchor must be fully embedded into soil.
3. Pull strap past anchor head and cut strap so that there is 12" to 15" of strap to wrap onto anchor bolt insuring 4 to 5 wraps minimum.
4. Insert strap into anchor bolt flush with opposite side of bolt. Tighten bolt/strap until tight. Secure anchor bolt with nut.

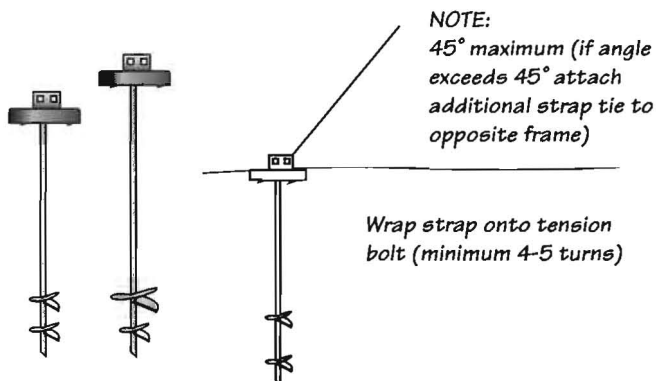

Certified Galvanized Strapping*

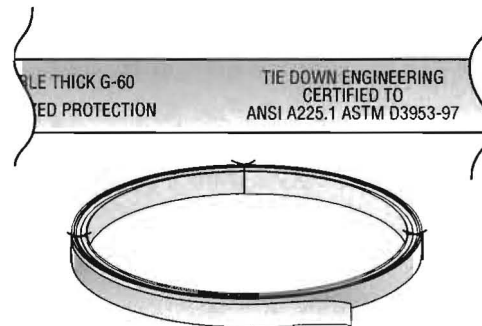

The steel strapping by Tie Down Engineering for the manufactured housing industry has been tested to, and conforms to, the HUD Code as referenced in Part 3280 of the Manufactured Home Construction and Safety Standards and Part 3285 of the installation standards; Final Rule.

3280.306(f), 3285.402(b2) Anchoring Equipment – Load Resistance. Anchoring equipment shall be capable of resisting an allowable working load equal to or exceeding 3,150 pounds and shall be capable of withstanding a 50 percent overload (4,725 pounds total) without failure of either the anchoring equipment or the attachment point on the manufactured home.

3280.306(g), 3285.402(b2) Anchoring Equipment – Weatherization. Anchoring equipment exposed to weathering shall have a resistance to weather deterioration at least equivalent to that provided by a coating of zinc on steel of not less than 0.30 ounces per square foot of surface coated, and in accordance with the following:

- (1) Slit or cut edges of zinc-coated steel strapping do not need to be zinc coated.
- (2) Type 1, Finish B, Grade 1 steel strapping, 1-1/4 inches wide and 0.035 inches in thickness, certified by a registered professional engineer or architect as conforming with ASTM Standard Specification D3953-91, Standard Specification for Strapping, Flat Steel, and Seals.

The above specification of a minimum coating of 0.30 ounces per square foot equates to a designation of "G30." Tie Down strapping exceeds this minimum requirement with a coating of 0.60 (G60) or 1.20 (G120) ounces as per above. Similarly, Tie Down strapping exceeds, in testing, the minimum load requirements of 3,150 pounds design (working) load and 4,725 pounds (ultimate) overload.

* Available with G60 or G20 galvanized coatings.



010809.d12

INSTALLATION INFORMATION

Proper Strap Tensioning

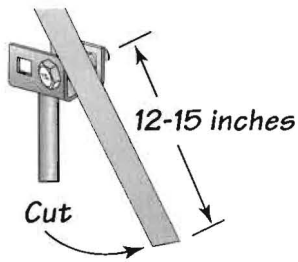

1. Insert slotted bolt into anchor head, attach loosely. Pull strap past bolt head and cut strap so that 12-15 inches of strap are available to wrap onto the slotted bolt.

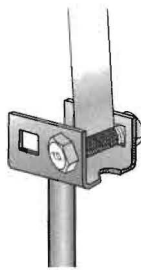

2. Insert the strap end into the slot in bolt until flush with opposite side of bolt.

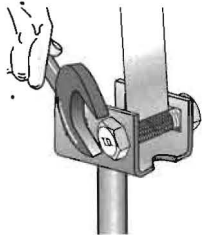

3. Using 15/16" wrench or socket, turn the bolt, winding the strap so that a minimum of four to five complete turns are made, and the strap is adequately tensioned.

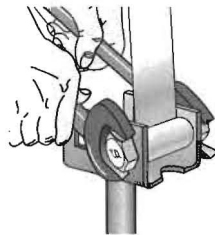

4. Hold the bolt under tension while tightening the nut, drawing the head of the bolt into the recess. After the bolt is within the recess, continue to tighten the nut until securely fastened.

Tip: TIE DOWN'S SPEED WRENCH cuts time required to tension strap in half!

Strap Tensioning - Speed Wrench

Tie Down's SPEED WRENCH simplifies anchor installation with a design that allows for one handed operation for installing slotted bolts and tensioning strap. The SPEED WRENCH has a 15/16" impact socket on one side and a 15/16" "nut" on the other. Combine this with your own ratchet and 15/16" socket and you have the fastest way to tighten slotted bolts!
Part # 48900

1. Place Speed Wrench over the bolt head. Insert the strap end into the slot in bolt until flush with opposite side of bolt.



2. Hold Speed Wrench in place, tighten bolt with socket wrench on outside of Speed Wrench (bolt head side).



3. Move socket to the opposite (nut) side. Hold Speed Wrench in place. Use socket wrench to tighten nut.



Strap Attachment

One crimp seal is used when strap is attached to a sidewall bracket or a strap connector. If the bracket does not have a radius edge, a radius clip (short "U" shaped piece of strap) must be placed between the strap and contact point to protect the strap from sharp edges. Verify state requirements for number of crimp seals required.

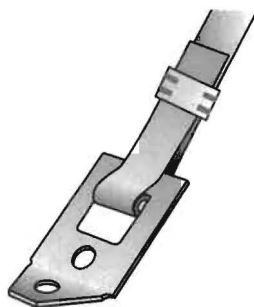

Strap Splice

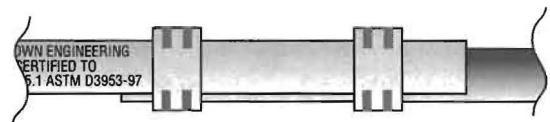

2 Seals - 2 Crimps per seal

To lengthen strap in the field, a double crimp seal splice is required. Overlap strap approximately 12 inches and use two crimp seals evenly spaced, with 2 crimps per seal.



010809.d12

I:\HOWARD-CO-2343\51591-ALPHA-RIDGE-LPS\DOCS\DWG\SHEETS\51591-001.DWG

QUANTITIES					
ITEM	BID AMOUNT	UNIT	AS-BUILT AMOUNT	MATERIAL	SUPPLIER
8" PVC GRAVITY SEWER	600	LF			
4" PVC FM	300	LF			
PRECAST CONCRETE MANHOLE	5	EA			
PREFABRICATED SEWER PUMP STATION AND VALVE VAULT	1	EA			

ALPHA RIDGE SEWAGE PUMP STATION

CONTRACT NO.: N/A

HOWARD COUNTY, MARYLAND

DEPARTMENT OF PUBLIC WORKS

INDEX OF DRAWINGS	
DRAWING NO.	TITLE
1	COVER SHEET, GENERAL NOTES, LEGEND, ABBREVIATIONS, AND INDEX OF DRAWINGS
2	SITE PLANS AND PROFILE
3	MISCELLANEOUS DETAILS
4	SEDIMENT AND EROSION CONTROL NOTES AND DETAILS

GENERAL NOTES:

- THE LOCATIONS, ELEVATIONS OR STATIONING SHOWN FOR THE EXISTING MAINS AND UTILITIES ARE APPROXIMATE. THE CONTRACTOR IS RESPONSIBLE FOR VERIFYING THE EXISTING (INCLUDING LOCATION AND ELEVATION) OF ALL BURIED UTILITIES. NOTE ALSO THAT OTHER BURIED UTILITIES MAY EXIST WITHIN THE WORK AREA THAT ARE NOT SHOWN. THE CONTRACTOR SHALL TAKE ALL NECESSARY PRECAUTIONS TO PROTECT EXISTING MAINS AND SERVICES AND MAINTAIN UNINTERRUPTED SERVICE. ANY DAMAGE INCURRED SHALL BE REPAIRED IMMEDIATELY TO THE SATISFACTION OF THE ENGINEER AT THE CONTRACTOR'S EXPENSE.
- TOPOGRAPHIC INFORMATION SHOWN IS BASED ON TOPOGRAPHIC SURVEYS PERFORMED BY URS CORPORATION (10, 2013) FOR THE PROJECT "ALPHA RIDGE LANDFILL MAINTENANCE FACILITY FUEL STORAGE & DISPENSING SYSTEM UPGRADES, DATED APRIL 2014" AS PROVIDED BY HOWARD COUNTY. COORDINATES SHOWN HEREON ARE BASED ON THE MARYLAND STATE REFERENCE SYSTEM NAD '83/'07 AS PROJECTED BY HOWARD COUNTY PROJECT CONTROL STATIONS 100 AND 16BM2
 16BM2
 597,115.7307
 1,338,079.2828
 507.04' (NAVD 88)
 HOWARD COUNTY REBAR FOUND

 100
 597,170.6579
 1,338,460.9795
 493.45' (NAVD 88)
 HOWARD COUNTY MAG NAIL FOUND
- ALL PIPE ELEVATIONS SHOWN ARE INVERT ELEVATIONS UNLESS OTHERWISE NOTED ON THE PLANS. THE FINAL PIPE LOCATION MAY BE ADJUSTED IN THE FIELD BY THE ENGINEER AFTER INITIAL STAKE OUT TO SUIT EXISTING CONDITIONS.
- FOR DETAILS NOT SHOWN ON THE DRAWING, AND FOR MATERIALS AND CONSTRUCTION METHODS, USE HOWARD COUNTY DESIGN MANUAL, VOLUMES II & IV, STANDARD SPECIFICATIONS AND DETAILS FOR CONSTRUCTION (LATEST EDITION). THE CONTRACTOR SHALL HAVE A COPY OF VOLUMES II & IV ON THE JOB.
- THE CONTRACTOR SHALL NOTIFY THE FOLLOWING UTILITY COMPANIES OR AGENCIES AT LEAST FIVE WORKING DAYS BEFORE STARTING WORK SHOWN ON THESE PLANS:
 AT&T.....1-800-252-1133
 BGE (CONTRACTOR SERVICES).....410-637-8713
 BGE (EMERGENCY).....410-685-0123
 BUREAU OF UTILITIES.....410-313-4900
 COLONIAL PIPELINE CO.....410-795-1390
 MISS UTILITY.....1-800-257-7777
 STATE HIGHWAY ADMINISTRATION.....410-531-5533
 VERIZON.....1-800-743-0033
- TREES AND SHRUBS ARE TO BE PROTECTED FROM DAMAGE TO THE MAXIMUM EXTENT. TREES AND SHRUBS LOCATED WITHIN THE TEMPORARY CONSTRUCTION STRIP ARE NOT TO BE REMOVED OR DAMAGED BY THE CONTRACTOR.
- THE CONTRACTOR SHALL REMOVE TREES, STUMPS AND ROOTS ALONG THE LINE OF EXCAVATION. PAYMENT FOR SUCH REMOVAL SHALL BE INCLUDED IN THE UNIT PRICE BID FOR CONSTRUCTION OF THE MAIN.
- THE CONTRACTOR SHALL NOTIFY THE BUREAU OF HIGHWAYS, HOWARD COUNTY, AT (410) 313-7450 AT LEAST FIVE WORKING DAYS BEFORE OPEN CUTTING OR BORING/JACKING OR DIRECTIONAL DRILLING OF ANY COUNTY ROAD FOR LAYING WATER/SEWER MAINS OR HOUSE CONNECTIONS. THE APPROVAL OF THESE DRAWINGS WILL CONSTITUTE COMPLIANCE WITH DPW REQUIREMENTS PER SECTION 18.114(A) OF THE HOWARD COUNTY CODE.
- TOPS OF ALL SEWER MAINS SHALL HAVE A MINIMUM OF 3'-6" OF COVER UNLESS OTHERWISE NOTED.
- ALL FITTINGS SHALL BE BUTTRESSED OR ANCHORED WITH CONCRETE IN ACCORDANCE WITH THE COUNTY STANDARD DETAIL S-4.04.
- THE CONTRACTOR SHALL LOCATE ANY WATER AND OR SEWER CONNECTIONS, AND TAKE ALL NECESSARY PRECAUTIONS TO PROTECT THESE EXISTING CONNECTIONS. ANY DAMAGE INCURRED SHALL BE REPAIRED IMMEDIATELY TO THE SATISFACTION OF THE ENGINEER AT THE CONTRACTOR'S EXPENSE. ALL EXISTING CONNECTIONS SHALL BE RECONNECTED UPON COMPLETION OF CONSTRUCTION IN ACCORDANCE WITH COUNTY STANDARDS. TEMPORARY SERVICE SHALL BE PROVIDED AS REQUIRED.
- EXISTING STORM DRAINS DISTURBED BY THE CONSTRUCTION SHALL BE REPLACED IN KIND AT THE SAME LINE AND GRADE AS THE EXISTING STORM DRAINS.
- ANY TREES, OUTSIDE OF EXISTING EASEMENTS, DISTURBED BY CONSTRUCTION SHALL BE REPLACED IN KIND. (3" CALIPER MINIMUM.)
- THE CONTRACTOR MUST FOLLOW ALL CONDITIONS AND REQUIREMENTS AS SET FORTH IN THE PROJECT DOCUMENTS.
- ANY SECTIONS OF THE EXISTING SEWER MAINS REMOVED AS PART OF THIS PROJECT SHALL BE DISPOSED OF IN ACCORDANCE WITH APPLICABLE REGULATIONS.
- CONTRACTOR SHALL NOT EXCEED 80% OF MANUFACTURER'S ALLOWABLE MAXIMUM JOINT DEFLECTION FOR PIPING SPECIFIED.
- CONNECTIONS TO EXISTING SEWER MAINS SHALL BE FULLY RESTRAINED.
- THE CONTRACTOR SHALL PROVIDE SURVEY CONSTRUCTION STAKEOUT FOR ALL NECESSARY LINES, GRADES AND ELEVATIONS OF THE PROPOSED FACILITIES.
- ALL PROPOSED INTERIOR WASTEWATER DIP PIPING SHALL BE CLASS 53 WITH FLANGED FITTINGS AND ALL PROPOSED BURIED PIPING SHALL BE PVC SDR 35 (FOR GRAVITY SEWER), DP CLASS 150 (FOR GRAVITY SEWER), AND PVC SDR 21 (FOR FORCE MAIN).
- PIPE TRENCHING AND PAVEMENT REPLACEMENT SHALL BE DONE IN ACCORDANCE WITH HOWARD COUNTY STANDARDS, INCLUDING STANDARD DETAIL G-4.01 AND STANDARD DETAIL G-2.12.
- PROVIDE TRACER WIRE AND CONTINUITY TEST STATIONS FOR ALL NON-METALLIC PIPING PER HOWARD COUNTY STANDARD DETAIL G-8.21.
- THE CONTRACTOR SHALL IMMEDIATELY NOTIFY THE ENGINEER UPON ENCOUNTERING HAZARDOUS WASTE OR CONTAMINATED SOIL DURING EXCAVATION OPERATIONS.



WATER AND SEWER CODE FOR COUNTY USE ONLY:

NO. OF WATER CONNECTIONS:	0
NO. OF SEWER CONNECTIONS:	N/A
DRAINAGE AREA:	X
TYPE OF BUILDING:	N/A
NO. OF PARCELS:	N/A

VICINITY MAP
SCALE: 1" = 600'

LEGEND
(PLAN AND PROFILE SHEETS)

<p>===== SIDEWALK</p> <p>===== PAVEMENT (EDGE)</p> <p>===== GRAVEL (EDGE)</p> <p>===== CONCRETE (EDGE)</p> <p>===== BUILDING</p> <p>----- CENTERLINE</p> <p>----- SHA THRU HIGHWAY RIGHT-OF-WAY</p> <p>----- PROPERTY LINE/RIGHT-OF-WAY</p> <p>----- MAJOR CONTOUR</p> <p>----- MINOR CONTOUR</p> <p>----- EX. GRAVITY SEWER</p> <p>----- EX. SANITARY FORCE MAIN</p> <p>===== NEW GRAVITY SEWER</p> <p>===== NEW SANITARY FORCE MAIN</p> <p>----- ABANDON IN PLACE</p> <p>----- LIMIT OF DISTURBANCE</p> <p>----- SILT FENCE</p>	<p>.....325.5 SPOT ELEVATION</p> <p>○ EX. SAN. SEW. MH/PUMP STATION</p> <p>○ NEW SAN. SEW. MH</p> <p>○ NEW SAN. PUMP STATION</p> <p>○ RSG VALVE</p> <p>○ POINT OF CONNECTION</p>	<p>① ← DETAIL OR SECTION IDENTIFICATION</p> <p>② ← SHEET NO.</p> <p>③ ← DETAIL IDENTIFICATION</p> <p>④ ← SHEET THAT DETAIL IS LOCATED</p>
---	--	---

OWNERS/DEVELOPER CERTIFICATION:

I/WE CERTIFY THAT ALL DEVELOPMENT AND CONSTRUCTION WILL BE DONE ACCORDING TO THIS PLAN, AND THAT ANY RESPONSIBLE PERSONNEL INVOLVED IN THE CONSTRUCTION PROJECT WILL HAVE A CERTIFICATE OF ATTENDANCE AT A DEPARTMENT OF THE ENVIRONMENT APPROVED TRAINING PROGRAM FOR THE CONTROL OF SEDIMENT AND EROSION BEFORE BEGINNING THE PROJECT. I ALSO AUTHORIZE PERIODIC ON-SITE INSPECTIONS BY THE HOWARD SOIL CONSERVATION DISTRICT.

Signature of Developer *3/22/14*
Date

SEDIMENT CONTROL MEASURES FOR THIS CONTRACT WILL BE IMPLEMENTED IN ACCORDANCE WITH SECTION 219 OF THE SPECIFICATIONS AND AS SHOWN ON THE DRAWINGS, AND STANDARD EROSION & SEDIMENT CONTROL.

HOWARD SOIL CONSERVATION DISTRICT CERTIFICATION:

THIS PLAN IS APPROVED FOR SOIL EROSION AND SEDIMENT CONTROL BY THE HOWARD SOIL CONSERVATION DISTRICT (SCD).

John P. Robertson/hrs *10/20/14*
Howard Soil Conservation District Date

ENGINEERS DESIGN CERTIFICATION:

I CERTIFY THAT THIS PLAN FOR EROSION AND SEDIMENT CONTROL REPRESENTS A PRACTICAL AND WORKABLE PLAN BASED ON MY PERSONAL KNOWLEDGE OF THE SITE CONDITIONS AND THAT IT WAS PREPARED IN ACCORDANCE WITH THE REQUIREMENTS OF THE HOWARD SOIL CONSERVATION DISTRICT.

Signature of Engineer - Registration Number *18523* *3/19/14*
Date

DEPARTMENT OF PUBLIC WORKS
HOWARD COUNTY, MARYLAND

Signature *3/21/14*
DIRECTOR OF PUBLIC WORKS DATE

Signature *3/21/14*
CHIEF - BUREAU OF FACILITIES DATE

Signature *3/21/14*
CHIEF - BUREAU OF ENVIRONMENTAL SERVICES DATE

O'BRIEN & GERE
4201 MITCHELLVILLE ROAD
SUITE 500
BOWIE, MD 20716
PHONE: 301-731-5622

PROFESSIONAL CERTIFICATION:
I HEREBY CERTIFY THAT THESE DOCUMENTS WERE PREPARED OR APPROVED BY ME, AND THAT I AM A DULY LICENSED PROFESSIONAL ENGINEER UNDER THE LAWS OF THE STATE OF MARYLAND, LICENSE NO. 18523, EXPIRATION DATE 12/08/2015

Signature *3/21/14*
REGISTERED PROFESSIONAL ENGINEER

DSN. BY:	NV
DRN. BY:	RPW
CHK. BY:	RJD
DATE:	05/14
BY NO.	
REVISION	
DATE	

COVER SHEET, GENERAL NOTES, LEGEND, ABBREVIATIONS, AND INDEX OF DRAWINGS

600' SCALE MAP NO. _____ BLOCK NO. _____

ALPHA RIDGE SEWAGE PUMP STATION

CAPITAL PROJECT NO.: C-0317
HOWARD COUNTY, MARYLAND

SCALE AS SHOWN

SHEET 1 OF 4

FILE NO. 51591-001