

LAYOUT _____ INSP 4 _____

INSP 2 _____ INSP 5 _____

INSP 3 _____ INSP 6 _____

ISSUE DATE: 12/07/06

P 525673

APPROVAL DATE: 12/13/06

A _____

PERMIT

TAX ID # _____

ON-SITE SEWAGE DISPOSAL SYSTEM HOWARD COUNTY HEALTH DEPARTMENT BUREAU OF ENVIRONMENTAL HEALTH

Hatfield's Equipment IS PERMITTED TO INSTALL ALTER

ADDRESS: P.O. Box 519 Annapolis Junction PHONE NUMBER: 301.854.6172

SUBDIVISION: Triadelphia Farms II LOT NUMBER: _____

ADDRESS: 13324 Hunt Ridge Road PROPERTY OWNER: Charleen Steenberg

SEPTIC TANK CAPACITY (GALLONS): _____ OUTLET BAFFLE FILTER REQUIRED

PUMP CHAMBER CAPACITY (GALLONS): N/A COMPARTMENTED TANK REQUIRED

NUMBER OF BEDROOMS: 3

SQUARE FEET PER BEDROOM: 180

LINEAR FEET OF TRENCH REQUIRED: 112

TRENCHES:	Trench to be 2.0feet wide. Inlet 5.0feet below original grade. Bottom maximum depth 10.00feet below original grade. Effective area begins at 5.0feet below original grade. 5.0feet of stone below distribution pipe.
LOCATION:	Install trenches as shown on attachment.
NOTES:	Pump out and fill Drywells with dirt

PLANS APPROVED: B.Baker DATE: 12/07/06

- NOTE: PERMIT VOID AFTER 2 YEARS
- NOTE: CONTRACTOR RESPONSIBLE FOR SCHEDULING A PRE-CONSTRUCTION INSPECTION FOR ALL INSTALLATIONS
- NOTE: WATERTIGHT SEPTIC TANKS REQUIRED
- NOTE: ALL PARTS OF SEPTIC SYSTEM SHALL BE 100 FEET FROM ANY WATER WELL
- NOTE: MANHOLE RISERS REQUIRED ON ALL SEPTIC TANKS AND PUMP CHAMBERS UNLESS SPECIFICALLY AUTHORIZED

NEITHER THE HOWARD COUNTY COUNCIL NOR THE HEALTH DEPARTMENT IS RESPONSIBLE FOR THE SUCCESSFUL OPERATION OF ANY SYSTEM PERMITTEE RESPONSIBLE FOR OBTAINING FINAL APPROVAL ON THIS PERMIT CALL 410-313-1771 FOR INSPECTION OF SEPTIC SYSTEM

HO-73-3501

NOT TO SCALE

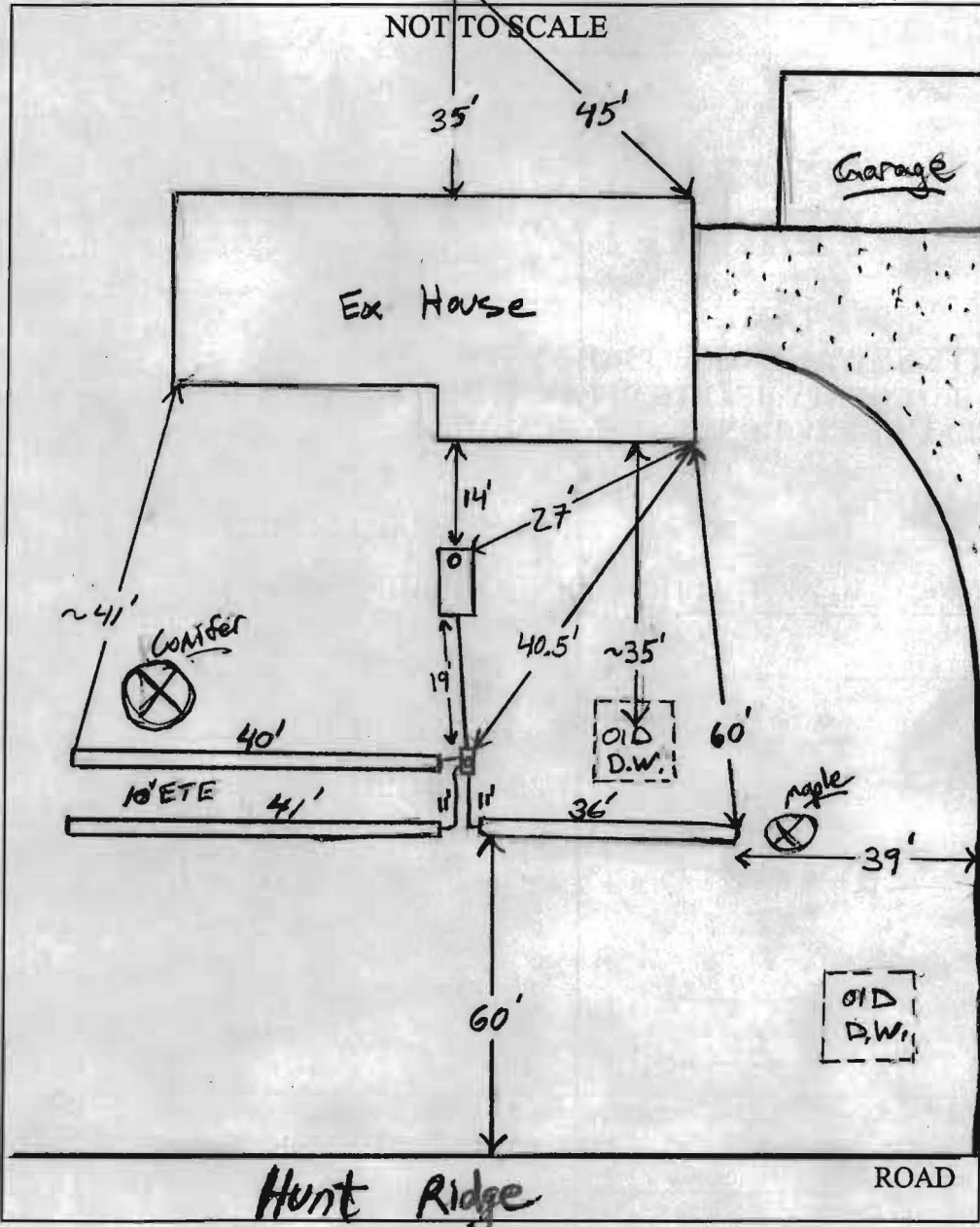

TRENCH/DRAINFIELD DATA		
WIDTH	INLET	BOTTOM
2'	5'	
NUMBER OF TRENCHES		3
TOTAL LENGTH		
ABSORPTION AREA		
DISTRIBUTION BOX LEVEL		Yes
DISTRIBUTION BOX BAFFLE		Yes
DISTRIBUTION BOX PORT		Yes

SEPTIC TANK DATA	
SEPTIC TANK 1 LEVEL	Level
CAPACITY	? GAL
SEAM LOC	
TANK LID DEPTH	3'-3.5'
BAFFLES	Yes
BAFFLE FILTER	-
MANHOLE LOC	none
6" PORT LOC	Front
WATERTIGHT TEST	-
SEPTIC TANK 2 LEVEL	
CAPACITY	GAL
SEAM LOC	
TANK LID DEPTH	
BAFFLES	
BAFFLE FILTER	
MANHOLE LOC	
6" PORT LOC	
WATERTIGHT TEST	

PRE-CONSTRUCTION _____

INSTALLATION 12/13/06 Both Dry well's pumped, collapsed and filled in. System installed per installation leveled D box w/ levelers. Rear baffle installed to ea. tank System OK. to back fill. (KW)

FINAL INSPECTOR (R.W) DATE OF APPROVAL 12/13/06