

PUB. SEWER STATUS VERIFIED BY _____

ISSUE DATE: 5/6/2011
APPROVAL DATE: 5/16/2011

PERMIT

P 535184
A REPAIR

Septic Repair ON-SITE SEWAGE DISPOSAL SYSTEM HOWARD COUNTY HEALTH DEPARTMENT BUREAU OF ENVIRONMENTAL HEALTH

J.M. Contracting LLC. IS PERMITTED TO INSTALL ALTER

ADDRESS: 425 Obrecht Road Sykesville, MD 21784 PHONE NUMBER: 443-277-7526

SUBDIVISION: _____ LOT NUMBER: _____

ADDRESS: 13258 Hunt Ridge Road PROPERTY OWNER: Jeff Willey

SEPTIC TANK CAPACITY (GALLONS): N/A

PUMP CHAMBER CAPACITY (GALLONS): _____

NUMBER OF BEDROOMS: _____

SQUARE FEET OF HOUSE: _____

LINEAR FEET OF TRENCH REQUIRED: _____

*Trenches 3' Wide
Inlet 4'
Bottom 5.5'
3 x 45' Trenches*

| | |
|-----------|------------------|
| TRENCHES: | <i>on center</i> |
| LOCATION: | |
| PURPOSE: | |

PLANS APPROVED: B. Baker DATE: 5/13/2011

- NOTE: PERMIT VOID AFTER 2 YEARS
- NOTE: CONTRACTOR RESPONSIBLE FOR SCHEDULING A PRE-CONSTRUCTION INSPECTION FOR ALL INSTALLATIONS
- NOTE: WATERTIGHT SEPTIC TANKS REQUIRED
- NOTE: ALL PARTS OF SEPTIC SYSTEM SHALL BE 100 FEET FROM ANY WATER WELL
- NOTE: MANHOLE RISERS REQUIRED ON ALL SEPTIC TANKS AND PUMP CHAMBERS

NEITHER THE HOWARD COUNTY COUNCIL OR THE HEALTH DEPARTMENT IS RESPONSIBLE FOR THE SUCCESSFUL OPERATION OF ANY SYSTEM PERMITTEE RESPONSIBLE FOR OBTAINING FINAL APPROVAL ON THIS PERMIT CALL 410-313-1771 FOR INSPECTION OF SEPTIC SYSTEM

NOT TO SCALE

HO-73-3159

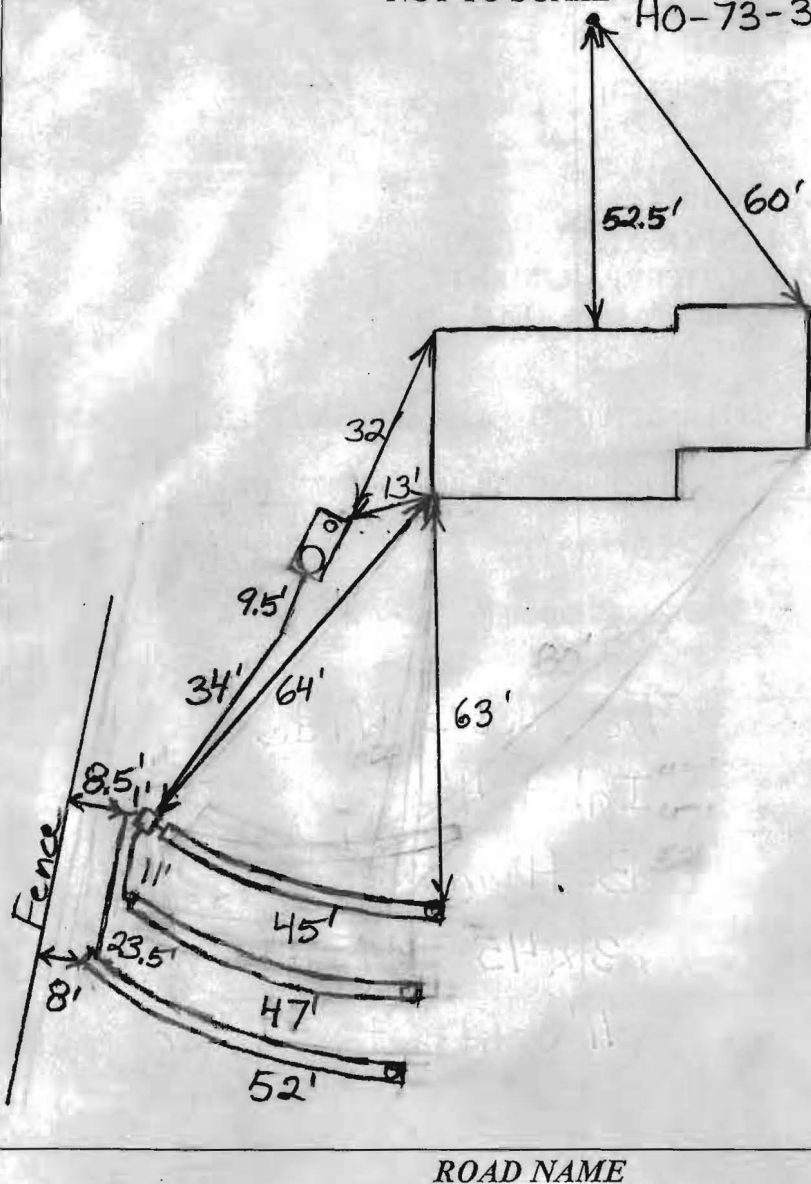

TRENCH/DRAINFIELD DATA

WIDTH 3' INLET 4' BOTTOM 5.5'
 NUMBER OF TRENCHES 3
 TOTAL LENGTH 144'
 ABSORPTION AREA 432 + Sidewall
 DISTRIBUTION BOX LEVEL Levelers
 DISTRIBUTION BOX BAFFLE Yes
 DISTRIBUTION BOX PORT No

SEPTIC TANK DATA

SEPTIC TANK 1 LEVEL _____
 MANUFACTURER ?
 CAPACITY ? GAL
 SEAM LOC Midseam
 TANK LID DEPTH 1.5-2
 BAFFLES Yes
 BAFFLE FILTER No
 MANHOLE LOC Rear
 6" PORT LOC Front
 WATERTIGHT TEST No
 SLOTTED No
 DATE ON LID No

PUMP/SEPTIC TANK LEVEL N/A

MANUFACTURER _____
 CAPACITY _____ GAL
 SEAM LOC _____
 TANK LID DEPTH _____
 BAFFLES _____
 BAFFLE FILTER _____
 MANHOLE LOC _____
 6" PORT LOC _____
 WATERTIGHT TEST _____
 SLOTTED _____
 DATE ON LID _____

PRE-CONSTRUCTION:

5/13/2011 Place the distribution box about 7' from the right property line. I install three 45' trenches on contour just below the evergreens. BB

INSTALLATION:

5/16/2011 System finished, O.K. to backfill. BB

FINAL INSPECTOR

B. Baker

DATE OF APPROVAL

5/16/2011