

C1 4412

SEQUENCE NO. (MDE USE ONLY)

STATE OF MARYLAND WELL COMPLETION REPORT

THIS REPORT MUST BE SUBMITTED WITHIN 45 DAYS AFTER WELL IS COMPLETED.

(THIS NUMBER IS TO BE PUNCHED IN COLS. 3-6 ON ALL CARDS)

COUNTY NUMBER

ST/CO USE ONLY DATE Received

DATE WELL COMPLETED

Depth of Well

PERMIT NO. FROM "PERMIT TO DRILL WELL"

OWNER: Palmer Robert; STREET OR RFD: 8430 Kings Meade Way; TOWN: Columbia; SUBDIVISION: Pleasant Grove; SECTION: 1; LOT: 62

WELL LOG

Table with columns: DESCRIPTION, FEET (FROM, TO), check if water bearing. Includes handwritten entries: Brown silty Soil and Weathered rock, Grey rock (schist), 2 geothermal bores completed each 300 ft deep...

GROUTING RECORD

WELL HAS BEEN GROUTED (Circle Appropriate Box) YES [Y] NO [N]; TYPE OF GROUTING MATERIAL: CEMENT [CM] BENTONITE CLAY [BC]; NO. OF BAGS: 18; NO. OF POUNDS: 100; GALLONS OF WATER: 342; DEPTH OF GROUT SEAL: from 0 to 300 ft.

CASING RECORD

MAIN CASING TYPE: None; Nominal diameter top (main) casing (nearest inch): 60; Total depth of main casing (nearest foot): 61.

Table for OTHER CASING (if used) with columns: diameter inch, depth (feet) from, to.

SCREEN RECORD

DEPTH (nearest ft.): 300; SCREEN TYPE: HO (Open Hole); SLOT SIZE: 1, 2, 3; DIAMETER OF SCREEN: 58 (NEAREST INCH); from 58 to 60.

PUMPING TEST

HOURS PUMPED (nearest hour): 8 9; PUMPING RATE (gal. per min.): 11 15; METHOD USED TO MEASURE PUMPING RATE: no tests; WATER LEVEL (distance from land surface) BEFORE PUMPING: 17 - 20 ft.; WHEN PUMPING: 22 - 25 ft.; TYPE OF PUMP USED (for test): A air, P piston, T turbine, C centrifugal, R rotary, O other, J jet, S submersible.

PUMP INSTALLED

DRILLER INSTALLED PUMP (CIRCLE) (YES or NO) YES [X] NO [O]; IF DRILLER INSTALLS PUMP, THIS SECTION MUST BE COMPLETED FOR ALL WELLS; TYPE OF PUMP INSTALLED PLACE (A,C,J,P,R,S,T,O) IN BOX 29: 29; CAPACITY: GALLONS PER MINUTE (to nearest gallon): 31 - 35; PUMP HORSE POWER: 37 - 41; PUMP COLUMN LENGTH (nearest ft.): 43 - 47; CASING HEIGHT (circle appropriate box and enter casing height): + above, - below; LAND SURFACE: 4 (nearest foot).

NUMBER OF UNSUCCESSFUL WELLS: 0; WELL HYDROFRACTURED: YES [Y] NO [N]

CIRCLE APPROPRIATE LETTER: A WELL WAS ABANDONED AND SEALED WHEN THIS WELL WAS COMPLETED; E ELECTRIC LOG OBTAINED; P TEST WELL CONVERTED TO PRODUCTION WELL

I HEREBY CERTIFY THAT THIS WELL HAS BEEN CONSTRUCTED IN ACCORDANCE WITH COMAR 26.04.04 "WELL CONSTRUCTION" AND IN CONFORMANCE WITH ALL CONDITIONS STATED IN THE ABOVE CAPTIONED PERMIT, AND THAT THE INFORMATION PRESENTED HEREIN IS ACCURATE AND COMPLETE TO THE BEST OF MY KNOWLEDGE.

DRILLERS LIC. NO.: MWD 421; DRILLERS SIGNATURE: [Signature]

LIC. NO.: D

SITE SUPERVISOR (sign. of driller or journeyman responsible for sitework if different from permittee)

GRAVEL PACK IF WELL DRILLED WAS FLOWING WELL INSERT F IN BOX 68: 68

MDE USE ONLY (NOT TO BE FILLED IN BY DRILLER) T (E.R.O.S.) W Q; TELESCOPE CASING; LOG INDICATOR; OTHER DATA

LOCATION OF WELL ON LOT SHOW PERMANENT STRUCTURE SUCH AS BUILDING, SEPTIC TANKS, AND/OR LANDMARKS AND INDICATE NOT LESS THAN TWO DISTANCES (MEASUREMENTS TO WELL)

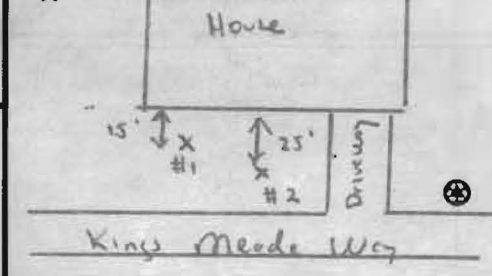

B 1 8684

SEQUENCE NO. (MDE USE ONLY)

STATE OF MARYLAND APPLICATION FOR PERMIT TO DRILL WELL 531984 please type

STATE PERMIT NUMBER

Ho-95-1846 fill in this form completely

Date Received (APA)

8 MM DD YY 13

Palmer Robert E. Last Name Owner First Name

8450 Kings Meade Way Street or RFD

Columbia MD 21046 Town State Zip

DRILLER INFORMATION

Stephen Saul MWD 421 Driller's Name License No.

B.I. Myers Bros Firm Name

15112 Pegasus Ct Ste V Frederick MD 21704 Address

Signature Date 11-2-09

B 2

WELL INFORMATION

APPROX. PUMPING RATE (GAL. PER MIN.) 0

AVERAGE DAILY QUANTITY NEEDED (GAL. PER DAY) 14 0 20

USE FOR WATER (CIRCLE APPROPRIATE BOX)

- DOMESTIC POTABLE SUPPLY & RESIDENTIAL IRRIGATION
FARMING (LIVESTOCK WATERING & AGRICULTURAL IRRIGATION)
INDUSTRIAL, COMMERCIAL, DEWATERING
PUBLIC WATER SUPPLY WELL
TEST, OBSERVATION, MONITORING
GEO-THERMAL 2 wells @ 300 ft

APPROXIMATE DEPTH OF WELL 300 FEET

APPROXIMATE DIAMETER OF WELL 6 INCH

METHOD OF DRILLING (circle one)

BORED (or Augered) JETTED Jetted & DRIVEN
AIR-ROTARY AIR-PERCussion ROTARY (Hydraulic Rotary)
CABLE REVERSE-ROTARY Drive-POINT

REPLACEMENT OR DEEPEMED WELLS (CIRCLE APPROPRIATE BOX)

- THIS WELL WILL NOT REPLACE AN EXISTING WELL
THIS WELL WILL REPLACE A WELL THAT WILL BE ABANDONED AND SEALED
THIS WELL WILL REPLACE A WELL THAT WILL BE USED AS A STANDBY-CONTACT LOCAL APPROVING AUTHORITY FOR POLICY ON STANDBY WELLS
THIS WELL WILL DEEPEMED AN EXISTING WELL

PERMIT NUMBER OF WELL TO BE REPLACED OR DEEPEMED (IF AVAILABLE)

Not to be filled in by driller (MDE OR COUNTY USE ONLY)

APPROX. PERMIT NUMBER G
PERMIT No. Ho-95-1846

SPECIAL CONDITIONS

NOTE - APPROVING AUTHORITIES SHOULD USE SEPARATE PERMIT IF NEEDED

Draw from Bottom Upward, Beware of Utility Lines

B 3

LOCATION OF WELL

Howard COUNTY

Pleasant Grove SUBDIVISION

SECTION 1 LOT 62

Columbia NEAREST TOWN

MILES FROM TOWN (enter 0 if in town) 1 MI

B 4

DIRECTION OF WELL FROM TOWN (CIRCLE BOX)

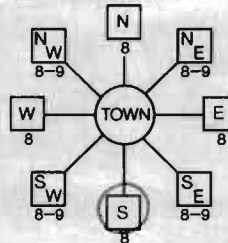

8450 Kings Meade Way NEAR WHAT ROAD

ON WHICH SIDE OF ROAD (CIRCLE APPROPRIATE BOX)

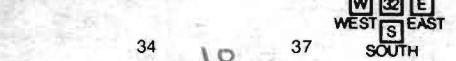

DISTANCE FROM ROAD 10 FT ENTER FT OR MI

TAX MAP: 42 BLK: 7 PARCEL 1

NOT TO BE FILLED IN BY DRILLER HEALTH DEPARTMENT APPROVAL

Howard 13 Public COUNTY NAME COUNTY NO.

STATE SIGNATURE INSERT S

DATE ISSUED 11/30/2010 CO SIGNATURE BRUN BABER 11/30/2010 EXP. DATE

NORTH GRID 488 0 0 0 EAST GRID 836 0 0 0

SHOW MAJOR FEATURES OF BOX & LOCATE WELL WITH AN X

SOURCES OF DRILLING WATER

- 1. Public
2.
3.

WRITE THE BOX NUMBER FROM THE MAP HERE

E 836

N 488

DRAW A SKETCH BELOW SHOWING LOCATION OF WELL IN RELATION TO NEARBY TOWNS AND ROADS AND GIVE DISTANCE FROM WELL TO NEAREST ROAD JUNCTION

N

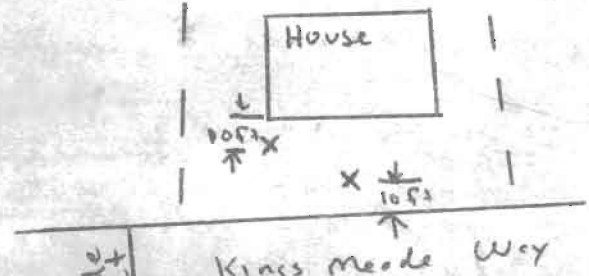

11/30/09

Cannot Maintain  
30' House Setback  
Cannot Get Rig  
in Back Yard.  
Locate all Utilities  
Before Drilling

(BB)

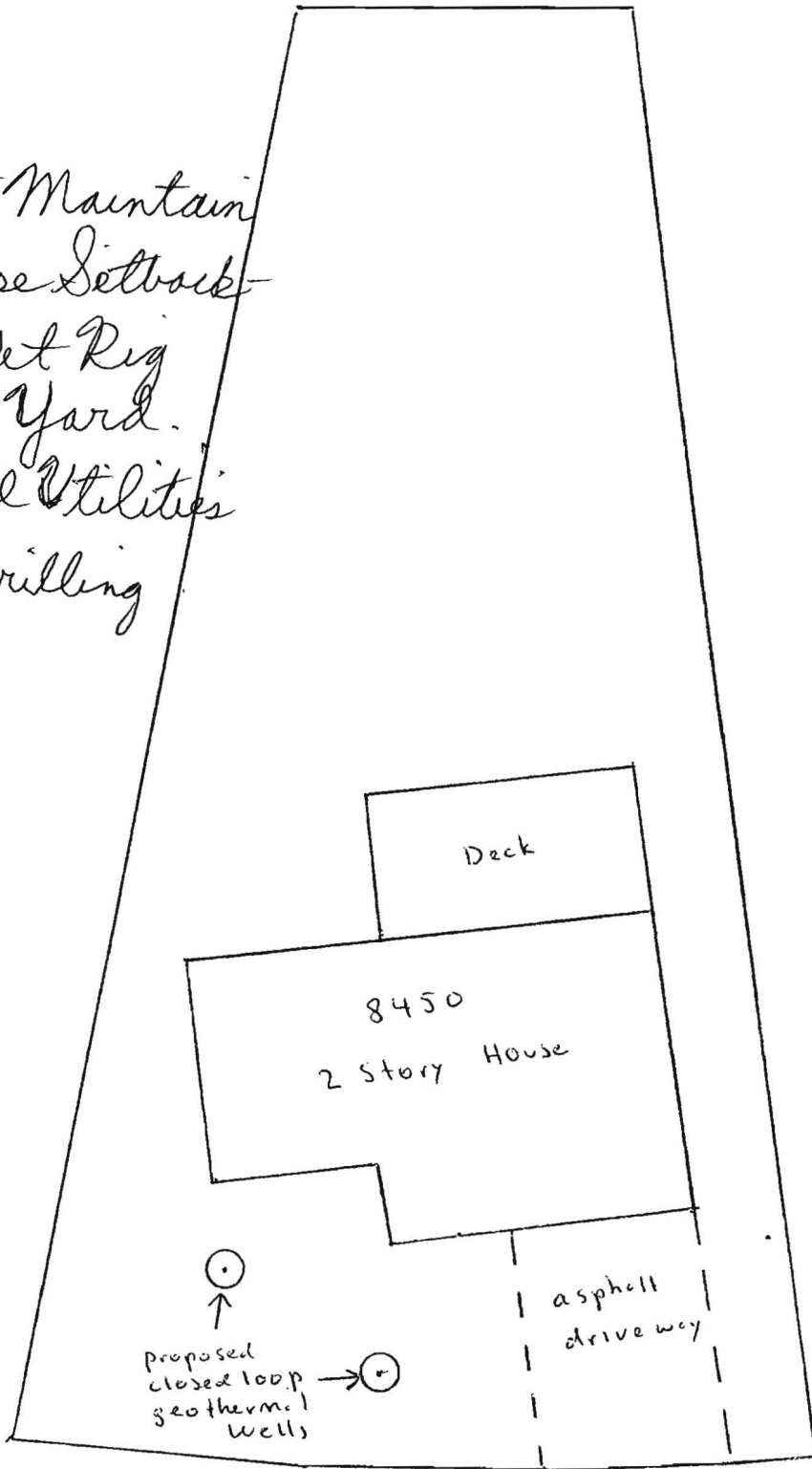

Kings Meade Way

**B.L. MYERS BROS. OF MD., LLC**

MYERS SINCE 1884

5112 PEGASUS COURT, SUITE V  
FREDERICK, MD 21704  
WEB: BLMYERS.COM

(800) 947-5552  
(301) 668-1044  
FAX (301) 668-1042

November 17, 2009

Brian Baker  
Howard County Health Department  
Environmental Health Division  
7178 Columbia Gateway Drive  
Columbia, MD 21047  
Fax: 410 313-2648

Re: geothermal well permit application  
8450 Kings Meade Way, Columbia Maryland

Dear Mr. Baker,

Per our telephone discussion earlier today, on behalf of the property owner, B.L. Myers Bros. hereby requests a variance from the minimum distance requirement for the placement of two closed loop geothermal wells that are proposed to be located on the property.

Given the size and layout of the property, the placement of the wells cannot satisfy the minimum distance of 30 feet from the building foundation. Rather the two proposed geothermal wells would be located in the front yard at distances of 10 feet and 15 feet from the foundation. It is not feasible to locate the wells further from the foundation without the drill rig encroaching on the public roadway. Furthermore, there is no drill rig access available to the back yard of the property.

We appreciate your consideration in this matter and look forward hearing from you.

Should you have any questions or require additional information, please contact me by cell phone at 443 309-2201 or by email at [ssaul@blmyers.com](mailto:ssaul@blmyers.com).

Sincerely,



Steve Saul  
B.L. Myers Bros of MD, LLC

# Typical Closed Loop Geothermal Bore

