

PUB. SEWER STATUS VERIFIED BY _____

ISSUE DATE: 09/20/05

P 523344

PERMIT

APPROVAL DATE: 9/23/05

A REPAIR

TAX ID # 03 - 304051

ON-SITE SEWAGE DISPOSAL SYSTEM HOWARD COUNTY HEALTH DEPARTMENT BUREAU OF ENVIRONMENTAL HEALTH

Jenkins Brothers Septic Service, Inc. IS PERMITTED TO INSTALL ALTER

ADDRESS: 7670 Smiths Private Road, Sykesville PHONE NUMBER: 410-465-6646

SUBDIVISION: Sand Hill Acres LOT NUMBER: 1-C

ADDRESS: 12049 Lamplighter Drive PROPERTY OWNER: Albert Holtz

SEPTIC TANK CAPACITY (GALLONS): Existing 3' Wide

PUMP CHAMBER CAPACITY (GALLONS): N/A 2' Inlet

NUMBER OF BEDROOMS: 4 4' Bottom

SQUARE FEET PER BEDROOM: 210

LINEAR FEET OF TRENCH REQUIRED: 174

TRENCHES:	Trench to be _____ feet wide. Inlet _____ feet below original grade. Bottom maximum depth _____ feet below original grade. Effective area begins at _____ feet below original grade. _____ feet of stone below distribution pipe.
LOCATION:	
PURPOSE:	Existing septic system has failed. Call for inspection when ground is opened so sanitarian can recommend repair.

PLANS APPROVED: _____ DATE: _____

- NOTE: PERMIT VOID AFTER 2 YEARS
- NOTE: CONTRACTOR RESPONSIBLE FOR SCHEDULING A PRE-CONSTRUCTION INSPECTION FOR ALL INSTALLATIONS
- NOTE: WATERTIGHT SEPTIC TANKS REQUIRED
- NOTE: ALL PARTS OF SEPTIC SYSTEM SHALL BE 100 FEET FROM ANY WATER WELL
- NOTE: MANHOLE RISERS REQUIRED ON ALL SEPTIC TANKS AND PUMP CHAMBERS

NEITHER THE HOWARD COUNTY COUNCIL OR THE HEALTH DEPARTMENT IS RESPONSIBLE FOR THE SUCCESSFUL OPERATION OF ANY SYSTEM PERMITTEE RESPONSIBLE FOR OBTAINING FINAL APPROVAL ON THIS PERMIT CALL 410-313-2640 FOR INSPECTION OF SEPTIC SYSTEM

1583660

NOT TO SCALE

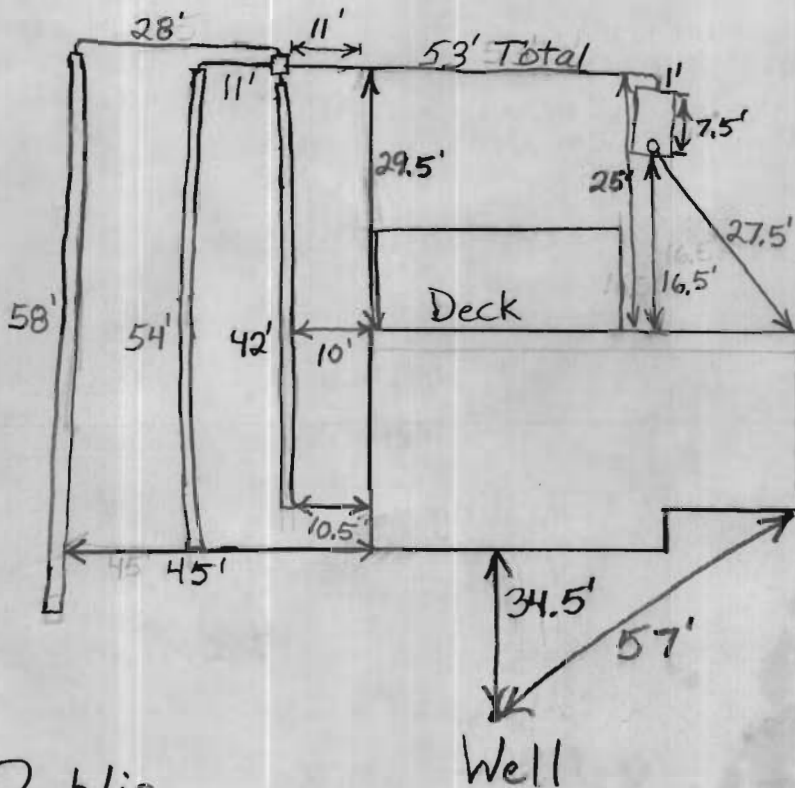

Public
H₂O

Lamplighters Drive

TRENCH/DRAINFIELD DATA		
WIDTH	INLET	BOTTOM
3'	2'	4'
NUMBER OF TRENCHES		3
TOTAL LENGTH		154'
ABSORPTION AREA		462 + Sidewalk
DISTRIBUTION BOX LEVEL		Levelers
DISTRIBUTION BOX BAFFLE		Yes
DISTRIBUTION BOX PORT		No

SEPTIC TANK DATA	
SEPTIC TANK 1 LEVEL _____	
CAPACITY	_____ GAL
SEAM LOC	Midscam
TANK LID DEPTH	6"
BAFFLES	Yes
BAFFLE FILTER	No
MANHOLE LOC	None
6" PORT LOC	Front
WATERTIGHT TEST	No
SEPTIC TANK 2 LEVEL N/A	
CAPACITY	_____ GAL
SEAM LOC	_____
TANK LID DEPTH	_____
BAFFLES	_____
BAFFLE FILTER	_____
MANHOLE LOC	_____
6" PORT LOC	_____
WATERTIGHT TEST	_____

PRE-CONSTRUCTION 9/22/05 To install 3 trenches on the right side of the house. O.K. if less than 20' from house.

INSTALLATION Pump out and fill in the drywell. (BB) 9/23/05 Drywell filled in per contractor. Contractor 20' short with total trench length. O.K. to backfill. (BB)

FINAL INSPECTOR B. Baker DATE OF APPROVAL 9/23/05