

LAYOUT 10/8/10 INSP 4 \_\_\_\_\_  
 INSP 2 10/12/10 INSP 5 \_\_\_\_\_  
 INSP 3 10/18/10 INSP 6 \_\_\_\_\_

ISSUE DATE: 9/27/2010  
 APPROVAL DATE: 10/18/10

# PERMIT

P 534034  
 A UPGRADE

**Tax ID #**  
**ON-SITE SEWAGE DISPOSAL SYSTEM**  
**HOWARD COUNTY HEALTH DEPARTMENT**  
**BUREAU OF ENVIRONMENTAL HEALTH**

LEVEL LAND, INC. IS PERMITTED TO INSTALL  ALTER   
 ADDRESS: PO BOX 100 LISBON, MD PHONE NUMBER: 410-984-1430  
 SUBDIVISION: WESTLAND FARM ESTATES LOT NUMBER: 1  
 ADDRESS: 12525 LIME KILN VALLEY ROAD PROPERTY OWNER: PERRY & BARBARA  
FULTON, MD 20759 WESTLAND

SEPTIC TANK CAPACITY (GALLONS): 2,000 OUTLET BAFFLE FILTER REQUIRED   
 PUMP CHAMBER CAPACITY (GALLONS): 1,500 COMPARTMENTED TANK REQUIRED   
 NUMBER OF BEDROOMS: 4 APPLICATION RATE: 1.2  
 SQUARE FOOTAGE OF HOUSE: 3,886  
 LINEAR FEET OF TRENCH REQUIRED: 103'

*4.5-6.5' 50'  
 54' Trenches  
 Trenches 6" Deeper*

TRENCHES:	Trenches to be 3 feet wide. Inlet 4 feet below original grade. Bottom maximum depth 6 feet below grade. Effective area begins at 4 feet below original grade with 2 feet of stone below distribution pipe.
LOCATION:	Abandon existing trenches and septic tank. Set new septic tank and pump tank. Run 2 x 52' trenches on contour in new septic easement.
NOTES:	<b>Do not order the septic tank until after layout inspection and Sanitarian approval. Stake septic easement corners. Call for layout inspection. Mark utilities. Gravel tickets must be available for Environmental Sanitarians. Stone must be approved by the Howard County Health Department. A written variance request is required for tanks deeper than 3 feet. A traffic bearing lid is required for tanks deeper than 4 feet.</b>

PLANS APPROVED: HEIDI SCOTT DATE: 9/27/2010

- NOTE: PERMIT VOID AFTER 2 YEARS
- NOTE: CONTRACTOR RESPONSIBLE FOR SCHEDULING A PRE-CONSTRUCTION INSPECTION FOR ALL INSTALLATIONS
- NOTE: WATERTIGHT SEPTIC TANKS REQUIRED
- NOTE: ALL PARTS OF SEPTIC SYSTEM SHALL BE 100 FEET FROM ANY WATER WELL
- NOTE: MANHOLE RISERS REQUIRED ON ALL SEPTIC TANKS AND PUMP CHAMBERS

**NEITHER THE HOWARD COUNTY COUNCIL OR THE HEALTH DEPARTMENT IS RESPONSIBLE FOR THE SUCCESSFUL OPERATION OF ANY SYSTEM PERMITTEE RESPONSIBLE FOR OBTAINING FINAL APPROVAL ON THIS PERMIT CALL 410-313-1771 FOR INSPECTION OF SEPTIC SYSTEM**

1"=40'

Lime Kiln Rd.

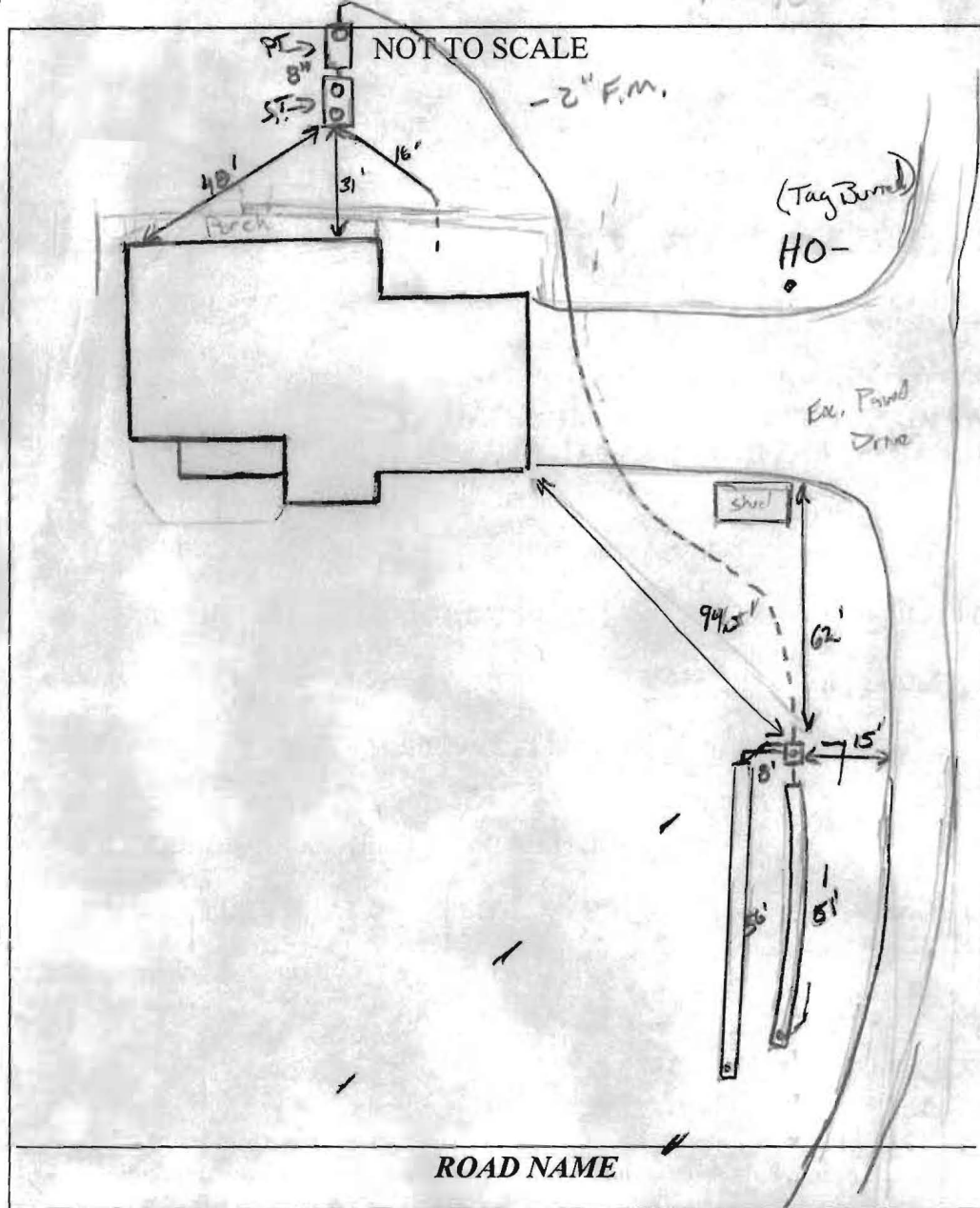

TRENCH/DRAINFIELD DATA		
WIDTH	INLET	BOTTOM
2'	4.5'	6.5'
NUMBER OF TRENCHES		2
TOTAL LENGTH		107
ABSORPTION AREA		214 + SW
DISTRIBUTION BOX LEVEL		Yes
DISTRIBUTION BOX BAFFLE		Yes
DISTRIBUTION BOX PORT		Yes

SEPTIC TANK DATA	
SEPTIC TANK 1 LEVEL	Yes
MANUFACTURER	Babylon
CAPACITY	2000 GAL
SEAM LOC	top
TANK LID DEPTH	2'-2.5'
BAFFLES	Yes
BAFFLE FILTER	NO
MANHOLE LOC	Front/Rear
6" PORT LOC	none
WATERTIGHT TEST	—
SLOTTED	Yes
DATE ON LID	8/20/10
<b>PUMP/SEPTIC TANK LEVEL</b>	Yes
MANUFACTURER	Babylon
CAPACITY	1500 GAL
SEAM LOC	Top
TANK LID DEPTH	2'
BAFFLES	Front
BAFFLE FILTER	—
MANHOLE LOC	Rear
6" PORT LOC	none
WATERTIGHT TEST	—
SLOTTED	NO
DATE ON LID	—

PRE-CONSTRUCTION:  
 10/8/2010 Layout done. **BB**

INSTALLATION: 10/12/10 Tanks set. Trenches complete. OK to backfill tanks and trenches. Had contractor remove pipe out of house to lower trench, bell" facing wrong direction. F.M. started ~20' out of tank. Make sure F.M. is 50' removed from ex. well **(KIM)**  
 10/18/10 F.M. installed. 50' from well. Pump & alarm test OK. System complete.

FINAL INSPECTOR Kevin Wang DATE OF APPROVAL 10/18/10