

12/29/89 ✓ ASAP + WATER
4/16/90 ✓ JWS
11/15

File

Note: Needs ONLY House Connection

12/29/89 (3) P.C.O. C.B.D.

PERMIT

SEWAGE-DISPOSAL SYSTEM

MARYLAND STATE DEPARTMENT OF HEALTH

HOWARD COUNTY
BUREAU OF ENVIRONMENTAL HEALTH
461-9933

05-396533

P 44763

A 33515

DISTRICT 5th

DATE 7/19/89

DATE SYSTEM APPROVED 4/16/90

INSPECTOR C.B.D.

INDEXED

Dave Hopkins & Son IS PERMITTED TO INSTALL ALTER

ADDRESS 17550 Old Frederick Road, Mt. Airy, Maryland PHONE 831-7257

SUBDIVISION Brighton Pines ROAD 1383³ Lakeside Drive LOT 16, Sec.1, Area 2

PROPERTY OWNER Joseph and Rochelle Long

ADDRESS

IF GARBAGE GRINDER IS USED INCREASE SEPTIC TANK CAPACITY BY 50% AND ABSORPTION AREA BY 22%.

GARBAGE GRINDER? YES NO

SEPTIC TANK CAPACITY 1250 GALLONS NUMBER OF BEDROOMS 4

TRENCHES - 180 sq. ft. per bedroom. Trench to be 2 feet wide. Inlet 4 feet below original grade. Bottom maximum depth 9 feet below original grade. Effective area begins at 4 feet below original grade. 5 feet of stone below distribution pipe.

LOCATION - From the bend in the left lot line (common intersection point with Lots 17 & 18) start first trench at a point 45 feet down the left lot line and 60 feet off that lot line. Run trenches along contour toward rear of lot.

NOTE - No trench to exceed 100 feet in length. Provide 6" - 8" diameter cleanout and cap to grade or above on septic tank. OK/CW

PLANS APPROVED BY C. Williams DATE Revised 12/07/89

COVER NO WORK UNTIL INSPECTED AND APPROVED

NEITHER THE HOWARD COUNTY COUNCIL NOR THE HEALTH DEPARTMENT IS RESPONSIBLE FOR THE SUCCESSFUL OPERATION OF ANY SYSTEM

NOTE: CLEANOUT REQUIRED EVERY 70 FEET OF SEWER LINE AND/OR AT 90° SWEEPS IN LINES FROM HOUSE TO DRAIN FIELDS

NOTE: ALL PARTS OF SEPTIC SYSTEMS (I.E. TANK, DISTRIBUTION BOX, TRENCHES) TO BE 100 FEET FROM WELL (UNLESS OTHERWISE SPECIFICALLY AUTHORIZED)

NOTE: IF DEEP TRENCHES ARE USED CALL FOR INSPECTION BEFORE AND AFTER PLACING GRAVEL IN TRENCHES

NOTE: NO DRY WELL SHALL EXCEED 15 FOOT IN DIAMETER NO ABSORPTION TRENCH TO EXCEED 100 FEET IN LENGTH.

NOTE: ALL PIPE FROM HOUSE TO SEPTIC TANK MUST BE CAST IRON OR SCHEDULE 40 PVC OR ABS

PERMIT VOID AFTER TWO YEARS

NOTE: INSTALL STAND PIPE ON SEPTIC TANK AND DRY WELL. STAND PIPES MUST BE 6 INCHES IN DIAMETER. CAST IRON, CONCRETE OR TERRA COTTA OR PVC OR ABS ACCEPTED. IF TOP OF SEPTIC TANK IS DEEPER THAN 3 FEET, MANHOLE TO GRADE REQUIRED

NOTE: DISTRIBUTION BOXES MUST HAVE BAFFLES

*INSTALLER IS RESPONSIBLE FOR OBTAINING FINAL APPROVAL ON THIS PERMIT

*CALL 461-9933 FOR INSPECTION OF SEPTIC SYSTEMS.

A 33515

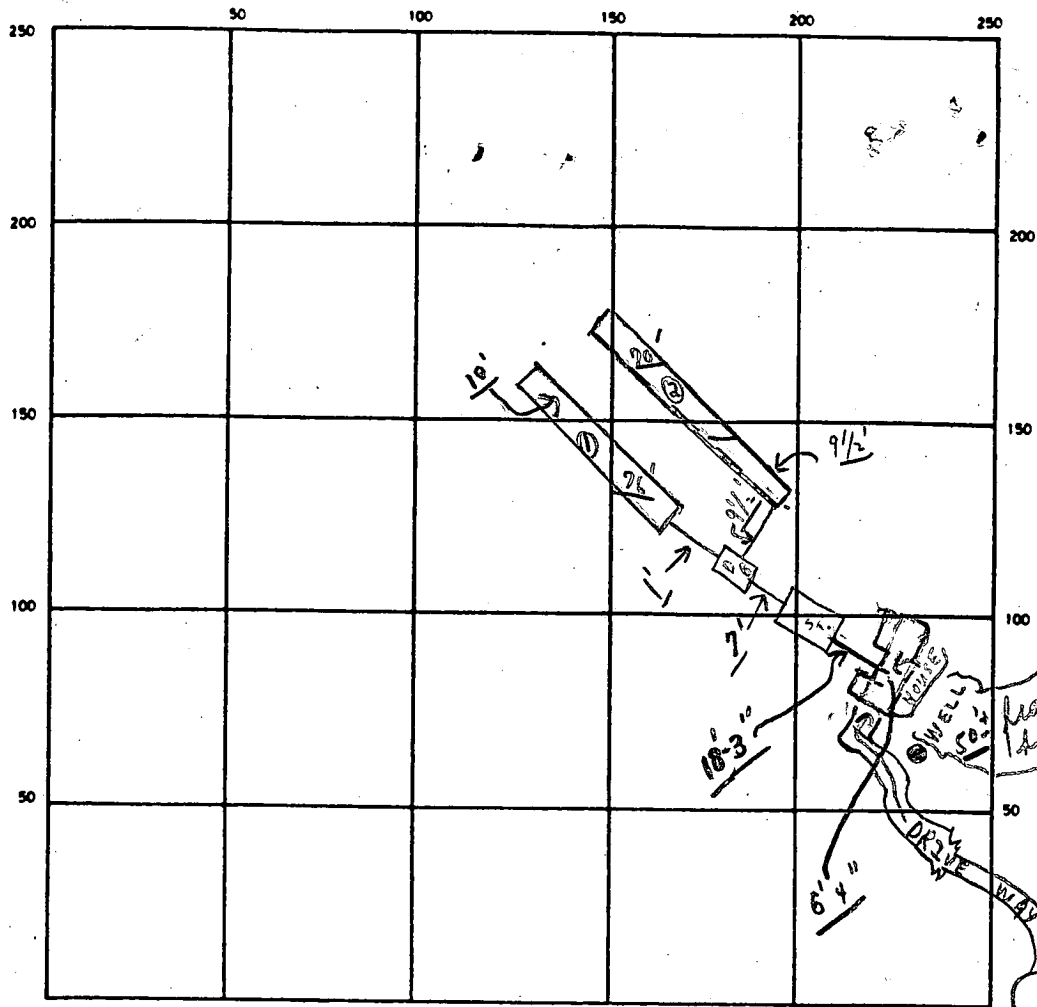

INDICATE NORTH — NAME ADJOINING ROADWAY AS BASE LINE

LAKESIDE DRIVE →

S.T.

SEPTIC TANK LEVEL OK CLEANOUTS OK

DISTRIBUTION BOX LEVEL OK (Baffles is in)

DRAIN FIELD/TILE FIELD DEPTH 9' FT. TRENCH WIDTH 2 FT. INLET DEPTH 4 FT.

EFFECTIVE GRAVEL DEPTH 5' FT. TOTAL LENGTH $\left. \begin{matrix} \textcircled{1} 26' \\ \textcircled{2} 20' \end{matrix} \right\} 146$ FT

NUMBER OF TRENCHES 2 ONE SIDEWALL/BOTTOM AREA 730⁺ SQ FT.

DRYWELL INSIDE DIAMETER FT EFFECTIVE DEPTH BELOW INLET FT.

ABSORBENT AREA 730⁺ SQ FT.

REMARKS 12/29/89 Partial septic tank only; ok to
continue; $\textcircled{1}$ Partial $\textcircled{1}$ Trench being worked on + $\textcircled{2}$ trench
not dug; C.B.D - Note: trenches swing - to fill in as they go;
ok to cover $\textcircled{1}$ Trench only; $\textcircled{3}$ Partial ok. to cover all
work - need to see pipes from septic tank to house
wall only; C.B.D Hold trench depth 9' + as certified

DATE SYSTEM APPROVED 4/16/90 INSPECTOR David D. Hopkins ← 12/29/89

→ Charles Bryan Street

May 22, 1989

Mr. Sid Abel
Environmental Health
3525 H. Ellicott Mills Dr.
Ellicott City, MD 21043

Dear Mr. Abel:

We are requesting that you review our proposed redistribution of septic field area for Lot 16, Section 1, Area 2 in Brighton Pines, Clarksville, MD. We wish to redistribute the area to accomodate the placement of a home such that one end does not fall within a gully while allowing the home to stay 20 feet from the septic field area. The proposed redistribution does not change the lowest elevation point and we believe remains within the perked area. Please contact us to confirm this change or to propose one that is more satisfactory to the Environmental Health Department. Thank-you.

Rochelle M. Long

Rochelle M. Long
(301) 496-5120 (Office)

Joseph B. Long

Joseph B. Long
(202) ~~576-4449~~ (Office)
~~1240-1290~~
17221 Hobble Bush Ct.
Rockville, MD 20855
(301) 869-5878 (Home)

ADJUSTMENT ACCEPTED
WITH "PAPER" REVISED
5/26/89 BY S.A.

FIELD INSP 12/5/89
NEGATED THIS DECISION
SOIL CONDITIONS NOT
AS EXPECTED -
SEPTIC AREA REVISED TO
HIGHER ON LOT.

12/7/89
C. Williams