

# APPLICATION

## FOR PERCOLATION TESTING AND SITE EVALUATION

TEST DATE(S) \_\_\_\_\_ TEST TIME \_\_\_\_\_

AP 538012

AGENCY REVIEW: \_\_\_\_\_

DATE 7-23-12

DO NOT WRITE ABOVE THIS LINE

I HEREBY APPLY FOR THE NECESSARY TESTING/EVALUATION PRIOR TO ISSUANCE OF SEWAGE DISPOSAL SYSTEM PERMIT(S) TO:

CHECK AS NEEDED:

- CONSTRUCT NEW SEPTIC SYSTEM(S)
- REPAIR/ADD TO AN EXISTING SEPTIC SYSTEM
- REPLACE AN EXISTING SEPTIC SYSTEM

CHECK AS NEEDED:

- NEW STRUCTURE(S)
- ADDITION TO AN EXISTING STRUCTURE
- REPLACE AN EXISTING STRUCTURE

CHECK ONE:

- CREATE NEW LOT(S)
- BUILD ON AN EXISTING LOT IN A SUBDIVISION
- BUILD ON AN EXISTING PARCEL OF RECORD

IS THE PROPERTY WITHIN 2500' OF ANY RESERVOIR?

- YES
- NO

THE TYPE OF STRUCTURE IS:

- RESIDENTIAL WITH 3 PROPOSED BEDROOMS IN THE COMPLETED STRUCTURE (NOTE UNKNOWN IF APPROPRIATE)
- COMMERCIAL (PROVIDE DETAIL OF NUMBERS AND TYPES OF EMPLOYEES/ CUSTOMERS ON ACCOMPANYING PLAN)
- INSTITUTIONAL/GOVERNMENT (PROVIDE DETAIL OF NUMBERS AND TYPES OF EMPLOYEES/USERS ON ACCOMPANYING PLAN)

PROPERTY OWNER(S) Steven Folsom

DAYTIME PHONE 410 531-3504 CELL \_\_\_\_\_ FAX \_\_\_\_\_

MAILING ADDRESS 4475 Linthicum Rd Dayton 21036  
STREET CITY/TOWN STATE ZIP

APPLICANT Fogle's Septic Clean Inc / Kurt Cassell

DAYTIME PHONE 410 795-5670 CELL 410 984-5211 FAX \_\_\_\_\_

MAILING ADDRESS 580 Obrecht Rd Sykesville MD 21784  
STREET CITY/TOWN STATE ZIP

APPLICANT'S ROLE: DEVELOPER BUILDER BUYER RELATIVE/FRIEND REALTOR CONSULTANT

PROPERTY LOCATION  
SUBDIVISION/PROPERTY NAME Pheasant Landing LOT NO. 17

PROPERTY ADDRESS 4475 Linthicum Rd Dayton  
STREET TOWN/POST OFFICE

TAX MAP PAGE(S) 28 GRID 1 PARCEL(S) 374 PROPOSED LOT SIZE 3.183

AS APPLICANT, I UNDERSTAND THE FOLLOWING: THE SYSTEM INSTALLED SUBSEQUENT TO THIS APPLICATION IS ACCEPTABLE ONLY UNTIL PUBLIC SEWERAGE IS AVAILABLE. THIS APPLICATION IS COMPLETE WHEN ALL APPLICABLE FEES AND A SUITABLE SITE PLAN HAVE BEEN RECEIVED. I ACCEPT THE RESPONSIBILITY FOR COMPLIANCE WITH ALL M.O.S.H.A. AND "MISS UTILITY" REQUIREMENTS. APPROVAL IS BASED UPON SATISFACTORY REVIEW OF A PERC CERTIFICATION PLAN.

TEST RESULTS WILL BE MAILED TO APPLICANT. Kurt A. Cassell  
SIGNATURE OF APPLICANT

HOWARD COUNTY HEALTH DEPARTMENT, BUREAU OF ENVIRONMENTAL HEALTH, WELL AND SEPTIC PROGRAM  
1718 COLUMBIA GATEWAY DRIVE COLUMBIA, MARYLAND 21046 (410) 313-2640 FAX (410) 313-2648  
TDD (410) 313-2323 TOLL FREE 1-877-4MD-DHMH

WP 538012  
Repair POC

H0-81-1294

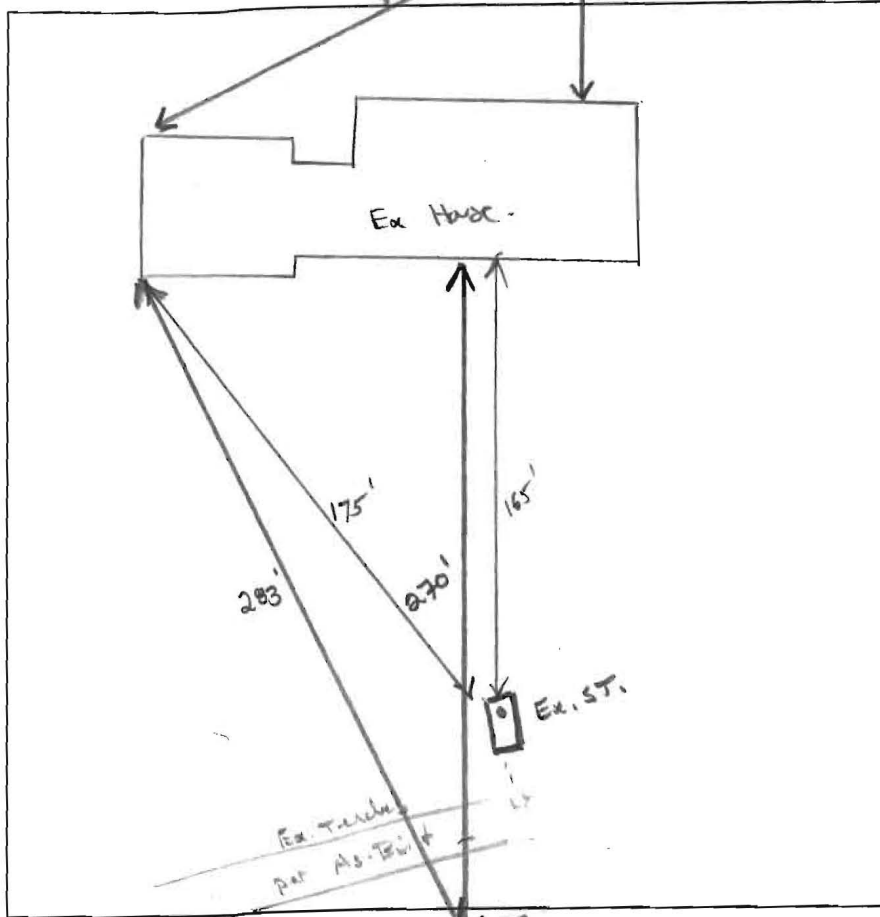

(A)  
10-12' WMSBK, DRK Br, roots,  
Br/Rd, CL, WSS but friable, 10% fd./sprallde.  
4-5' MSBK, roots  
Br/Rd./Y  
8' MSCL, Dry, tight  
many mica, friable, platy  
25% solid chert  
15% sprallde  
8' Br/Y SL, friable, loose  
many mica  
16' 6" 15% solid chert

DATE	TEST #	DEPTH	START	BREAK 1" DROP	STOP 2" DROP	TIME OF 2ND INCH	P/F/H
8/2/12	(A)	5' 6" / 16' 6"	11:32	11:42	11:50	Pulled 1/2" in 15 min	~25 min OK
		8' 10"	11:53	11:59	12:09	10	(P)
		16' 6"	POURED	H2O @ bottom	1:45pm - 2:20pm		OK

REMARKS WSS = slightly sticky / H2O poured @ bottom of hole # Future repair  
SA = single grain A ~ Spring move up 11.

SANITARIAN K. Wolf BACKHOE Fugle's OTHERS Helper  
TEST HOLES USED IN SDA 1 AVG. PERC TIME \_\_\_\_\_ SQ. FT/BR \_\_\_\_\_  
TRENCH WIDTH 2' INLET DEPTH \_\_\_\_\_ MAX. BOT DEPTH \_\_\_\_\_ EFFECTIVE SW \_\_\_\_\_