

8 1 9805

SEQUENCE NO. (MDE USE ONLY)

STATE OF MARYLAND APPLICATION FOR PERMIT TO DRILL WELL

please type

STATE PERMIT NUMBER

HO-95-1566

fill in this form completely

Date Received (APA)

3/4/08

OWNER INFORMATION

BABA'S of Howard County
Last Name: BABA'S, Owner: John Hopkins, First Name: R.D., Street or RFD: Clarksville Md 21029, Town: Clarksville, State: Md, Zip: 21029

B 3

LOCATION OF WELL

Howard County, Hopkins Mead, Section 1, Lot 8+9, Fulton, Nearest Town, Miles from town 3 1/2

DRILLER INFORMATION

Joseph L Mayne, M S D 024, License No. 76, Firm Name: Joseph L Mayne Well Drilling, Address: 5512 Ridge Rd Mt. Airy Md 21771, Signature: Joseph L Mayne, Date: 3-4-2009

B 4

Direction of well from town (circle box), On which side of road (circle appropriate box), Distance from road, Tax map: 41, Blk: 8, Parcel: 195

B 2

WELL INFORMATION

Approx. pumping rate: 4 gal per min, Average daily quantity needed: 500 gal per day

USE FOR WATER (circle appropriate box)

- Domestic Potable Supply & Residential Irrigation, Farming (Livestock Watering & Agricultural Irrigation), Industrial, Commercial, Dewatering, Public Water Supply Well, Test, Observation, Monitoring, Geo-Thermal

NOT TO BE FILLED IN BY DRILLER HEALTH DEPARTMENT APPROVAL

Howard County, P45569, State Signature: Brian Baker, Date Issued: 3/4/2008, Exp. Date: 3/4/2009, North Grid: 486 000, East Grid: 824 000

Approximate depth of well: 300 feet

Approximate diameter of well: 6 inches, Nearest inch

METHOD OF DRILLING (circle one)

Bored (or Augered), Jetted & Driven, Air-Rotary, Air-PerCussion, Rotary (Hydraulic Rotary), Cable, Reverse-Rotary, Drive-Point

REPLACEMENT OR DEEPEMED WELLS (circle appropriate box)

- This well will not replace an existing well, This well will replace a well that will be abandoned and sealed, This well will replace a well that will be used as a standby-contact local approving authority for policy on standby wells, This well will deepen an existing well

Permit number of well to be replaced or deepened (if available): 41

Not to be filled in by driller (MDE or county use only)

Approp. permit number: G, Permit No: HO-95-1566

SPECIAL CONDITIONS

NOTE: APPROVING AUTHORITIES SHOULD USE SEPARATE SHEET IF NEEDED

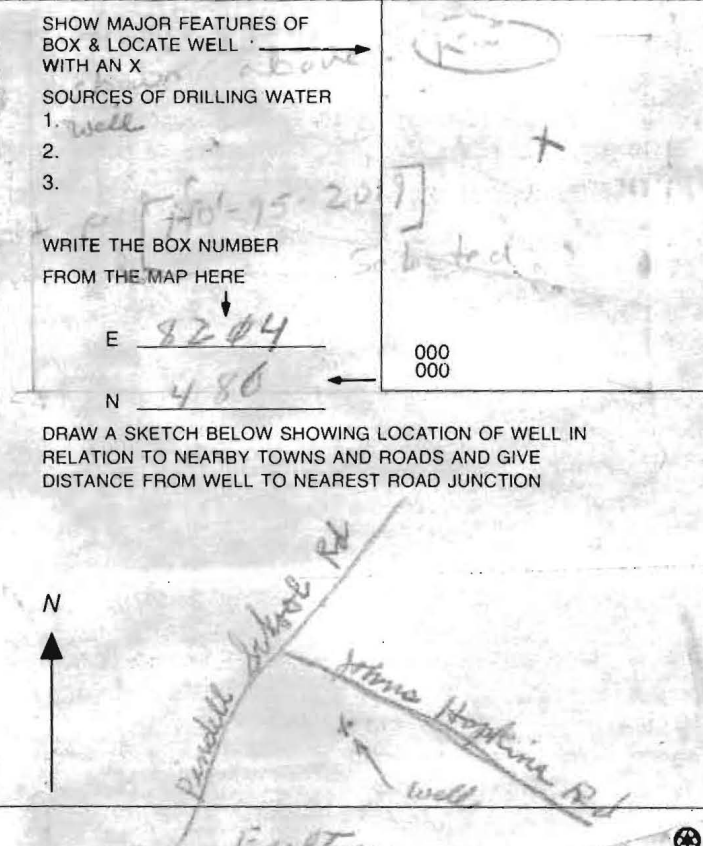

SITE INSPECTION SHEET

OWNER: Church of the Baha'is PHONE #: \_\_\_\_\_  
ADDRESS: 11517 Johns Hopkins Rd. CONTRACTOR: J. Mayne  
WELL TAG #: 95-1566  
SUBDIVISION: Hopkins Meade LOT: 849 COUNTY #: \_\_\_\_\_  
PROPOSAL: Replacement Well

LOCATION DIAGRAM

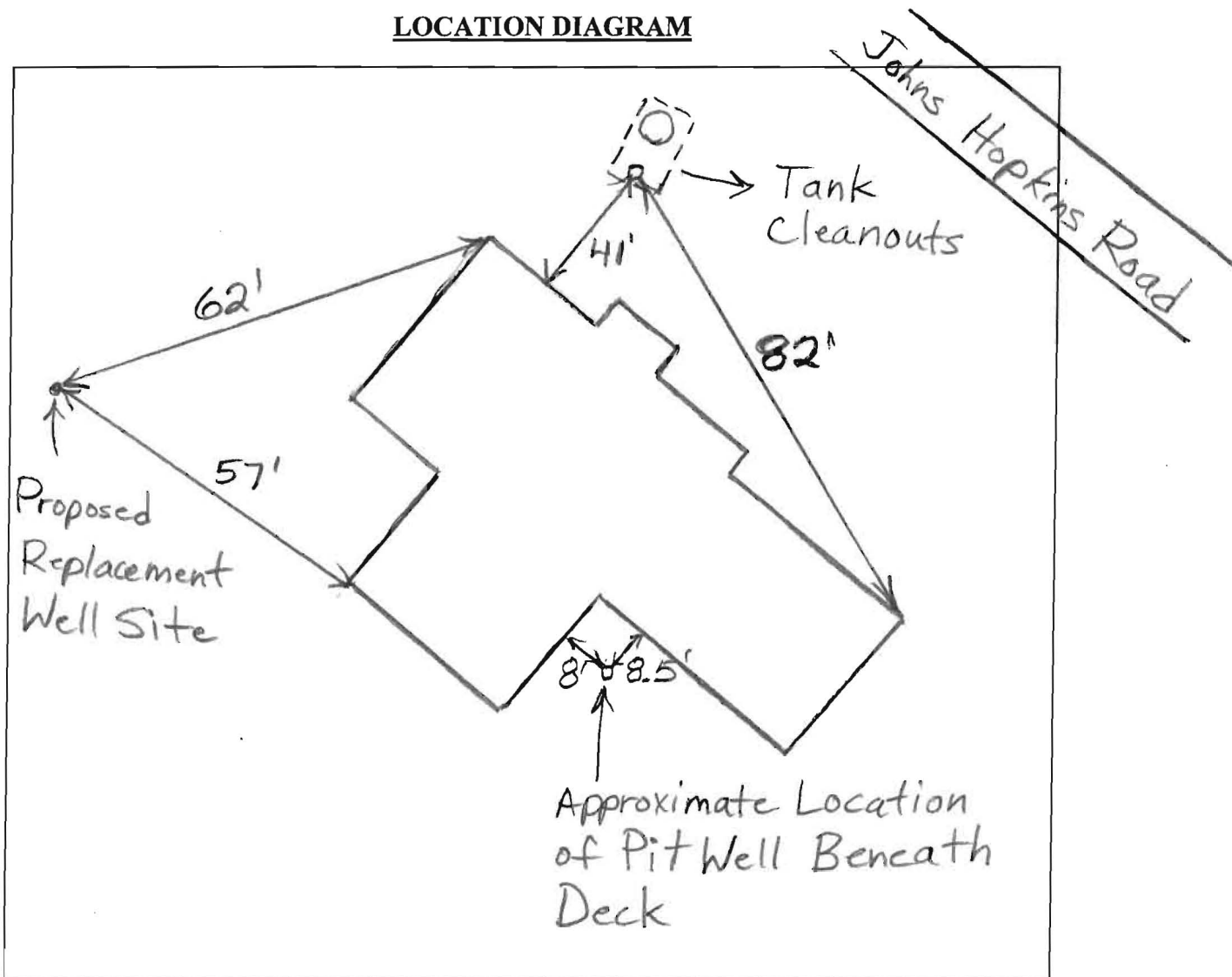

COMMENTS: Site Above Chosen  
10/18/10 New Well Permit per. for. [140-95-2019] Selected  
location from 3/4/08 shown above. (kw)

DATE: 3/4/08 INSPECTOR: B. Baker

FROM

**Memo**

**JOSEPH L. MAYNE WELL DRILLING**

---

12-30-2008

Please cancel permit.

Joe Mayne

check commercial files

Joe  
P 22687 + P 45569

05347912