

LAYOUT 1/23/08 INSP 4 \_\_\_\_\_  
INSP 2 1/24/08 INSP 5 \_\_\_\_\_  
INSP 3 \_\_\_\_\_ INSP 6 \_\_\_\_\_

ISSUE DATE: 01/04/08

P Upgrade 528430

APPROVAL DATE: 1/24/08

**PERMIT**  
*Logged Into Permit Manager*  
TAX ID # 05-362946

A 527330

**ON-SITE SEWAGE DISPOSAL SYSTEM  
HOWARD COUNTY HEALTH DEPARTMENT  
BUREAU OF ENVIRONMENTAL HEALTH**

Hatfields Equipment IS PERMITTED TO INSTALL  ALTER

ADDRESS: P.O. Box 519 Annapolis Junction PHONE NUMBER: 301-854-6172

SUBDIVISION: Cabin Hill LOT NUMBER: 3

ADDRESS: 12909 Kentbury Dr PROPERTY OWNER: Debra Wilson

SEPTIC TANK CAPACITY (GALLONS): 1500 OUTLET BAFFLE FILTER REQUIRED

PUMP CHAMBER CAPACITY (GALLONS): \_\_\_\_\_ COMPARTMENTED TANK REQUIRED

NUMBER OF BEDROOMS: 5

SQUARE FEET PER BEDROOM: \_\_\_\_\_

LINEAR FEET OF TRENCH REQUIRED: 135

TRENCHES:	Trench to be 2.0 feet wide. Inlet 5.0 feet below original grade. Bottom maximum depth 11.0 feet below original grade. Effective area begins at 7.0 feet below original grade. 6.0 feet of stone below distribution pipe.
LOCATION:	1) Install 3 new trenches as follows: A 50' trench along 10' setback to west property line; a 45' trench on 8' center from 1 <sup>st</sup> trench; a 40' trench on 8' center from existing repair trench. 2) Set 1000' gal septic tank in line with existing tank. 3) Set distribution box at best location, between septic tanks & drywell.
NOTES:	1) Hand dig under BG&E service line, Verizon line and Comcast line, to install effluent line. 2) Abandon existing dry well.

PLANS APPROVED: Robert Bricker DATE: 11/16/07

- NOTE: PERMIT VOID AFTER 2 YEARS
- NOTE: CONTRACTOR RESPONSIBLE FOR SCHEDULING A PRE-CONSTRUCTION INSPECTION FOR ALL INSTALLATIONS
- NOTE: WATERTIGHT SEPTIC TANKS REQUIRED
- NOTE: ALL PARTS OF SEPTIC SYSTEM SHALL BE 100 FEET FROM ANY WATER WELL
- NOTE: MANHOLE RISERS REQUIRED ON ALL SEPTIC TANKS AND PUMP CHAMBERS UNLESS SPECIFICALLY AUTHORIZED

**NEITHER THE HOWARD COUNTY COUNCIL NOR THE HEALTH DEPARTMENT IS  
RESPONSIBLE FOR THE SUCCESSFUL OPERATION OF ANY SYSTEM  
PERMITTEE RESPONSIBLE FOR OBTAINING FINAL APPROVAL ON THIS PERMIT  
CALL 410-313-1771 FOR INSPECTION OF SEPTIC SYSTEM**

NOT TO SCALE

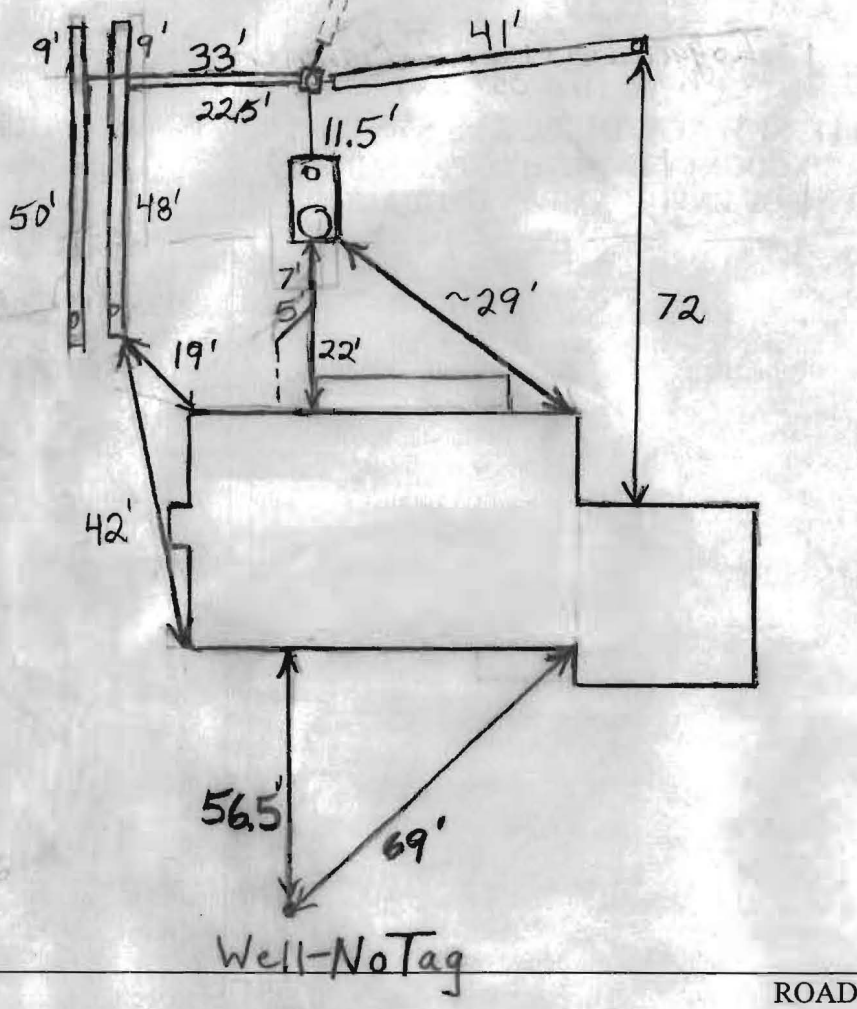

TRENCH/DRAINFIELD DATA		
WIDTH	INLET	BOTTOM
2'	5'	11'
NUMBER OF TRENCHES 3		
TOTAL LENGTH 139'		
ABSORPTION AREA 556		
DISTRIBUTION BOX LEVEL Levelers		
DISTRIBUTION BOX BAFFLE Yes		
DISTRIBUTION BOX PORT Yes		

SEPTIC TANK DATA	
SEPTIC TANK 1 LEVEL	Yes
CAPACITY	1500 GAL
SEAM LOC	Top
TANK LID DEPTH	3.5'-4'
BAFFLES	Yes
BAFFLE FILTER	No
MANHOLE LOC	Front
6" PORT LOC	Rear
WATERTIGHT TEST	No
SEPTIC TANK 2 LEVEL	N/A
CAPACITY	_____ GAL
SEAM LOC	_____
TANK LID DEPTH	_____
BAFFLES	_____
BAFFLE FILTER	_____
MANHOLE LOC	_____
6" PORT LOC	_____
WATERTIGHT TEST	_____

PRE-CONSTRUCTION 1/23/08 New 1500 gallon tank installed. Old tank pumped out and filled in along with drywell.

INSTALLATION O.K. to use T fittings in trenches. Install as per plan (PB)

1/24/08 Trenches installed. Everything finished. O.K. to backfill (PB)

FINAL INSPECTOR B. Baker DATE OF APPROVAL 1/24/08

Mac BERN 7

50' E/W

7178 Gateway Drive

Valley

410-313-2640

N48°39'02"E 125'00"

Sewer Cleanout 53' +/-

Well 57' +/-

LOT #4

LOT #3 Block "B"

N41°20'58" W

S41°20'58" E

5' UTILITY EASEMENT

S28°18'36" W 133.51'

Approved Septic System Plan  
Howard County Health Department

Additions approved as shown  
(2-story at side of orig. split-level)

R. Buehler 1/29/2008

Signature Date



4-12-93

THIS IS TO CERTIFY That The Improvements Indicated Hereon Are Located As Shown. This Is Not A Property Line Survey And Should Not Be Used As Such.

THE LOT SHOWN HEREON IS IN FLOOD ZONE \_\_\_\_\_ PER F.E.M.A. FLOOD INSURANCE RATE MAP PANEL # 24221

PC 527330

Re: request for Variance

To Mr Michael J Davis

Well & Septic Program Supervisor

I am requesting avariance for the set back distance of a septic system trench to a well. The distance is 96 feet between the "repair" trench, while the required distance is 100 ft. The distance is between the repair trench (connected to my dry well) installed in 1982, and a second well drilled at 12910 Kentbury Drive in 1990.

Thank you.

 11/15/07  
Deborah Thatcher Wilson