

LAYOUT 1/8/10 INSP 4 1/20/10  
 INSP 2 1/15/10 INSP 5 \_\_\_\_\_  
 INSP 3 1/19/10 INSP 6 \_\_\_\_\_

ISSUE DATE: 1/4/2010  
 APPROVAL DATE: 1/20/10

# PERMIT

*(log seal and put date)*

P 532490  
 A \_\_\_\_\_

Tax ID # 05372283

**ON-SITE SEWAGE DISPOSAL SYSTEM  
 HOWARD COUNTY HEALTH DEPARTMENT  
 BUREAU OF ENVIRONMENTAL HEALTH**

Eoin O'Colman

IS PERMITTED TO INSTALL  ALTER

ADDRESS: \_\_\_\_\_ PHONE NUMBER: 301-854-2533  
*Eoin O'Colman 410-465-2503*

SUBDIVISION: Aintree Estates LOT NUMBER: 7

ADDRESS: 6276 Linkythorn Lane PROPERTY OWNER: Ryan and Farrah O'Colman

SEPTIC TANK CAPACITY (GALLONS): 1500 OUTLET BAFFLE FILTER REQUIRED

PUMP CHAMBER CAPACITY (GALLONS): \_\_\_\_\_ COMPARTMENTED TANK REQUIRED

NUMBER OF BEDROOMS: 3 APPLICATION RATE: 1.2

SQUARE FOOTAGE OF HOUSE: 3000

LINEAR FEET OF TRENCH REQUIRED: 124

TRENCHES:	Trenches to be 2.0 feet wide. Inlet 2.0 feet below original grade. Bottom maximum depth 3.5 feet below grade. Effective area begins at 2.0 feet below original grade with 1.5 feet of stone below distribution pipe.
LOCATION:	Set distribution box per layout inspection. Install 1x60 and 1x64' trenches in southwest corner off septic easement. Set 1500 gallon septic tank per layout inspection.
NOTES:	Stake septic easement corners. Call for layout inspection. Mark utilities. Gravel tickets must be available for Environmental Sanitarians. Stone must be approved by the Howard County Health Department. PUMP AND ABANDON EXISTING TANK AND 2 DRY WELLS.

PLANS APPROVED: Robert Bricker DATE: 1/4/10

- NOTE: PERMIT VOID AFTER 2 YEARS
- NOTE: CONTRACTOR RESPONSIBLE FOR SCHEDULING A PRE-CONSTRUCTION INSPECTION FOR ALL INSTALLATIONS
- NOTE: WATERTIGHT SEPTIC TANKS REQUIRED
- NOTE: ALL PARTS OF SEPTIC SYSTEM SHALL BE 100 FEET FROM ANY WATER WELL
- NOTE: MANHOLE RISERS REQUIRED ON ALL SEPTIC TANKS AND PUMP CHAMBERS

**NEITHER THE HOWARD COUNTY COUNCIL OR THE HEALTH DEPARTMENT IS RESPONSIBLE FOR THE SUCCESSFUL OPERATION OF ANY SYSTEM PERMITTEE RESPONSIBLE FOR OBTAINING FINAL APPROVAL ON THIS PERMIT CALL 410-313-1771 FOR INSPECTION OF SEPTIC SYSTEM**

Ex. Well (No Tag)

NOT TO SCALE

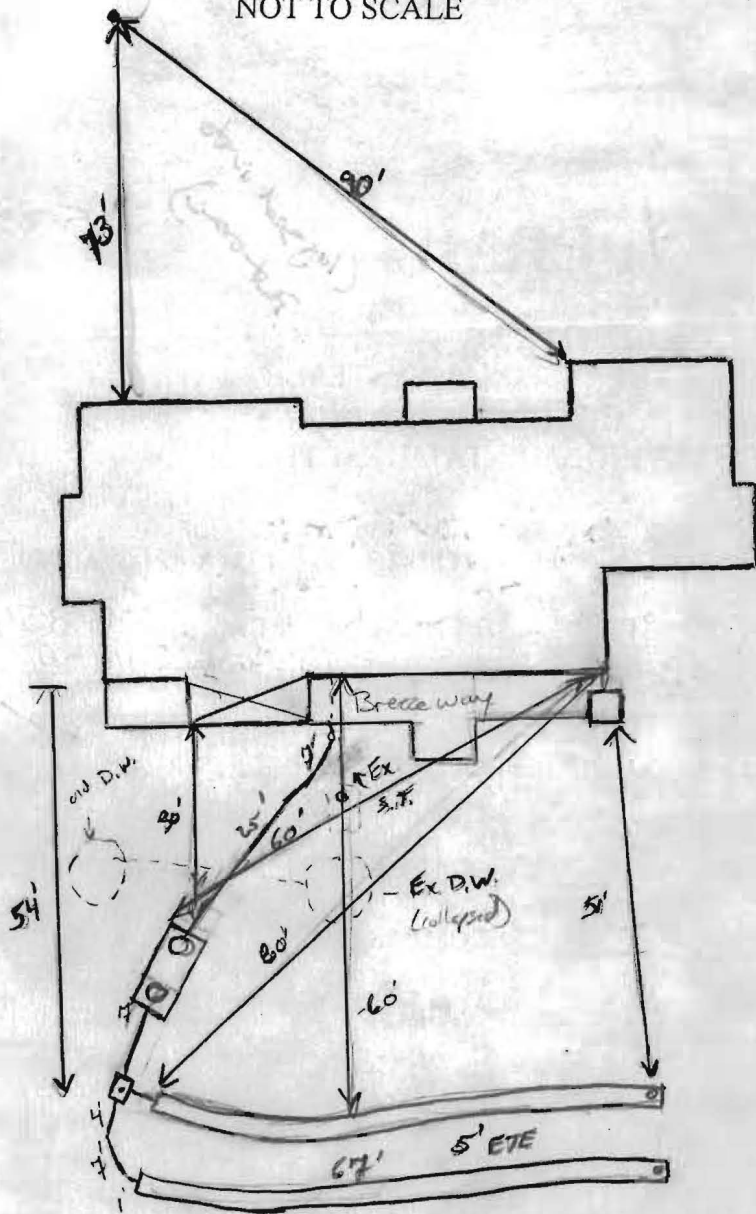

**TRENCH/DRAINFIELD DATA**

WIDTH	INLET	BOTTOM
2'	2'	3.5'
NUMBER OF TRENCHES		2
TOTAL LENGTH		
ABSORPTION AREA		
DISTRIBUTION BOX LEVEL		Level
DISTRIBUTION BOX BAFFLE		Yes
DISTRIBUTION BOX PORT		Yes

**SEPTIC TANK DATA**

SEPTIC TANK 1 LEVEL	Yes
MANUFACTURER	Major Bros
CAPACITY	1500 GAL
SEAM LOC	Top
TANK LID DEPTH	1.5'-2.5'
BAFFLES	Yes
BAFFLE FILTER	
MANHOLE LOC	Front / Rear
6" PORT LOC	None
WATERTIGHT TEST	N/A
SLOTTED	Yes

**PUMP/SEPTIC TANK LEVEL**

MANUFACTURER	
CAPACITY	
SEAM LOC	
TANK LID DEPTH	
BAFFLES	
BAFFLE FILTER	
MANHOLE LOC	
6" PORT LOC	
WATERTIGHT TEST	
SLOTTED	

**PRE-CONSTRUCTION**

1/8/10 Partial layout given. To be completed after snow has melted. (BB)

1/15/2010 No one on site.

Install trenches as Robert has them marked on plan. Top 60' trench and lower 60' trench. Install tank near

**INSTALLATION:**

where shown on plan in red. Located and flagged top trench location on site. Called Darland and told him. He said there could be a drywell that will be in the way. (BB) 1/19/10 Tank set a little further downhill due to D.W. loc. Lower trench installed. Top trench dig. Told contractor to use filter cloth non-woven mat silt fence fabric. (KW) 1/20/10. System complete. Horse connection made. Both D.W. purged and collapsed. OK to cover all work (BB)

FINAL INSPECTOR

K. Warf

DATE OF APPROVAL

1/20/10

SITE INSPECTION SHEET

OWNER: Ryan & Farrah O'Colman PHONE #: \_\_\_\_\_  
 ADDRESS: 6276 Linkythorn Lane CONTRACTOR: \_\_\_\_\_  
Clarksville 21029 WELL TAG #: \_\_\_\_\_  
 SUBDIVISION: Aintree Est. LOT: 7 COUNTY #: Howard  
 PROPOSAL: <sup>ex</sup> 4 BR - SFD. Addition for

LOCATION DIAGRAM

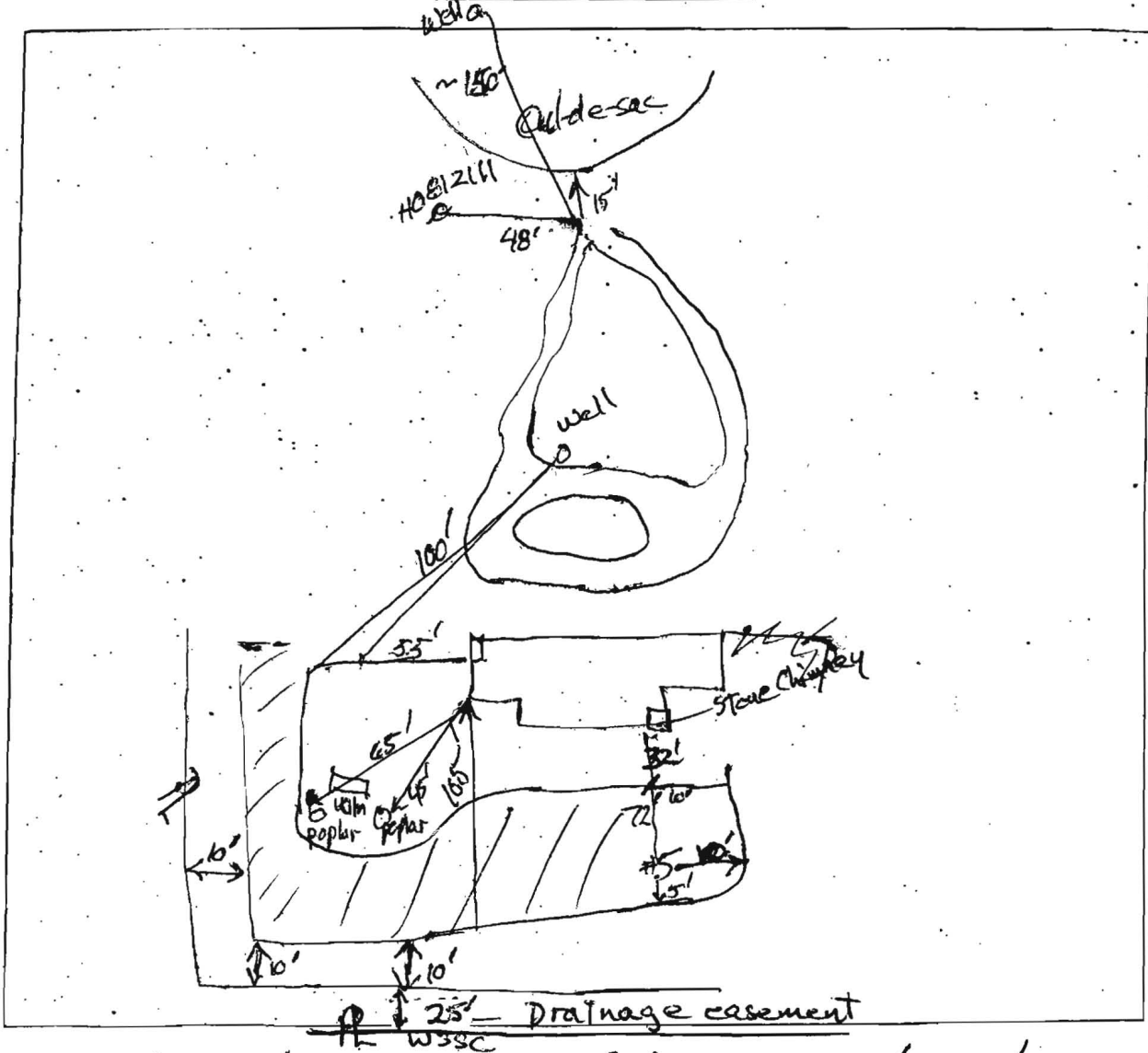

COMMENTS: Sewer line at proposed footer is ~3.0' to 3.5'  
Gravity flow to septic Tank & box & 1<sup>ST</sup> Repair, no problem  
Old dry wells have cinder block walls; one has failed, the other was not checked

