

PUBLIC SEWER STATUS VERIFIED BY

ISSUE DATE:

12/20/12

PERMIT

P

544429

APPROVAL DATE:

10/1/13

A

REPAIR

Septic Repair

**ON-SITE SEWAGE DISPOSAL SYSTEM
HOWARD COUNTY HEALTH DEPARTMENT
BUREAU OF ENVIRONMENTAL HEALTH**

Hatfields

IS PERMITTED TO INSTALL ALTER

ADDRESS: PO box 519 Annapolis Jctn, MD 20701

PHONE NUMBER: 410-984-0047

SUBDIVISION: _____

LOT NUMBER: _____

ADDRESS: 2698 Jennings Chapel Road

PROPERTY OWNER: Eugene Freeze

SEPTIC TANK CAPACITY (GALLONS): 2000

Need to have a layout inspection

PUMP CHAMBER CAPACITY (GALLONS): N/A

NUMBER OF BEDROOMS: 3

SQUARE FEET OF HOUSE: _____

LINEAR FEET OF TRENCH REQUIRED: 82 LF

Aprx. 50ton #2 stone

TRENCHES:	Trenches to be <u>2</u> feet wide. Inlet <u>3</u> feet below original grade. Bottom maximum depth <u>8</u> feet below grade. Effective area begins at <u>5</u> feet below original grade with <u>5</u> feet of stone below distribution pipe.
LOCATION:	Septic tank to be set downhill aprx. 75' off of house. Install 2x41' trenches just above perc hole #A on contour running away from ex. drive.
NOTES:	S.T. and Drywell must be pumped and collapsed. Obs. pipes at ends of trenches are required. Manhole access required on ex. septic tank. System sized for 3 BR. Soil Rates can be designed for 4 Bedrooms as follows: Linear feet required: 110 LF. Trench specs remain the same as above. Install 2x55' trenches on contour. Need layout. This system requires aprx. 67ton #2 stone.

PLANS APPROVED: K. Wolf

DATE: 12/19/2012

NOTE: PERMIT VOID AFTER 2 YEARS

NOTE: CONTRACTOR RESPONSIBLE FOR SCHEDULING A PRE-CONSTRUCTION INSPECTION FOR ALL INSTALLATIONS

NOTE: WATERTIGHT SEPTIC TANKS REQUIRED

NOTE: ALL PARTS OF SEPTIC SYSTEM SHALL BE 100 FEET FROM ANY WATER WELL

NOTE: MANHOLE RISERS REQUIRED ON ALL SEPTIC TANKS AND PUMP CHAMBERS

NOTE: AN ELECTRICAL PERMIT IS REQUIRED FOR INSTALLATION OF ANY ELECTRICAL COMPONENTS OF THE SYSTEM

NEITHER THE HOWARD COUNTY COUNCIL OR THE HEALTH DEPARTMENT IS RESPONSIBLE FOR THE SUCCESSFUL OPERATION OF ANY SYSTEM PERMITTEE RESPONSIBLE FOR OBTAINING FINAL APPROVAL ON THIS PERMIT CALL 410-313-1771 FOR INSPECTION OF SEPTIC SYSTEM

NOT TO SCALE

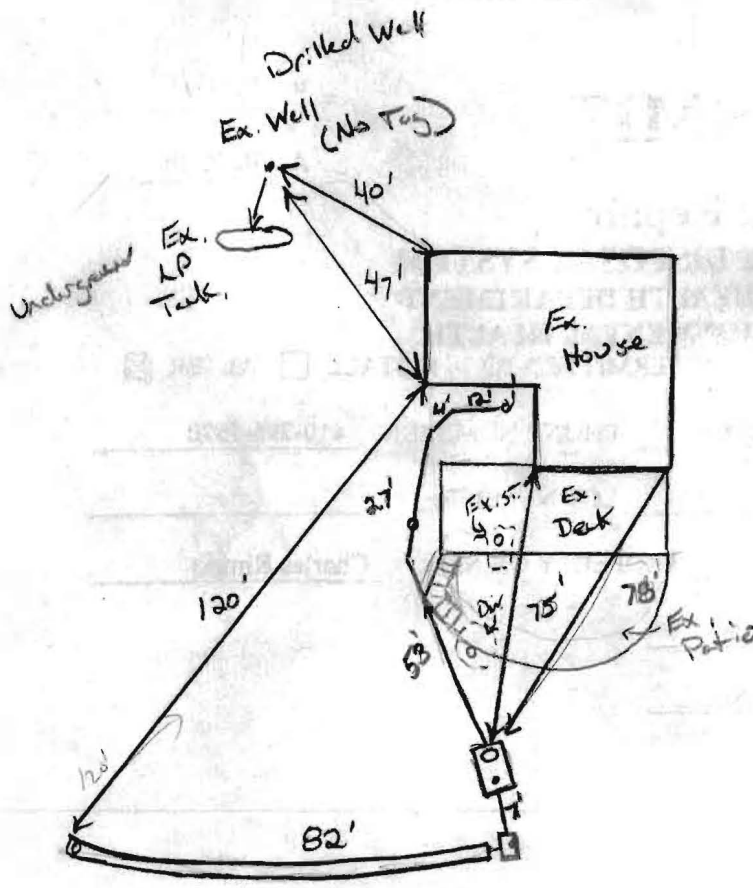

TRENCH/DRAINFIELD DATA		
WIDTH	INLET	BOTTOM
2'	3'	8'
NUMBER OF TRENCHES		1
TOTAL LENGTH		82'
ABSORPTION AREA		164'±SW
DISTRIBUTION BOX LEVEL		Yes
DISTRIBUTION BOX BAFFLE		Yes
DISTRIBUTION BOX PORT		Yes

SEPTIC TANK DATA	
SEPTIC TANK I LEVEL	Yes
MANUFACTURER	Babylon
CAPACITY	2000 GAL
SEAM LOC	Top
TANK LID DEPTH	2'
BAFFLES	Yes
BAFFLE FILTER	-
MANHOLE LOC	Front
6" PORT LOC	Rear
WATERTIGHT TEST	-
SLOTTED	Yes
DATE ON LID	
PUMP/SEPTIC TANK LEVEL NA	
MANUFACTURER	
CAPACITY	GAL
SEAM LOC	
TANK LID DEPTH	
BAFFLES	
BAFFLE FILTER	
MANHOLE LOC	
6" PORT LOC	
WATERTIGHT TEST	
SLOTTED	
DATE ON LID	

ROAD NAME

PRE-CONSTRUCTION:

9/23/13 Contour shot in field. OK to install 1x82' trench just above parcel hole A. set new s.t. just above new D box in open area. Plenty room to rework system as needed. (pud)

INSTALLATION:

9/26/13 system complete. Ex Dry well and S.T. pumped. Needs to be collapsed. (pud) 10/1/13 Ex. S.T. and Dry well pumped/collapsed.

FINAL INSPECTOR

J. K. Waff

DATE OF APPROVAL

10/1/13