

# APPLICATION

PERCOLATION TESTING

A 49655

P \_\_\_\_\_

HOWARD COUNTY HEALTH DEPARTMENT  
BUREAU OF ENVIRONMENTAL HEALTH  
3525-H ELLICOTT MILLS DRIVE/ELLICOTT CITY, MARYLAND 21043  
TELEPHONE: 313-2640

DISTRICT 2ND

DATE 10/1/93

TO: THE COUNTY HEALTH OFFICER  
ELLICOTT CITY, MARYLAND

I HEREBY APPLY FOR THE NECESSARY TEST PRIOR TO APPLICATION FOR PERMIT TO CONSTRUCT (OR RECONSTRUCT) A SEWAGE DISPOSAL SYSTEM.

PROPERTY OWNER ROBERT J. BYRD APT

ADDRESS 12290 GREEN MEADOW DR #515 PHONE (410) 740 1193

AGENT OR PROSPECTIVE BUYER COLUMBIA SMP SAME (21044)

ADDRESS \_\_\_\_\_ PHONE \_\_\_\_\_

PROPERTY LOCATION:

SUBDIVISION BURLEIGH MANOR LOT NO. 707

ROAD AND DESCRIPTION 10413 KINGSBRIDGE ROAD

TAX MAP \_\_\_\_\_ PARCEL # \_\_\_\_\_

SIZE OF LOT \_\_\_\_\_ TYPE BLDG. \_\_\_\_\_  
(SINGLE FAMILY DWELLING OR COMMERCIAL)

THE SYSTEM INSTALLED UNDER THIS APPLICATION IS ACCEPTABLE ONLY UNTIL PUBLIC FACILITIES BECOME AVAILABLE. I FULLY UNDERSTAND THE FEE CONNECTED WITH THE FILING OF THIS PERC TEST APPLICATION IS NON-REFUNDABLE UNDER ANY CIRCUMSTANCES. I ALSO AGREE TO COMPLY WITH ALL M.O.S.H.A. REQUIREMENTS IN TESTING THIS LOT.

Robert J Byrd  
(SIGNATURE OF APPLICANT)

APPROVED BY \_\_\_\_\_ FOR \_\_\_\_\_ DATE \_\_\_\_\_

DISAPPROVED BY \_\_\_\_\_ FOR \_\_\_\_\_ DATE \_\_\_\_\_

HOLD PENDING FURTHER TESTS \_\_\_\_\_

REASONS FOR REJECTION OR HOLDING 10/22/93 2 Perc Holes out of 3 O/C

PERCOLATION TEST PLAT/PRELIMINARY PLAT - TITLE OR I.D. # \_\_\_\_\_ DATE \_\_\_\_\_  
owner must submit perc cert/plat

SITE DEVELOPMENT PLAN/FINAL PLAT - TITLE OR I.D. # \_\_\_\_\_ DATE \_\_\_\_\_

# THIS IS NOT A PERMIT

COUNTY #

SOIL PROFILE

0' **①**  
 BROWN CLAY  
 3' SAND & CLAY  
 5' WHITE SAND SILT LOAM

13 1/2

0' **②**  
 TOPSOIL BROWN CLAY  
 5' BROWN CLAY SAND SILT LOAM

14

0' **③**  
 BROWN CLAY TOPSOIL  
 3' BEIGE SAND SILT LOAM

13

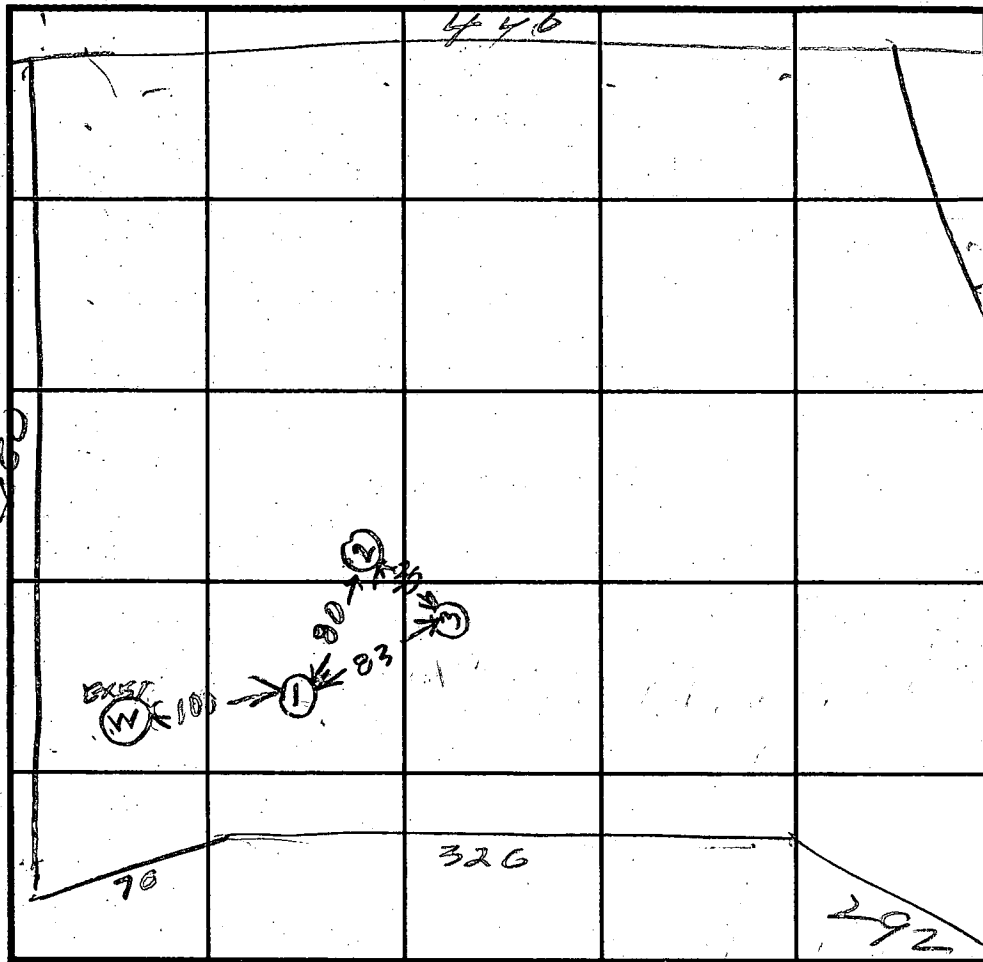

SOIL PROFILE

0' **④**

INDICATE NORTH - NAME ADJOINING ROADWAY AS BASE LINE.

DATE	TEST NO.	DEPTH	PRE-WET		TEST - 1" DROP		TIME
			START	STOP	START	STOP	
10/22/93	1S	4	1047	1107	1107	enter per	4
	1M	9.5	1101	1104	1104	1108	
	1V	13 1/2					
	2S	4 1/2	1055	1040	1st inch	FAIL	
	2D	9	1053	1040	1st inch	FAIL	
	2V	14	FAIL	SCOWPBR			
	3D	8 1/2	1209	1211	1211	1217	6
	3S	4	1209	1212	1212	1217	5
	3	13	O/K				

REMARKS \_\_\_\_\_  
 TYPE OF SOIL \_\_\_\_\_  
 TESTED BY \_\_\_\_\_ ALSO PRESENT \_\_\_\_\_  
 TRENCH DESIGN DATA: AVERAGE PERCOLATION TIME \_\_\_\_\_ TRENCH WIDTH \_\_\_\_\_  
 INLET DEPTH \_\_\_\_\_ MAXIMUM BOTTOM DEPTH \_\_\_\_\_ SQ. FT./BEDROOM \_\_\_\_\_