

APPLICATION

PERCOLATION TESTING

A 518543

P _____

HOWARD COUNTY HEALTH DEPARTMENT
BUREAU OF ENVIRONMENTAL HEALTH
3525-H ELLICOTT MILLS DRIVE/ELLICOTT CITY, MARYLAND 21043
TELEPHONE: 313-2640

DISTRICT _____

DATE 2/12/2003

TO: THE COUNTY HEALTH OFFICER
ELLICOTT CITY, MARYLAND

I HEREBY APPLY FOR THE NECESSARY TEST PRIOR TO APPLICATION FOR PERMIT TO CONSTRUCT (OR RECONSTRUCT) A SEWAGE DISPOSAL SYSTEM.

PROPERTY OWNER The Estate of Elizabeth Smith c/o Charles Slade, Personal Representative

ADDRESS 10450 Shaker Dr., Ste 112 Columbia, MD 21046 PHONE _____

AGENT OR PROSPECTIVE BUYER MacBeth Farm, LLC

ADDRESS 8808 Centre Pk. Dr., Ste 209 Columbia, MD 21045 PHONE 410.964.5522

PROPERTY LOCATION:

SUBDIVISION MacBeth Farm LOT NO. 11

ROAD AND DESCRIPTION MD Rt. 108 Clarksville, MD- Approximately 1 mile south of the Guilford Rd./
Rt. 108 intersection

TAX MAP 34 PARCEL # p/o 90

SIZE OF LOT 1 Acre TYPE BLDG. Single Family Dwelling
(SINGLE FAMILY DWELLING OR COMMERCIAL)

THE SYSTEM INSTALLED UNDER THIS APPLICATION IS ACCEPTABLE ONLY UNTIL PUBLIC FACILITIES BECOME AVAILABLE. I FULLY UNDERSTAND THE FEE CONNECTED WITH THE FILING OF THIS PERC TEST APPLICATION IS NON-REFUNDABLE UNDER ANY CIRCUMSTANCES. I ALSO AGREE TO COMPLY WITH ALL M.O.S.H.A. REQUIREMENTS IN TESTING THIS LOT.

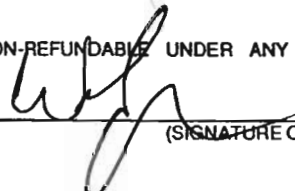

(SIGNATURE OF APPLICANT)

APPROVED BY _____ FOR _____ DATE _____

DISAPPROVED BY _____ FOR _____ DATE _____

HOLD PENDING FURTHER TESTS _____

REASONS FOR REJECTION OR HOLDING _____

PERCOLATION TEST PLAT/PRELIMINARY PLAT - TITLE OR I.D. # _____ DATE _____

SITE DEVELOPMENT PLAN/FINAL PLAT - TITLE OR I.D. # _____ DATE _____

THIS IS NOT A PERMIT

COUNTY #

SOIL PROFILE

0' 702
Brown Sil

1 gravelly orange brown SCL

2 orange brown micaceous L

4 1/2 fine yellow brown micaceous SL

14

703

1 Brown Sil

orange brown micaceous SCL

3 orange brown micaceous L

4 fine yellow brown SL

14

710

2 Brown SCL

orange brown L

3 yellow brown micaceous LS/SL

14

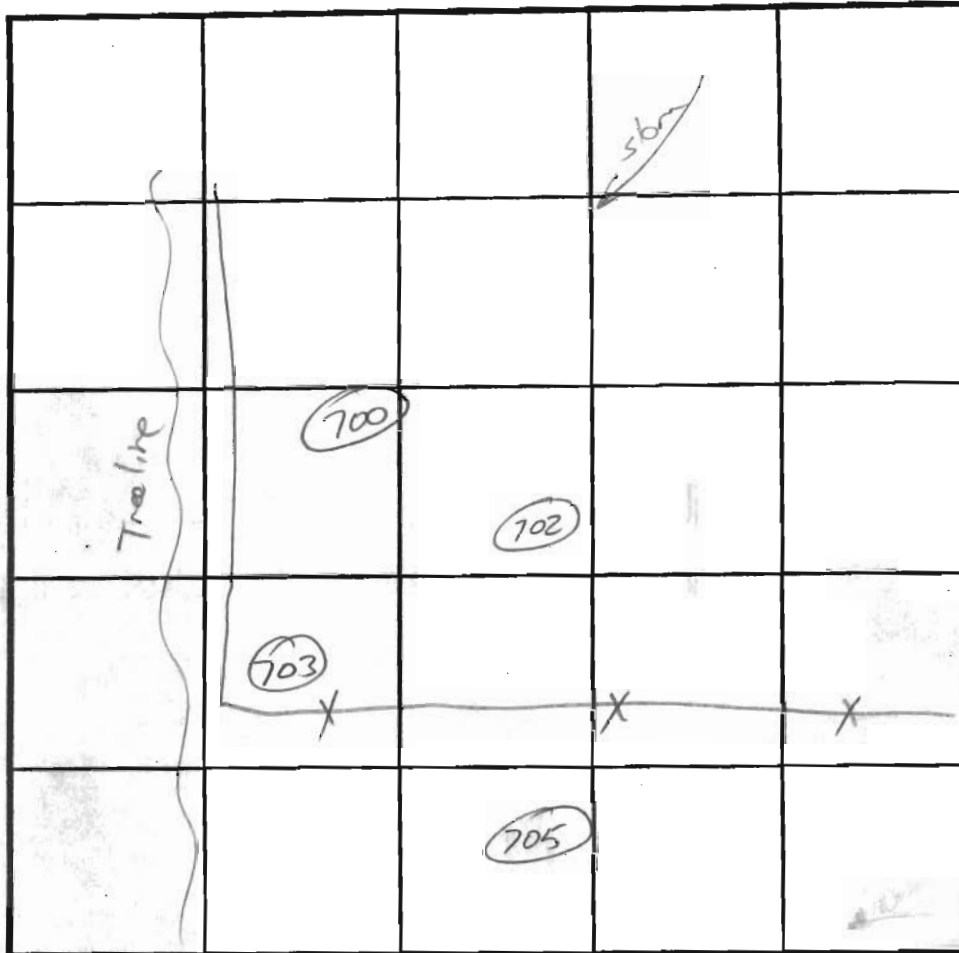

SOIL PROFILE 705

0' Brown Sil

1 orange brown micaceous L

4 1/2 yellow brown fine micaceous SL

14

INDICATE NORTH - NAME ADJOINING ROADWAY AS BASE LINE.

DATE	TEST NO.	DEPTH	PRE-WET		TEST - 1" DROP		TIME
			START	STOP	START	STOP	
5/29/03	702	6 14	9:48	9:50	9:50	9:53	3
	703	5 14	9:57	9:59	9:59	10:03	4
	700	5 14	10:09	10:10	10:10	10:12	2
	705	5 14	10:24	10:26	10:26	10:28	2

REMARKS _____

TYPE OF SOIL _____

TESTED BY _____ ALSO PRESENT _____

TRENCH DESIGN DATA: AVERAGE PERCOLATION TIME _____ TRENCH WIDTH _____

INLET DEPTH _____ MAXIMUM BOTTOM DEPTH _____ SQ. FT./BEDROOM _____

COUNTY #

SOIL PROFILE

0' 704
 Brown
 SIL

1' gravelly
 orange
 brown
 SCL

6 1/2' yellow
 brown
 SL w/
 patches
 of white gravelly
 SIL

SOIL PROFILE

0'

INDICATE NORTH - NAME ADJOINING ROADWAY AS BASE LINE.

DATE	TEST NO.	DEPTH	PRE-WET		TEST - 1" DROP		TIME
			START	STOP	START	STOP	
5/29/02	704	7 14	10:56	10:59	10:59	11:04	5

REMARKS _____

TYPE OF SOIL _____

TESTED BY _____ ALSO PRESENT _____

TRENCH DESIGN DATA: AVERAGE PERCOLATION TIME _____ TRENCH WIDTH _____

INLET DEPTH _____ MAXIMUM BOTTOM DEPTH _____ SQ FT/BEDROOM _____

COUNTY #

SOIL PROFILE

0' 708
Orange brown SIL
2' Orange brown SIL w/ 15-20% coarse cherty frags
4' fine brown micaceous SL
13'

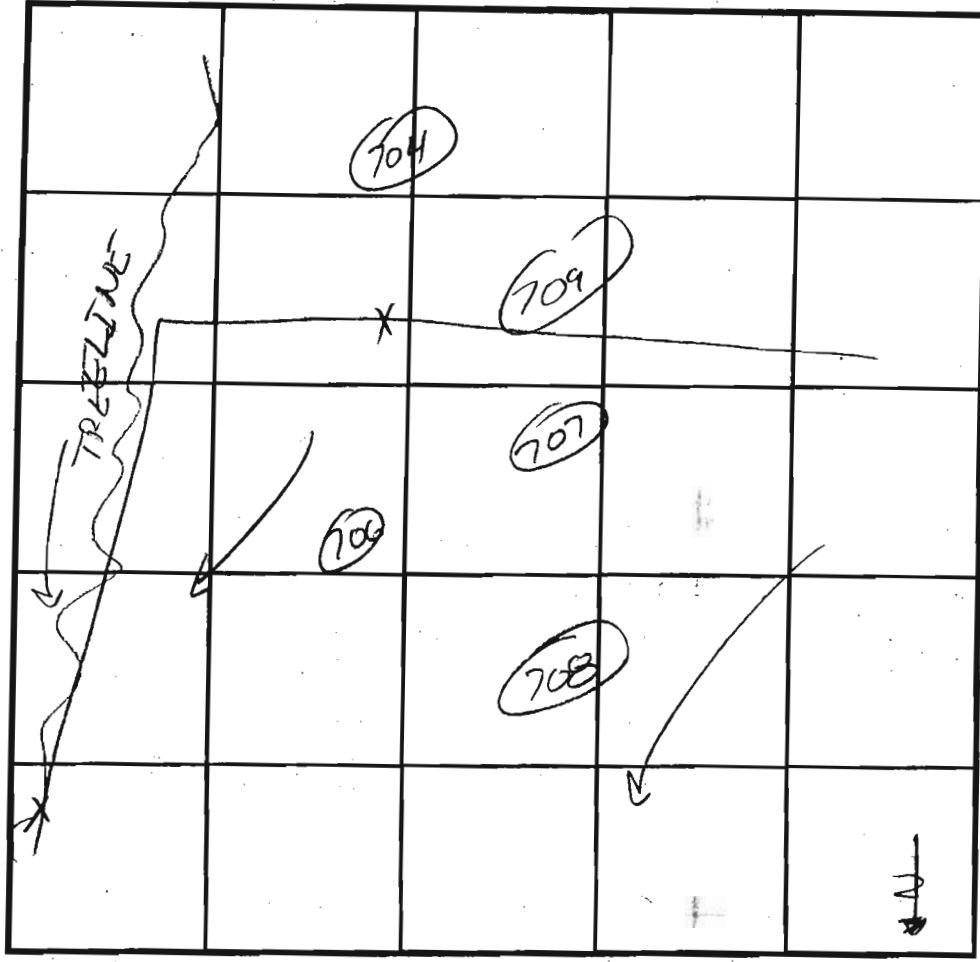

SOIL PROFILE

0' 706
Brown SIL
1' Orange brown SIL
3' Orange brown micaceous L
4' fine orange brown
↓ SL
yellow brown
13'

INDICATE NORTH - NAME ADJOINING ROADWAY AS BASE LINE.

DATE	TEST NO.	DEPTH	PRE-WET		TEST - 1" DROP		TIME
			START	STOP	START	STOP	
5/1/03	708	5 1/2 13	2:09:00	2:10:15	2:10:15	2:13:30	3:15 ok
5/29/03	709	7 13	9:36	9:37	9:37	9:41	4 ok
5/29/03	704	6 1/2 14	9:45	10:00	10:00	9:15:42	12 ok
5/29/03	706	5 13	10:28	10:31	10:31	10:35	4 ok

REMARKS _____
 TYPE OF SOIL _____
 TESTED BY _____ ALSO PRESENT _____
 TRENCH DESIGN DATA: AVERAGE PERCOLATION TIME _____ TRENCH WIDTH _____
 INLET DEPTH _____ MAXIMUM BOTTOM DEPTH _____ SQ. FT./BEDROOM _____

709
heavy brown SIL
3' orange brown SIL
6 1/2' yellow brown fine micaceous SL
13'

704
Brown gravelly SIL
1' orange brown gravelly SIL
3 1/2' orange brown heavy micaceous L
7 1/2' fine brown micaceous SL
13'

