

# APPLICATION

## FOR PERCOLATION TESTING AND SITE EVALUATION

P 524196 3/7/06  
AIP 524157

TEST DATE(S) \_\_\_\_\_ TEST TIME \_\_\_\_\_

AGENCY REVIEW: \_\_\_\_\_

DATE 3/2/06

DO NOT WRITE ABOVE THIS LINE

I HEREBY APPLY FOR THE NECESSARY TESTING/EVALUATION PRIOR TO ISSUANCE OF SEWAGE DISPOSAL SYSTEM PERMIT(S) TO:

CHECK AS NEEDED:

- CONSTRUCT NEW SEPTIC SYSTEM(S)
- REPAIR/ADD TO AN EXISTING SEPTIC SYSTEM
- REPLACE AN EXISTING SEPTIC SYSTEM

CHECK AS NEEDED:

- NEW STRUCTURE(S)
- ADDITION TO AN EXISTING STRUCTURE
- REPLACE AN EXISTING STRUCTURE

CHECK ONE:

- CREATE NEW LOT(S)
- BUILD ON AN EXISTING LOT IN A SUBDIVISION
- BUILD ON AN EXISTING PARCEL OF RECORD

IS THE PROPERTY WITHIN 2500' OF ANY RESERVOIR?

- YES
- NO

THE TYPE OF STRUCTURE IS:

- RESIDENTIAL WITH \_\_\_\_\_ PROPOSED BEDROOMS IN THE COMPLETED STRUCTURE (NOTE **UNKNOWN** IF APPROPRIATE)
- COMMERCIAL (PROVIDE DETAIL OF NUMBERS AND TYPES OF EMPLOYEES/ CUSTOMERS ON ACCOMPANYING PLAN)
- INSTITUTIONAL/GOVERNMENT (PROVIDE DETAIL OF NUMBERS AND TYPES OF EMPLOYEES/USERS ON ACCOMPANYING PLAN)

PROPERTY OWNER(S) \_\_\_\_\_

DAYTIME PHONE \_\_\_\_\_ CELL \_\_\_\_\_ FAX \_\_\_\_\_

MAILING ADDRESS \_\_\_\_\_  
STREET CITY/TOWN STATE ZIP

APPLICANT \_\_\_\_\_

DAYTIME PHONE \_\_\_\_\_ CELL \_\_\_\_\_ FAX \_\_\_\_\_

MAILING ADDRESS \_\_\_\_\_  
STREET CITY/TOWN STATE ZIP

APPLICANT'S ROLE: DEVELOPER BUILDER BUYER RELATIVE/FRIEND REALTOR CONSULTANT

PROPERTY LOCATION  
SUBDIVISION/PROPERTY NAME 3549 Lakeway Drive LOT NO. \_\_\_\_\_

PROPERTY ADDRESS \_\_\_\_\_  
STREET TOWN/POST OFFICE

TAX MAP PAGE(S) \_\_\_\_\_ GRID \_\_\_\_\_ PARCEL(S) \_\_\_\_\_ PROPOSED LOT SIZE \_\_\_\_\_

AS APPLICANT, I UNDERSTAND THE FOLLOWING: THE SYSTEM INSTALLED SUBSEQUENT TO THIS APPLICATION IS ACCEPTABLE ONLY UNTIL PUBLIC SEWERAGE IS AVAILABLE. THIS APPLICATION IS COMPLETE WHEN ALL APPLICABLE FEES AND A SUITABLE SITE PLAN HAVE BEEN RECEIVED. I ACCEPT THE RESPONSIBILITY FOR COMPLIANCE WITH ALL M.O.S.H.A. AND "MISS UTILITY" REQUIREMENTS. APPROVAL IS BASED UPON SATISFACTORY REVIEW OF A PERC CERTIFICATION PLAN.

TEST RESULTS WILL BE MAILED TO APPLICANT.

SIGNATURE OF APPLICANT \_\_\_\_\_

HOWARD COUNTY HEALTH DEPARTMENT, BUREAU OF ENVIRONMENTAL HEALTH, WELL AND SEPTIC PROGRAM  
3525-H ELLICOTT MILLS DRIVE, ELLICOTT CITY, MARYLAND 21043-4544 (410) 313-1771 FAX (410) 313-2648  
TDD (410) 313-2323 TOLL FREE 1-877-4MD-DHMH

27 09.32.17

A/P

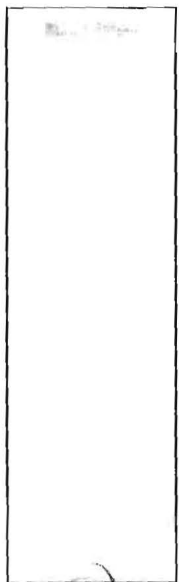
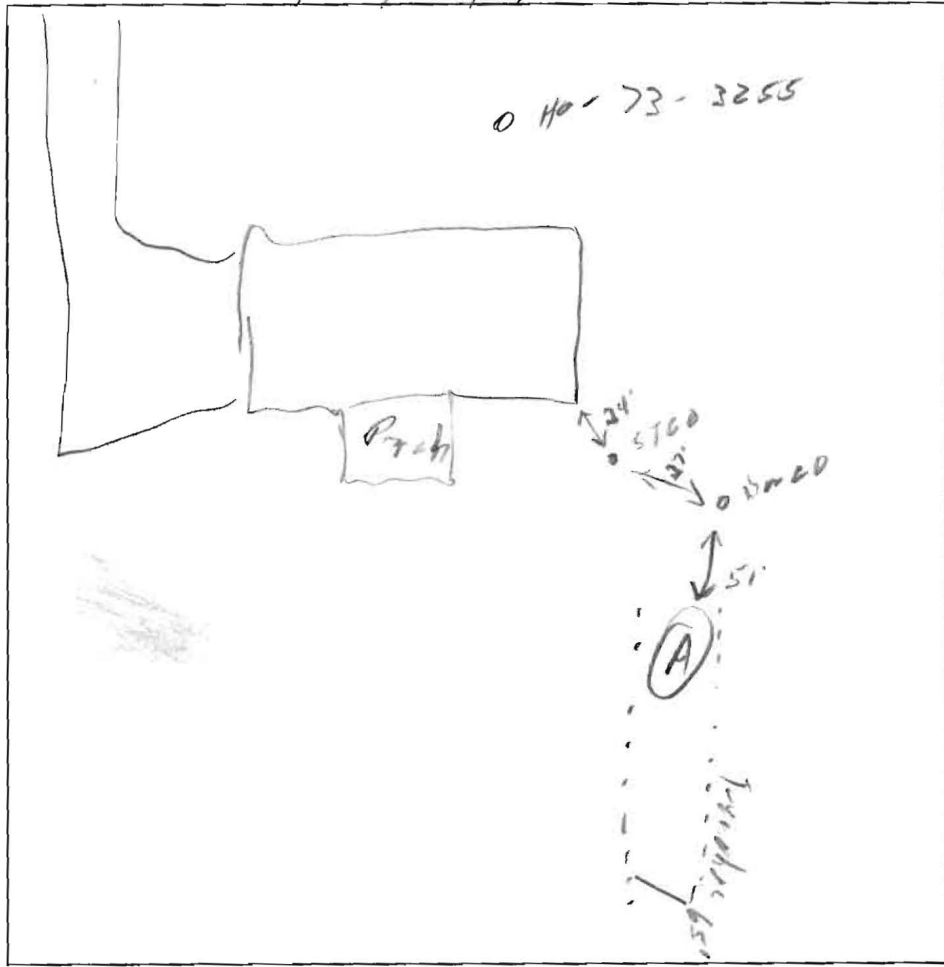

6"  
6"  
4"  
Loam-Tan  
10"  
Brown-Tan  
Loam  
14"

DATE	TEST #	DEPTH	START	BREAK 1" DROP	STOP 2" DROP	TIME OF 2nd INCH	P/F/H
3/7/26	(A)	5'	10:15	12:24	10:34	10	P

REMARKS \_\_\_\_\_  
 SANITARIAN SO BACKHOE Todd OTHERS Humana  
 TEST HOLES USED IN SDA \_\_\_\_\_ AVG. PERC TIME 10 SQ. FT/BR 210  
 TRENCH WIDTH 2 INLET DEPTH 5 MAX. BOT DEPTH 10 EFFECTIVE SW \_\_\_\_\_

130 vs 113 65 vs 57