

PUB. SEWER STATUS VERIFIED BY _____

Handwritten signature

ISSUE DATE: 3/2/06

P 524196

APPROVAL DATE: 3/20/06

A REPAIR (513618-FF)

PERMIT INDEXED

Tax ID # 03-286452

ON-SITE SEWAGE DISPOSAL SYSTEM HOWARD COUNTY HEALTH DEPARTMENT BUREAU OF ENVIRONMENTAL HEALTH

Hatfields Equipment IS PERMITTED TO INSTALL ALTER

ADDRESS: 8159 Brock Bridge Road, Annapolis Junction PHONE NUMBER: 301-854-6172

SUBDIVISION: Benson LOT NUMBER: 13-A

ADDRESS: 3549 Lakeway Drive PROPERTY OWNER: Daniel Elswick

SEPTIC TANK CAPACITY (GALLONS): Ex 1500

PUMP CHAMBER CAPACITY (GALLONS): N/A

NUMBER OF BEDROOMS: 4

SQUARE FEET PER BEDROOM: 210

LINEAR FEET OF TRENCH REQUIRED: 130

TRENCHES:	Trench to be <u>2</u> feet wide. Inlet <u>5</u> feet below original grade. Bottom maximum depth <u>10</u> feet below original grade. Effective area begins at <u>4</u> feet below original grade. <u>5</u> feet of stone below distribution pipe.
LOCATION:	<u>Pump, collapse & fill in P.W.</u> <u>Install (2) 65' trenches on contour</u>
PURPOSE:	Existing septic system has failed. Call for inspection when ground is opened so sanitarian can recommend repair.

PLANS APPROVED: *John B...* DATE: 3/7/06

- NOTE: PERMIT VOID AFTER 2 YEARS
- NOTE: CONTRACTOR RESPONSIBLE FOR SCHEDULING A PRE-CONSTRUCTION INSPECTION FOR ALL INSTALLATIONS
- NOTE: WATERTIGHT SEPTIC TANKS REQUIRED
- NOTE: ALL PARTS OF SEPTIC SYSTEM SHALL BE 100 FEET FROM ANY WATER WELL
- NOTE: MANHOLE RISERS REQUIRED ON ALL SEPTIC TANKS AND PUMP CHAMBERS

NEITHER THE HOWARD COUNTY COUNCIL OR THE HEALTH DEPARTMENT IS RESPONSIBLE FOR THE SUCCESSFUL OPERATION OF ANY SYSTEM PERMITTEE RESPONSIBLE FOR OBTAINING FINAL APPROVAL ON THIS PERMIT CALL 410-313-2640 FOR INSPECTION OF SEPTIC SYSTEM

P524196

NOT TO SCALE

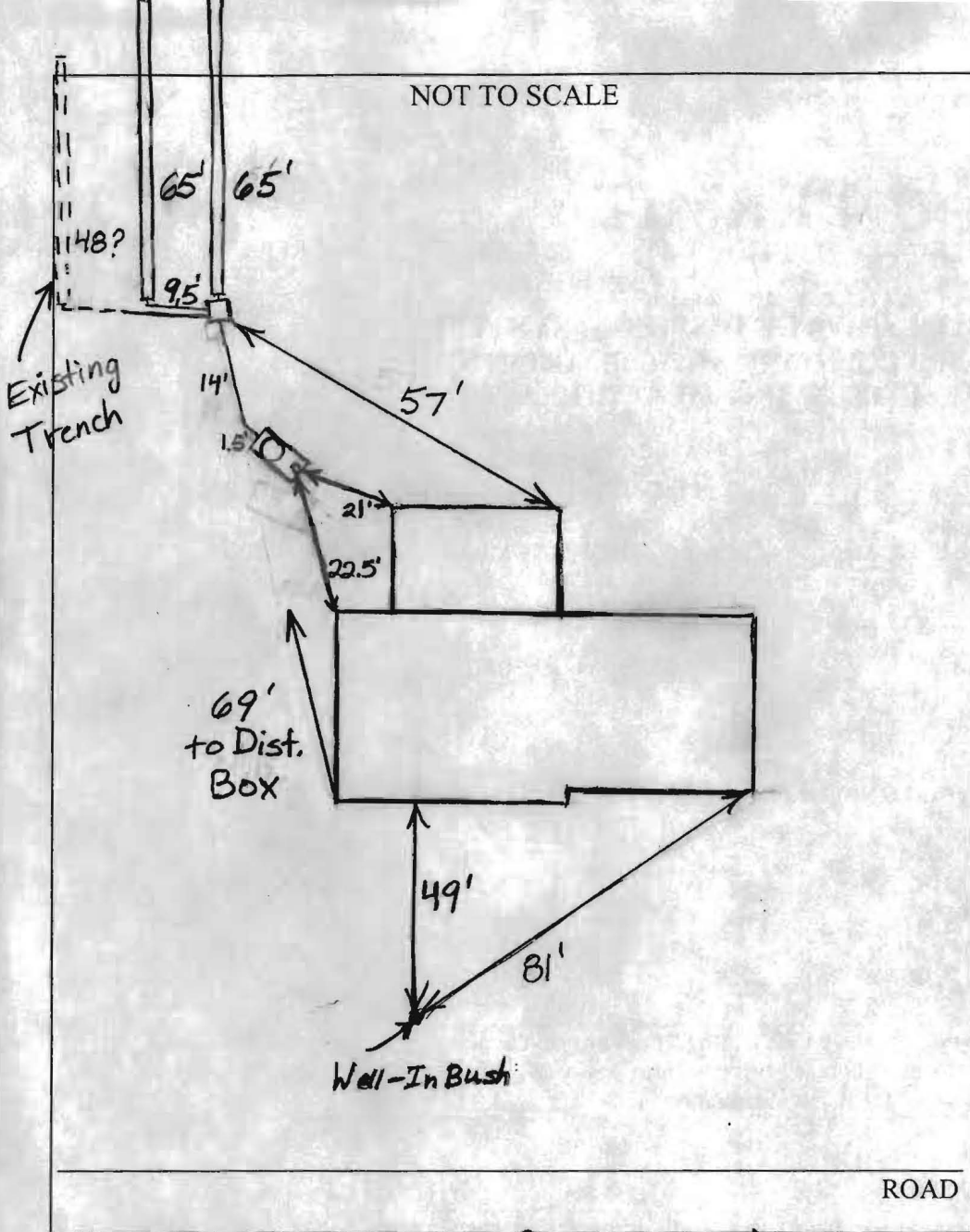

TRENCH/DRAINFIELD DATA		
WIDTH	INLET	BOTTOM
2'	5'	10'
NUMBER OF TRENCHES <u>2</u>		
TOTAL LENGTH <u>130+</u>		
ABSORPTION AREA <u>650+</u>		
DISTRIBUTION BOX LEVEL <u>Ladders</u>		
DISTRIBUTION BOX BAFFLE <u>Yes</u>		
DISTRIBUTION BOX PORT <u>No</u>		

SEPTIC TANK DATA	
SEPTIC TANK 1 LEVEL	<u>Yes</u>
CAPACITY	<u>Existing</u> GAL
SEAM LOC	<u>Midseam</u>
TANK LID DEPTH	<u>3/4-1'</u>
BAFFLES	<u>Rear</u>
BAFFLE FILTER	<u>No</u>
MANHOLE LOC	<u>Rear</u>
6" PORT LOC	<u>Front</u>
WATERTIGHT TEST	<u>No</u>
SEPTIC TANK 2 LEVEL	<u>N/A</u>
CAPACITY	_____ GAL
SEAM LOC	_____
TANK LID DEPTH	_____
BAFFLES	_____
BAFFLE FILTER	_____
MANHOLE LOC	_____
6" PORT LOC	_____
WATERTIGHT TEST	_____

PRE-CONSTRUCTION 3/20/06 System installed, O.K. to backfill (PB)

INSTALLATION _____

FINAL INSPECTOR B. Baker

DATE OF APPROVAL 3/20/06