

6/13/73 - 9:30 - *Trisch*  
*Final OK w/22*  
*imp. first*

# PERMIT

SEWAGE DISPOSAL SYSTEM

MARYLAND STATE DEPARTMENT OF HEALTH  
HOWARD COUNTY

## INDEXED

P 18578

A 09881

ELLICOTT CITY  
DISTRICT 3rd

DATE 6/11/73

Jack Fyock IS PERMITTED TO INSTALL  ALTER

ADDRESS Ten Oaks Road, Glenelg, Maryland PHONE 286-2939

A SEWAGE DISPOSAL SYSTEM LOCATED AT

SUBDIVISION Fox Den Farms ROAD <sup>3906</sup> Jumper Hill Road LOT 7, Blk. A

PROPERTY OWNER Mr. & Mrs. James V. Piersall

ADDRESS ?

SPECIFICATIONS 4 bedrooms

DRAIN FIELD \_\_\_\_\_ DEPTH \_\_\_\_\_ FEET, BOTTOM AREA \_\_\_\_\_ SQ. FT.

SEEPAGE PITS \_\_\_\_\_ ABSORBENT SIDE-WALL AREA \_\_\_\_\_ SQ. FT.

SEPTIC TANK CAPACITY 1250 GALLONS

FOR GARBAGE GRINDER, INCREASE DISPOSAL AREA 22% & TANK CAPACITY 50%.

OTHER DRY WELL - 400 sq. ft. absorbent sidewall area to begin below the first 3/4 ft. of non-absorbent ground. Maximum depth permitted for dry well is 12 ft. Place dry well 25 ft. from the front property line and 10 ft. off the right side property line as seen when facing the lot from Jumper Hill Road.

NOTE: ALL PIPE FROM HOUSE TO DRY WELL MUST BE CAST IRON.

PERMIT VOID AFTER THREE YEARS.

NOTE: INSTALL STAND PIPE ON SEPTIC TANK AND DRY WELL.

PLANS APPROVED BY J. Hennigan & Charles B. Streaker DATE 12/16/65 and 4/5/73

FILL SEPTIC TANK AND DISTRIBUTION BOX WITH WATER BEFORE CALLING FOR AN INSPECTION. COVER NO WORK UNTIL INSPECTED AND APPROVED.

NEITHER THE HOWARD COUNTY COMMISSIONERS NOR THE HEALTH DEPARTMENT IS RESPONSIBLE FOR THE SUCCESSFUL OPERATION OF ANY SYSTEM.

COPIES PERMIT SIGNED AND RETURNED 2/2/84  
Serial # 52472  
Addition - pool, master bed.

A 09881

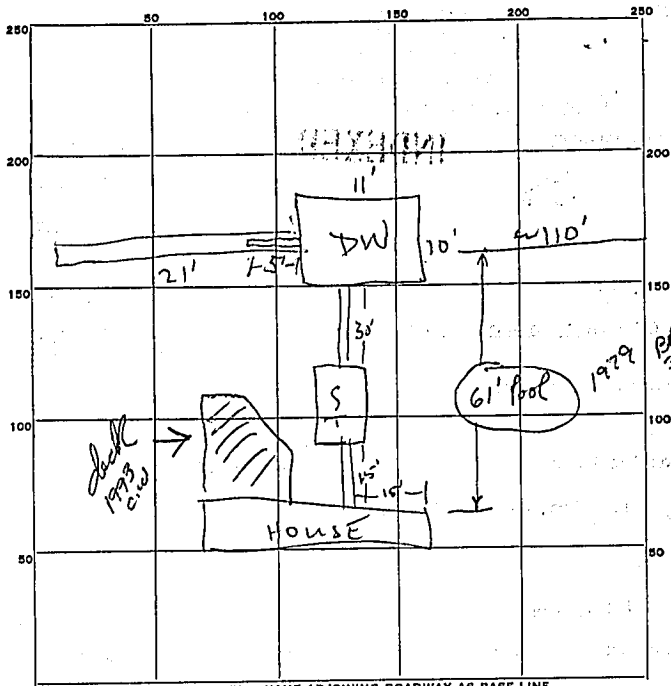

INDICATE NORTH. - NAME ADJOINING ROADWAY AS BASE LINE.

PERMIT CARD

SEPTIC TANK, LEVEL  1250 CLEANOUTS

DISTRIBUTION BOX, LEVEL \_\_\_\_\_

TILE FIELD, DEPTH \_\_\_\_\_ FT. TRENCH WIDTH \_\_\_\_\_ FT.

GRAVEL DEPTH \_\_\_\_\_ IN. TOTAL LENGTH \_\_\_\_\_ FT.

NUMBER OF TRENCHES 1 TOTAL BOTTOM AREA \_\_\_\_\_

SEEPAPE PITS, INSIDE DIAMETER 10 x 11 FT. DEPTH BELOW INLET 7' FT.

ABSORBENT AREA 420 SQ. FT.

REMARKS System moved closer to house' higher ground, sandy mica soil ok  
295 sq ft for DW, 10' x 11'  
1 Trench, effective depth starts @ 5'; trench 11' deep  
~ 126 sq ft.  
Total Eff abso. DW area = 426 sq ft. OK,

DATE SYSTEM APPROVED 6/13/73 INSPECTOR WW Zapp

PP 39522  
 1979  
 190  
 21  
 43  
 294  
 1.26  
 420