

LAYOUT _____

INSP 1 _____ INSP 3 _____

INSP 2 _____ INSP 5 _____

ISSUE DATE: _____

APPROVAL
DATE:

3-26-08

PERMIT

MULTI-USE SEPTIC SYSTEM

P 528468 -13

A

515326

HOUSE SEWER LINE CONNECTION

HOWARD COUNTY HEALTH DEPARTMENT BUREAU OF ENVIRONMENTAL HEALTH

NVR _____ IS PERMITTED TO INSTALL ALTER

ADDRESS: 11700 Plaza America Drive, Reston VA PHONE NUMBER: 410-796-0980

SUBDIVISION Homeland (Ellicott Meadows) LOT NUMBER: 13

ADDRESS: 3020 John Bernard Drive PROPERTY OWNER: NVR, Inc.

NUMBER OF BEDROOMS: 2

HOUSE SERVED BY PUBLIC WATER? **Yes**

LOCATION:	Install 4" house sewer line connection per the approved site plan.
NOTES:	This permit is limited to the installation of the individual house sewer line connection and installation of the grinder pump, if applicable. The Howard County Bureau of Utilities must be contacted for scheduling of inspection of these items, as well at 410-313-4900.

PLANS APPROVED: Gabriel Creighton DATE: 1/30/08

PERMIT VOID AFTER 2 YEARS

1. CONTRACTOR IS RESPONSIBLE FOR SCHEDULING A PRE-CONSTRUCTION INSPECTION FOR ALL INSTALLATIONS.
2. ALL PARTS OF SEPTIC SYSTEM SHALL BE 100 FEET FROM ANY WATER WELL UNLESS SPECIFICALLY AUTHORIZED.
3. MANHOLE RISERS REQUIRED ON ALL SEPTIC TANKS AND PUMP CHAMBERS UNLESS SPECIFICALLY AUTHORIZED.
4. CONTRACTOR RESPONSIBLE FOR COMPLIANCE WITH APPLICABLE REGULATIONS, GUIDELINES AND THE TERMS OF THIS PERMIT.
5. NEITHER THE HOWARD COUNTY COUNCIL OR THE HEALTH DEPARTMENT IS RESPONSIBLE FOR THE SUCCESSFUL OPERATION OF ANY SYSTEM.
6. PERMITTEE RESPONSIBLE FOR OBTAINING FINAL APPROVAL ON THIS PERMIT.

CALL 410-313-1771 FOR INSPECTION OF HOUSE CONNECTION

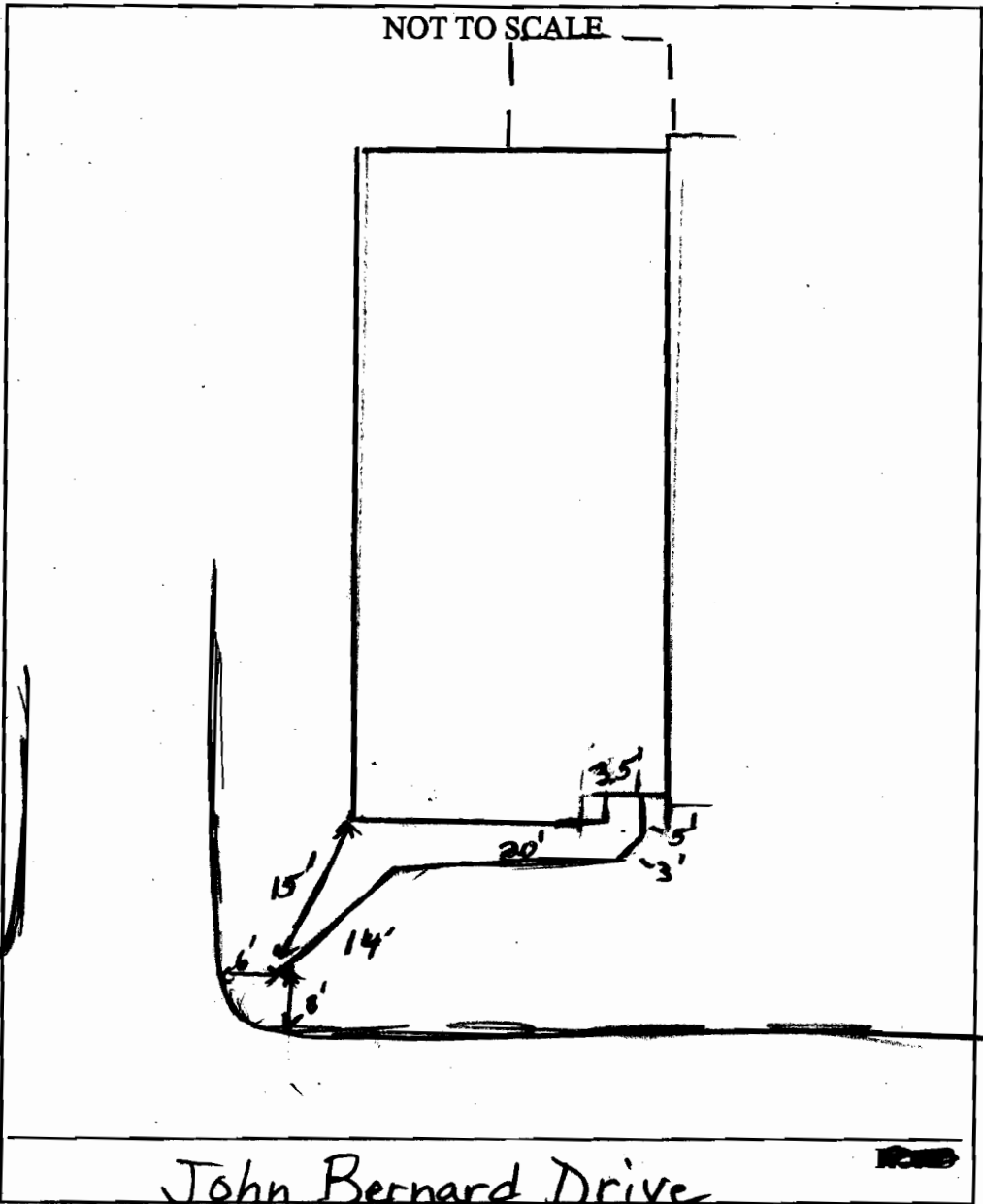

TRENCH/DRAINFIELD DATA		
WIDTH	INLET	BOTTOM
_____	_____	_____
NUMBER OF TRENCHES _____		
TOTAL LENGTH _____		
ABSORPTION AREA _____		
DISTRIBUTION BOX LEVEL _____		
DISTRIBUTION BOX BAFFLE _____		
DISTRIBUTION BOX PORT _____		

SEPTIC TANK DATA	
SEPTIC TANK 1 LEVEL _____	
CAPACITY _____	GAL
SEAM LOC _____	
TANK LID DEPTH _____	
BAFFLES _____	
BAFFLE FILTER _____	
MANHOLE LOC _____	
6" PORT LOC _____	
WATERTIGHT TEST _____	
SEPTIC TANK 2 LEVEL _____	
CAPACITY _____	GAL
SEAM LOC _____	
TANK LID DEPTH _____	
BAFFLES _____	
BAFFLE FILTER _____	
MANHOLE LOC _____	
6" PORT LOC _____	
WATERTIGHT TEST _____	

PRE-CONSTRUCTION _____

INSTALLATION OK to back fill

FINAL INSPECTOR R. Wall DATE OF APPROVAL 3-26-08



MCE.=434.52

G.=443.51
F.F.=443.84
B.=435.09
MCE.=433.59

PHASE 2
8
G.=442.84
F.F.=443.17
B.=434.42
MCE.=434.18

PHASE 1
9
G.=442.69
F.F.=443.07
B.=434.27
MCE.=434.11

PHASE 1
10
G.=443.56
F.F.=443.89
B.=435.14
MCE.=433.69

16
G.=450.45
F.F.=450.78
B.=442.03
MCE.=435.91

17
G.=450.12
F.F.=451.45
B.=442.70
MCE.=436.35

15
G.=445.52
F.F.=446.85
B.=437.10
MCE.=435.25

14
G.=443.38
F.F.=443.71
B.=434.96
MCE.=433.99

13
G.=443.71
F.F.=444.04
B.=435.29
MCE.=433.73

18
G.=451.87
F.F.=452.2
B.=443.45
MCE.=441.76

19
G.=452.54
F.F.=452.87
B.=444.12
MCE.=441.89

20
G.=453.21
F.F.=453.54
B.=444.79
MCE.=442.17

G.=44
F.F.=4
B.=43
MCE.=

15' DWELLING UNIT
SETBACK
445

25' WETLAND
BUFFER

PUBLIC 20'
WATER AND
UTILITY EASEMENT

PROP. LIGHT
NO CURB

WHEEL
STOP
(TYP.)

300' SW BUNKER

MODIFIED C&G
H.C.STD.
(TYP.)
3.01

PUBLIC 20'
WATER AND
UTILITY EASEMENT

PROP. LIGHT
NO CURB

WHEEL
STOP
(TYP.)

G.=44
F.F.=4
B.=43
MCE.=

15' DWELLING UNIT
SETBACK
445

25' WETLAND
BUFFER

PUBLIC 20'
WATER AND
UTILITY EASEMENT

PROP. LIGHT
NO CURB

WHEEL
STOP
(TYP.)

300' SW BUNKER

MODIFIED C&G
H.C.STD.
(TYP.)
3.01

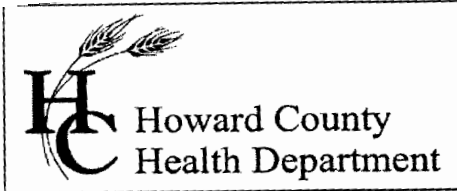

Bureau of Environmental Health
7178 Gateway Drive Columbia, MD 21046
(410) 313-2640 Fax (410) 313-2648
TDD (410) 313-2323 Toll Free 1-866-313-6300
website: www.hchealth.org

Peter L. Beilenson, M.D., M.P.H., Health Officer

June 6, 2008

NVR, Inc./Ryan Homes
6085 Marshalee Road
Elkridge, MD 21075

RE: Ellicott Meadows, Lot 13
3020 John Bernard Drive
Ellicott City, MD 21043
BP# B07003050
PUBLIC WATER

Dear Sir/Madam:

This is to advise you that the septic system for the above referenced property has been installed and inspected. **Final approval of the septic system was granted on 03/26/2008.**

The property is served by public water and is therefore exempt from the Health Department water sampling requirements.

By issuance of this letter, this office recommends release of the Use and Occupancy permit for the referenced property.

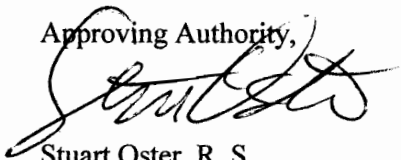
Approving Authority,

Stuart Oster, R. S.
Well & Septic Program

mlb
cc: Building Inspector's Office
File

Lot 15(130)
Block

Community GH

BEDROOM RESTRICTION ACKNOWLEDGMENT
Hearthstone at Ellicott Meadows

The undersigned Purchaser has entered into a Purchase Agreement for the Property known as GH15 and located in the Hearthstone at Ellicott Meadows Community (the "Property").

By signing below, Purchaser acknowledges they have been informed of and understand the following information relating to the Property:

The Hearthstone at Ellicott Meadows is served by a community private sewage disposal system which can only accommodate a maximum of two bedrooms per Unit. The Declaration of Covenants, Conditions and Restrictions recorded against the Units at Hearthstone at Ellicott Meadows, as amended, states that "...no Condominium Unit shall be constructed or modified to contain more than two (2) bedrooms." The Condominium Association is the entity which enforces the terms of the Declaration.

ACKNOWLEDGED BY PURCHASER:

Purchaser: *[Signature]*

Purchaser: *Hang J. Ward*

Date: *23 Jul 07*