

10/5/99
10:30 AM

04-315650

PERMIT

SEWAGE DISPOSAL SYSTEM

DEPARTMENT OF HEALTH AND MENTAL HYGIENE

04-315650

P 512752

A REPAIR

DISTRICT _____

DATE 10/4/99

FILE CLOSED

DATE SYSTEM APPROVED 7/04

INSPECTOR _____

HOWARD COUNTY HEALTH DEPARTMENT
BUREAU OF ENVIRONMENTAL HEALTH
~~XXXXXX~~ 410-313-2640

INDEXED

Fogle's Septic Clean, Inc. IS PERMITTED TO INSTALL _____ ALTER

ADDRESS 580 Obrecht Road, Sykesville, Maryland 21784 PHONE 410-795-5670

SUBDIVISION _____ LOT _____ ROAD 3366 Jennings Chapel Road

PROPERTY OWNER Wade Gallagher 3366 Jennings Chapel Road (prev. Nicodemus)

ADDRESS Woodbine, Maryland 21797 301-854-6278 Warfield

SEPTIC TANK CAPACITY EX GALLONS Wilderness Farm

NUMBER OF BEDROOMS 7

125 SQUARE FEET PER BEDROOM

LINEAR FEET OF TRENCH REQUIRED 110

REPAIR - PURPOSE - EXISTING SEPTIC SYSTEM IS FAILING.
Call for inspection when ground is opened so sanitarian can recommend repair. 9/29/1999

INV 3 1/2 - 4 BOT 11 1/2 - 12 8" STONE

PLANS APPROVED BY _____ DATE _____

COVER NO WORK UNTIL INSPECTED AND APPROVED

NEITHER THE HOWARD COUNTY COUNCIL NOR THE HEALTH DEPARTMENT IS RESPONSIBLE FOR THE SUCCESSFUL OPERATION OF ANY SYSTEM

NOTE: CLEANOUT REQUIRED EVERY 70 FEET OF SEWER LINE AND/OR AT 90° SWEEPS IN LINES FROM HOUSE TO DRAIN FIELDS. 90° ELBOWS NOT ACCEPTABLE.

NOTE: ALL PARTS OF SEPTIC SYSTEMS (I.E. TANK, DISTRIBUTION BOX TRENCHES) TO BE 100 FEET FROM WELL (UNLESS OTHERWISE SPECIFICALLY AUTHORIZED)

NOTE: IF DEEP TRENCH(ES) ARE USED CALL FOR INSPECTION BEFORE AND AFTER PLACING GRAVEL IN TRENCH(ES)

NOTE: NO DRY WELL SHALL EXCEED 15 FOOT IN DIAMETER NO ABSORPTION TRENCH TO EXCEED 100 FEET IN LENGTH

NOTE: ALL PIPE FROM HOUSE TO SEPTIC TANK MUST BE CAST IRON OR SCHEDULE 25/40 PVC OR ABS

PERMIT VOID AFTER TWO YEARS

NOTE: INSTALL STAND PIPE ON SEPTIC TANK AND DRY WELL STAND PIPES MUST BE 6 INCHES IN DIAMETER CAST IRON, CONCRETE OR TERRA COTTA OR PVA OR ABS ACCEPTED. IF TOP OF SEPTIC TANK IS DEEPER THAN 3 FEET, MANHOLE TO GRADE REQUIRED.

NOTE: DISTRIBUTION BOXES MUST HAVE BAFFLES

*INSTALLER IS RESPONSIBLE FOR OBTAINING FINAL APPROVAL ON THIS PERMIT

*CALL 461-9933 FOR INSPECTION OF SEPTIC SYSTEM.

P 512752

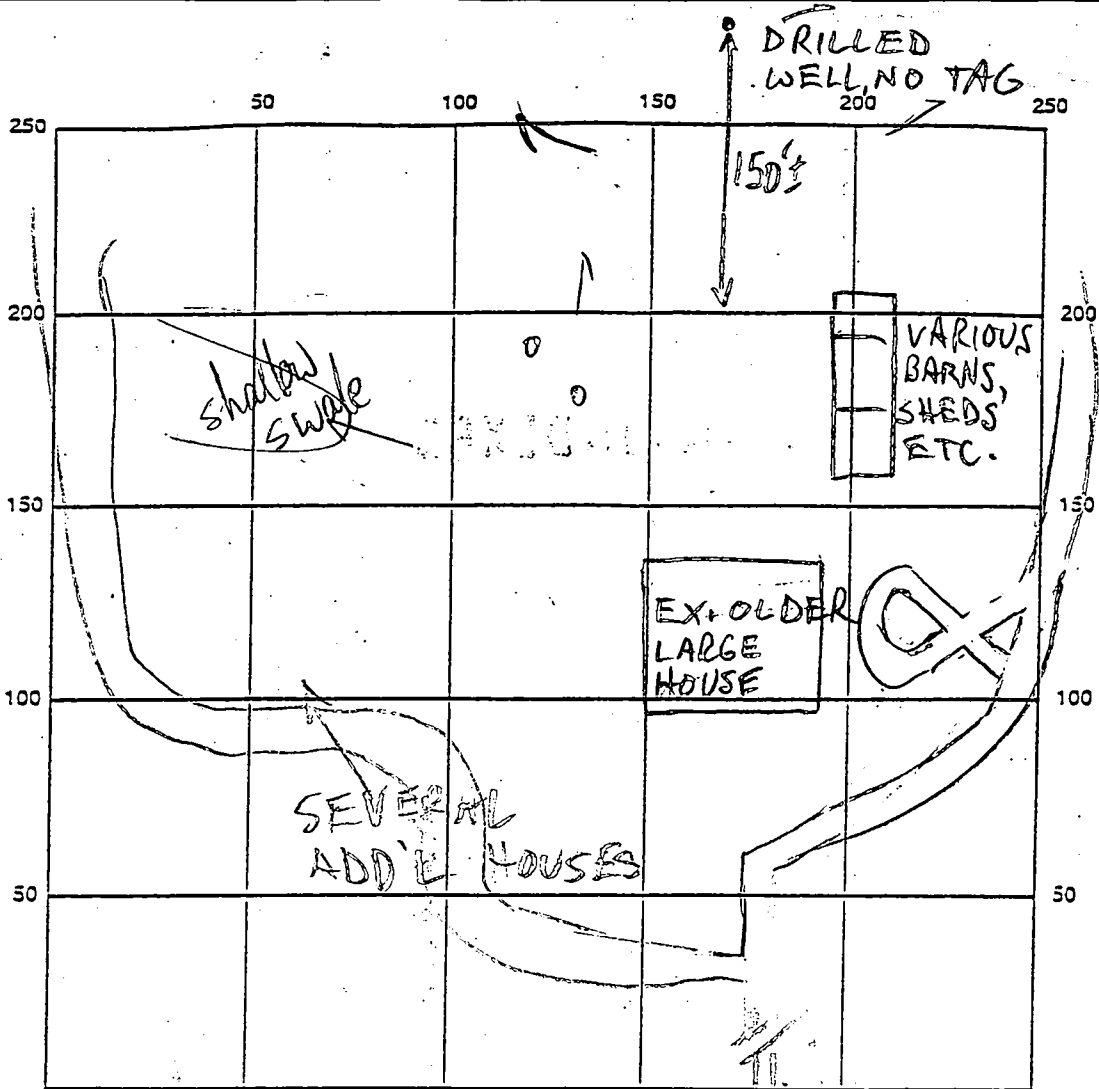

INDICATE NORTH - NAME ADJOINING ROADWAY AS BASE LINE

SEPTIC TANK LEVEL _____ CLEANOUTS _____

DISTRIBUTION BOX LEVEL _____

DRAIN FIELD/TITLE DEPTH _____ FT. TRENCH WIDTH _____ FT. INLET DEPTH _____ FT.

EFFECTIVE GRAVEL DEPTH _____ FT. TOTAL LENGTH _____ FT.

NUMBER OF TRENCHES _____ ONE SIDEWALL/SOTTOM AREA _____ SQ. FT.

DRYWALL INSIDE DIAMETER _____ FT. EFFECTIVE DEPTH BELOW INLET _____ FT.

ABSORBENT AREA _____ SQ. FT.

REMARKS: 10/5/99 OK TO START (MR)

3/2/04 PER FOGLE'S REPAIR NOT INSTALLED

T/C TO OWNER UNRETURNED

DATE SYSTEM APPROVED _____ INSPECTOR _____

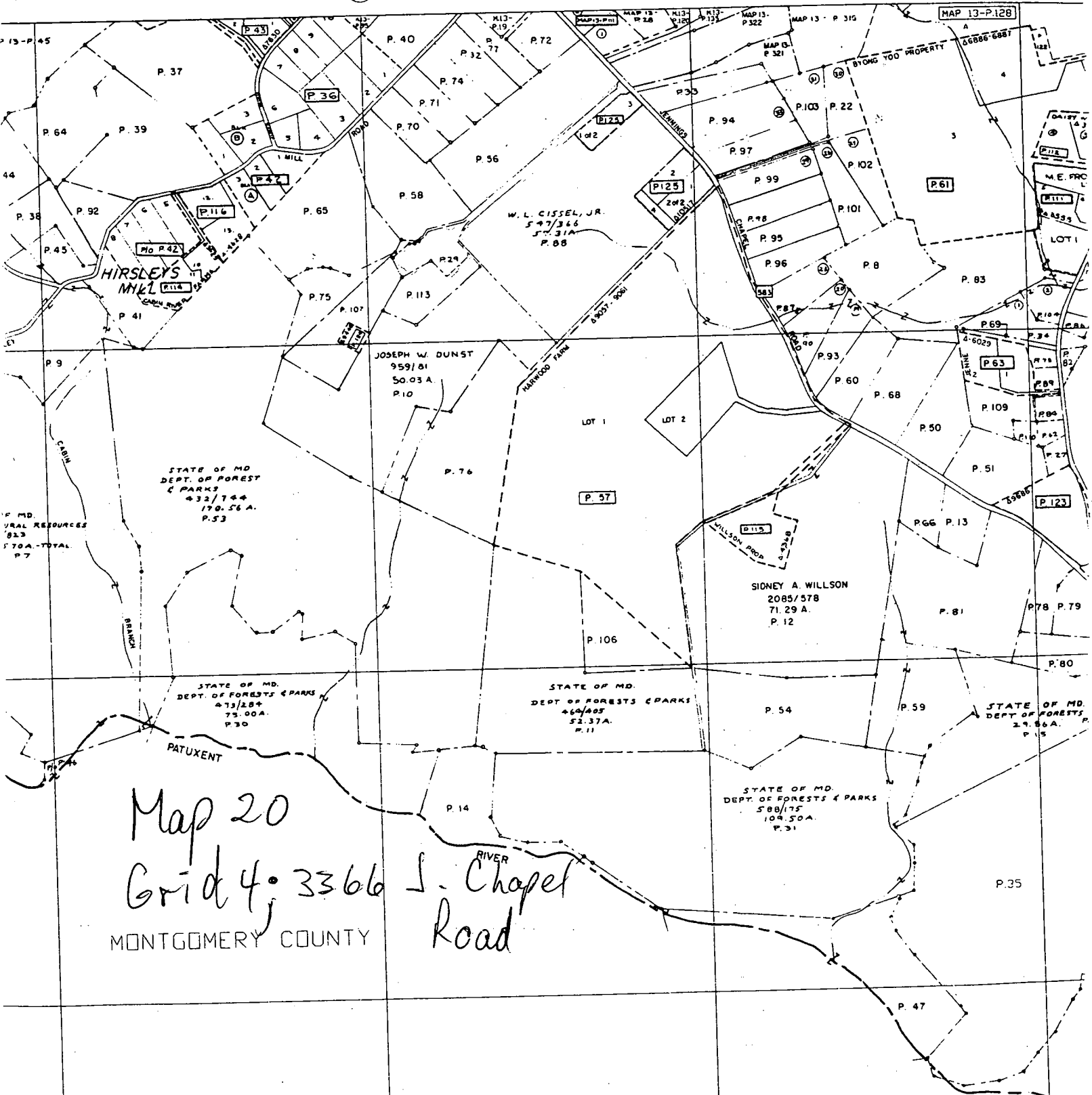

Map 20
 Grid 4: 3366 S. Chapel Road
 MONTGOMERY COUNTY