

C 1 **8327** SEQUENCE NO. (WRA USE ONLY)
 1 2 3 (SEQ. NO.) 6
 (THIS NUMBER IS TO BE PUNCHED IN COLS. 3-6 ON ALL CARDS)

STATE OF MARYLAND
WATER RESOURCES ADMINISTRATION
 TAWES STATE OFFICE BLDG., ANNAPOLIS, MD. 21401
WELL COMPLETION REPORT

THIS REPORT MUST BE SUBMITTED IN 30 DAYS AFTER WELL COMPLETE
 FILL IN THIS FORM COMPLETELY
 COUNTY NUMBER

DATE RECEIVED (WRA USE ONLY) 11/29/77 DEPTH OF WELL 150 PERMIT NO. FROM "PERMIT TO DRILL WELL"
 DATE WELL COMPLETED 11 29 77 22 (TO NEAREST FOOT) 26 28 29 30 31 32 33 34 35 36 37
 8-13 15 20 DRILLERS IDENTIFICATION NO. 217

OWNER Kraussberg LAST NAME Barry FIRST NAME
 STREET OR RFD 4639 H. W. W. Road POST OFFICE Pikesville, Md. 21208

WELL LOG
 STATE THE KIND OF FORMATIONS PENETRATED, THEIR COLOR, DEPTH, THICKNESS AND IF WATER BEARING
 DESCRIPTION (USE ADDITIONAL SHEETS IF NECESSARY)

| DESCRIPTION (USE ADDITIONAL SHEETS IF NECESSARY) | FEET | | CHECK IF WATER BEARING |
|--|-----------|------------|------------------------|
| | FROM | TO | |
| <u>BROWN SAND</u> | <u>0</u> | <u>30</u> | |
| <u>GREEN ROCK</u> | <u>30</u> | <u>150</u> | |

GROUTING RECORD
 WELL HAS BEEN GROUTED (CIRCLE APPROPRIATE BOX) Y N
 TYPE OF GROUTING MATERIAL (CIRCLE BOX):
 CEMENT C M BENTONITE CLAY B C
 NO. OF BAGS 9 NO. OF POUNDS 752
 GALLONS OF WATER 50
 DEPTH OF GROUT SEAL (TO NEAREST FOOT)
 FROM 0 FT. TO 44 FT.
 (ENTER 0 IF FROM SURFACE)

CASING RECORD
 INSERT APPROPRIATE CODE BELOW
 STEEL S T CONCRETE C O
 PLASTIC P L OTHER O T
 MAIN CASING TYPE S T
 NOMINAL DIAMETER TOP (MAIN) CASING (NEAREST INCH) 6
 TOTAL DEPTH OF MAIN CASING (NEAREST FOOT) 45

OTHER CASING (IF USED)
 DIAMETER (INCH) DEPTH (FEET) FROM TO
 [] [] [] []
 [] [] [] []

SCREEN RECORD
 INSERT APPROPRIATE CODE BELOW
 STEEL S T BRASS OR BRONZE B R OPEN HOLE H O
 PLASTIC P L OTHER O T

DEPTH (NEAREST WHOLE FOOT)
 FROM TO
 1 40 8 9 11 44 15 17 150 21
 2 [] [] [] [] [] [] [] []
 3 [] [] [] [] [] [] [] []
 SLOT SIZE 1, 2, 3.

DIAMETER OF SCREEN 56 (NEAREST INCH) FROM 60 TO
 GRAVEL PACK [] [] [] []
 IF WELL DRILLED WAS A FLOWING WELL CIRCLE BOX F

WRA USE ONLY (NOT TO BE FILLED IN BY DRILLER) (E.R.O.S.)
 T 70 72 74 75 76
 TELESCOPE CASING LOG INDICATOR OTHER DATA AVAILABLE

PUMPING TEST
 HOURS PUMPED (TO NEAREST HOUR) 8
 PUMPING RATE (GALLONS PER MINUTE TO NEAREST GALLON) 8
 METHOD USED TO MEASURE PUMPING RATE Rotary
 WATER LEVEL: (DISTANCE FROM LAND SURFACE)
 BEFORE PUMPING 30 (NEAREST FOOT)
 WHEN PUMPING 145 (NEAREST FOOT)

TYPE OF PUMPED USED (CIRCLE APPROPRIATE BOX) (FOR PUMPING TEST)
 A AIR P PISTON T TURBINE
 C CENTRIFUGAL R ROTARY O OTHER (DESCRIBE BELOW)
 J JET S SUBMERSIBLE

PUMP INSTALLED
 TYPE OF PUMP (WRITE APPROPRIATE LETTER IN BOX - SEE ABOVE: A, C, J, P, R, S, T, O) 29
 DRILLER WILL INSTALL PUMP (CIRCLE APPROPRIATE BOX) Y N
 CAPACITY:
 GALLONS PER MINUTE (TO NEAREST GALLON) 31 35
 PUMP HORSE POWER 37 41
 PUMP COLUMN LENGTH (NEAREST FOOT) 43 47

CASING HEIGHT (CIRCLE APPROPRIATE BOX AND ENTER CASING HEIGHT)
 + ABOVE } LAND SURFACE (NEAREST FOOT)
 - BELOW } 1 (NEAREST FOOT)

LOCATION OF WELL ON LOT
 SHOW PERMANENT STRUCTURE SUCH AS BUILDINGS, SEPTIC TANKS, AND/OR OTHER LAND MARKS AND INDICATE NOT LESS THAN TWO DISTANCES (MEASUREMENTS TO WELL).
 [Handwritten notes and diagrams]

CIRCLE APPROPRIATE BOXES
 A A WELL WAS ABANDONED AND SEALED WHEN THIS WELL WAS COMPLETED
 E ELECTRIC LOG OBTAINED
 P TEST WELL CONVERTED TO PRODUCTION WELL

I HEREBY CERTIFY THAT I HAVE COMPLIED WITH ALL CONDITIONS STATED ON THE ABOVE-CAPTIONED "PERMIT TO DRILL WELL", AND THAT INFORMATION CONTAINED IN THIS REPORT IS TRUE, ACCURATE, AND COMPLETE TO THE BEST OF MY KNOWLEDGE, INFORMATION AND BELIEF.

DRILLERS NAME
 (PLEASE PRINT) C. A. Crumwell
 SIGNATURE C. A. Crumwell

Martin Smith
Enser
Stewart

833-1221

Virginia Enser 833-3600,
or
356-6233

9/14/76 paid extra H. Side check for pers.

RECEIVED
DEC 20 9 23 AM '77
HOWARD COUNTY
HEALTH DEPT.
ELLIOTT CITY, MD.

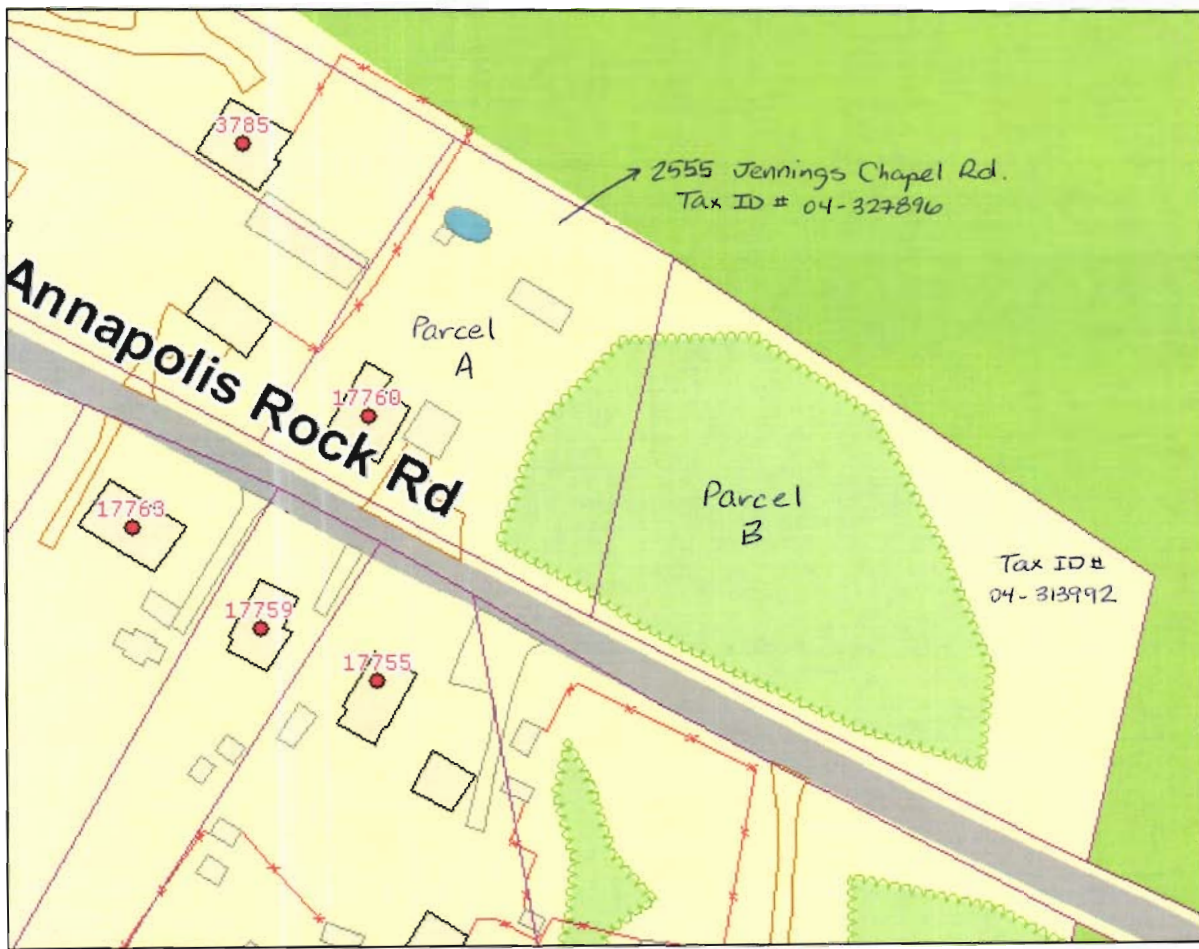

Note: Perc testing was done in 1976 for Parcel B. That paperwork is filed under "Annapolis Rock" & the Tax ID #.

A well was installed on Parcel A in 1977. That paperwork is filed under the Jennings Chapel Road address.

The "17760 Annapolis Rock Road" is only listed on the County's GIS system. Real Property search has the Jennings Chapel address.