

PERMIT

P 08715

A _____

SEWAGE DISPOSAL SYSTEM

MARYLAND STATE DEPARTMENT OF HEALTH

HOWARD COUNTY

ELLICOTT CITY

DISTRICT 6

DATE 7/7/64

Richard Lowe IS PERMITTED TO INSTALL _____ ALTER

ADDRESS Ellicott City, Maryland PHONE RI 7-7598

A SEWAGE DISPOSAL SYSTEM LOCATED AT _____

SUBDIVISION _____ ROAD _____ LOT _____

PROPERTY OWNER Maple Village Trailer Park - Wilson, Schoenbrodt & Spock

ADDRESS _____

SPECIFICATIONS

DRAIN FIELD _____ DEPTH _____ FEET, BOTTOM AREA _____ SQ. FT.

SEEPAGE PITS _____ ABSORBENT SIDE-WALL AREA _____ SQ. FT.

SEPTIC TANK CAPACITY _____ GALLONS

FOR GARBAGE GRINDER, INCREASE DISPOSAL AREA 22% & TANK CAPACITY 50%.

OTHER Sufficient number of dry wells to accommodate sewage effluent
from the Trailer Park. Dry wells to be located 10 ft. from the
property line. Existing system at lower end of park not to be
used.

PLANS APPROVED BY Palmer Wine DATE 7/7/64

FILL SEPTIC TANK AND DISTRIBUTION BOX WITH WATER BEFORE CALLING FOR AN INSPECTION. COVER NO WORK UNTIL INSPECTED AND APPROVED.

NEITHER THE HOWARD COUNTY COMMISSIONERS NOR THE HEALTH DEPARTMENT IS RESPONSIBLE FOR THE SUCCESSFUL OPERATION OF ANY SYSTEM.

A 708715

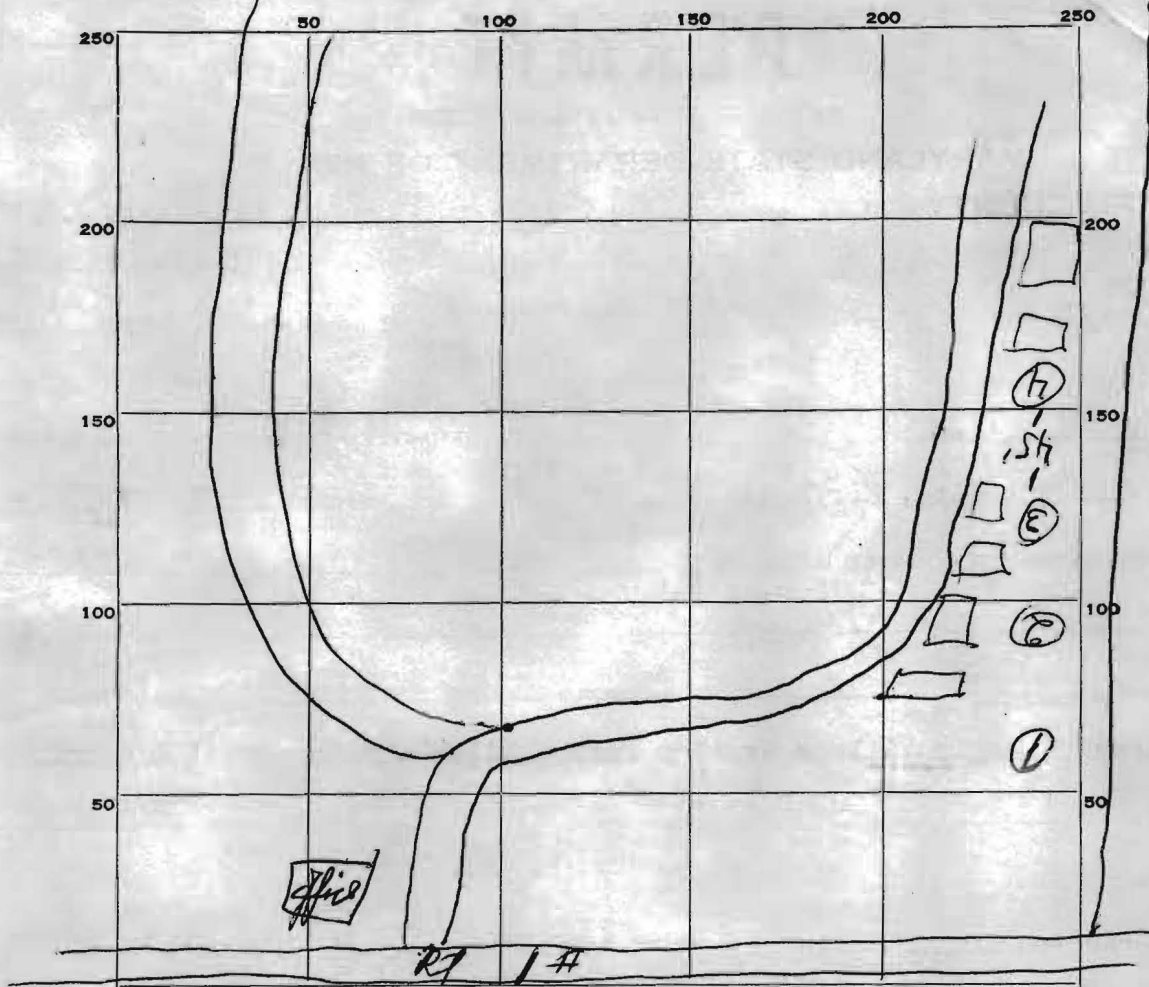

INDICATE NORTH. - NAME ADJOINING ROADWAY AS BASE LINE.

PERMIT CARD _____

SEPTIC TANK, LEVEL _____ CLEANOUTS _____

DISTRIBUTION BOX, LEVEL _____

TILE FIELD, DEPTH _____ FT. TRENCH WIDTH _____ FT.

GRAVEL DEPTH _____ IN. TOTAL LENGTH _____ FT.

NUMBER OF TRENCHES _____ TOTAL BOTTOM AREA _____

SEEPAGE PITS, INSIDE DIAMETER 12 FT. DEPTH BELOW INLET 13' FT.

ABSORBENT AREA _____ SQ. FT.

RECEIVED
 MAY 25 4 24 PM '66
 DIVISION OF ENVIRONMENTAL HEALTH

REMARKS _____

7/31/69 - 1# 12' x 13' - 45' from dog well No. 30

DATE SYSTEM APPROVED _____ INSPECTOR _____