

4/14/65

PERMIT

P 10008

SEWAGE DISPOSAL SYSTEM

A

MARYLAND STATE DEPARTMENT OF HEALTH

HOWARD COUNTY

INDEXED

ELLICOTT CITY

DISTRICT 6

DATE 4/13/65

Richard Lowe

IS PERMITTED TO INSTALL ALTER

ADDRESS Ellicott City, Md. PHONE RI 7-7598

A SEWAGE DISPOSAL-SYSTEM LOCATED AT

SUBDIVISION ROAD LOT

PROPERTY OWNER Maple Village Trailer Park

ADDRESS Jessup, Maryland

SPECIFICATIONS

DRAIN FIELD DEPTH FEET, BOTTOM AREA SQ. FT.

SEEPAGE PITS ABSORBENT SIDE-WALL AREA SQ. FT.

SEPTIC TANK CAPACITY GALLONS

FOR GARBAGE GRINDER, INCREASE DISPOSAL AREA 22% & TANK CAPACITY 50%.

OTHER REPAIR - one 12 x 12 or more

PLANS APPROVED BY DATE 4/13/65

FILL SEPTIC TANK AND DISTRIBUTION BOX WITH WATER BEFORE CALLING FOR AN INSPECTION. COVER NO WORK UNTIL INSPECTED AND APPROVED.

NEITHER THE HOWARD COUNTY COMMISSIONERS NOR THE HEALTH DEPARTMENT IS RESPONSIBLE FOR THE SUCCESSFUL OPERATION OF ANY SYSTEM.

10008

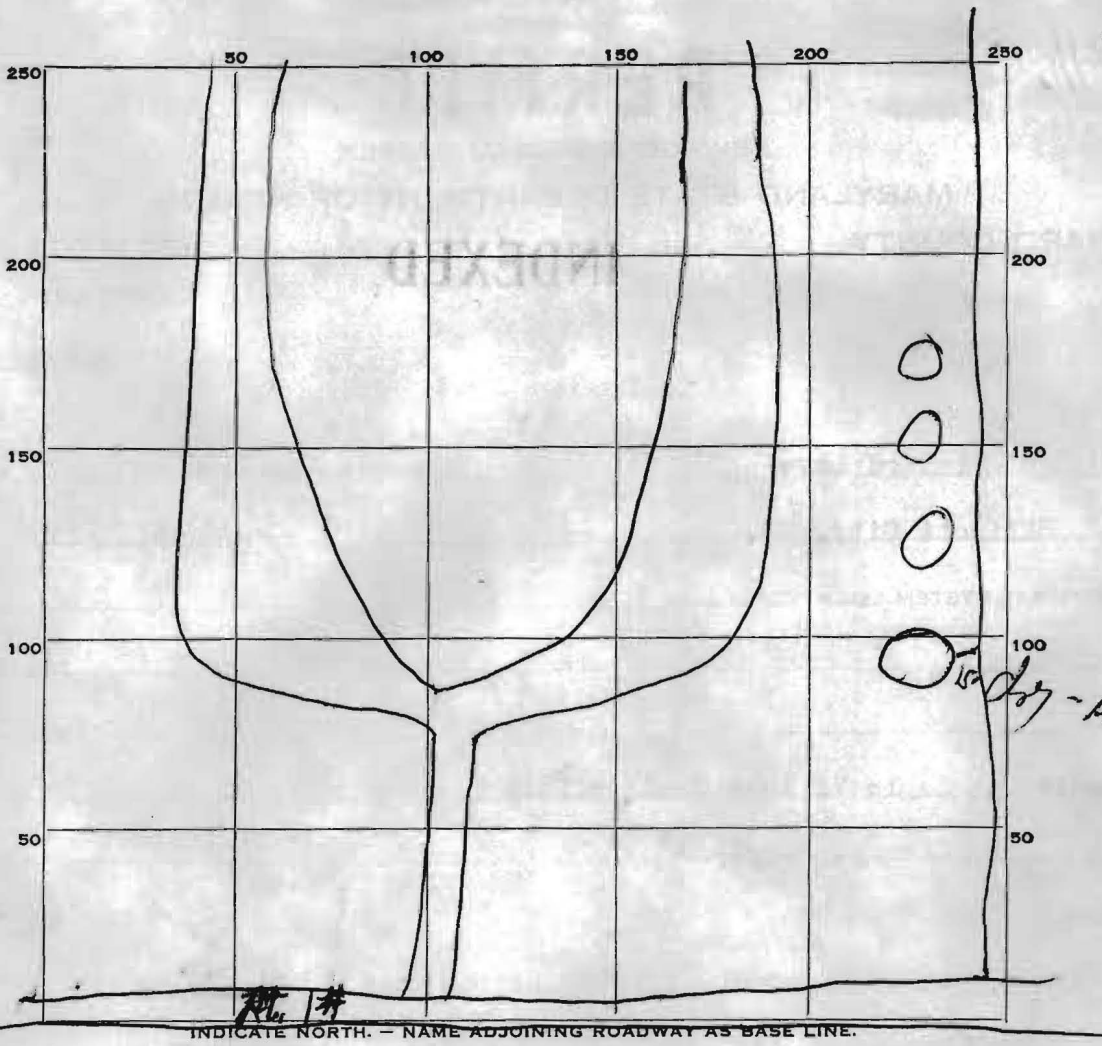

PERMIT CARD ✓

SEPTIC TANK, LEVEL _____

CLEANOUTS _____

DISTRIBUTION BOX, LEVEL _____

TILE FIELD, DEPTH _____ FT. TRENCH WIDTH _____ FT.

GRAVEL DEPTH _____ IN. TOTAL LENGTH _____ FT.

NUMBER OF TRENCHES _____ TOTAL BOTTOM AREA _____

SEEPAGE PITS, INSIDE DIAMETER _____ FT. DEPTH BELOW INLET _____ FT.

ABSORBENT AREA _____ SQ. FT.

REMARKS

Repair job - one 12' X 12' dry-well added. 4/14/65

DATE SYSTEM APPROVED

4/14/65

INSPECTOR

[Signature]