



Building Permit Application

Howard County Maryland
Department of Inspections, Licenses and Permits
3430 Court House Drive
Permits: 410-313-2455
www.howardcountymd.gov

Date Received: _____

Permit No.: _____

Building Address: 15017 Kenwood Ct
 City: Woodbine State: Md Zip Code: 21797
 Suite/Apt. # _____ SDP/WP/BA #: _____
 Census Tract: _____ Subdivision: _____
 Section: _____ Area: _____ Lot: _____
 Tax Map: _____ Parcel: _____ Grid: _____
 Zoning: _____ Map Coordinates: _____ Lot Size: _____

Existing Use: _____
 Proposed Use: 12x48 Deck w/ Pergola
 Estimated Construction Cost: \$ 32,000.00
 Description of Work: 12'x48" Deck around w/ pool w/ 12'x24' Pergola

Occupant or Tenant: _____
 Was tenant space previously occupied? Yes No
 Contact Name: _____
 Address: _____
 City: _____ State: _____ Zip Code: _____
 Phone: _____ Fax: _____
 Email: _____

Commercial Building Characteristics	Residential Building Characteristics	
Height:	<input type="checkbox"/> SF Dwelling <input type="checkbox"/> SF Townhouse	
No. of stories:	<u>Depth</u>	<u>Width</u>
Gross area, sq. ft./floor:	1 st floor:	
<u>578²/ft</u>	2 nd floor:	
Area of construction (sq. ft.):	Basement:	
<u>578²/ft</u>	<input type="checkbox"/> Finished Basement	
Use group:	<input type="checkbox"/> Unfinished Basement	
	<input type="checkbox"/> Crawl Space	
Construction type:	<input type="checkbox"/> Slab on Grade	
<input type="checkbox"/> Reinforced Concrete	No. of Bedrooms:	
<input type="checkbox"/> Structural Steel	Multi-family Dwelling	
<input type="checkbox"/> Masonry	No. of efficiency units:	
<input checked="" type="checkbox"/> Wood Frame	No. of 1 BR units:	
<input type="checkbox"/> State Certified Modular	No. of 2 BR units:	
	No. of 3 BR units:	
	Other Structure:	
	Dimensions:	
<input checked="" type="checkbox"/> Roadside Tree Project Permit	Footings:	
<input type="checkbox"/> Yes <input checked="" type="checkbox"/> No	Roof:	
Roadside Tree Project Permit #	<input type="checkbox"/> State Certified Modular	
	<input type="checkbox"/> Manufactured Home	

Property Owner's Name: Steve and Jen Swales
 Address: 15017 Kenwood Ct
 City: Woodbine State: Md Zip Code: 21797
 Phone: 410 489 9740 Fax: _____
 Email: _____

Applicant's Name & Mailing Address, (If other than stated herein)
 Applicant's Name: Steve Cooley
 Address: 105 Margaret Drive
 City: Stennisville State: Md. Zip Code: 21666
 Phone: 301 252 0179 Fax: _____
 Email: Cooleycoley@yahoo.com

Contractor Company: Cooley Construction LLC
 Contact Person: Steve Cooley
 Address: 105 Margaret Drive
 City: Stennisville State: Md Zip Code: 21666
 License No. 05-130050
 Phone: 301 252 0179 Fax: _____
 Email: Cooleycoley@yahoo.com

Engineer/Architect Company: _____
 Responsible Design Prof.: _____
 Address: _____
 City: _____ State: _____ Zip Code: _____
 Phone: _____ Fax: _____
 Email: _____

Utilities
Water Supply
<input type="checkbox"/> Public
<input checked="" type="checkbox"/> Private
Sewage Disposal
<input type="checkbox"/> Public
<input checked="" type="checkbox"/> Private
Electric: <input type="checkbox"/> Yes <input type="checkbox"/> No
Gas: <input type="checkbox"/> Yes <input type="checkbox"/> No
Heating System
<input type="checkbox"/> Electric <input type="checkbox"/> Oil
<input type="checkbox"/> Natural Gas <input type="checkbox"/> Propane Gas
<input type="checkbox"/> Other:
Sprinkler System:
<input type="checkbox"/> Yes <input type="checkbox"/> No
Grading Permit Number:
Building Shell Permit Number:

THE UNDERSIGNED HEREBY CERTIFIES AND AGREES AS FOLLOWS: (1) THAT HE/SHE IS AUTHORIZED TO MAKE THIS APPLICATION; (2) THAT THE INFORMATION IS CORRECT; (3) THAT HE/SHE WILL COMPLY WITH ALL REGULATIONS OF HOWARD COUNTY WHICH ARE APPLICABLE THERETO; (4) THAT HE/SHE WILL PERFORM NO WORK ON THE ABOVE REFERENCED PROPERTY NOT SPECIFICALLY DESCRIBED IN THIS APPLICATION; (5) THAT HE/SHE GRANTS COUNTY OFFICIALS THE RIGHT TO ENTER ONTO THIS PROPERTY FOR THE PURPOSE OF INSPECTING THE WORK PERMITTED AND POSTING NOTICES.

Applicant's Signature: Steve H. Cooley
 Email Address: Cooleycoley@yahoo.com
 Title/Company: _____

Print Name: Steven H. Cooley
 Date: 4-23-2014

Checks Payable to: DIRECTOR OF FINANCE OF HOWARD COUNTY
 PLEASE WRITE NEATLY & LEGIBLY
 -FOR OFFICE USE ONLY-

AGENCY	DATE	SIGNATURE OF APPROVAL
State Highways		
Building Officials		
PSZA (Zoning)		
PSZA (Engineering)		
Health	<u>4/23/14</u>	<u>[Signature]</u>

Is Sediment Control approval required for issuance? Yes No
 CONTINGENCY CONSTRUCTION START

DPZ SETBACK INFORMATION
Front:
Rear:
Side:
Side St.:
All minimum setbacks met? <input type="checkbox"/> Yes <input type="checkbox"/> No
Is Entrance Permit Required? <input type="checkbox"/> Yes <input type="checkbox"/> No
Historic District? <input type="checkbox"/> Yes <input type="checkbox"/> No
Lot Coverage for New Town Zone:
SDP/Red-line approval date:

Filing Fee	\$
Permit Fee	\$
Tech Fee	\$
Excise Tax	\$
PSFS	\$
Guaranty Fund	\$
Add'l per Fee	\$
Total Fees	\$
Sub-Total Paid	\$
Balance Due	\$
Check	#

Low Voltage Lighting	
SYMBOL	QUANTITY
○	18
△	8
□	5 + 4
◐	6
	Fixture Type
	Path Lights
	Up-Lights
	Pergola Lights
	Rail Lights

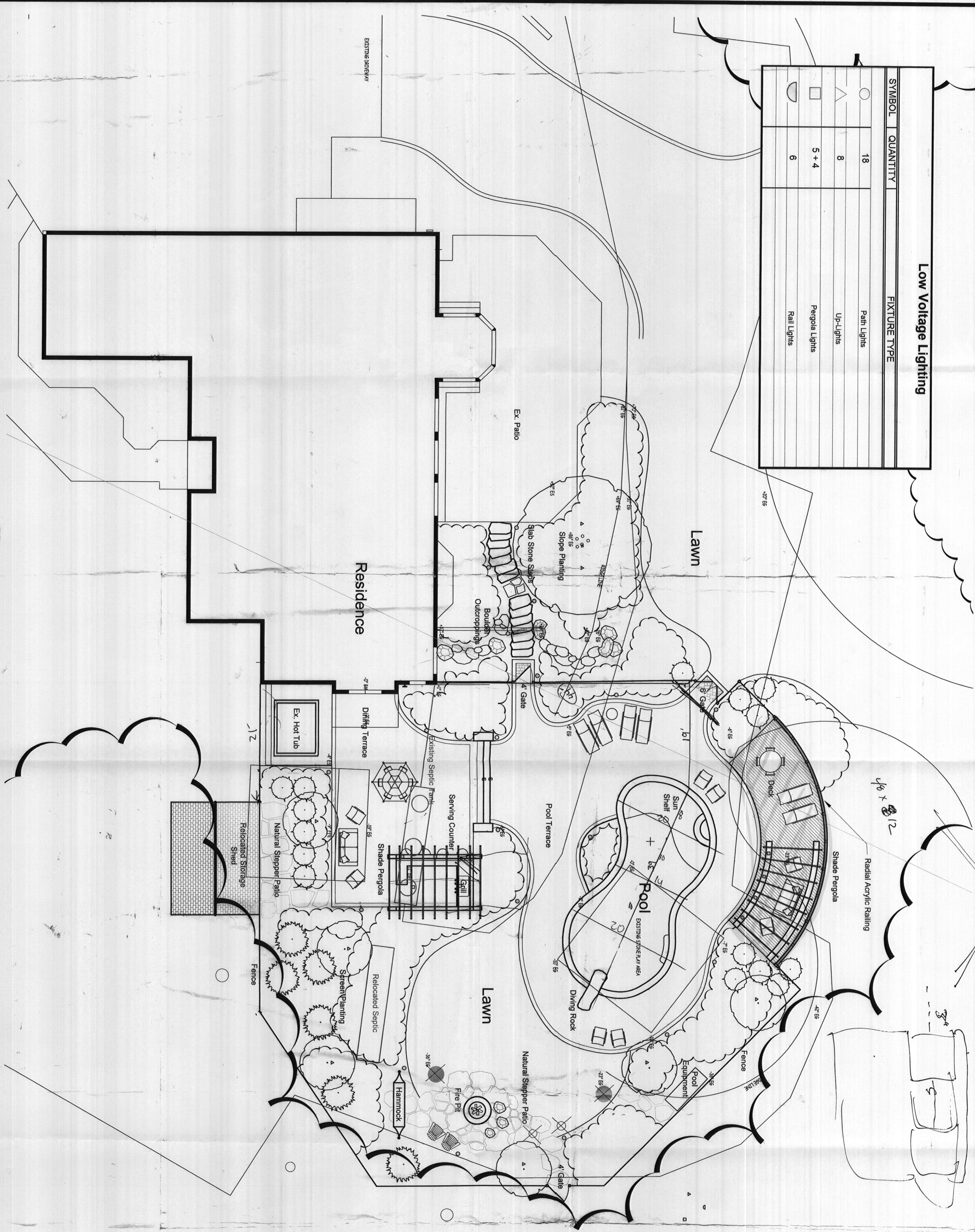

APPROVED
 WALKTHRU BUILDING PERMIT
 A#
 APR SAN K DATE: 4/8/13
 DESC. OF WORK: 12' x 48' deck

SCALE
 1/8"=1'-0"
 PLOT DATE
 April 8, 2013

DRAWING TITLE
 Revised
 Concept Plan
 REVISIONS:
 No. Description: Date:

Swales Residence
 15017
 1507 Kenwood Court Cooksville, MD 21723

Steve Clancy
 Vice President
 Senior Landscape Designer
TOWN CREEK
 LANDSCAPING, CONSTRUCTION & POOLS
 Office: 410-531-6608 x 225 www.towncreeklandscaping.com