

COUNTY #

SOIL PROFILE

496

Topsoil

dt org brn
yellow brn
Hvy Lm
Rock Frag
~100%

1+ beige
white
SAND

Rock Frag
25-35%

Bottom

495 / 497

Topsoil

Strong brn
CL Lm
trace
Rock

black (amorph. sil.)
mica
beige
dk brn
SAND

Rock
~5%

Damp

Bottom

499

like
495/497

water @
12'

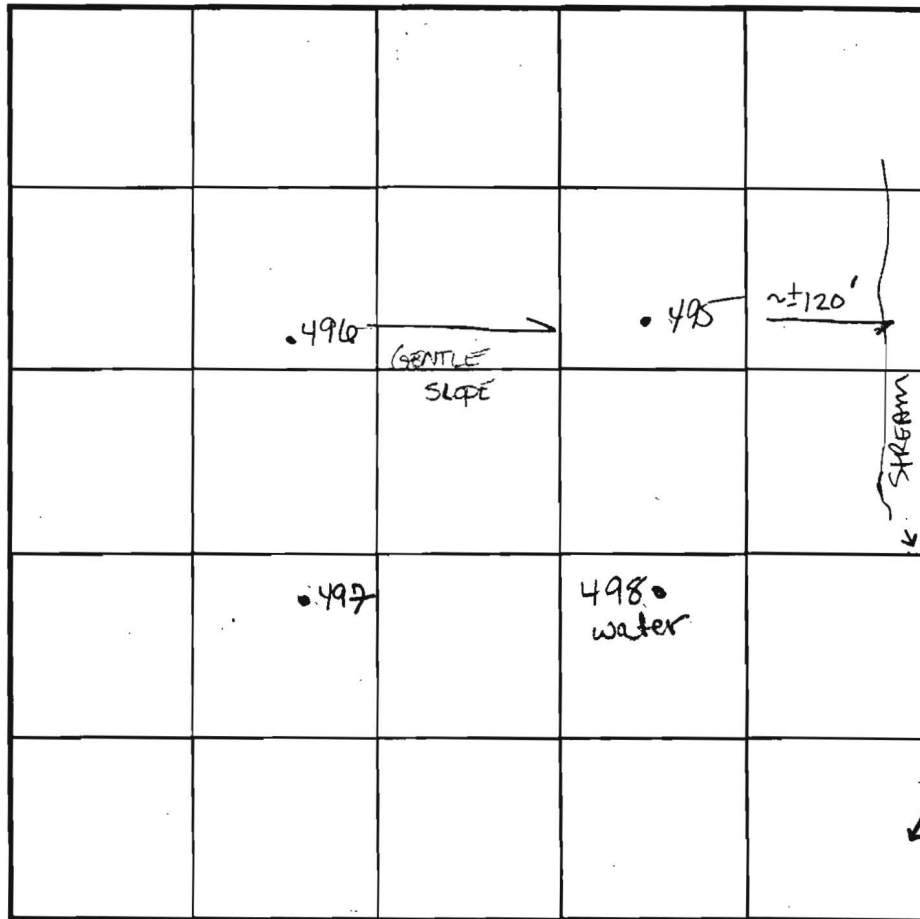

SOIL PROFILE

0'

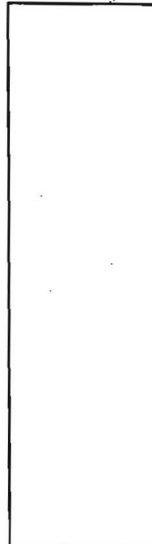

INDICATE NORTH - NAME ADJOINING ROADWAY AS BASE LINE.

HOMWOOD RD

DATE	TEST NO.	DEPTH	PRE-WET		TEST - 1" DROP		TIME	
			START	STOP	START	STOP		
11-15-01	496	6' S	2:30	2:35	2:35	2:43	~7min	
		14' B	—————→				PASS	
	495	5 1/2' S	2:39 ⁵⁵	2:43	2:43	2:52	9min	
		15' B	—————→					
	498	6' S	NOT PERCED		NEED	28' Buffer		
	497	14' Bottom w/ WATER @ 12'	—————→					FAIL
	497	5'10" S	2:56	3:00	3:00	3:19 ³⁰	~19min	
		14' B	—————→				OK	

REMARKS #495 ~9' vein of spherule → H₂O on pec hole wall (suspicious)

TYPE OF SOIL HOLES PER PLAN

TESTED BY Goedeking

ALSO PRESENT Chuck Crow

TRENCH DESIGN DATA: AVERAGE PERCOLATION TIME

TRENCH WIDTH

INLET DEPTH

MAXIMUM BOTTOM DEPTH

SQ. FT./BEDROOM

14'