





## HOWARD COUNTY HEALTH DEPARTMENT

Bureau of Environmental Health  
7178 Columbia Gateway Drive, Columbia MD 21046  
(410) 313-2640 FAX (410) 313-2648  
TDD (410) 313-2323 Toll Free 1-877-4MD-DHMH

---

*Penny E. Borenstein, M.D., M.P.H., County Health Officer*

September 9, 2005

NVR Inc.  
6085 Marshalee Drive, Suite 140  
Elkridge, Maryland 21075

---

**SENT VIA FACSIMILE 410-796-7094**

RE: Homeland, Lot 63  
12017 Grayton Run  
Ellicott City, MD 21042  
BP # B00153794  
**PUBLIC WATER**

Dear Sirs or Madam:

This is to advise that the connection from the house to the street has been installed and inspected for the referenced property. A Community Septic System serves this dwelling. **Final approval was granted on 06/23/2005 by HCHD for the house connection.**

The property is served by public water and is therefore exempt from the Health Department water sampling requirements.

By issuance of this letter, this office recommends release of the Use and Occupancy permit for the referenced property.

### RECOMMENDATION FOR USE AND OCCUPANCY

Respectfully,

*Brian Baker*

Brian Baker, R. S.  
Well and Septic Program

cc: DILP, Building Inspectors Office  
File

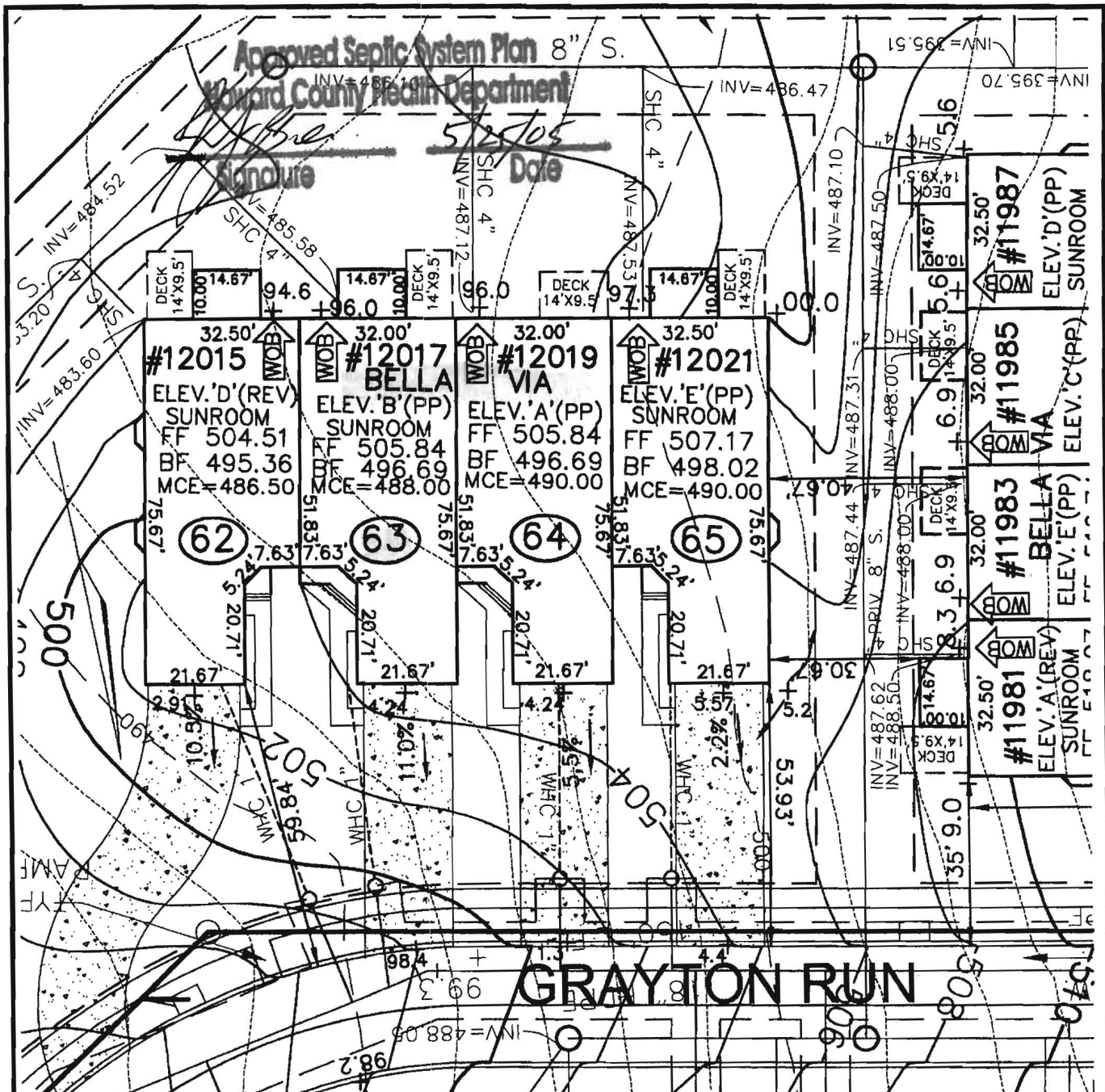

**ROBERT H. VOGEL ENGINEERING, INC.**  
 ENGINEERS • SURVEYORS • PLANNERS  
 8407 MAIN STREET TEL: 410.461.7666  
 ELLICOTT CITY, MD 21043 FAX: 410.461.8961

SCALE 1"=30'  
 DRAWN BY JCO  
 CHECKED BY RHV  
 DATE APRIL, 2005  
 W. O. # 04-87.00  
 SHEET# 1 OF 1

**NV HOMES**  
**ELLICOTT MEADOWS**  
**UNITS 62-65**

HOMELAND SDP-03-30  
 TAX MAP 16  
 3RD ELECTION DISTRICT

PARCEL 53,96,165&204  
 HOWARD COUNTY, MARYLAND

B00153794