

PERMITS TO BE INSTALLED FIRST
BEFORE BUILDING PERMIT CAN
BE SIGNED

serial # 37066

11-14-78

PERMIT

Needs to be connected
11/10/79

16 MAR 79 Approved
29087

64

A 2000 AS 2068

SEWAGE DISPOSAL SYSTEM

MARYLAND STATE DEPARTMENT OF HEALTH

11/1/78
Howard County
final copy if possible
Wed.

11/8/78

INDEXED

ELLICOTT CITY

DISTRICT 3rd

DATE 10/20/78

11/20/79
George Kirgerman

R. L. Orndorff

IS PERMITTED TO INSTALL ALTER

ADDRESS Highland, Maryland 20777 PHONE

SUBDIVISION Kingston ROAD 3534 Kingston Court LOT 7, Sec. 3

PROPERTY OWNER Mark and Evelyn Dardon Daniel Dawson

ADDRESS 7820 Bruton Court, GlencBurnie, Md. 21061 Phone: 760-8269

SPECIFICATIONS 4 bedrooms

BUILDING PERMIT SIGNED
AND RETURNED

SEPTIC TANK CAPACITY 1250 GALLONS

DRAIN FIELD DEPTH FEET. BOTTOM AREA SQ. FT.

DEEP TRENCH DEPTH FEET. BOTTOM AREA SQ. FT.

SEEPAGE PITS ABSORBENT SIDE-WALL AREA 364 SQ. FT. total sidewall area in dry well.

INLET PIPE 3 FT. BELOW ORIGINAL GRADE. MAXIMUM DEPTH 10 FT. BELOW ORIGINAL GRADE

EFFECTIVE DEPTH AT FT. BELOW ORIGINAL GRADE.

LOCATE DISPOSAL AREA 110 FT. FROM 193.26' LOT LINE AND 25 FT. FROM 213' LOT LINE

Trench to be 20 ft. long and run towards 193 ft. lot line parallel to 213 ft. lot

line. NOTE: CALL FOR INSPECTION OF TRENCH BEFORE PLACING GRAVEL IN TRENCH. LEAVE

5 FT. EARTH BUFFER BETWEEN TRENCH AND DRY WELL.

PLANS APPROVED BY David J. O'Neill DATE 7/25/75

COVER NO WORK UNTIL INSPECTED AND APPROVED.

NEITHER THE HOWARD COUNTY COUNCIL NOR THE HEALTH DEPARTMENT IS RESPONSIBLE FOR THE SUCCESSFUL OPERATION OF ANY SYSTEM.

NOTE: IF TRENCH IS USED CALL FOR INSPECTION BEFORE PLACING GRAVEL IN TRENCH.

NOTE: NO DRY WELL SHALL EXCEED 15 FOOT IN DIAMETER.

NOTE: ALL PIPE FROM HOUSE TO DISPOSAL AREA MUST BE CAST IRON.

PERMIT VOID AFTER THREE YEARS.

NOTE: INSTALL STAND PIPE ON SEPTIC TANK AND DRY WELL. STAND PIPES MUST BE 6 INCHES IN DIAMETER. CAST IRON, CONCRETE OR TERRA

COTTA ACCEPTED

*INSTALLER IS RESPONSIBLE FOR OBTAINING FINAL APPROVAL ON THIS PERMIT.

HD - 23

BLDG. PERMIT SIGNED
AND RETURNED 11/15/78
serial # 37066

BLDG. PERMIT SIGNED
AND RETURNED 11/15/78

Serial # 22229
Addition

19668 AS 2068 F

14
13
13
55

55
35
155
175
175
1925
3025

fee simple strip

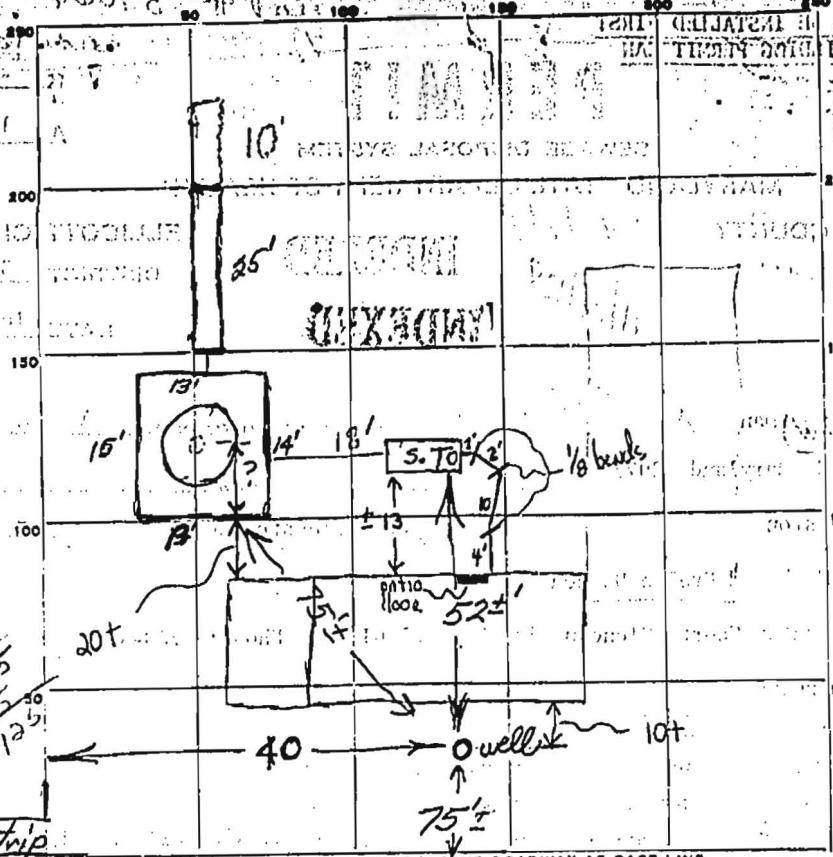

INDICATE NORTH. - NAME ADJOINING ROADWAY AS BASE LINE.

PERMIT CARD NO - WORKED TO RESOLVE 3/16 - NONE SEEN

SEPTIC TANK, LEVEL CLEANOUTS CAST IRON

DISTRIBUTION BOX, LEVEL N.A.S.

TILE FIELD, DEPTH 10 FT. TRENCH WIDTH 2 FT.

GRAVEL DEPTH 5.5 IN. TOTAL LENGTH 35 FT.

NUMBER OF TRENCHES 1 TOTAL BOTTOM AREA 193

SEEPAGE PITS, INSIDE DIAMETER 55 FT. DEPTH BELOW INLET 5.5 FT. 305

ABSORBENT AREA ±496 SQ. FT. 496

REMARKS 1/6/78. ok to gravel trench, must raise pipe d.w. to trench to no deeper than 3 1/2', raise pipes septic tank to gravel, to rest on top row of blocks, NOT 2nd row. From melt informed installer to add another 20 ft. to trench, near impossible to raise pipes to needed heights to achieve sq. ft.

1/16/78 130 NO FURTHER PROGRESS PH 8 Nov 78 - Gravel in trench -

(no trenching) (not for seepage) Also install gravel in well (not) (GLK on 10' sections)

DATE SYSTEM APPROVED 1/14/78 16 MAR 79 INSPECTOR George L. Keller

need 504 #