

# APPLICATION

A 18668

## SEWAGE DISPOSAL TESTING

P \_\_\_\_\_

STATE OF MARYLAND - DEPARTMENT OF HEALTH AND MENTAL HYGIENE

HOWARD COUNTY HEALTH DEPARTMENT  
ENVIRONMENTAL HEALTH SERVICES  
P.O. BOX 476, ELLICOTT CITY, MARYLAND 21043  
TELEPHONE: 465-8000, EXT. 386

DISTRICT 3d.  
DATE 5-3-73

TO: THE COUNTY HEALTH OFFICER  
ELLICOTT CITY, MARYLAND

*System in first.*

I, HEREBY, APPLY FOR THE NECESSARY TEST IN ORDER TO CONSTRUCT (OR RECONSTRUCT) A SEWAGE DISPOSAL SYSTEM.

PROPERTY OWNER

James W. Kingbe - 6567 Innetown Rd.

ADDRESS

Simpsonville, Md. 21150 PHONE 531-5549

PROPERTY LOCATION:

SUBDIVISION

Kingston

LOT NO.

~~500~~ Sec. <sup>3</sup> 84

ROAD AND DESCRIPTION

off William Field Drive - first drive past Rosemary Lane & Philadelphia Rd.

SIZE OF LOT

51,131 sq. ft.

TYPE BLDG.

NUMBER OF BEDROOMS

IF NOT SINGLE RESIDENCE DESCRIBE \_\_\_\_\_

THE SYSTEM INSTALLED UNDER THIS APPLICATION IS ACCEPTABLE ONLY UNTIL PUBLIC FACILITIES BECOME AVAILABLE.

SIGNATURE OF APPLICANT

James W. Kingbe

APPROVED BY

David P. Hill

FOR

Pro. Well + Trench  
(KIND OF SYSTEM)

DATE

7/25/75

REJECTED BY \_\_\_\_\_

FOR \_\_\_\_\_

(KIND OF SYSTEM)

DATE \_\_\_\_\_

HOLD PENDING FURTHER TESTS \_\_\_\_\_

DATE \_\_\_\_\_

REASONS FOR REJECTION OR HOLDING \_\_\_\_\_

# THIS IS NOT A PERMIT

# APPLICATION

18668

SEWAGE DISPOSAL TESTING  
STATE OF MARYLAND - DEPARTMENT OF HEALTH AND MENTAL HYGIENE  
HOWARD COUNTY HEALTH DEPARTMENT  
ENVIRONMENTAL HEALTH SERVICES  
P. O. BOX 476, ELLICOTT CITY, MARYLAND 21043  
TELEPHONE: 463-1000, EXT. 386

P. \_\_\_\_\_  
DISTRICT 3rd  
DATE 5-3-73

Dry well to be 100' from 192' lot line 25' from 213' lot line

TO: THE COUNTY HEALTH OFFICER  
ELLICOTT CITY, MARYLAND

I, HEREBY, APPLY FOR THE NECESSARY TEST IN ORDER TO CONSTRUCT (OR RECONSTRUCT) A SEWAGE DISPOSAL SYSTEM.

PROPERTY OWNER

ADDRESS

James W. King 6567 Innetown Rd.  
Simpsonville, Md. 21150 PHONE 531-5549

PROPERTY LOCATION:

SUBDIVISION

LOT NO.

ROAD AND DESCRIPTION

SIZE OF LOT

TYPE BLDG.

NUMBER OF BEDROOMS

IF NOT SINGLE RESIDENCE DESCRIBE

THE SYSTEM INSTALLED UNDER THIS APPLICATION IS ACCEPTABLE ONLY UNTIL PUBLIC FACILITIES BECOME AVAILABLE.

SIGNATURE OF APPLICANT

APPROVED BY

FOR

(KIND OF SYSTEM)

DATE

REJECTED BY

FOR

(KIND OF SYSTEM)

DATE

HOLD PENDING FURTHER TESTS

DATE

REASONS FOR REJECTION OR HOLDING

## THIS IS NOT A PERMIT



# APPLICATION

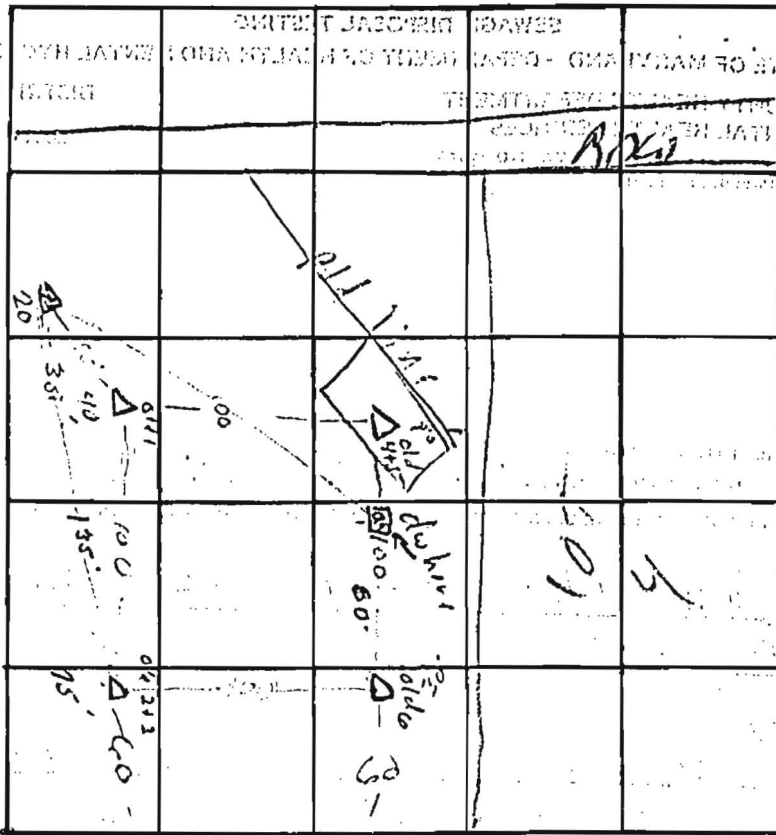

INDICATE NORTH - NAME ADJOINING ROADWAY AS BASE LINE.

lot 4

lot 4

DATE	TEST NO.	DEPTH	PRE-WET		TEST - 1" DROP		TIME
			START	STOP	START	STOP	
7/21/75	7 d	12'	1:42	1:45	1:45	1:57	12
"	7 s	3'	1:40	1:41	1:41	1:42	7

Com. org.  
inlet 3ft

REMARKS: Place House on old hole 4+5 dry well 100' From Right Property line 30' From Front of lot

O'Neill 5/24/75 King + Representatives of Purdon + Sible pres