

PUB. SEWER STATUS VERIFIED BY _____

ISSUE DATE: _____

P 520408-B

APPROVAL DATE: _____

A RE-INDEX

PERMIT INDEXED

**ON-SITE SEWAGE DISPOSAL SYSTEM
HOWARD COUNTY HEALTH DEPARTMENT
BUREAU OF ENVIRONMENTAL HEALTH**

TAX ID # 03-286134

_____ IS PERMITTED TO INSTALL ALTER

ADDRESS: _____ PHONE NUMBER: _____

SUBDIVISION: Kingston LOT NUMBER: 2

ADDRESS: 3584 Katashley Court PROPERTY OWNER: _____

SEPTIC TANK CAPACITY (GALLONS): _____

PUMP CHAMBER CAPACITY (GALLONS): _____

NUMBER OF BEDROOMS: _____

SQUARE FEET PER BEDROOM: _____

LINEAR FEET OF TRENCH REQUIRED: _____

TRENCHES:	Trench to be _____ feet wide. Inlet _____ feet below original grade. Bottom maximum depth _____ feet below original grade. Effective area begins at _____ feet below original grade. _____ feet of stone below distribution pipe.
LOCATION:	
PURPOSE:	Reindex file 7/30/04

PLANS APPROVED: _____ DATE: _____

- NOTE: PERMIT VOID AFTER 2 YEARS
- NOTE: CONTRACTOR RESPONSIBLE FOR SCHEDULING A PRE-CONSTRUCTION INSPECTION FOR ALL INSTALLATIONS
- NOTE: WATERTIGHT SEPTIC TANKS REQUIRED
- NOTE: ALL PARTS OF SEPTIC SYSTEM SHALL BE 100 FEET FROM ANY WATER WELL
- NOTE: MANHOLE RISERS REQUIRED ON ALL SEPTIC TANKS AND PUMP CHAMBERS

**NEITHER THE HOWARD COUNTY COUNCIL OR THE HEALTH DEPARTMENT IS
RESPONSIBLE FOR THE SUCCESSFUL OPERATION OF ANY SYSTEM
PERMITTEE RESPONSIBLE FOR OBTAINING FINAL APPROVAL ON THIS PERMIT
CALL 410-313-2640 FOR INSPECTION OF SEPTIC SYSTEM**

**BUILDING PERMIT SIGNED
AND RETURNED**

5/16/2004 B00148454 DECK
2/28/05 B00152356 - LP TANK
3-31-05 B00152941 - GARAGE

P 520 408-B

10/20/79
amending
please

PERMIT

30408
A 11377

SEWAGE DISPOSAL SYSTEM
MARYLAND STATE DEPARTMENT OF HEALTH*

HOWARD COUNTY

ELLICOTT CITY

DISTRICT 3rd

INDEXED

DATE 9/25/79

South Carroll Backhoe Service IS PERMITTED TO INSTALL ALTER

ADDRESS 7311 Brangles Road, Marriottsville, Md. 21104 PHONE 795-2642

SUBDIVISION Kingston ROAD 3584 Ketchley Court LOT 6, Sec. 2

PROPERTY OWNER William A. Conway

ADDRESS 3015 Oak Hill Avenue, Baltimore, Md. 21207

SPECIFICATIONS 3 bedrooms
SEPTIC TANK CAPACITY 1000 GALLONS
DRAIN FIELD _____ DEPTH _____ FEET, BOTTOM AREA _____ SQ. FT.
SEEP TRENCH _____ DEPTH _____ FEET, BOTTOM AREA _____ SQ. FT.
SEEPAGE PITS ABSORBENT SIDEWALL AREA 360 SQ. FT.
INLET PIPE 3/4 FT. BELOW ORIGINAL GRADE, MAXIMUM DEPTH 10 FT. BELOW ORIGINAL GRADE
EFFECTIVE DEPTH AT _____ FT. BELOW ORIGINAL GRADE.
LOCATE DISPOSAL AREA 7 1/2 FT. FROM SEWER LOT LINE AND 20 FT. FROM LEFT LOT LINE AS SHOWN WHEN
FACING LOT FROM Ketchley Court.

BEK OKAY TO USE TRENCH OFF DRY WELL TO MAKE UP ABSORBENT SIDEWALL AREA IN SYSTEM.

LEAVE 5 FT. BARTH BUFFER BETWEEN TRENCH AND DRY WELL. TRENCH TO FOLLOW CONTOUR OF THE LAND.

PLANS APPROVED BY Donald W. Montaghan DATE 12/12/72

- COVER NO WORK UNTIL INSPECTED AND APPROVED.
- NEITHER THE HOWARD COUNTY COUNCIL NOR THE HEALTH DEPARTMENT IS RESPONSIBLE FOR THE SUCCESSFUL OPERATION OF ANY SYSTEM
- NOTE: IF TRENCH IS USED CALL FOR INSPECTION BEFORE PLACING GRAVEL IN TRENCH.
- NOTE: NO DRY WELL SHALL EXCEED 16 FOOT IN DIAMETER.
- NOTE: ALL PIPE FROM HOUSE TO DISPOSAL AREA MUST BE CAST IRON.
- PERMIT VOID AFTER THREE YEARS.
- NOTE: INSTALL STAND PIPE ON SEPTIC TANK AND DRY WELL. STAND PIPES MUST BE 8 INCHES IN DIAMETER, CAST IRON, CONCRETE OR TERRA COTTA ACCEPTED.

***INSTALLER IS RESPONSIBLE FOR OBTAINING FINAL APPROVAL ON THIS PERMIT.**

BLDG. PERMIT SIGNED
AND RETURNED 11/21/79
Dist # 67946
Quintman

113377

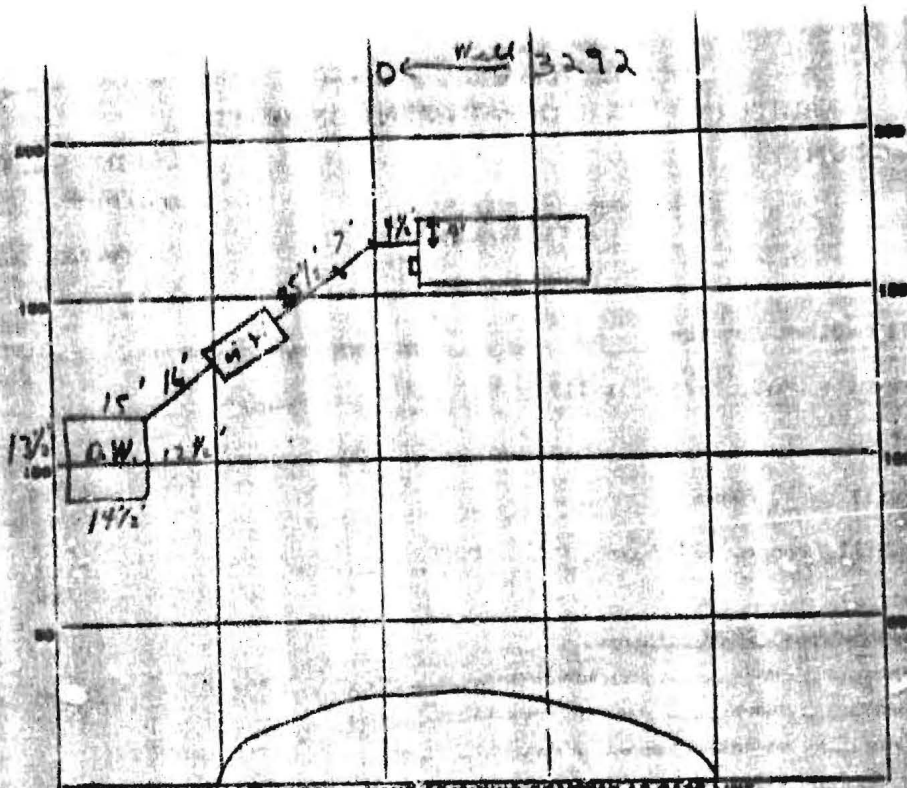

INDICATE NORTH - NAME ADJOINING ROADWAY AS BASE LINE.

Ratselley Court

PERMIT CARD S.T. D.W.

SEPTIC TANK LEVEL CLEANOUTS

DISTRIBUTION BOX LEVEL _____

TILE FIELD S-PTH _____ FT. TRENCH WIDTH _____ FT.

GRAVEL DEPTH _____ IN. TOTAL LENGTH _____ FT.

NUMBER OF TRENCHES _____ TOTAL BOTTOM AREA _____

SEEPAGE FITS. IN. DIAMETER 5.5 FT. DEPTH BELOW INLET 6.5 FT.

ABSORBENT AREA 360 SQ. FT.

REMARKS: 10/26/77 System installed
CBV

DATE SYSTEM APPROVED 10/26/77 INSPECTOR C. B. [Signature]