

5/24/78
Trench Insp.
3/19/78
around now possible

Final
5/23/78

PERMIT

SEWAGE DISPOSAL SYSTEM

MARYLAND STATE DEPARTMENT OF HEALTH*

HOWARD COUNTY

P 28035
A 26208

ELLICOTT CITY

DISTRICT 5th

DATE 5/11/78

INDEXED

Allen H. Mitchell IS PERMITTED TO INSTALL ALTER

ADDRESS 16487 Frederick Road, Woodbine, Md. 21797 PHONE 442-2920

SUBDIVISION Hallmark ROAD 11318 Johns Hopkins Road LOT 16, Sec. 1

PROPERTY OWNER John Mikolasko

ADDRESS **BUILDING PERMIT SIGNED**

SPECIFICATIONS 4 bedrooms
SEPTIC TANK CAPACITY 1250 GALLONS
4-24-03 BOD 141499-DECK

DRAIN FIELD DEPTH FEET, BOTTOM AREA SQ. FT.

DEEP TRENCH 10 DEPTH 60 FEET, BOTTOM AREA SQ. FT.

SEEPAGE PITS ABSORBENT SIDE-WALL AREA 312 SQ. FT. total sidewall area in dry well

INLET PIPE 3 1/2 FT. BELOW ORIGINAL GRADE. MAXIMUM DEPTH 10 FT. BELOW ORIGINAL GRADE

EFFECTIVE DEPTH AT FT. BELOW ORIGINAL GRADE

LOCATE DISPOSAL AREA 150 FT. FROM Johns Hopkins Road AND 12 FT. FROM Lot 15

~~XXXXXXXXXXXX~~ (right) lot line.

Trench to run on contour of land towards Lot 17.

PLANS APPROVED BY David J. O'Neill DATE 11/29/78

COVER NO WORK UNTIL INSPECTED AND APPROVED.

NEITHER THE HOWARD COUNTY COUNCIL NOR THE HEALTH DEPARTMENT IS RESPONSIBLE FOR THE SUCCESSFUL OPERATION OF ANY SYSTEM.

NOTE: IF TRENCH IS USED CALL FOR INSPECTION BEFORE PLACING GRAVEL IN TRENCH.

NOTE: NO DRY WELL SHALL EXCEED 15 FOOT IN DIAMETER.

NOTE: ALL PIPE FROM HOUSE TO DISPOSAL AREA MUST BE CAST IRON.

PERMIT VOID AFTER THREE YEARS.

NOTE: INSTALL STAND PIPE ON SEPTIC TANK AND DRY WELL. STAND PIPES MUST BE 6 INCHES IN DIAMETER. CAST IRON, CONCRETE OR TERRA COTTA ACCEPTED.

*INSTALLER IS RESPONSIBLE FOR OBTAINING FINAL APPROVAL ON THIS PERMIT.

A 26208

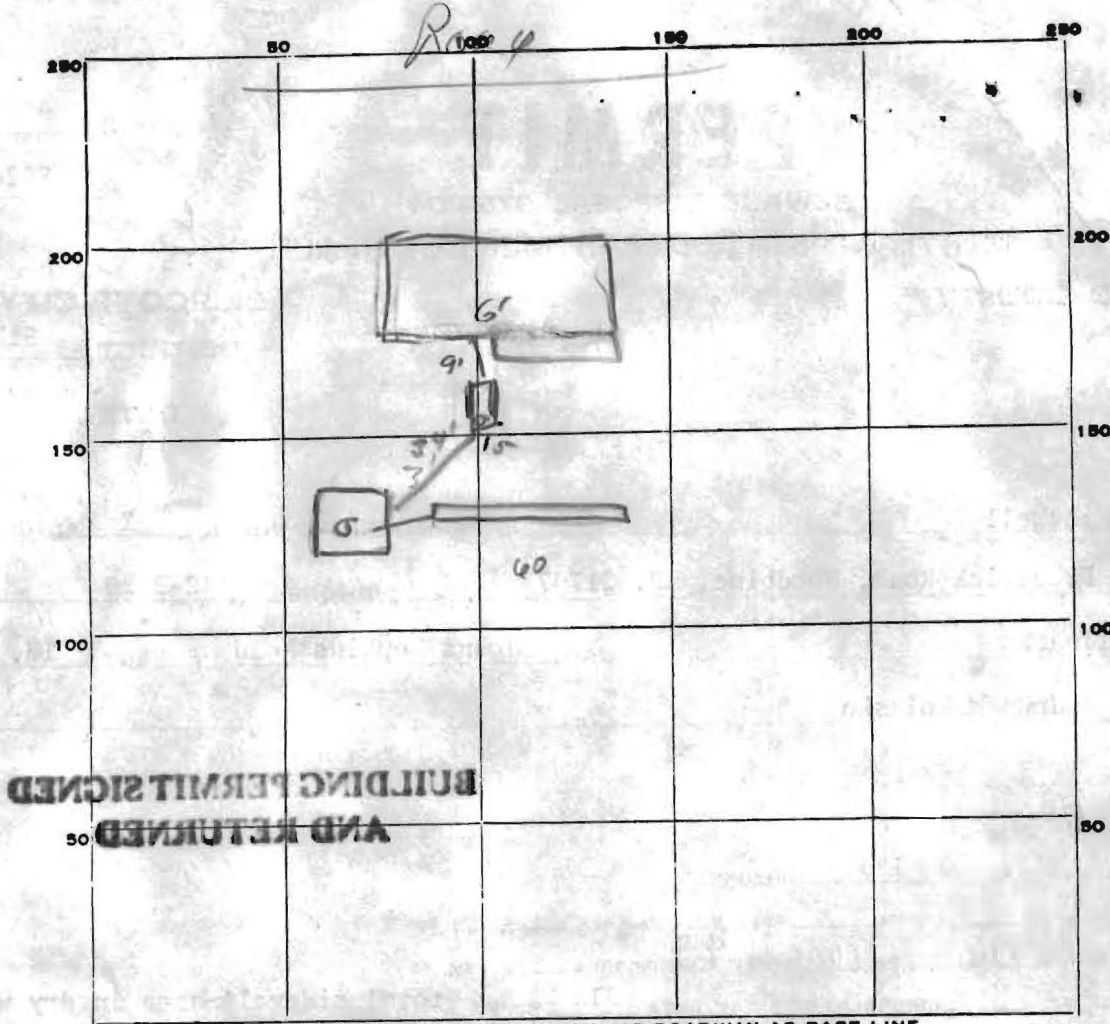

INDICATE NORTH. - NAME ADJOINING ROADWAY AS BASE LINE.

PERMIT CARD

SEPTIC TANK, LEVEL

CLEANOUTS

DISTRIBUTION BOX, LEVEL NA

TILE FIELD, DEPTH 9-10 FT. TRENCH WIDTH 2 FT.

GRAVEL DEPTH 2' IN. TOTAL LENGTH 60' FT.

NUMBER OF TRENCHES 1 TOTAL BOTTOM AREA 420

SEEPAGE PITS, INSIDE DIAMETER 48 FT. DEPTH BELOW INLET 5 1/2 FT.

ABSORBENT AREA 360 SQ. FT.

5
45
7.5
240
336

REMARKS upon 5/19/48 system ok to 857 point
needs east man, cleanouts, strong dist pipe etc.

DATE SYSTEM APPROVED 5/23/48 INSPECTOR Phil G. W.