

PUB. SEWER STATUS VERIFIED BY _____

1/6/04 1:00

ISSUE DATE: 1/5/2004

P 520016

APPROVAL DATE: 3/24/04

A REPAIR

PERMIT INDEXED

ON-SITE SEWAGE DISPOSAL SYSTEM HOWARD COUNTY HEALTH DEPARTMENT BUREAU OF ENVIRONMENTAL HEALTH

04-329031

Jack Fyock Septic System SERVICE IS PERMITTED TO INSTALL ALTER

ADDRESS: PO Box 89, Glenelg, MD 21737 PHONE NUMBER: 410-988-9270

SUBDIVISION: WARFIELD ESTATES LOT NUMBER: 10, BL B, 54

ADDRESS: 14505 MacClintock DRIVE PROPERTY OWNER: Sturges

SEPTIC TANK CAPACITY (GALLONS): Existing 3' Wide Trenches

PUMP CHAMBER CAPACITY (GALLONS): N/A Inlet at 3'

NUMBER OF BEDROOMS: 3 Bottom at 5'

SQUARE FEET PER BEDROOM: 210 10' center spacing

LINEAR FEET OF TRENCH REQUIRED: 150 → One 60' trench and one 90' trench

TRENCHES:	Trench to be _____ feet wide. Inlet _____ feet below original grade. Bottom maximum depth _____ feet below original grade. Effective area begins at _____ feet below original grade. _____ feet of stone below distribution pipe.
LOCATION:	
PURPOSE:	Septic system is failing. Call for inspection when the ground has been opened so sanitarian can recommend repair.

PLANS APPROVED: BB DATE: 1/5/04

- NOTE: PERMIT VOID AFTER 2 YEARS
- NOTE: CONTRACTOR RESPONSIBLE FOR SCHEDULING A PRE-CONSTRUCTION INSPECTION FOR ALL INSTALLATIONS
- NOTE: WATERTIGHT SEPTIC TANKS REQUIRED
- NOTE: ALL PARTS OF SEPTIC SYSTEM SHALL BE 100 FEET FROM ANY WATER WELL
- NOTE: MANHOLE RISERS REQUIRED ON ALL SEPTIC TANKS AND PUMP CHAMBERS

NEITHER THE HOWARD COUNTY COUNCIL NOR THE HEALTH DEPARTMENT IS RESPONSIBLE FOR THE SUCCESSFUL OPERATION OF ANY SYSTEM PERMITTEE RESPONSIBLE FOR OBTAINING FINAL APPROVAL ON THIS PERMIT CALL 410-313-2640 FOR INSPECTION OF SEPTIC SYSTEM

P520016

NOT TO SCALE

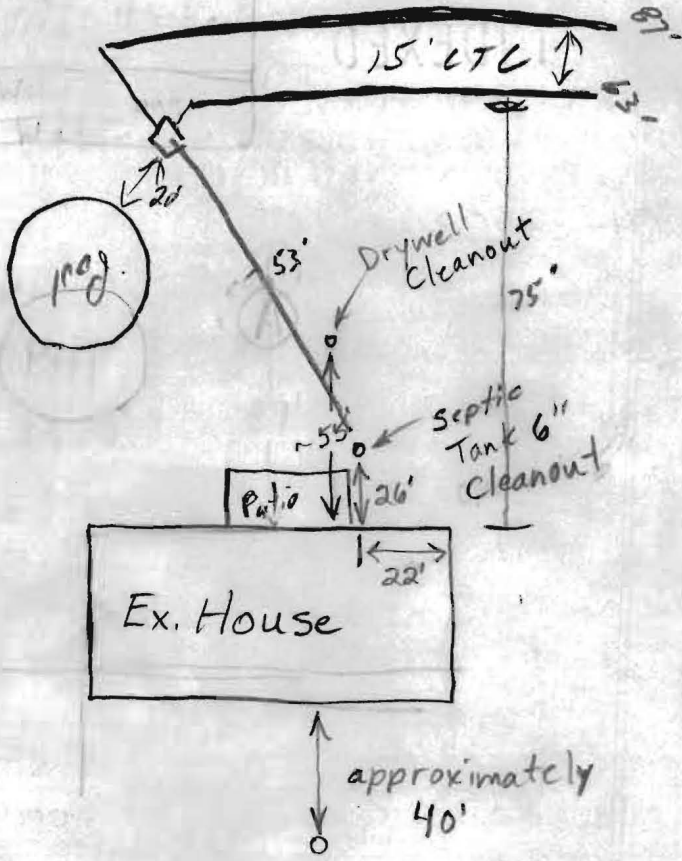

40-73-0827

MacClintock Drive

TRENCH/DRAINFIELD DATA		
WIDTH	INLET	BOTTOM
3'	3'	5'
NUMBER OF TRENCHES	2	
TOTAL LENGTH	150'	
ABSORPTION AREA	450 0	
DISTRIBUTION BOX LEVEL	<input checked="" type="checkbox"/>	
DISTRIBUTION BOX BAFFLE	<input checked="" type="checkbox"/>	
DISTRIBUTION BOX PORT	<input checked="" type="checkbox"/>	

SEPTIC TANK DATA	
SEPTIC TANK 1 LEVEL	_____
CAPACITY	Existing GAL
SEAM LOC	_____
TANK LID DEPTH	_____
BAFFLES	_____
BAFFLE FILTER	_____
MANHOLE LOC	_____
6" PORT LOC	_____
WATERTIGHT TEST	_____
SEPTIC TANK 2 LEVEL	N/A
CAPACITY	_____ GAL
SEAM LOC	_____
TANK LID DEPTH	_____
BAFFLES	_____
BAFFLE FILTER	_____
MANHOLE LOC	_____
6" PORT LOC	_____
WATERTIGHT TEST	_____

PRE-CONSTRUCTION 1/6/03 To install a 60' trench near the bottom of the pool and a 90' trench farther downhill where there is more room. The drywell is to be pumped out and filled. (BB)

3/24/04 - OK to cover all work (SO)

FINAL INSPECTOR Jim B...

DATE OF APPROVAL 3/24/04