

THIS REPORT
MUST BE SUBMITTED
WITHIN 30 DAYS
AFTER COMPLETION
OF THE WELL

WELL COMPLETION REPORT

WELL DESCRIPTION

WELL LOG

State the kind of formations penetrated, their color, their depth, their thickness, and if water-bearing

Shale + sand
Sand Rock

FEET
from 0 to 45
45-77

CASING AND SCREEN RECORD

State the kind and size and position of casing, liner, shoe, screen, and other accessories (if no casing used, give diameter of well).

Steel
Casing

DIAM.
(inches)
6 1/4

FEET
from 0 to 45

Permit Number Ho-67-W-275
Owner COUNTRY HOMES LTD
Address _____
Subdivision Indian Hills
Section _____ Lot 1

PUMPING TEST

Hours Pumped 2
Type of Pump Used Batter
Pumping Rate _____
Gallons per Minute 8

WATER LEVEL

(Distance from land surface to water)
Before Pumping 45' Ft.
When Pumping 70' Ft.

APPEARANCE OF WATER

Clear Cloudy _____
Taste NONE
Odor NONE

Height of Casing Above Land

Surface 1 Ft.

PUMP INSTALLED

Type _____
Capacity _____
Gallons per Minute _____
Gallons per Hour _____
Pump Column Length _____ Ft.

LOCATION OF WELL ON LOT

Show permanent structures such as building(s), septic tank, and/or other landmarks and indicate not less than 2 distances (measurements) to well.

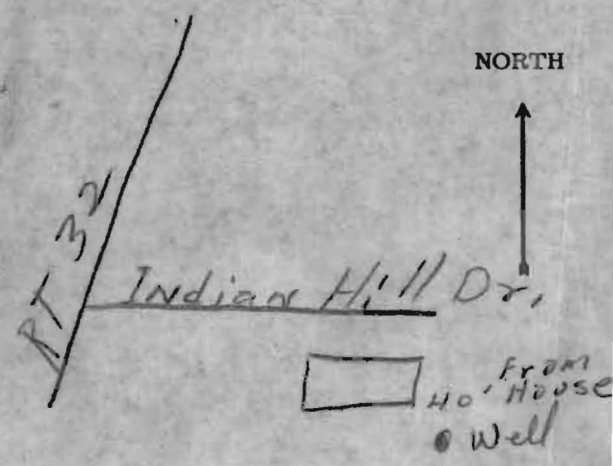

DATE
WELL WAS
COMPLETED

6/7/67

I hereby affirm that this report contains no willful misrepresentations or falsifications and that information given in this report is true, accurate and complete to the best of my knowledge and belief.

Greg E Hart, Well Driller

Well Driller License No.: 279

APPLICATION MUST BE SUBMITTED AND PERMIT RECEIVED BEFORE DRILLING IS STARTED.

A10586

APPLICATION FOR PERMIT TO DRILL WELL

420.963

Owner Country Homes Ltd.

Driller George Hart License Number 279

Street or R. F. D. South western Blvd.

Street or R. F. D. Box 347 Owings Mills, Md.

Post Office Baltimore, Md. 21227

Date June 5, 1967

Quantity of Water to be Produced 5 Gallons Per Minute

Location of Well County Howard

Total Quantity Needed For Use 250 Gallons Per Day

Subdivision Indian Hills

Use for Water Domestic

Section _____ Lot 1

Approximate Depth of Well (feet) 80'

Nearest Town Sykesville

Method of Drilling to be used Cable

Distance from Town 2 miles

Is this a Replacement Well? Yes - No

Direction from Town southeast

If YES, indicate date abandoned well is to be sealed: _____ and by whom: _____

Description of Location of Well (This information MUST BE ACCURATE, and should be definite enough to permit locating well on a county map).

Near what road Indian Hill Drive

On which side of road south
(North, East, South, West)

Distance from road about 70'

PERMIT TO DRILL WELL
(Not To Be Filled In By Driller)

Draw a sketch below showing location of well in relation to nearby towns, roads and streams with north in the direction of the arrow, and give distance from well to nearest road junction or stream crossing shown on the sketch. Distances may be approximate, but must be indicated.

Well Permit No. Ho-67-W-275

Samples of Cuttings Required by Department: Yes No
Owner Requires Permit to Appropriate Water: Yes No
Owner Has Permit to Appropriate Water: Yes No

Appropriation Permit No. _____
The applicant is herewith granted a permit to drill this well subject to the conditions stated.
Paul W. McKee Dir. 6-7-67
Director Date

THIS PERMIT IS NOT TRANSFERABLE
WITHOUT WRITTEN PERMISSION FROM THE DEPARTMENT
Special conditions that must be observed:

Health Department Approval of Application
Howard County Department of Health
or State Department of Health
Approved by Robert F. Wine
Title Director, Environmental Health
Date 6/6/67

