

PUB. SEWER STATUS VERIFIED BY _____

ISSUE DATE: _____

APPROVAL DATE: _____

PERMIT

INDEXED

P Re-indexed

A 518557-8 D

ON-SITE SEWAGE DISPOSAL SYSTEM HOWARD COUNTY HEALTH DEPARTMENT BUREAU OF ENVIRONMENTAL HEALTH

03-279472

IS PERMITTED TO INSTALL ALTER

ADDRESS: _____ PHONE NUMBER: _____

SUBDIVISION: Fox Den LOT NUMBER: 2

ADDRESS: 4020 Jumper Hill Lane PROPERTY OWNER: Thomas Badik

SEPTIC TANK CAPACITY (GALLONS): _____

PUMP CHAMBER CAPACITY (GALLONS): _____

NUMBER OF BEDROOMS: _____

SQUARE FEET PER BEDROOM: _____

LINEAR FEET OF TRENCH REQUIRED: _____

TRENCHES:	Trench to be _____ feet wide. Inlet _____ feet below original grade. Bottom maximum depth _____ feet below original grade. Effective area begins at _____ feet below original grade. _____ feet of stone below distribution pipe.
LOCATION:	
PURPOSE:	File re-indexed

PLANS APPROVED: _____ DATE: _____

- NOTE: PERMIT VOID AFTER 2 YEARS
- NOTE: CONTRACTOR RESPONSIBLE FOR SCHEDULING A PRE-CONSTRUCTION INSPECTION FOR ALL INSTALLATIONS
- NOTE: WATERTIGHT SEPTIC TANKS REQUIRED
- NOTE: ALL PARTS OF SEPTIC SYSTEM SHALL BE 100 FEET FROM ANY WATER WELL
- NOTE: MANHOLE RISERS REQUIRED ON ALL SEPTIC TANKS AND PUMP CHAMBERS

**NEITHER THE HOWARD COUNTY COUNCIL NOR THE HEALTH DEPARTMENT IS
RESPONSIBLE FOR THE SUCCESSFUL OPERATION OF ANY SYSTEM
PERMITTEE RESPONSIBLE FOR OBTAINING FINAL APPROVAL ON THIS PERMIT
CALL 410-313-2640 FOR INSPECTION OF SEPTIC SYSTEM**

A518557-8D

A 518557-E

4/1/78
award noon

INDEXED PERMIT

P 29109
A 11950

SEWAGE DISPOSAL SYSTEM
MARYLAND STATE DEPARTMENT OF HEALTH*

HOWARD COUNTY 05-362776

ELLICOTT CITY
DISTRICT 22A

INDEXED

DATE 10/26/78

Mr. Schissler - So. Carroll Septic Service IS PERMITTED TO INSTALL X ALTER

ADDRESS _____ PHONE _____

SUBDIVISION Cisco Farms ROAD 7113 Deer Valley Road LOT 21, Sec. 1

PROPERTY OWNER Mr. John Patrick

ADDRESS 11922 Owen Street, Fulton, Md.

SPECIFICATIONS 4 bedrooms

SEPTIC TANK CAPACITY 1250 GALLONS

DRAIN FIELD _____ DEPTH _____ FEET. BOTTOM AREA _____ SQ. FT.

DEEP TRENCH _____ DEPTH _____ FEET. BOTTOM AREA _____ SQ. FT.

SEWAGE PITS _____ ABSORBENT SIDE-WALL AREA 442 SQ. FT. total area.

INLET PIPE 4 IN. BELOW ORIGINAL GRADE. MAXIMUM DEPTH 12 1/2 FT. BELOW ORIGINAL GRADE

EFFECTIVE DEPTH AT _____ FT. BELOW ORIGINAL GRADE

LOCATE DISPOSAL AREA 162 FT. FROM PROPERTY LINE AND 15 FT. FROM RIGHT LOT LINE AS SHOWN WHEN FACING LOT FROM Deer Valley Road.

PLANS APPROVED BY Raymond Hodges DATE 7/1/66

COVER NO WORK UNTIL INSPECTED AND APPROVED

NEITHER THE HOWARD COUNTY COUNCIL NOR THE HEALTH DEPARTMENT IS RESPONSIBLE FOR THE SUCCESSFUL OPERATION OF ANY SYSTEM.

NOTE IF TRENCH IS USED CALL FOR INSPECTION BEFORE PLACING GRAVEL IN TRENCH

NOTE NO DRY WELL SHALL EXCEED 18 FOOT IN DIAMETER

NOTE ALL PIPE FROM HOUSE TO DISPOSAL AREA MUST BE CAST IRON

PERMIT VOID AFTER THREE YEARS

NOTE INSTALL STAND PIPE ON SEPTIC TANK AND DRY WELL. STAND PIPES MUST BE 6 INCHES IN DIAMETER. CAST IRON, CONCRETE OR TERRAZO ACCEPTED

BUILDING PERMIT SIGNED

AND RETURNED
7-605 B00154798-DEUK

A 11950

A 518557-E

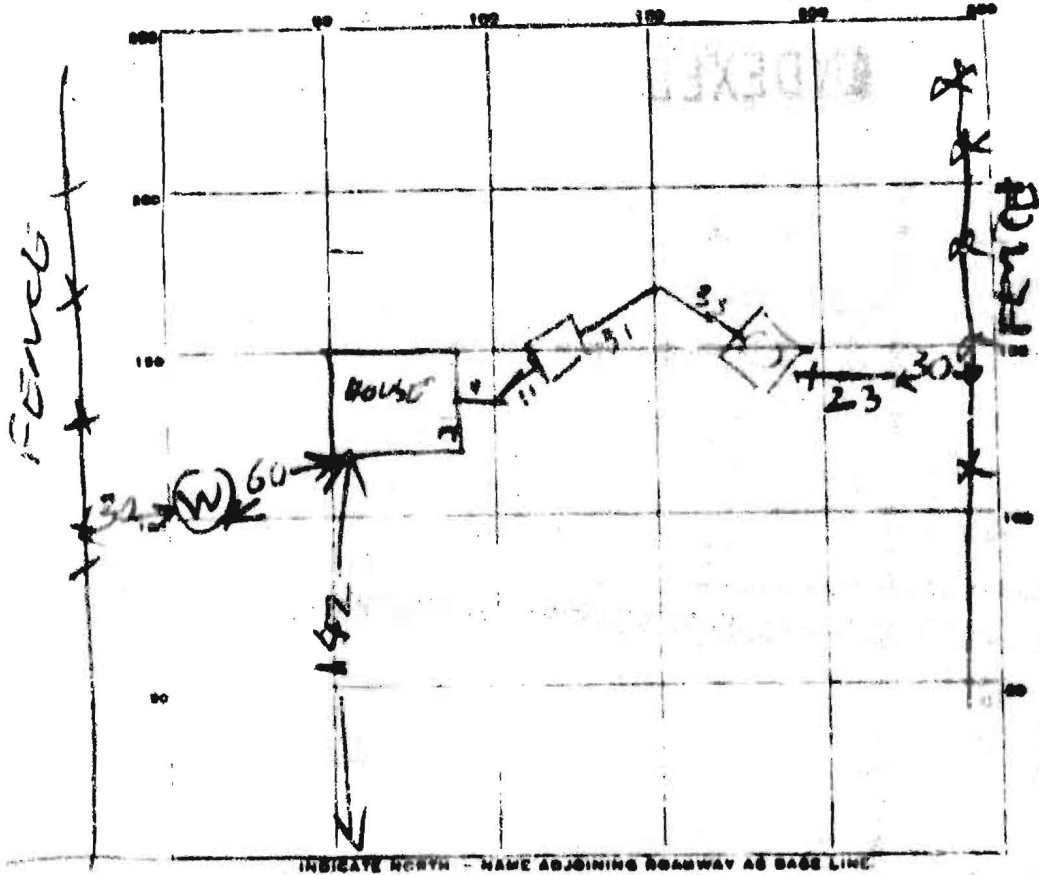

PERMIT CARD

SEPTIC TANK LEVEL OK 1253

CLEANOUTS OK

DISTRIBUTION BOX LEVEL ↑ UP 3 FT ABOVE GROUND

TILE FIELD DEPTH 12 FT. TRENCH WIDTH 2 FT.

GRAVEL DEPTH 2.5 IN. TOTAL LENGTH 23 FT.

NUMBER OF TRENCHES 1 TOTAL 1/2 SIDE AREA 242

SEEPAGE PITS INSIDE DIAMETER PERIMETER 44 FT. DEPTH BELOW INLET 8 1/2 FT.

ABSORBENT AREA 374 SQ. FT.

REMARKS

11/1/79 DW: INLET 7 1/2 - 5 FT DEEP

STONE ADDED TO DITCH AT TIME OF INSPECTION

DATE SYSTEM APPROVED

11/1/79

INSPECTOR

Raymond [Signature]

BUILDING PERMIT SIGNED
RETURNED TO