

Steph:

Another to index.

No completion report
Known. I looked in
well permit box. Thanx

MR 10/29

RECEIVED
HOWARD COUNTY
HEALTH DEPT.
SEP 5 3 55 PM '88
DIVISION OF
ENVIRONMENTAL
HEALTH



OFFICE OF ENVIRONMENTAL PROGRAMS
DEPARTMENT OF HEALTH AND MENTAL HYGIENE

201 WEST PRESTON STREET • BALTIMORE, MARYLAND 21201 • AREA CODE 301 • 225-
TTY FOR DEAF: Balto. Area 383-7555
D.C. Metro 565-0451

Adele Wiltzack, R.N., M.S., Secretary

William M. Eichbaum, Assistant Secretary

December 31, 1986

Mr. William Zepp
Division of Milk Control
Gateway Industrial Park
Old Fair Child Build
Rt. 6 Snowalter Road
Hagerstown, Maryland 21740

Dear Mr. Zepp:

In response to your request for our Division's assistance (November 3, 1986 letter to Mr. and Mrs. Kenneth Burrier), a site evaluation was made with you, staff member Mrs. Skinner, Mr. Lin Wilber, agent for the State of Maryland and Mrs. Richard Smith, field representative for the Maryland and Virginia Milk Producers Co-op.

Together we looked at the existing situation, the spring, to determine if it could be used for both a domestic and dairy farm water supply and discussed the State's intention to proceed with a fifth attempt to drill a well.

It is my opinion that the spring is not an acceptable water supply. It is located at the bottom of a distinct drainage swale which could contribute surface runoff and subsequently contaminate the spring area. The spring is a water source for a farm pond and this pond contributes to a standing water problem for the spring. The construction of the spring housing is also suspect since a wooden hinged door at the front and undeterminable construction below and behind would not prevent or eliminate the potential for a contaminated supply.

Mr. William Zepp
Page 2
December 31, 1986

Your letter stated that although minor repairs have been made, water samples on three separate occasions continue to indicate bacterial contamination. I do not believe minor repairs or even a major repair could eliminate the potential for continued bacterial problems.

The only option to pursue is to drill a well for I cannot agree that a spring can be considered safe or thought to be safe from contamination in this particular case. State Regulation, COMAR 10.17.02, states "Springs are not to be used as a drinking water supply for new homesites". I do not believe our concern can be any less for a dairy farm operation, with its homesite water needs and stock watering needs. I am hopeful a well site can be found to produce safe and adequate water.

If you have any questions or new proposals for this situation, please do not hesitate to call me at (301) 225-6351.

Sincerely,

A handwritten signature in cursive script that reads "David A. Kerr" followed by a stylized monogram or initials "DAK".

David A. Kerr, R.S.
Division of Residential Sanitation

DAK:ydt

cc: Mr. Dane S. Bauer
Mr. Jack R. Holthaus, R.S.

State of



Maryland

*None of these
Have you
been
contacted?*

OFFICE OF ENVIRONMENTAL PROGRAMS
DEPARTMENT OF HEALTH AND MENTAL HYGIENE

201 WEST PRESTON STREET • BALTIMORE, MARYLAND 21201 • AREA CODE 301 • ~~255~~X659-1022
TTY FOR DEAF: Balto. Area 383-7555
D.C. Metro 565-0451

Adele Wilzack, R.N., M.S., Secretary

William M. Eichbaum, Assistant Secretary

November 3, 1986

RECEIVED

NOV 7 1986

Kenneth E. & Robyn L. Burrier
2107 Long Corner Road
Mt. Airy, Maryland 21771

DIVISION OF
RESIDENTIAL REGULATION

Dear Mr. & Mrs. Burrier:

This letter is written per your request to confirm the status of your application for a Maryland Milk Producer's Permit.

An application inspection was conducted on August 19, 1986, by Mrs. Rachaelle Skinner of this Division. At that time, numerous deficiencies regarding construction, location and protection of the existing spring water supply were discussed with you. You were informed that due to the poor construction and location of this spring supply, a permanent continuous disinfection device was not an acceptable option, and a new water supply was recommended.

After minor repairs and action taken to upgrade the existing spring, water samples were obtained on three separate occasions. Laboratory results for each sample indicated bacterial contamination.

On September 11, 1986, Mrs. Skinner visited this farm after initial attempts to drill a well yielded no water. Mr. Ron Kyker of Westminster Well Drilling was also present. Several prospective well sites were selected as being acceptable to this Division.

Mrs. Skinner and I visited your farm on October 2, 1986 for consultative purposes. At this time, four (4) dry holes were existing, and you requested evaluation of another site for a fifth (5) attempt, pending the property owner's approval. This site was evaluated and found to meet the Division's criteria.

On October 17, 1986, Mrs. Skinner spoke with Mr. Len Wilbur, agent for the State of Maryland (property owner), and was informed of the State's intention to proceed with a fifth attempt at drilling a well upon receipt of this letter documenting the Division of Milk Control's activities.

Kenneth E. & Robyn L. Burrier
Page #2

In closing, be advised that the Division of Milk Control is, by way of this letter, requesting the assistance of the Division of Residential Sanitation in evaluating and proposing a solution to the water problem on this property. If there are any questions, please feel free to contact me at 791-4779.

Very truly yours,

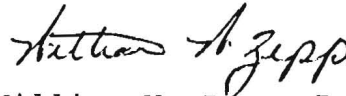

William W. Zepp, R.S., Head
Region II
Division of Milk Control

WWZ:pw

CC: Mr. Len Wilbur
Mr. David L. Resh, Jr.
Mr. Walter L. Hill
Mrs. Rachaelle Skinner
Maryland & Virginia Milk Producers
Mr. Jack Holthaus

M 40366-40426
REGION _____

AREA _____ RATING _____

ACKNOWLEDGMENT AND CONTROLS	DATE

Howard County Department of Health
BUREAU OF ENVIRONMENTAL HEALTH

DISPOSITION	DATE

RECORD OF INVESTIGATION

LOCATION _____ ZIP _____

OWNER OCCUPANT ROBIN BURRIER ADDRESS 2107 LONG CORNER PHONE 829-9357

COMPLAINANT _____ ADDRESS _____ PHONE _____

REASON FOR INVESTIGATION ADDITIONAL WELL SITE REQUEST

RECEIVED BY C Williams DATE 6/8/87 ASSIGNED TO _____ DATE _____

DATE OF INVESTIGATION _____ TIME _____ WEATHER _____

REPORT MS. BURRIER INDICATED

SHE WOULD BE SELECTING A NEW DRILLER. A PROPOSAL ACCEPTABLE TO THIS BUREAU WAS ACCEPTED NEAR

THE DRIVEWAY BETWEEN THE HOUSE AND MAIN BARN.

CONFIRMATION FROM DAIRY DIVISION REQUIRED PLUS APPLICATION FROM NEW DRILLER.

6/8/87 CW

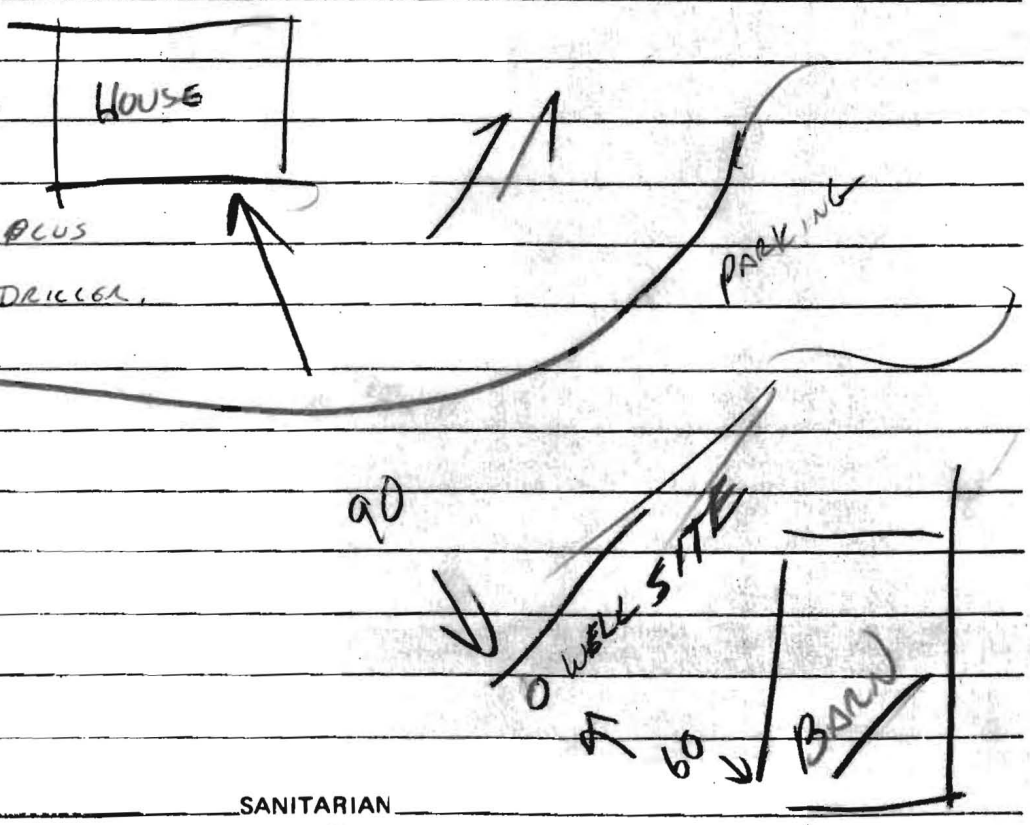

DATE SUBMITTED _____ SANITARIAN _____

REGION _____

AREA _____ RATING _____

ACKNOWLEDGMENT AND CONTROLS	DATE

Howard County Department of Health
BUREAU OF ENVIRONMENTAL HEALTH

RECORD OF INVESTIGATION

DISPOSITION	DATE

LOCATION 2107 LONG CORNER RD - BURRIER FARM ZIP _____

OWNER OCCUPANT ADDRESS _____ PHONE _____

COMPLAINANT _____ ADDRESS _____ PHONE _____

REASON FOR INVESTIGATION THE TENANT, MR BURRIER AND THE LANDLORD, MD. DEPT OF NATURAL RESOURCES REQUESTED A REVIEW OF THE EXISTING SPRING BECAUSE EFFORTS TO REPLACE IT WITH A DRILLED WELL WERE UNSUCCESSFUL. CODES _____

RECEIVED BY CWilliam DATE _____ ASSIGNED TO _____ DATE _____

DATE OF INVESTIGATION 4/23/87 TIME 11:00 AM WEATHER OVERCAST

REPORT THE SPRING SITE WAS ^{JUDGED} AN EXCEPTIONALLY VULNERABLE TO A VARIETY OF CONTAMINANTS. THE SUPPLY WAS VERY SHALLOW WITH TREE ROOTS PROLIFIC IN THE SPRING HOUSE; THE LOCATION WAS AT THE EDGE OF A POND AND DESPITE VARIOUS CLAIMS TO THE CONTRARY, APPEARED VERY VULNERABLE TO CROSS CONTAMINATION FROM THE POND; IT WAS LOCATED AT THE BOTTOM OF A LARGE (1 ACRE OR MORE) NATURAL BOWL WITH EXTENSIVE FARMING AND GRAZING DIRECTLY ABOVE; VARIOUS RESIDENCES AT THE RIM OF THE BOWL ~~WERE~~ WERE SERVED BY PRIVIES OR OTHER QUESTIONABLE DISPOSAL SYSTEMS. THE SITE WOULD NOT QUALIFY UNDER ANY CIRCUMSTANCES AS AN APPROVABLE WELL SITE, IT WAS STRONGLY RECOMMENDED BY BILL ZEPP AND MYSELF THAT EFFORTS TO RECONSTRUCT THE SPRING WOULD DO LITTLE TO GUARANTEE THE SAFETY OF THE SUPPLY.

DATE SUBMITTED 4/23/87 SANITARIAN CWilliam

DAIRY FARM

2107 LONG CORNER RD

REPLACEMENT WELL (IN LIEU OF EXISTING CONTAMINATED SPRING)

9/10/86

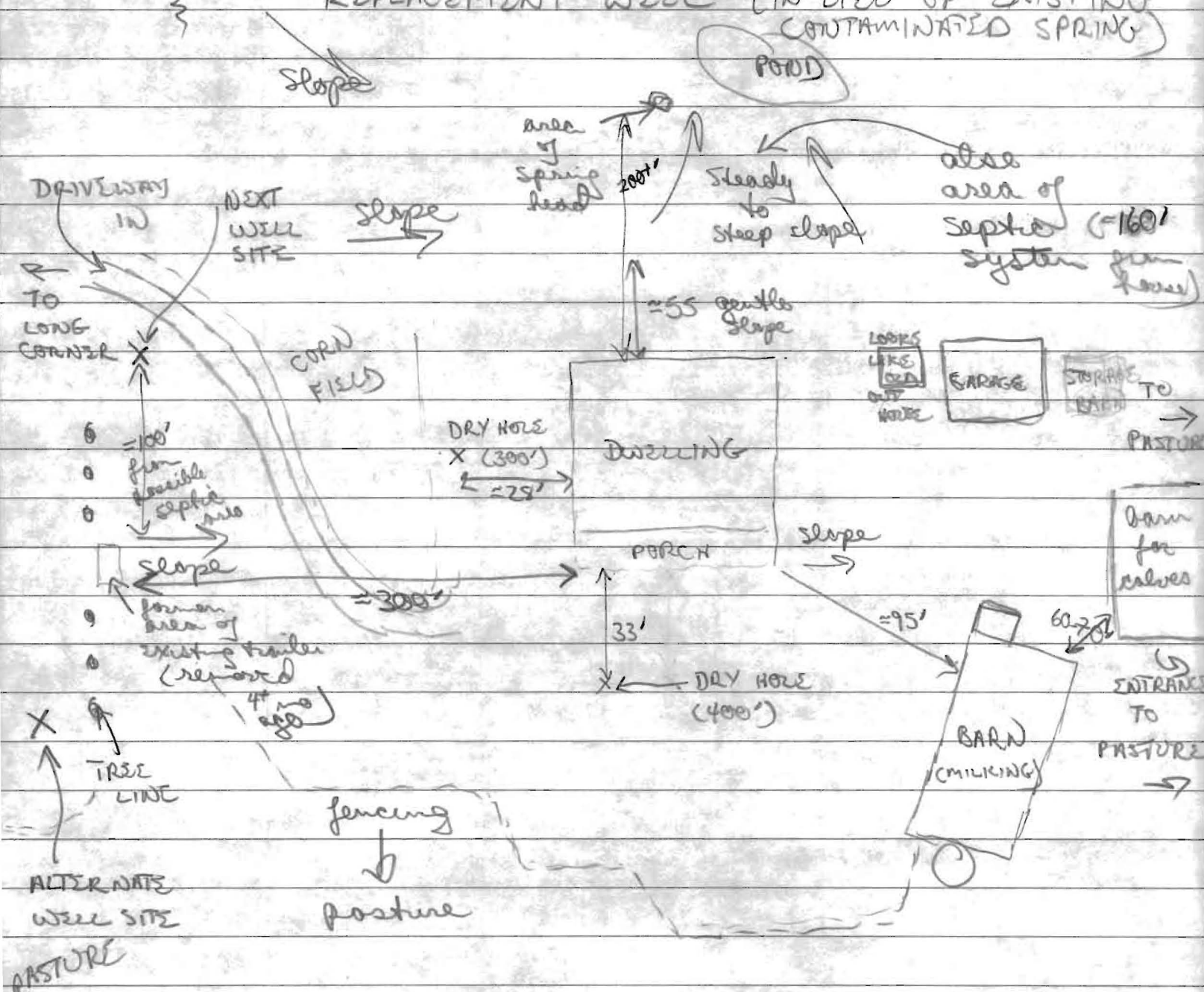

If well sites do hit H₂O & are low yield, may tie wells together

Well to service both house & barns