

1/22/02 Repair 10 A.M.

3/22/02 - PM

3/25/02 - PM

ISSUE DATE: 1/17/02

APPROVAL DATE: 3/25/02

PERMIT

P 516477-A

A Repair

ON-SITE SEWAGE DISPOSAL SYSTEM HOWARD COUNTY HEALTH DEPARTMENT BUREAU OF ENVIRONMENTAL HEALTH

05-383730

Fogles Septic Clean, Inc IS PERMITTED TO INSTALL ALTER

ADDRESS: 580 Obrecht Road, Sykesville PHONE NUMBER: 410-795-5670

SUBDIVISION: Joseph Judge LOT NUMBER: 6

ADDRESS: 7032 Loganberry Lane PROPERTY OWNER: Richard Green

SEPTIC TANK CAPACITY (GALLONS): ex: 1000 gallon

PUMP CHAMBER CAPACITY (GALLONS): NA

NUMBER OF BEDROOMS: 3

SQUARE FEET PER BEDROOM: 180

LINEAR FEET OF TRENCH REQUIRED: 135-140 (2-70' trenches)

TRENCHES:	Trench to be 2 feet wide. Inlet 4 feet below original grade. Bottom maximum depth 8 feet below original grade. Effective area begins at 4 feet below original grade. 4 feet of stone below distribution pipe.
LOCATION:	
PURPOSE:	Existing septic system has failed. Call for inspection when ground is opened so sanitarian can recommend repair. Dry well & Trench Full

PLANS APPROVED: Steven R. Krieg DATE: 1/22/02

- NOTE: PERMIT VOID AFTER 2 YEARS
- NOTE: CONTRACTOR RESPONSIBLE FOR SCHEDULING A PRE-CONSTRUCTION INSPECTION FOR ALL INSTALLATIONS
- NOTE: WATERTIGHT SEPTIC TANKS REQUIRED
- NOTE: ALL PARTS OF SEPTIC SYSTEM SHALL BE 100 FEET FROM ANY WATER WELL
- NOTE: MANHOLE RISERS REQUIRED ON ALL SEPTIC TANKS AND PUMP CHAMBERS

NEITHER THE HOWARD COUNTY COUNCIL NOR THE HEALTH DEPARTMENT IS RESPONSIBLE FOR THE SUCCESSFUL OPERATION OF ANY SYSTEM PERMITTEE RESPONSIBLE FOR OBTAINING FINAL APPROVAL ON THIS PERMIT CALL 410-313-2640 FOR INSPECTION OF SEPTIC SYSTEM

P516477-A

NOT TO SCALE

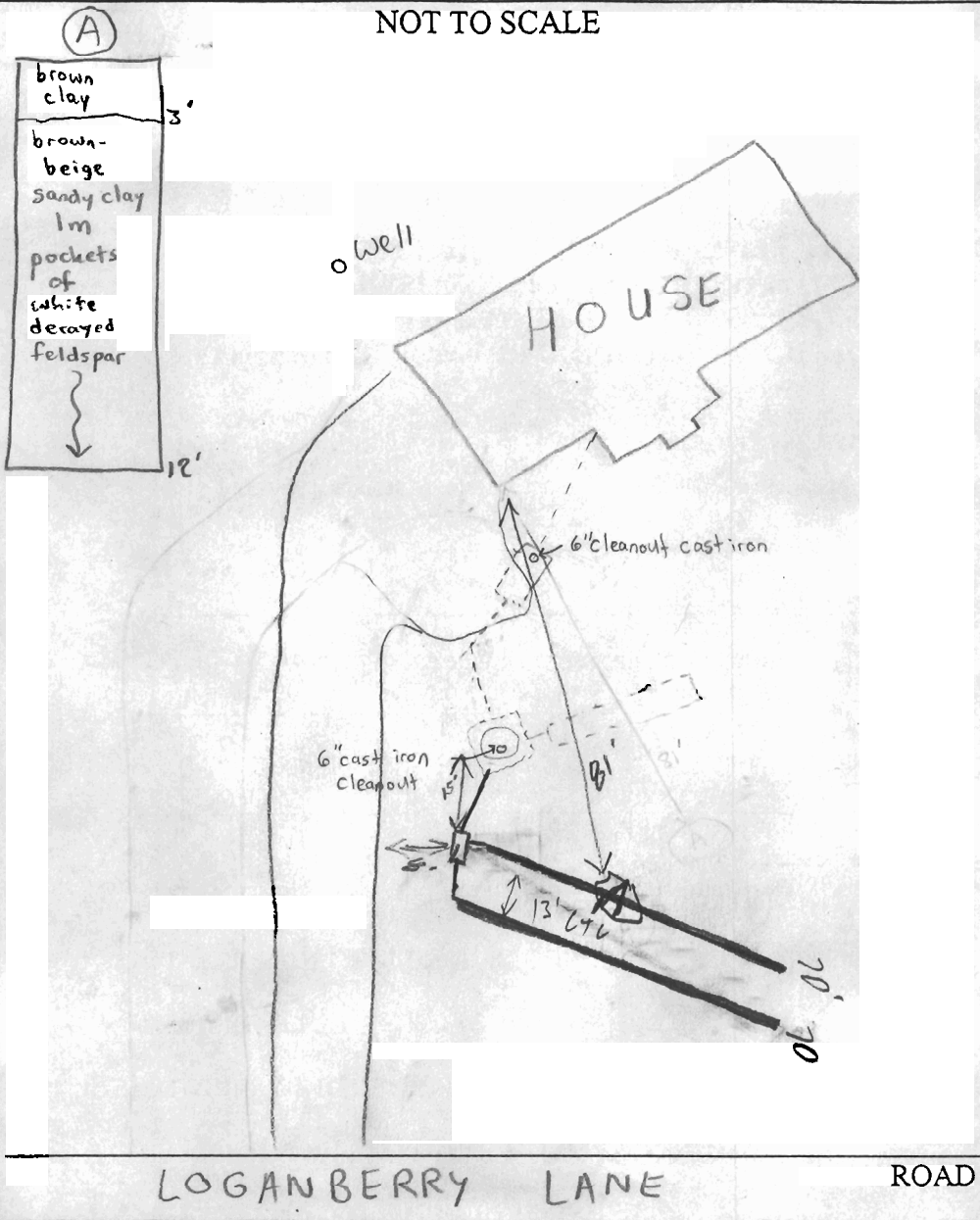

TRENCH/DRAINFIELD DATA		
WIDTH	INLET	BOTTOM
<u>2</u>	<u>4'</u>	<u>2'</u>
NUMBER OF TRENCHES		<u>2</u>
TOTAL LENGTH		<u>140'</u>
ABSORPTION AREA		<u>5604</u>
DISTRIBUTION BOX LEVEL		<u>yes</u>
DISTRIBUTION BOX BAFFLE		<u>yes</u>
DISTRIBUTION BOX PORT		<u>—</u>

SEPTIC TANK DATA <i>existing</i>	
SEPTIC TANK 1 LEVEL	_____
CAPACITY	_____ GAL
SEAM LOC	_____
TANK LID DEPTH	_____
BAFFLES	_____
BAFFLE FILTER	_____
MANHOLE LOC	_____
6" PORT LOC	_____
WATERTIGHT TEST	_____
SEPTIC TANK 2 LEVEL	_____
CAPACITY	_____ GAL
SEAM LOC	_____
TANK LID DEPTH	_____
BAFFLES	_____
BAFFLE FILTER	_____
MANHOLE LOC	_____
6" PORT LOC	_____
WATERTIGHT TEST	_____

PRE-CONSTRUCTION 1/22/02 - PERC HOLE DUG IN LOCATION (A) SEE SOIL PROFILE, WILL PERC BETWEEN 2-7 minutes, INSTALL -2 TRENCHES 70' LONG IN APPROVED SDA - (SRK)

INSTALLATION 3/22/02 D.B. & 1st trench being dug (SD)

3/25/02 OK to cover all work (SD)

FINAL INSPECTOR Steve [Signature] DATE OF APPROVAL 3/25/02

8-2-79
8-3-79
8/6/79

8-6-79 R. DENARCO
APPROVED

PERMIT

P 29999

A 24840

SEWAGE DISPOSAL SYSTEM

MARYLAND STATE DEPARTMENT OF HEALTH

HOWARD COUNTY

ELLICOTT CITY

DISTRICT 5th

INDEXED

DATE 7/17/79

Paul Schissler IS PERMITTED TO INSTALL ALTER

ADDRESS 2338 Erin Road, Sykesville, Md. 21784 PHONE 795-3708

SUBDIVISION _____ ROAD 7032 Loganberry Lane LOT 6

PROPERTY OWNER Joseph Judge Richard Green

ADDRESS 6349 Amherst Avenue, Columbia, Md. 21046 Phone: 995-1920

SPECIFICATIONS 3 bedrooms

SEPTIC TANK CAPACITY 1000 GALLONS

DRAIN FIELD _____ DEPTH _____ FEET, BOTTOM AREA _____ SQ. FT.

DEEP TRENCH _____ DEPTH _____ FEET, BOTTOM AREA _____ SQ. FT.

SEEPAGE PITS ABSORBENT SIDE-WALL AREA 135 sq. ft. per bedroom.

INLET PIPE 4 1/2 FT. BELOW ORIGINAL GRADE. MAXIMUM DEPTH 10 1/2 FT. BELOW ORIGINAL GRADE

EFFECTIVE DEPTH AT 5 FT. BELOW ORIGINAL GRADE.

LOCATE DISPOSAL AREA 150 FT. FROM front LOT LINE AND 20 FT. FROM left LOT LINE AS SEEN WHEN FACING LOT FROM the road.

DRY WELL TO HAVE AT LEAST 250 sq. ft. and TRENCH TO BE 40 ft. long.

PLANS APPROVED BY David J. O'Neill & Fred Frommelt DATE 11/18/77

COVER NO WORK UNTIL INSPECTED AND APPROVED.

NEITHER THE HOWARD COUNTY COUNCIL NOR THE HEALTH DEPARTMENT IS RESPONSIBLE FOR THE SUCCESSFUL OPERATION OF ANY SYSTEM.

NOTE: IF TRENCH IS USED CALL FOR INSPECTION BEFORE PLACING GRAVEL IN TRENCH.

NOTE: NO DRY WELL SHALL EXCEED 15 FOOT IN DIAMETER.

NOTE: ALL PIPE FROM HOUSE TO DISPOSAL AREA MUST BE CAST IRON.

PERMIT VOID AFTER THREE YEARS.

NOTE: INSTALL STAND PIPE ON SEPTIC TANK AND DRY WELL. STAND PIPES MUST BE 6 INCHES IN DIAMETER. CAST IRON, CONCRETE OR TERRA COTTA ACCEPTED.

***INSTALLER IS RESPONSIBLE FOR OBTAINING FINAL APPROVAL ON THIS PERMIT.**

01840

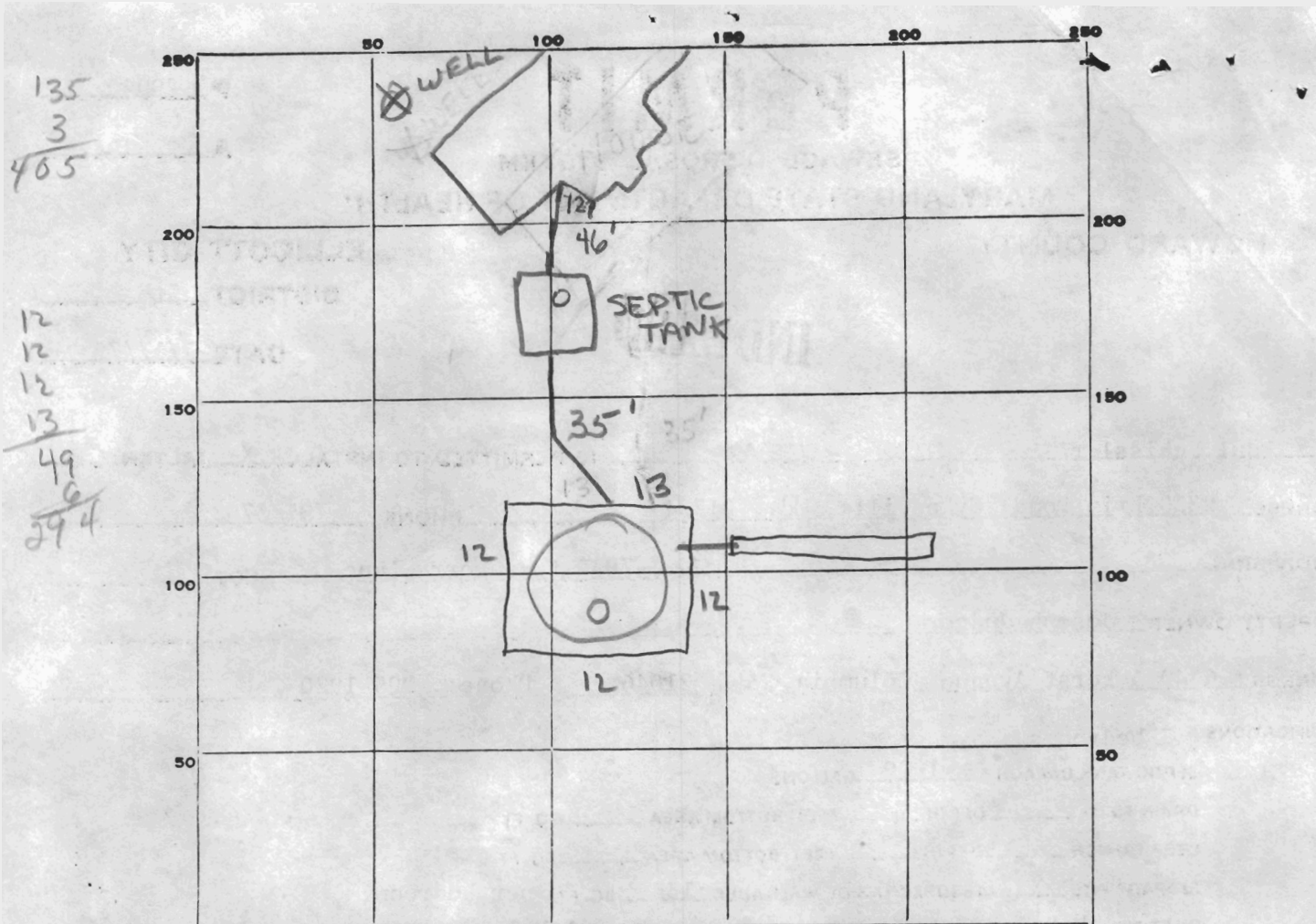

INDICATE NORTH. - NAME ADJOINING ROADWAY AS BASE LINE.

Loganberry

PERMIT CARD

SEPTIC TANK, LEVEL

DISTRIBUTION BOX, LEVEL

TILE FIELD, DEPTH 10 1/2 FT. TRENCH WIDTH 2 FT.

GRAVEL DEPTH 6' IN. TOTAL LENGTH 30' FT.

NUMBER OF TRENCHES 1 TOTAL BOTTOM AREA 180

SEEPAGE PITS, INSIDE DIAMETER 49 FT. DEPTH BELOW INLET 6 FT.

ABSORBENT AREA 474 SQ. FT.

ST	DW
CAST IRON	CAST IRON

REMARKS 8-2-79, not ready, asked for wrong job therefore had wrong paperwork L.F.
8-3-79 OK TO COVER FROM SEPTIC TANK UP TO AND INCLUDING DRYWELL. ADD GRAVEL TO TRENCH R.D.
8-6-79 - OK TO COVER ALL WORK R.D.

DATE SYSTEM APPROVED 8-6-79 INSPECTOR P. De Marco

135
3
465

12
12
12
13
49
6
294

294
180
474

SCALE
1" = 30'-0"

