

11/10/72

11/10/72  
Serial  
R. Town

# PERMIT

SEWAGE DISPOSAL SYSTEM

P 17623  
A 14974

MARYLAND STATE DEPARTMENT OF HEALTH

HOWARD COUNTY

ELLICOTT CITY

DISTRICT 4th

## INDEXED

DATE 11/8/72

Jack Fyock IS PERMITTED TO INSTALL  ALTER

ADDRESS Ten Oaks Road, Glenelg, Maryland PHONE 286-2939

A SEWAGE DISPOSAL-SYSTEM LOCATED AT \_\_\_\_\_

SUBDIVISION Warfield Estates ROAD Mac Clintock & Huster LOT 11, Blk. B,  
14509 Drives Sect. 4

PROPERTY OWNER Maple Hill Farm Associates John Douglas

ADDRESS 9300 Fontana Ave., Seabrook, Md.

SPECIFICATIONS 3 bedrooms

DRAIN FIELD \_\_\_\_\_ DEPTH \_\_\_\_\_ FEET, BOTTOM AREA \_\_\_\_\_ SQ. FT.

SEEPAGE PITS \_\_\_\_\_ ABSORBENT SIDE-WALL AREA \_\_\_\_\_ SQ. FT.

SEPTIC TANK CAPACITY 1000 GALLONS

FOR GARBAGE GRINDER, INCREASE DISPOSAL AREA 22% & TANK CAPACITY 50%.

OTHER DRY WELL - 300 sq. ft. sidewall area below the inlet. Inlet of dry well to be no deeper than 4 ft. and bottom of dry well to be no deeper than 11 ft. Place the dry well 150 ft. from the front lot line and 25 ft. from the left side of the lot as seen when facing the lot from MacClintock Drive.

NOTE: ALL PIPE FROM HOUSE TO SEPTIC TANK MUST BE CAST IRON.  
PERMIT VOID AFTER THREE YEARS.

NOTE: INSTALL STAND PIPE ON SEPTIC TANK AND DRY WELL.

PLANS APPROVED BY Raymond Hodges DATE 10/7/71

FILL SEPTIC TANK AND DISTRIBUTION BOX WITH WATER BEFORE CALLING FOR AN INSPECTION. COVER NO WORK UNTIL INSPECTED AND APPROVED.

NEITHER THE HOWARD COUNTY COMMISSIONERS NOR THE HEALTH DEPARTMENT IS RESPONSIBLE FOR THE SUCCESSFUL OPERATION OF ANY SYSTEM.

BLDG. PERMIT SIGNED  
AND RETURNED 12/30/91  
Serial # 40685-  
addition

A  
14974

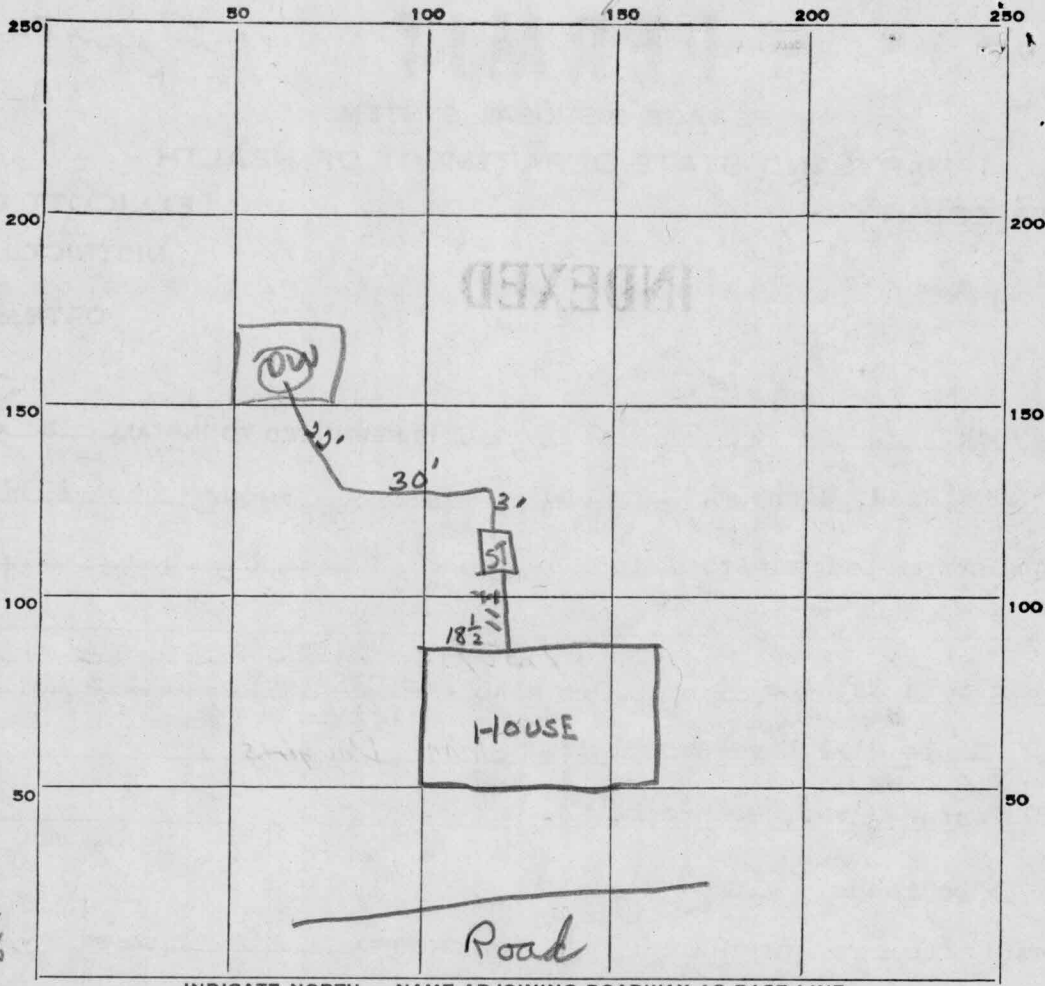

13 1/2  
 2 1/2  
 5 1/2  
 2 1/2  
 15  
 2 1/2  
 14  
 3 1/2

INDICATE NORTH. - NAME ADJOINING ROADWAY AS BASE LINE.

PERMIT CARD Signed

SEPTIC TANK, LEVEL 1000 gal. CLEANOUTS OK

DISTRIBUTION BOX, LEVEL -

TILE FIELD, DEPTH - FT. TRENCH WIDTH - FT.

GRAVEL DEPTH - IN. TOTAL LENGTH - FT.

NUMBER OF TRENCHES - TOTAL BOTTOM AREA -

SEEPAGE PITS, ~~INSIDE DIAMETER~~ outside perimeter 13 1/2 x 13 1/2 FT. DEPTH BELOW INLET 7 FT.

ABSORBENT AREA 378 SQ. FT.

REMARKS \_\_\_\_\_

\_\_\_\_\_

\_\_\_\_\_

\_\_\_\_\_

\_\_\_\_\_

DATE SYSTEM APPROVED 11/10/72 INSPECTOR R. Tane



