

LAYOUT 6/29/04 - 10 INSP 4 1-11-05 11:30 P/A
INSP 2 6/29/04 - 2PM INSP 5 _____
INSP 3 7/12/04 10:30 INSP 6 _____

ISSUE DATE: 6/24/04
APPROVAL DATE: 1-11-05

PERMIT

INDEXED

P p520440
A 515227-Q

ON-SITE SEWAGE DISPOSAL SYSTEM HOWARD COUNTY HEALTH DEPARTMENT BUREAU OF ENVIRONMENTAL HEALTH

04-367820

Fogles Septic Clean, Inc. IS PERMITTED TO INSTALL ALTER

ADDRESS: 580 Obrecht Rd., Sykesville 21784 PHONE NUMBER: 410-795-5670

SUBDIVISION: Waterford Farm LOT NUMBER: 18

ADDRESS: 3180 Lorenzo Lane PROPERTY OWNER: Toll MDII, LP

SEPTIC TANK CAPACITY (GALLONS): 1500 OUTLET BAFFLE FILTER REQUIRED

PUMP CHAMBER CAPACITY (GALLONS): N/A COMPARTMENTED TANK REQUIRED

NUMBER OF BEDROOMS: 5

SQUARE FEET PER BEDROOM: 217

LINEAR FEET OF TRENCH REQUIRED: 210 HOUSE SERVED BY PUBLIC WATER

TRENCHES:	Trench to be 3.0 feet wide. Inlet 3.0 feet below original grade. Bottom maximum depth 5.0 feet below original grade. Effective area begins at 3.0 feet below original grade. 2.0 feet of stone below distribution pipe.
LOCATION:	Septic system layout to be determined when inspection comes out for layout inspection.
NOTES:	

PLANS APPROVED: Steven R. Krieg Reviewed by: _____ DATE: 5/10/02

NOTES: PERMIT VOID AFTER 2 YEARS
CONTRACTOR IS RESPONSIBLE FOR SCHEDULING A PRE-CONSTRUCTION INSPECTION FOR ALL INSTALLATIONS
WATERTIGHT SEPTIC TANKS REQUIRED
ALL PARTS OF SEPTIC SYSTEM SHALL BE 100 FEET FROM ANY WATER WELL UNLESS SPECIFICALLY AUTHORIZED
MANHOLE RISERS REQUIRED ON ALL SEPTIC TANKS AND PUMP CHAMBERS UNLESS SPECIFICALLY AUTHORIZED
CONTRACTOR RESPONSIBLE FOR COMPLIANCE WITH APPLICABLE REGULATIONS, GUIDELINES AND THE TERMS OF THIS PERMIT

NEITHER THE HOWARD COUNTY COUNCIL NOR THE HEALTH DEPARTMENT IS RESPONSIBLE FOR THE SUCCESSFUL OPERATION OF ANY SYSTEM PERMITTEE RESPONSIBLE FOR OBTAINING FINAL APPROVAL ON THIS PERMIT ALL 410-313-2640 FOR INSPECTION OF SEPTIC SYSTEM

4515227-Q

NOT TO SCALE

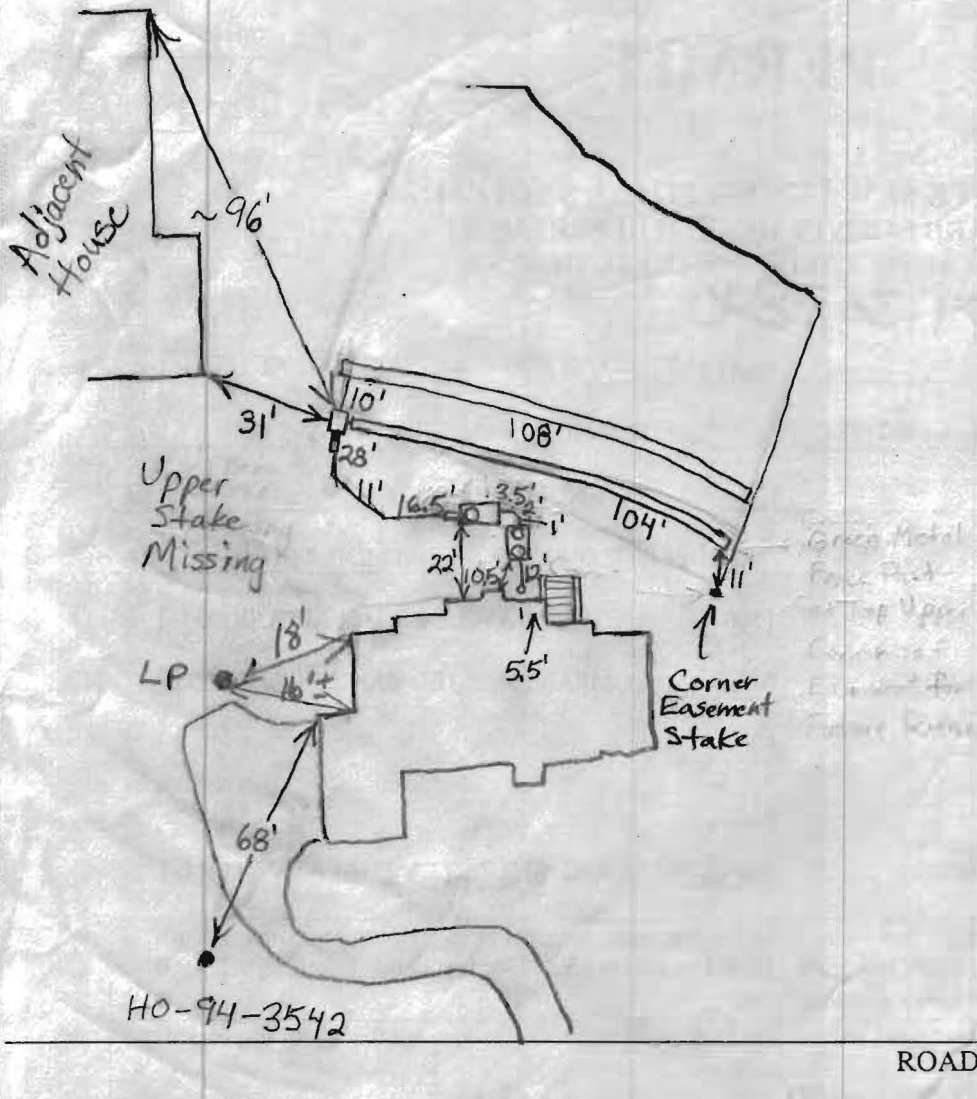

TRENCH/DRAINFIELD DATA		
WIDTH	INLET	BOTTOM
3	3	5
NUMBER OF TRENCHES		2
TOTAL LENGTH		212'
ABSORPTION AREA		636+Sidewall
DISTRIBUTION BOX LEVEL		Levelers
DISTRIBUTION BOX BAFFLE		Elbow
DISTRIBUTION BOX PORT		Yes

SEPTIC TANK DATA	
SEPTIC TANK 1 LEVEL	✓
CAPACITY	1500 GAL
SEAM LOC	Top
TANK LID DEPTH	2'
BAFFLES	Yes
BAFFLE FILTER	Yes
MANHOLE LOC	Front+Back
6" PORT LOC	None
WATERTIGHT TEST	No
SEPTIC TANK 2 LEVEL	✓
CAPACITY	1500 GAL
SEAM LOC	Top
TANK LID DEPTH	2.5'-4'
BAFFLES	No
BAFFLE FILTER	No
MANHOLE LOC	Rear
6" PORT LOC	None
WATERTIGHT TEST	No

PRE-CONSTRUCTION 6/20/04 - SRA not staked. Contr. wants to dig 2 conf. holes on highest side of lot. OK but must stake 1st (SO)

INSTALLATION 6/29/04 - Lot staked (SO) 7/12/04 Turst trench started. To run 2 - 105' trenches per Stuart. (BB) 7/13/04 Two trenches done. O.K. to cover. End of right side of top trench marked with green metal fence post. (BB) 8/30/04 Need house connection and pump and alarm test for final approval. O.K. to cover everything. (BB) 1-11-05 LP in ground, P & A OK well cap reensp. OK (KN)

FINAL INSPECTOR 1-11-05 Kace Toran DATE OF APPROVAL 1-11-05