

**HOWARD COUNTY  
PERMIT APPLICATION**

**PERMIT NUMBER**

1000143354 KB

Building Address 3151 Lomaxa Lane  
Woodbine MD 21797  
Suite/Apt. #: \_\_\_\_\_ SDP/WP/Petition #: \_\_\_\_\_  
Census Tract 11402 Subdivision 11402  
Section \_\_\_\_\_ Area \_\_\_\_\_ Lot 7  
Tax Map 20 Parcel 13 Grid 12  
Zoning R-1 Map Coordinates 3611 Lot size 43577

Property Owner's Name Toll MD2 LP  
Address 7164 Columbia Gateway Dr. #230  
City Columbia State MD Zip Code 21046  
Home Phone \_\_\_\_\_ Work Phone 443-535-1216  
Applicant's Name & Mailing Address, (if other than stated hereon):  
Phone \_\_\_\_\_ Fax \_\_\_\_\_

Existing Use Vacant lot  
Proposed Use Residential Home  
Estimated Construction Cost \$ 225,000  
Description of Work Hardy Colonial Finished Basement  
Wall-to-wall 3/4" Ins. Exposed Family Room  
Staircase - Add 4" between balustrade rail

Contractor Company Toll MD2 LP  
Contact Person Nathan Brandenburg  
Address 7164 Columbia Gateway Dr. #230  
City Columbia State MD Zip Code 21046  
License No. \_\_\_\_\_  
Phone 443-535-9276 Fax 443-535-7297

Occupant or Tenant Toll MD2 LP  
Contact Name Nathan Brandenburg  
Address 7164 Columbia Gateway Dr. #230  
City Columbia State MD Zip Code 21046  
Phone 443-535-9276 Fax 443-535-7297

Engineer or Architect Company FSH Associates  
Contact Person Zach  
Address 8218 Forest St.  
City Ellicott City State MD Zip Code 21042  
Phone 410-750-2251 Fax 410-750-7350

**BUILDING DESCRIPTION - COMMERCIAL**

**BUILDING DESCRIPTION - RESIDENTIAL**

Building Characteristics	Utilities
Height: _____	Water Supply: _____ Public _____ Private _____
No. of stories: _____	Sewage Disposal: _____ Public _____ Private _____
Gross area, sq. ft. per floor: _____	Electric Yes <input type="checkbox"/> No <input type="checkbox"/>
Use group: _____	Gas Yes <input type="checkbox"/> No <input type="checkbox"/>
Construction type: _____ Reinforced Concrete _____ Structural Steel _____ Masonry _____ Wood Frame _____	Heating System: _____ Electric <input type="checkbox"/> Oil <input type="checkbox"/> Natural Gas <input type="checkbox"/> Propane Gas <input type="checkbox"/>
State Certified Modular _____	Sprinkler system: N/A <input type="checkbox"/> Full _____ Partial _____ Other Suppression _____ # of Heads _____

Building Characteristics	Utilities
SF Dwelling <input checked="" type="checkbox"/> SF Townhouse <input type="checkbox"/>	Water Supply: _____ Public _____ Private <input checked="" type="checkbox"/>
Depth _____ Width _____	Sewage Disposal: _____ Public _____ Private <input checked="" type="checkbox"/>
1st floor: <u>72'</u>	Electric Yes <input checked="" type="checkbox"/> No <input type="checkbox"/>
2nd floor: <u>72'</u>	Gas Yes <input type="checkbox"/> No <input checked="" type="checkbox"/>
Basement: <u>72'</u>	Heating System: _____ Electric <input type="checkbox"/> Oil <input type="checkbox"/> Natural Gas <input type="checkbox"/> Propane Gas <input checked="" type="checkbox"/>
Finished Basement <input checked="" type="checkbox"/> Unfinished Basement <input type="checkbox"/>	Sprinkler system: N/A <input type="checkbox"/> NFPA #13D _____ NFPA #13R _____ Other: _____
Crawl space <input type="checkbox"/> Slab on Grade <input checked="" type="checkbox"/>	
No. of Bedrooms <u>4</u>	
Multi-family dwellings: _____	
No. of efficiency units: _____	
No. of 1 BR units: _____	
No. of 2 BR units: _____	
No. of 3 BR units: _____	
Other Structure: _____	
Dimensions: _____	
Footings: _____	
Roof: _____	
State Certified Modular _____	
Manufactured Home _____	

THE UNDERSIGNED HEREBY CERTIFIES AND AGREES AS FOLLOWS: (1) THAT HE/SHE IS AUTHORIZED TO MAKE THIS APPLICATION; (2) THAT THE INFORMATION IS CORRECT; (3) THAT HE/SHE WILL COMPLY WITH ALL REGULATIONS OF HOWARD COUNTY WHICH ARE APPLICABLE THERETO; (4) THAT HE/SHE WILL PERFORM NO WORK ON THE ABOVE REFERENCED PROPERTY NOT SPECIFICALLY DESCRIBED IN THIS APPLICATION; (5) THAT HE/SHE GRANTS COUNTY OFFICIALS THE RIGHT TO ENTER ONTO THIS PROPERTY FOR THE PURPOSE OF INSPECTING THE WORK PERMITTED AND POSTING NOTICES.

Applicant's Signature \_\_\_\_\_  
Title/Company \_\_\_\_\_

Print Name \_\_\_\_\_  
Date \_\_\_\_\_

Checks payable to: **DIRECTOR OF FINANCE OF HOWARD COUNTY**  
\*\* PLEASE WRITE NEATLY AND LEGIBLY. \*\*  
- FOR OFFICE USE ONLY -

AGENCY	DATE	SIGNATURE APPROVAL
Land Development, DPZ		
State Highways		
Building Official		
Dev. Engineering, DPZ	<u>4/14/04</u>	<u>[Signature]</u>
Health		
Fire Protection		

Is Sediment Control approval required prior to issuance?  
YES  NO

CONTINGENCY CONSTRUCTION START:

ONE STOP SHOP:

DPZ SETBACK INFORMATION	PROPERTY ID#:
Front: _____	Filing fee \$ <u>100</u>
Rear: _____	Permit fee \$ _____
Side: _____	Excise tax \$ _____
Side St.: _____	Add'l per. fee \$ _____
All minimum setbacks met?	TOTAL FEES \$ _____
YES <input type="checkbox"/> NO <input type="checkbox"/>	Sub-total paid \$ _____
Is Entrance Permit required?	Balance due \$ _____
YES <input type="checkbox"/> NO <input type="checkbox"/>	Check # <u>332116</u>
Historic District?	Validation # <u>40123</u>
YES <input type="checkbox"/> NO <input type="checkbox"/>	
Lot Coverage for NewTown Zone _____	
SDP/Red-line approval date _____	Accepted by _____

Approved Septic System Plan  
Howard County Health Department

*[Signature]*  
Signature

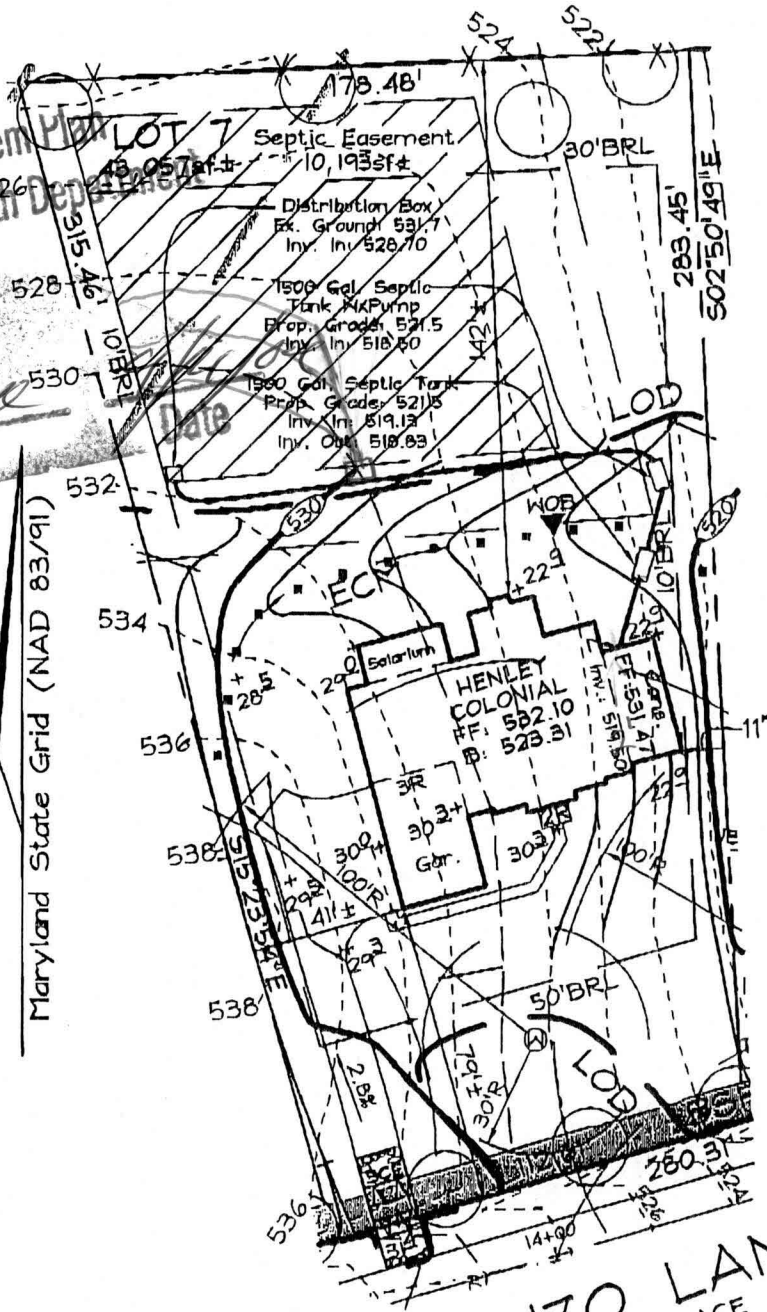

**OWNER/DEVELOPER**

Toll MD II, LP  
7164 Columbia Gateway Drive  
Suite 230  
Columbia, Maryland 21046  
410.872.9185

**LORENZO LANE**  
PUBLIC ACCESS PLACE

**FSH Associates**

Engineers Planners Surveyors  
8318 Forrest Street Ellicott City, MD 21043  
Tel: 410-750-2251 Fax: 410-750-7350  
E-mail: FSHAssociates@cs.com

Note: 1. See Approved Grading Plan GP-04-39 for Entire Site.  
2. The existing well shown on this plan (identified with the attached well tag number: HO-94-3531) has been field located by C. B. Miller professional surveyor and is accurately shown.

DESIGN BY: PS  
DRAWN BY: KSZ  
CHECKED BY: ZYF  
SCALE: 1"=50'  
DATE: Apr. 05, 2004  
W.O. No.: 5217  
SHEET No.: 1 OF 1

**LOT RESITE**  
**LOT 7**  
**CATTAIL TRACE**

TAX MAPS 13, 14, 20 & 21  
GRIDS 7, 12, 19 & 24  
4TH ELECTION DISTRICT

PARCELS 20, 67 & 312  
HOWARD COUNTY, MARYLAND