

PUB. SEWER STATUS VERIFIED BY _____

ISSUE DATE: _____

APPROVAL DATE: 3/27/09

PERMIT

Tax ID # 04-320085

P 530336

A REPAIR

ON-SITE SEWAGE DISPOSAL SYSTEM HOWARD COUNTY HEALTH DEPARTMENT BUREAU OF ENVIRONMENTAL HEALTH

Fogles Septic Clean, Inc IS PERMITTED TO INSTALL ALTER

ADDRESS: 580 Obrecht Rd PHONE NUMBER: 410-795-5670

SUBDIVISION: Windsor Overlook LOT NUMBER: 2

ADDRESS: 1781 Long Corner Road PROPERTY OWNER: Robert Poore

SEPTIC TANK CAPACITY (GALLONS): _____

PUMP CHAMBER CAPACITY (GALLONS): _____

NUMBER OF BEDROOMS: 4

SQUARE FOOTAGE (OF HOUSE): _____

LINEAR FEET OF TRENCH REQUIRED: _____

TRENCHES:	Trench to be feet wide. Inlet at feet below original grade. Bottom maximum depth feet below original grade. Effective area begins at feet below original grade. feet of stone below the distribution pipe.
LOCATION:	Septic tank is to be moved to accommodate BP#09000275.
ADDITIONAL NOTES:	

PLANS APPROVED: Dana Barnard DATE: 03/19/09

- NOTE: PERMIT VOID AFTER 2 YEARS
- NOTE: CONTRACTOR RESPONSIBLE FOR SCHEDULING A PRE-CONSTRUCTION INSPECTION FOR ALL INSTALLATIONS
- NOTE: WATERTIGHT SEPTIC TANKS REQUIRED
- NOTE: ALL PARTS OF SEPTIC SYSTEM SHALL BE 100 FEET FROM ANY WATER WELL
- NOTE: MANHOLE RISERS REQUIRED ON ALL SEPTIC TANKS AND PUMP CHAMBERS

NEITHER THE HOWARD COUNTY COUNCIL OR THE HEALTH DEPARTMENT IS RESPONSIBLE FOR THE SUCCESSFUL OPERATION OF ANY SYSTEM PERMITTEE RESPONSIBLE FOR OBTAINING FINAL APPROVAL ON THIS PERMIT CALL 410-313-2640 FOR INSPECTION OF SEPTIC SYSTEM

HO-94-3653

NOT TO SCALE

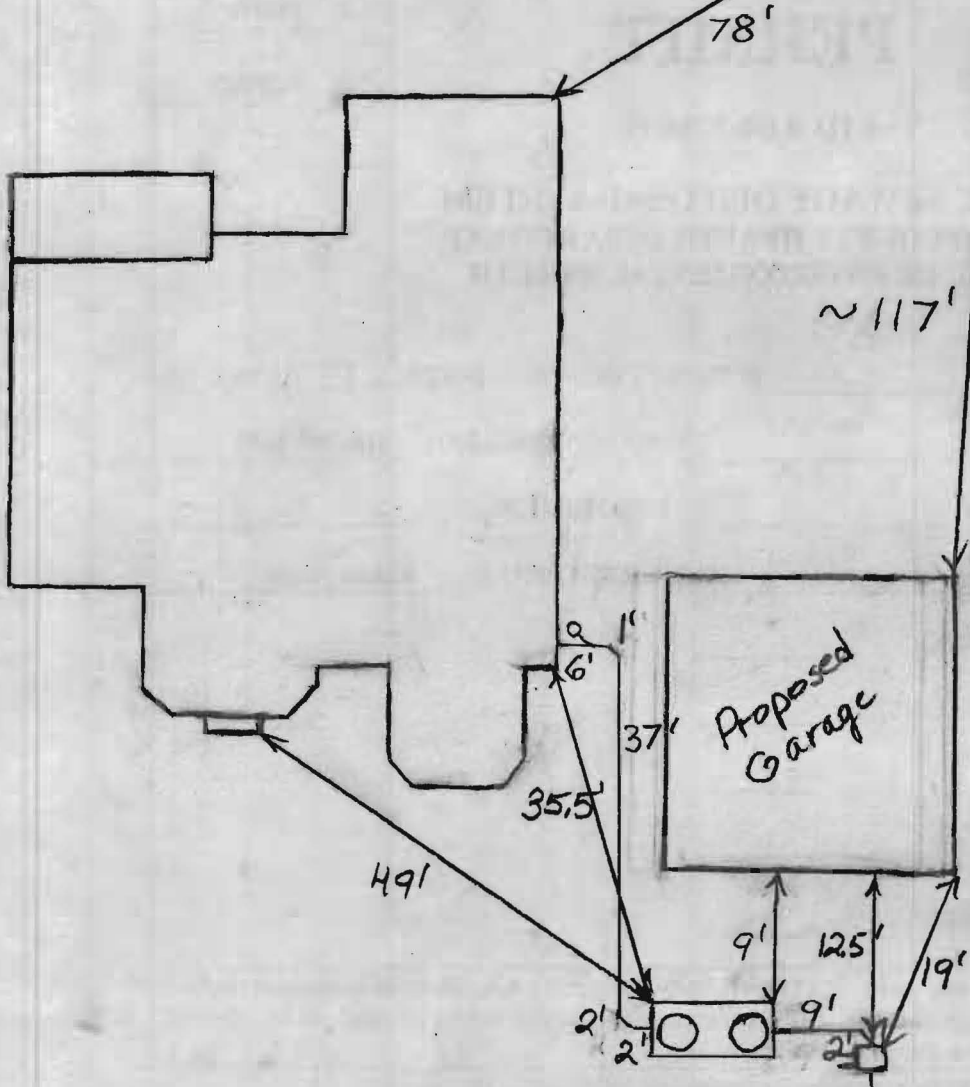

TRENCH/DRAINFIELD DATA		
WIDTH	INLET	BOTTOM
_____	_____	_____
NUMBER OF TRENCHES _____		
TOTAL LENGTH _____		
ABSORPTION AREA _____		
DISTRIBUTION BOX LEVEL		Levelers
DISTRIBUTION BOX BAFFLE		Yes
DISTRIBUTION BOX PORT		No

SEPTIC TANK DATA	
SEPTIC TANK 1 LEVEL	Yes
MANUFACTURER	Babylon
CAPACITY	2000 GAL
SEAM LOC	Top
TANK LID DEPTH	1'-1.5'
BAFFLES	Yes
BAFFLE FILTER	No
MANHOLE LOC	Front + Rear
6" PORT LOC	None
WATERTIGHT TEST	No
SLOTTED	Yes
PUMP/SEPTIC TANK LEVEL N/A	
MANUFACTURER _____	
CAPACITY _____ GAL	
SEAM LOC _____	
TANK LID DEPTH _____	
BAFFLES _____	
BAFFLE FILTER _____	
MANHOLE LOC _____	
6" PORT LOC _____	
WATERTIGHT TEST _____	
SLOTTED _____	

PRE-CONSTRUCTION
 3/24/09 Distribution box moved and beginning of trenches shortened so that

tank could keep some distance from proposed garage. Tank must be at least 5' from garage (BB) 3/25/09 Old tank crushed and filled with gravel. Garage location appears to be farther from house than on perc. cert. Measurements from garage are taken from centerline of proposed footer. Seven to ten feet of beginning of trenches removed. O.K. to backfill. (BB)

INSTALLATION

FINAL INSPECTOR B. Baber

DATE OF APPROVAL 3/27/09