

A/P 32C

Brown Loam  
Red Brown Salcom  
Yellow Brown Salcom  
L590 Rock

32C1  
Brown Loam  
Red Brown Salcom  
Yellow Brown Salcom  
L590 Rock

\* ADDITIONAL HOLES

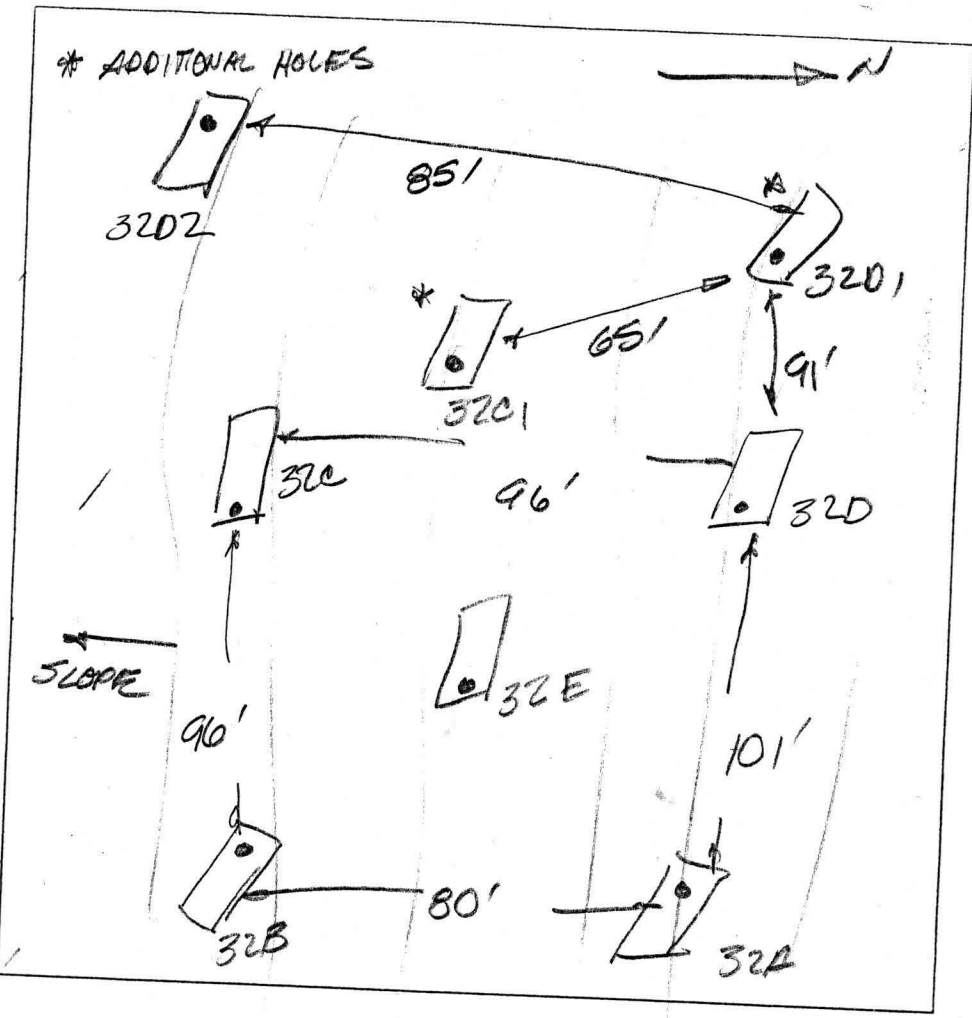

32D  
Brown Loam  
Red Brown Salcom  
L590 Rock  
Hard bottom

32D2  
Brown Loam  
Red Brown Salcom  
Yellow Brown Salcom  
L590 Cherty mica  
HB

DATE	TEST #	DEPTH	START	BREAK 1" DROP	STOP 2" DROP	TIME OF 2nd INCH	P/F/H
11/21/03	32A	Refused @ 5 1/2'				NOT TESTED	F
	32B	Refused @ 5 1/2'				NOT TESTED	F
	32E	Refused @ 3 1/2'				NOT TESTED	F
	32C	4 1/2'	17	20	25	5min	P
	32D	4 1/2'	3015	3218	3431	2min	P
	32D1	5' / 10'	54	02	12	10min	P
	3201	3 1/2' / 9 1/2'	210	215	24	9min	P
	32D2	4 1/2' / 11'	231	235	239	4min	P

32D1  
Brown Loam  
Red Brown Salcom  
L590 Rock

REMARKS \_\_\_\_\_

SANITARIAN FA/KC BACKHOE Willie OTHERS Bob Sheesley, Mark Johnson, Dale Johnson

TEST HOLES USED IN SDA \_\_\_\_\_ AVG. PERC TIME \_\_\_\_\_ SQ. FT/BR \_\_\_\_\_

TRENCH WIDTH \_\_\_\_\_ INLET DEPTH \_\_\_\_\_ MAX. BOT DEPTH \_\_\_\_\_ EFFECTIVE SW \_\_\_\_\_

