

APPLICATION

PERCOLATION TESTING

A 516084

P _____

HOWARD COUNTY HEALTH DEPARTMENT
BUREAU OF ENVIRONMENTAL HEALTH
3525-H ELLICOTT MILLS DRIVE/ELLICOTT CITY, MARYLAND 21043
TELEPHONE: 313-2640

DISTRICT _____

DATE _____

TO: THE COUNTY HEALTH OFFICER
ELLICOTT CITY, MARYLAND

I HEREBY APPLY FOR THE NECESSARY TEST PRIOR TO APPLICATION FOR PERMIT TO CONSTRUCT (OR RECONSTRUCT) A SEWAGE DISPOSAL SYSTEM.

PROPERTY OWNER SECURITY DEVELOPMENT, L.L.C.

P.O. BOX 417

ADDRESS ELLICOTT CITY, MD 21041 PHONE 410-465-4244

AGENT OR PROSPECTIVE BUYER _____

ADDRESS _____ PHONE _____

PROPERTY LOCATION:

SUBDIVISION HOMEWOOD LOT NO. 62

ROAD AND DESCRIPTION HOMEWOOD ROAD

TAX MAP 23 & 29 PARCEL # 20 & 86

SIZE OF LOT 1 ACRE ± TYPE BLDG. SINGLE FAMILY DETACHED
(SINGLE FAMILY DWELLING OR COMMERCIAL)

THE SYSTEM INSTALLED UNDER THIS APPLICATION IS ACCEPTABLE ONLY UNTIL PUBLIC FACILITIES BECOME AVAILABLE. I FULLY UNDERSTAND THE FEE CONNECTED WITH THE FILING OF THIS PERC TEST APPLICATION IS NON-REFUNDABLE UNDER ANY CIRCUMSTANCES. I ALSO AGREE TO COMPLY WITH ALL M.O.S.H.A. REQUIREMENTS IN TESTING THIS LOT.

SECURITY DEVELOPMENT LLC
BY: M. C. [Signature]
(SIGNATURE OF APPLICANT) STEPHEN K. BIRFORD

APPROVED BY _____ FOR _____ DATE _____

DISAPPROVED BY _____ FOR _____ DATE _____

HOLD PENDING FURTHER TESTS _____

REASONS FOR REJECTION OR HOLDING _____

PERCOLATION TEST PLAT/PRELIMINARY PLAT - TITLE OR I.D. # _____ DATE _____

SITE DEVELOPMENT PLAN/FINAL PLAT - TITLE OR I.D. # _____ DATE _____

THIS IS NOT A PERMIT

516084
COUNTY #

SOIL PROFILE
62B

Strong org brn
Dk brn
CL-CLM
Rx < 5%
7'±
Mottling black
grey, white
strong ag brn
tan
Coarse
sand
Bottom
13'±

62C

RD Brn
hv Lm
CL Lm
Choc
brn
Rx 5-10%
6'±
org brn
greyish white
moist dk brn
micaceous
Lmy
SAND
Rx 15-20%
Bottom
14'

62A

Moist
RD Brn
Dk Brn
hv
micaceous
SCLM
pebbles
20-25%
Mottles
6'
Strong
org brn
dk brn
micaceous
granular
S Lm
SAND
12'±

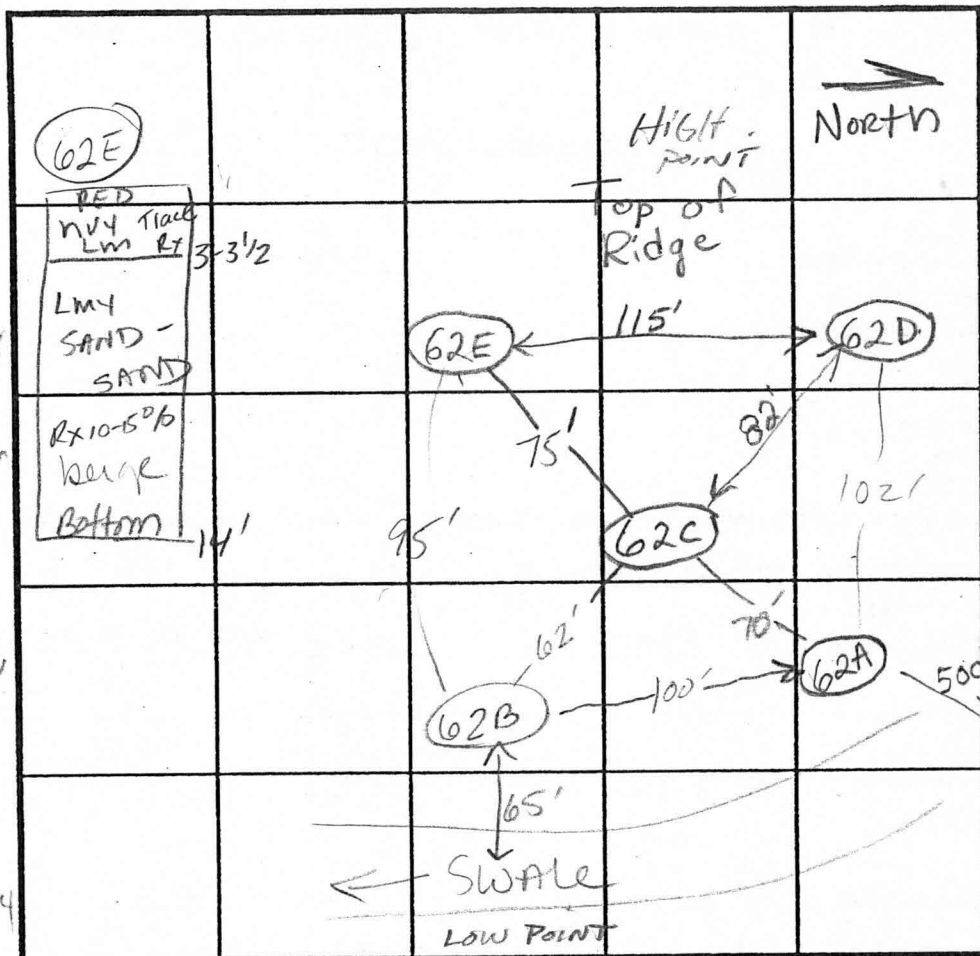

SOIL PROFILE
62D

org brn
CL Lm
Trace Rx
5'
Fine
large
SAND
Rx < 10%
Bottom
15'

INDICATE NORTH - NAME ADJOINING ROADWAY AS BASE LINE.

DATE	TEST NO.	DEPTH	PRE-WET		TEST - 1" DROP		TIME	
			START	STOP	START	STOP		
5-15-02	62B	7'3" / 13'±	2:29:24	Fail pulled @ 2:55	2:55	2:55	8min	need another 1/2" to 2nd test
Marked 52A	62A	6'± / 14'	1:54:16	1:59	1:59	2:07	8min	OK
	62C	6'±	2:10	2:17	2:17	2:55	38min	OK
	62D	5'± / 15'	3:18	3:18:17	3:18:17	repour		OK
	62E	6'± / repour	3:10:56	3:11:55	3:11:55	3:13:20	125	OK
		4'± / 14'	3:07	3:09	3:09	3:12	3min	
	62D	6'± / 12x12	3:21:42	3:22:40	3:22:40	3:24:38	2min	OK

REMARKS Holes dug per plan

TYPE OF SOIL _____

TESTED BY BB/KG ALSO PRESENT HATEFIELDS

TRENCH DESIGN DATA: AVERAGE PERCOLATION TIME _____ TRENCH WIDTH _____

APPLICATION

PERCOLATION TESTING

A 5/6084

P _____

HOWARD COUNTY HEALTH DEPARTMENT
BUREAU OF ENVIRONMENTAL HEALTH
3525-H ELLICOTT MILLS DRIVE/ELLICOTT CITY, MARYLAND 21043
TELEPHONE: 313-2840

DISTRICT _____

DATE _____

TO: THE COUNTY HEALTH OFFICER
ELLICOTT CITY, MARYLAND

I HEREBY APPLY FOR THE NECESSARY TEST PRIOR TO APPLICATION FOR PERMIT TO CONSTRUCT (OR RECONSTRUCT) A SEWAGE DISPOSAL SYSTEM.

PROPERTY OWNER SECURITY DEVELOPMENT, L.L.C.
P.O. BOX 417
ADDRESS ELLICOTT CITY, MD 21041 PHONE 410-465-4244

AGENT OR PROSPECTIVE BUYER _____
ADDRESS _____ PHONE _____

PROPERTY LOCATION:

SUBDIVISION HOMEWOOD LOT NO. 63

ROAD AND DESCRIPTION HOMEWOOD ROAD

TAX MAP 23 & 29 PARCEL # 20 & 86

SIZE OF LOT 1 ACRE ± TYPE BLDG. SINGLE FAMILY DETACHED
(SINGLE FAMILY DWELLING OR COMMERCIAL)

THE SYSTEM INSTALLED UNDER THIS APPLICATION IS ACCEPTABLE ONLY UNTIL PUBLIC FACILITIES BECOME AVAILABLE. I FULLY UNDERSTAND THE FEE CONNECTED WITH THE FILING OF THIS PERC TEST APPLICATION IS NON-REFUNDABLE UNDER ANY CIRCUMSTANCES. I ALSO AGREE TO COMPLY WITH ALL M.O.S.H.A. REQUIREMENTS IN TESTING THIS LOT.

SECURITY DEVELOPMENT LLC
BY: [Signature] MEMBER
(SIGNATURE OF APPLICANT) STEVEN K BISHOP

APPROVED BY _____ FOR _____ DATE _____

DISAPPROVED BY _____ FOR _____ DATE _____

HOLD PENDING FURTHER TESTS _____

REASONS FOR REJECTION OR HOLDING _____

PERCOLATION TEST PLAT/PRELIMINARY PLAT - TITLE OR I.D. # _____ DATE _____

SITE DEVELOPMENT PLAN/FINAL PLAT - TITLE OR I.D. # _____ DATE _____

THIS IS NOT A PERMIT

516084

COUNTY #

SOIL PROFILE

(63C)

Red Br Heavy Loam
One 4' Wide Pocket of 30-40% Rock From 8.5'-10'

Tan Sa Loam Hole Has About 10% Rock Overall

(63B)

Red Br Heavy Loam

Red Br Si Loam With Trace of Clay ~5% Rock

Tan Sa Loam ~5% Rock

(63A)

Red Br Heavy Loam

Or Br Sa Loam

Large Pocket of ~30% Rock From 8'-11' ~10%

SOIL PROFILE

(63D)

Red Br Heavy Loam ~5% Rock

Beige Sa Loam ~10% Rock

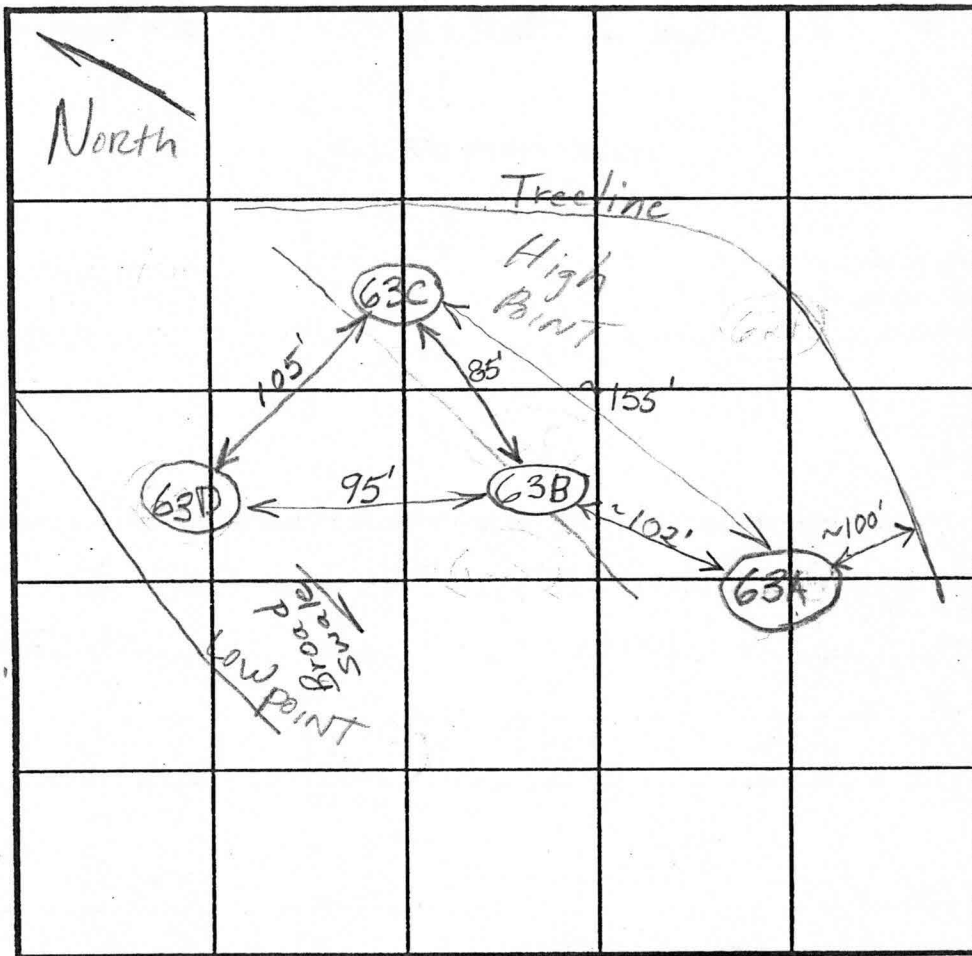

INDICATE NORTH - NAME ADJOINING ROADWAY AS BASE LINE.

Homewood Road

DATE	TEST NO.	DEPTH	PRE-WET		TEST - 1" DROP		TIME
			START	STOP	START	STOP	
5/15/02	63C	5'8" / 14.5'	10:25:30	~1/4" in 20 minutes			Slow (F)
		7'	10:24	~1/4" in 20 minutes			Slow
	63B	5.5' / 14.5'	10:37	Pulled - Slow			Slow OK
		6' 9"	10:37:15	10:38	10:38	10:39:45	1/min 45 sec
	63A	5' / 14'	11:00:15	11:02:15	11:02:15	11:07	~5 OK.
		6'	11:01	11:02:30	11:02:30	11:05	2 1/2
	63D	7'3" / 15.5'	11:17	~1/4" in 15 minutes			Slow (F)

REMARKS

Holes per plan

TYPE OF SOIL

TESTED BY

B. Baker

ALSO PRESENT

Hatfields

TRENCH DESIGN DATA: AVERAGE PERCOLATION TIME

TRENCH WIDTH

INLET DEPTH

MAXIMUM BOTTOM DEPTH

SOIL BEDROOM

APPLICATION

PERCOLATION TESTING

A 516084

P _____

HOWARD COUNTY HEALTH DEPARTMENT
BUREAU OF ENVIRONMENTAL HEALTH
3525-H ELLICOTT MILLS DRIVE/ELLICOTT CITY, MARYLAND 21043
TELEPHONE: 313-2640

DISTRICT _____

DATE _____

TO: THE COUNTY HEALTH OFFICER
ELLICOTT CITY, MARYLAND

I HEREBY APPLY FOR THE NECESSARY TEST PRIOR TO APPLICATION FOR PERMIT TO CONSTRUCT (OR RECONSTRUCT) A SEWAGE DISPOSAL SYSTEM.

PROPERTY OWNER Security Development

ADDRESS P.O. Box 417, Ellicott City, MD PHONE (410) 465-4244
21041

AGENT OR PROSPECTIVE BUYER _____

ADDRESS _____ PHONE _____

PROPERTY LOCATION:

SUBDIVISION Homewood LOT NO. _____

ROAD AND DESCRIPTION Homewood Road

TAX MAP 23+29 PARCEL # 20+86

SIZE OF LOT 1 Acre ± TYPE BLDG. SFD
(SINGLE FAMILY DWELLING OR COMMERCIAL)

THE SYSTEM INSTALLED UNDER THIS APPLICATION IS ACCEPTABLE ONLY UNTIL PUBLIC FACILITIES BECOME AVAILABLE. I FULLY UNDERSTAND THE FEE CONNECTED WITH THE FILING OF THIS PERC TEST APPLICATION IS NON-REFUNDABLE UNDER ANY CIRCUMSTANCES. I ALSO AGREE TO COMPLY WITH ALL M.O.S.H.A. REQUIREMENTS IN TESTING THIS LOT.

(SIGNATURE OF APPLICANT)

APPROVED BY _____ FOR _____ DATE _____

DISAPPROVED BY _____ FOR _____ DATE _____

HOLD PENDING FURTHER TESTS _____

REASONS FOR REJECTION OR HOLDING _____

PERCOLATION TEST PLAT/PRELIMINARY PLAT - TITLE OR I.D. # _____ DATE _____

SITE DEVELOPMENT PLAN/FINAL PLAT - TITLE OR I.D. # _____ DATE _____

THIS IS NOT A PERMIT

APPLICATION

PERCOLATION TESTING

A 516084

P _____

HOWARD COUNTY HEALTH DEPARTMENT
BUREAU OF ENVIRONMENTAL HEALTH
3525-H ELLICOTT MILLS DRIVE/ELLICOTT CITY, MARYLAND 21043
TELEPHONE: 313-2640

DISTRICT _____

DATE _____

TO: THE COUNTY HEALTH OFFICER
ELLICOTT CITY, MARYLAND

I HEREBY APPLY FOR THE NECESSARY TEST PRIOR TO APPLICATION FOR PERMIT TO CONSTRUCT (OR RECONSTRUCT) A SEWAGE DISPOSAL SYSTEM.

PROPERTY OWNER SECURITY DEVELOPMENT, L.L.C.
P.O. BOX 417
ADDRESS ELLICOTT CITY, MD 21041 PHONE 410-465-4244

AGENT OR PROSPECTIVE BUYER _____
ADDRESS _____ PHONE _____

PROPERTY LOCATION:
SUBDIVISION HOMEWOOD LOT NO. 61
ROAD AND DESCRIPTION HOMEWOOD ROAD

TAX MAP 23 & 29 PARCEL # 20 & 86
SIZE OF LOT 1 ACRE ± TYPE BLDG. SINGLE FAMILY DETACHED
(SINGLE FAMILY DWELLING OR COMMERCIAL)

THE SYSTEM INSTALLED UNDER THIS APPLICATION IS ACCEPTABLE ONLY UNTIL PUBLIC FACILITIES BECOME AVAILABLE. I FULLY UNDERSTAND THE FEE CONNECTED WITH THE FILING OF THIS PERC TEST APPLICATION IS NON-REFUNDABLE UNDER ANY CIRCUMSTANCES. I ALSO AGREE TO COMPLY WITH ALL M.O.S.H.A. REQUIREMENTS IN TESTING THIS LOT.

SECURITY DEVELOPMENT LLC
BY: [Signature] MEMBER
(SIGNATURE OF APPLICANT) STEVEN K BIRFORD

APPROVED BY _____ FOR _____ DATE _____

DISAPPROVED BY _____ FOR _____ DATE _____

HOLD PENDING FURTHER TESTS _____

REASONS FOR REJECTION OR HOLDING _____

PERCOLATION TEST PLAT/PRELIMINARY PLAT - TITLE OR I.D. # _____ DATE _____

SITE DEVELOPMENT PLAN/FINAL PLAT - TITLE OR I.D. # _____ DATE _____

THIS IS NOT A PERMIT

516084
COUNTY #

SOIL PROFILE
(61C)

dense
y brn
Lm -
hvy Lm
4 1/2'
brn
beige
micaceous
SAND
Bottom

(61A)

Trace Rx
Strong
brn
Lm - CLM
4'
brn, y brn
Lm
Rx ≤ 5%
brn
lt brn
y brn
SAND
Rx ≤ 10%
Bottom

(61D)

org brn
y brn
Loam
(fine)
Rx ≤ 5%
org brn
y brn
fine
SAND
Rx 10-15%
Bottom

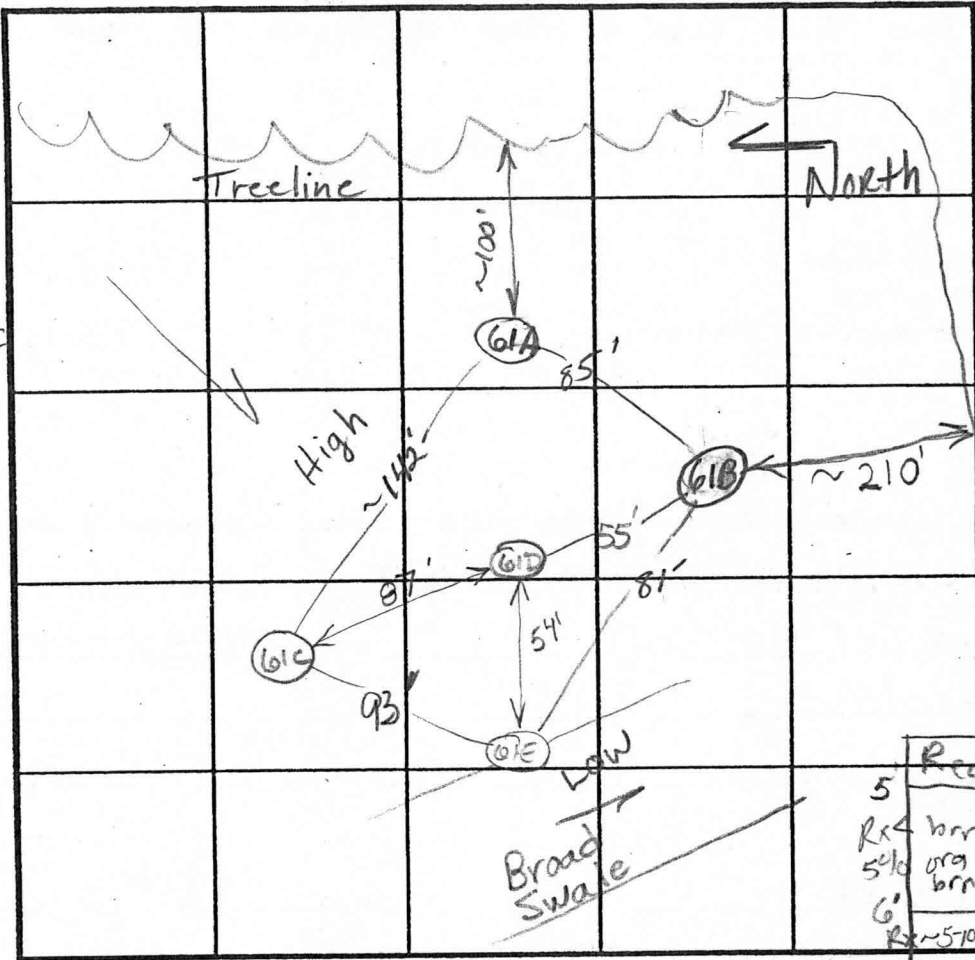

SOIL PROFILE

(61B)
0'
Dk brn
Strong
brn
hvy Lm
Rx < 5%
4 1/2'
tan
y brn
micaceous
sand
Lm
10-15%
Rx
Bottom

(61E)

5'
Rx 4 brn
5% org
brn
6'
Rx 5-10%
Br Heavy loam
Thin
layer of
micaceous
Lm
beige, brn
coarse sand

INDICATE NORTH - NAME ADJOINING ROADWAY AS BASE LINE.

DATE	TEST NO.	DEPTH	PRE-WET		TEST - 1" DROP		TIME	
			START	STOP	START	STOP		
5-15-02	61C	3'10" / 14 1/2'	12:44	12:50	1:04:30	1:04:30	14 1/2	OK
		6 1/2'	12:45:30	12:48	12:48	12:50:30	2 1/2 min	OK
	61A	3'10" / 14 1/2'	1:07:30	1:28	~ 3/8" in	20 minutes	Slow	
		4 1/2'	1:12:30	1:15:15	1:15:15	1:24	2:19 min	OK
		6 1/2'	1:14:10	1:14:55	1:14:55	1:16:25	1 1/2'	OK
	61D	4.5' / 14 1/2'	Visual	Q SEE	soil profile			OK
	61B	4'8"	1:28:32	1:32:30	1:32:30	1:41	8 1/2 min	OK
		6 1/2' / 14 1/2'	1:28:40	1:31:50	1:31:50	1:40	8 min	OK
	61E	6.5' / 15'	1:40:10	1:41:55	1:41:55	1:44:27	2 1/2 min	OK

REMARKS Holes dug per plan

TYPE OF SOIL _____

TESTED BY BB/KG ALSO PRESENT HATFIELD'S

TRENCH DESIGN DATA: AVERAGE PERCOLATION TIME _____ TRENCH WIDTH _____

MIN. TEST DEPTH _____ MAXIMUM BOTTOM DEPTH _____ SO FT/BEDROOM _____

APPLICATION

PERCOLATION TESTING

A 516084

P _____

HOWARD COUNTY HEALTH DEPARTMENT
BUREAU OF ENVIRONMENTAL HEALTH
3525-H ELLICOTT MILLS DRIVE/ELLICOTT CITY, MARYLAND 21043
TELEPHONE: 313-2640

DISTRICT _____

DATE _____

TO: THE COUNTY HEALTH OFFICER
ELLICOTT CITY, MARYLAND

I HEREBY APPLY FOR THE NECESSARY TEST PRIOR TO APPLICATION FOR PERMIT TO CONSTRUCT (OR RECONSTRUCT) A SEWAGE DISPOSAL SYSTEM.

PROPERTY OWNER _____

ADDRESS _____ PHONE _____

AGENT OR PROSPECTIVE BUYER _____

ADDRESS _____ PHONE _____

PROPERTY LOCATION:

SUBDIVISION Homewood LOT NO. 42/43

ROAD AND DESCRIPTION _____

TAX MAP _____ PARCEL # _____

SIZE OF LOT _____ TYPE BLDG. _____
(SINGLE FAMILY DWELLING OR COMMERCIAL)

THE SYSTEM INSTALLED UNDER THIS APPLICATION IS ACCEPTABLE ONLY UNTIL PUBLIC FACILITIES BECOME AVAILABLE. I FULLY UNDERSTAND THE FEE CONNECTED WITH THE FILING OF THIS PERC TEST APPLICATION IS NON-REFUNDABLE UNDER ANY CIRCUMSTANCES. I ALSO AGREE TO COMPLY WITH ALL M.O.S.H.A. REQUIREMENTS IN TESTING THIS LOT.

(SIGNATURE OF APPLICANT)

APPROVED BY _____ FOR _____ DATE _____

DISAPPROVED BY _____ FOR _____ DATE _____

HOLD PENDING FURTHER TESTS _____

REASONS FOR REJECTION OR HOLDING _____

PERCOLATION TEST PLAT/PRELIMINARY PLAT - TITLE OR I.D. # _____ DATE _____

SITE DEVELOPMENT PLAN/FINAL PLAT - TITLE OR I.D. # _____ DATE _____

THIS IS NOT A PERMIT

0116084
COUNTY #

SOIL PROFILE

0'
 (210)
 Red Br
 Heavy Loam 2.5'-4.5'
 Tan Sa
 Loam
 15-20%
 Rock and
 Saprolite

SOIL PROFILE

0'

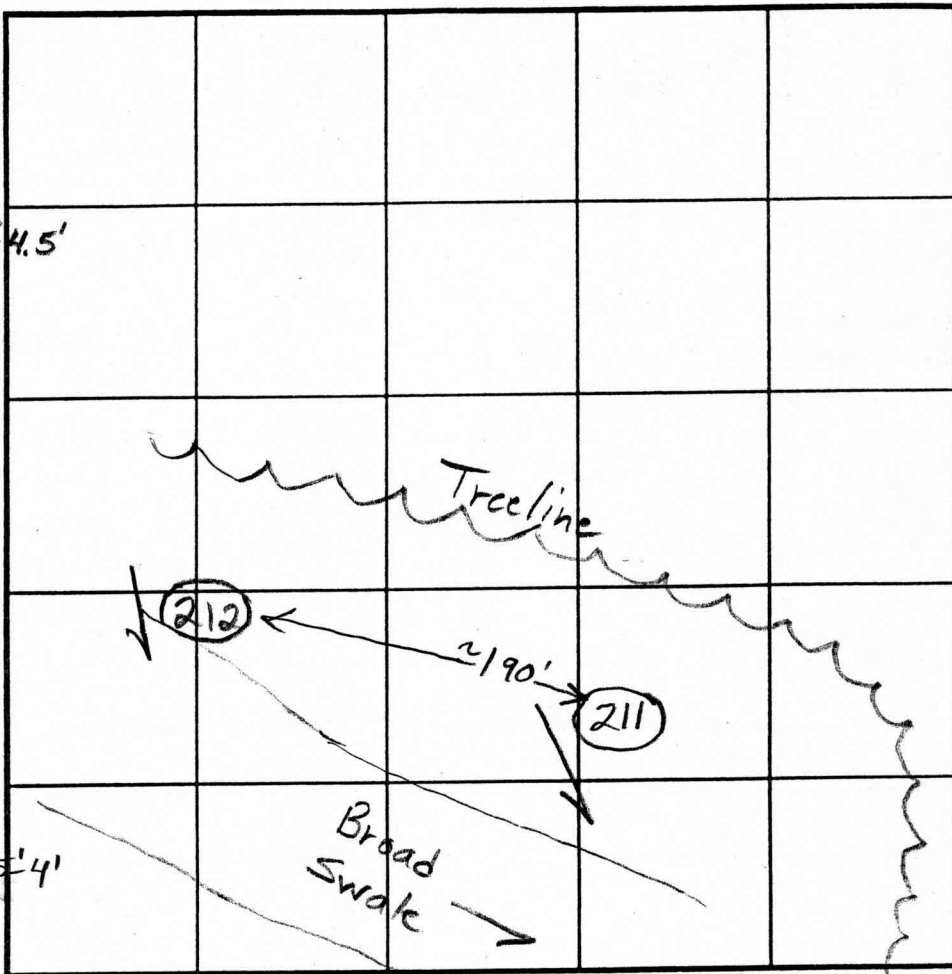

INDICATE NORTH - NAME ADJOINING ROADWAY AS BASE LINE.
 Homewood Road

(212)
 Red Br
 Heavy Loam 3.5'-4'
 Light Or
 Br Sa
 Loam
 ~15%
 Saprolite
 14.5'

DATE	TEST NO.	DEPTH	PRE-WET		TEST - 1" DROP		TIME
			START	STOP	START	STOP	
10/23/02	211	55'/14.5'	1:17	1:20:30	1:20:30	1:26:30	6
		7'	1:17:15	1:19:15	1:19:15	1:23	~4
	212	5'/14.5'	1:34:15	1:36:40	1:36:40	1:42:30	~6
		7'	1:34:30	1:36:20	1:36:20	1:39:30	~3

OK
 OK

REMARKS: Holes dug per plan
 TYPE OF SOIL: _____
 TESTED BY: B. Baker ALSO PRESENT: Hatfield
 TRENCH DESIGN DATA: AVERAGE PERCOLATION TIME _____ TRENCH WIDTH _____
 INLET DEPTH _____ MAXIMUM BOTTOM DEPTH _____ SQ. FT./BEDROOM _____

SQUARE FOOTAGE

<u>NOTTINGHAM</u>		<u>(01NM92)</u>
FIRST FLOOR		3,358
SECOND FLOOR		<u>3,462</u>
TOTAL LIVABLE AREA		6,820
GARAGE		607
PORCH		<u>368</u>
TOTAL		7,795
BASEMENT LIVABLE AREA		3,662
OPTIONAL PATIO'S	LEFT 166 RIGHT 243	409
OPTIONAL SOLARIUM		608
OPT. PATIO'S AT SOLARIUM	LEFT 108 RIGHT 185	292
OPTIONAL 3 CAR GARAGE (ADD'L)		219
OPTIONAL 4 CAR GARAGE (ADD'L)		<u>824</u>

NOTE: FINISHED SQUARE FOOTAGE CALCULATIONS FOR THIS STRUCTURE WERE MADE BASED ON PLAN DIMENSIONS ONLY AND MAY VARY FROM THE FINISHED SQUARE FOOTAGE OF THE STRUCTURE.

ARCH

CONI

E-MA