

PUB. SEWER STATUS VERIFIED BY _____

ISSUE DATE: 6/6/2001

APPROVAL DATE: 5/6/03

**PERMIT
INDEXED**

P 515280

A REPAIR

**ON-SITE SEWAGE DISPOSAL SYSTEM
HOWARD COUNTY HEALTH DEPARTMENT
BUREAU OF ENVIRONMENTAL HEALTH**

04-338677

Gary Poole

IS PERMITTED TO INSTALL ALTER

ADDRESS: _____ PHONE NUMBER: _____

SUBDIVISION: Justifiable LOT NUMBER: 14

ADDRESS: 14770 Justifiable Court PROPERTY OWNER: Tod & Lisa Lipman

SEPTIC TANK CAPACITY (GALLONS): 1500

PUMP CHAMBER CAPACITY (GALLONS): —

NUMBER OF BEDROOMS: 5

SQUARE FEET PER BEDROOM: 240

LINEAR FEET OF TRENCH REQUIRED: 120 + any additional

TRENCHES:	Trench to be 2.0 feet wide. Inlet 4.0 feet below original grade. Bottom maximum depth 8.0 feet below original grade. Effective area begins at 4.0 feet below original grade. 4.0 feet of stone below distribution pipe.
LOCATION:	
PURPOSE:	In support of B00130370 to add 2-BR addition to ex. 3-BR house. Provide minimum septic tank capacity as above. Excavate highest existing trench to verify system operation. Install trenches as req'd (as specified, plus any additional to be determined).

PLANS APPROVED: MER DATE: 4/28/03

- NOTE: PERMIT VOID AFTER 2 YEARS
- NOTE: CONTRACTOR RESPONSIBLE FOR SCHEDULING A PRE-CONSTRUCTION INSPECTION FOR ALL INSTALLATIONS
- NOTE: WATERTIGHT SEPTIC TANKS REQUIRED
- NOTE: ALL PARTS OF SEPTIC SYSTEM SHALL BE 100 FEET FROM ANY WATER WELL
- NOTE: MANHOLE RISERS REQUIRED ON ALL SEPTIC TANKS AND PUMP CHAMBERS

**NEITHER THE HOWARD COUNTY COUNCIL NOR THE HEALTH DEPARTMENT IS
RESPONSIBLE FOR THE SUCCESSFUL OPERATION OF ANY SYSTEM
PERMITTEE RESPONSIBLE FOR OBTAINING FINAL APPROVAL ON THIS PERMIT
CALL 410-313-2640 FOR INSPECTION OF SEPTIC SYSTEM**

P515280

NOT TO SCALE

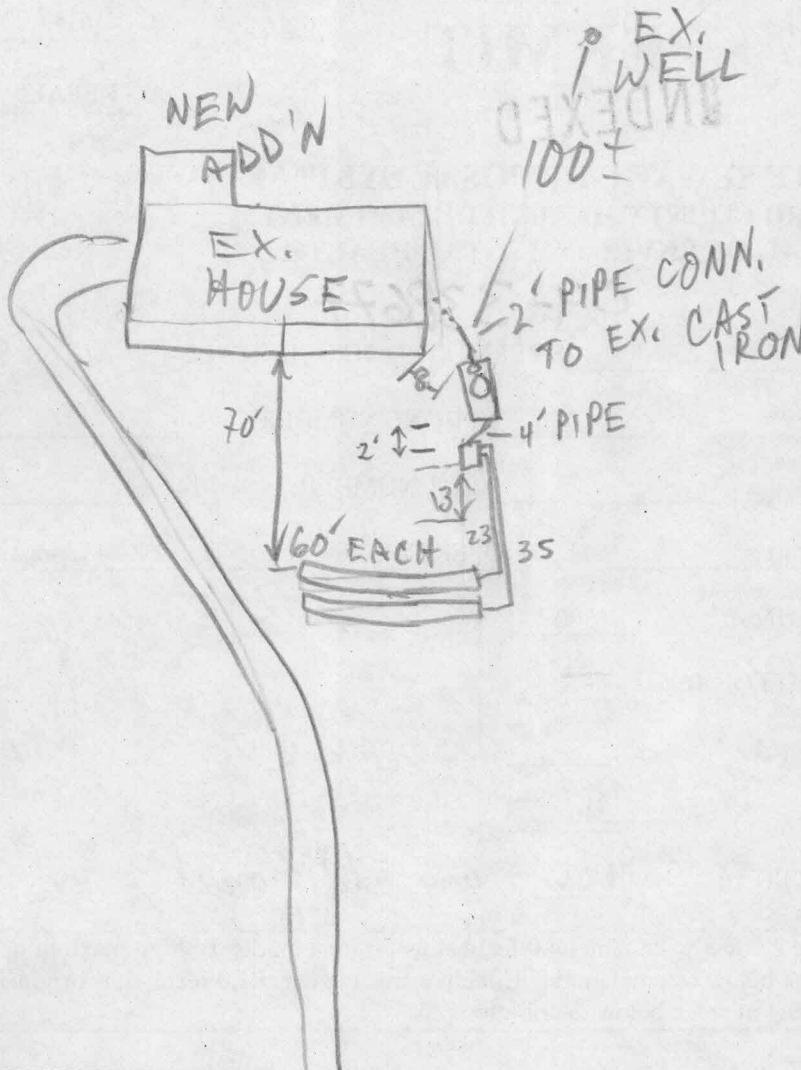

TRENCH/DRAINFIELD DATA		
WIDTH	INLET	BOTTOM
<u>2</u>	<u>4</u>	<u>8</u>
NUMBER OF TRENCHES		<u>2</u>
TOTAL LENGTH		<u>120</u>
ABSORPTION AREA		<u>840</u>
DISTRIBUTION BOX LEVEL		<input checked="" type="checkbox"/>
DISTRIBUTION BOX BAFFLE		<input checked="" type="checkbox"/>
DISTRIBUTION BOX PORT		<input type="checkbox"/>

SEPTIC TANK DATA	
SEPTIC TANK 1 LEVEL	<input checked="" type="checkbox"/>
CAPACITY	<u>1500</u> GAL
SEAM LOC	<u>TOP</u>
TANK LID DEPTH	<u>3-4'</u>
BAFFLES	<input checked="" type="checkbox"/>
BAFFLE FILTER	<input type="checkbox"/>
MANHOLE LOC	<u>CENTER</u>
6" PORT LOC	<u>FRONT</u>
WATERTIGHT TEST	<input type="checkbox"/>
SEPTIC TANK 2 LEVEL	<input type="checkbox"/>
CAPACITY	<input type="checkbox"/> GAL
SEAM LOC	<input type="checkbox"/>
TANK LID DEPTH	<input type="checkbox"/>
BAFFLES	<input type="checkbox"/>
BAFFLE FILTER	<input type="checkbox"/>
MANHOLE LOC	<input type="checkbox"/>
6" PORT LOC	<input type="checkbox"/>
WATERTIGHT TEST	<input type="checkbox"/>

PRE-CONSTRUCTION _____

INSTALLATION 5/6/03 EX. TANK ABANDONED & REPLACED; NEW TRENCHES OK; EX. TRENCH EXCAVATED TO TOP, DRY; ALL WORK OK TO COVER (MR)

FINAL INSPECTOR M. Ripkin DATE OF APPROVAL 5/6/03