

COP-8964

DEPARTMENT OF INSPECTIONS, LICENSES AND PERMITS
340 COURT HOUSE DRIVE
ELICOTT CITY, MD 21043
PERMITS (410) 313-2455 INSPECTIONS (410) 313-1810
AUTOMATED INFORMATION (410) 313-3000

HOWARD COUNTY PERMIT APPLICATION

PERMIT NUMBER

B00151156 KSB

Building Address 13505 Julia Manor
Way West Friendship 21794
TAX ID# 03-341828 SDP/WP/Petition #: 04 67
Suite/Apt. #: _____ Subdivision Paddock EAST
Census Tract 603000 Section _____ Area _____ Lot 8
Tax Map 22 Parcel 7 Grid 8
Zoning R11 Map Coordinates 755 Lot size _____

Property Owner's Name Pulte Homes Inc
Address 1501 S. Edgewood St
City Baltimore State Md Zip Code 21227
Home Phone _____ Work Phone 410 644 5603
Applicant's Name & Mailing Address, (if other than stated hereon): _____
Phone _____ Fax _____

Existing Use VACANT LOT
Proposed Use SFD
Estimated Construction Cost \$ 250,000
Description of Work CHATEAUX w/ MORNJAM
2 story full bsmt, 1DR, 2FB, 1HB,
1FP, 3 CAR, 4 BR (OPT. finish)

Contractor Company Pulte Homes Inc
Contact Person Dianna Wenzlaff
Address 1501 S. Edgewood Street
City Baltimore State Md Zip Code 21227
License No. 516 Phone _____ Fax _____

Occupant or Tenant BSMT + BATH, WALKOUT
Contact Name _____
Address _____
City _____ State _____ Zip Code _____
Phone _____ Fax _____

Engineer or Architect Company _____
Contact Person _____
Address _____
City _____ State _____ Zip Code _____
Phone _____ Fax _____

BUILDING DESCRIPTION - COMMERCIAL

BUILDING DESCRIPTION - RESIDENTIAL

Building Characteristics	Utilities
Height: _____	Water Supply: _____ Public _____ Private _____
No. of stories: _____	Sewage Disposal: _____ Public _____ Private _____
Gross area, sq. ft. per floor: _____	Electric Yes <input type="checkbox"/> No <input type="checkbox"/>
Use group: _____	Gas Yes <input type="checkbox"/> No <input type="checkbox"/>
Construction type: _____ Reinforced Concrete _____ Structural Steel _____ Masonry _____ Wood Frame _____ State Certified Modular _____	Heating System: _____ Electric <input type="checkbox"/> Oil <input type="checkbox"/> Natural Gas <input type="checkbox"/> Propane Gas <input type="checkbox"/>
	Sprinkler system: N/A <input type="checkbox"/> Full _____ Partial _____ Other Suppression _____ # of Heads _____

Building Characteristics	Utilities
SF Dwelling <input checked="" type="checkbox"/> SF Townhouse <input type="checkbox"/>	Water Supply: _____ Public _____ Private <input checked="" type="checkbox"/>
1st floor: <u>62</u> Depth <u>72</u> Width <u>72</u>	Sewage Disposal: _____ Public _____ Private <input checked="" type="checkbox"/>
2nd floor: <u>41</u> Depth <u>38</u> Width <u>38</u>	Electric Yes <input type="checkbox"/> No <input type="checkbox"/>
Basement: <u>62</u> Depth <u>58</u> Width <u>58</u>	Gas Yes <input checked="" type="checkbox"/> No <input type="checkbox"/>
Finished Basement <input checked="" type="checkbox"/> Unfinished Basement <input type="checkbox"/>	Heating System: _____ Electric <input type="checkbox"/> Oil <input type="checkbox"/> Natural Gas <input checked="" type="checkbox"/> Propane Gas <input type="checkbox"/>
Crawl space <input type="checkbox"/> Slab on Grade <input type="checkbox"/>	Sprinkler system: N/A <input checked="" type="checkbox"/> NFA #13D _____ NFA #13R _____ Other: _____
No. of Bedrooms <u>4</u>	
Multi-family dwellings: _____ No. of efficiency units: _____ No. of 1 BR units: _____ No. of 2 BR units: _____ No. of 3 BR units: _____	
Other Structure: _____ Dimensions: _____ Footings: _____ Roof: _____	
State Certified Modular _____ Manufactured Home _____	

THE UNDERSIGNED HEREBY CERTIFIES AND AGREES AS FOLLOWS: (1) THAT HE/SHE IS AUTHORIZED TO MAKE THIS APPLICATION, (2) THAT THE INFORMATION IS CORRECT, (3) THAT HE/SHE WILL COMPLY WITH ALL REGULATIONS OF HOWARD COUNTY WHICH ARE APPLICABLE THERETO, (4) THAT HE/SHE WILL PERFORM NO WORK ON THE ABOVE REFERENCED PROPERTY NOT SPECIFICALLY DESCRIBED IN THIS APPLICATION, (5) THAT HE/SHE GRANTS COUNTY OFFICIALS THE RIGHT TO ENTER ONTO THIS PROPERTY FOR THE PURPOSE OF INSPECTING THE WORK PERMITTED AND POSTING NOTICES.

Applicant's Signature Dianna Wenzlaff
Pulte Homes
Title/Company

Print Name Dianna Wenzlaff
11/16/04
Date

Checks payable to: **DIRECTOR OF FINANCE OF HOWARD COUNTY**
** PLEASE WRITE NEATLY AND LEGIBLY. **
- FOR OFFICE USE ONLY -

AGENCY	DATE	SIGNATURE APPROVAL
Land Development, DPZ		
State Highways		
Building Official		
Dev. Engineering, DPZ		
Health	<u>11/19/04</u>	<u>[Signature]</u>
Fire Protection		
Sediment Control approval required prior to issuance?		
YES <input type="checkbox"/> NO <input checked="" type="checkbox"/>		
CONTINGENCY CONSTRUCTION START: <input type="checkbox"/>		
ONE STOP SHOP: <input type="checkbox"/>		

DPZ SETBACK INFORMATION

Front: _____
Rear: _____
Side: _____
Side St: _____
All minimum setbacks met? YES NO
Is Entrance Permit required? YES NO
Historic District? YES NO
Lot Coverage for New Town Zone _____
SDP/Red-line approval date _____

PROPERTY ID#: 63975

Filing fee \$ 1100
Permit fee \$ _____
Excise tax \$ _____
Add'l per. fee \$ _____
TOTAL FEES \$ _____
Sub-total paid \$ _____
Balance due \$ _____
Check # 100984
Validation # 51002

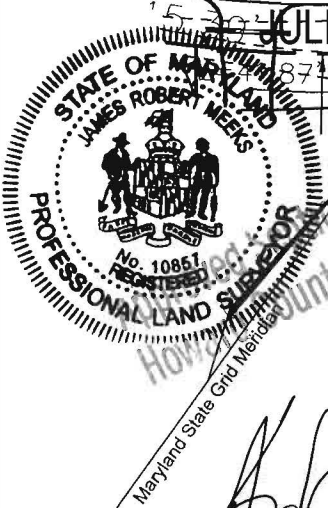
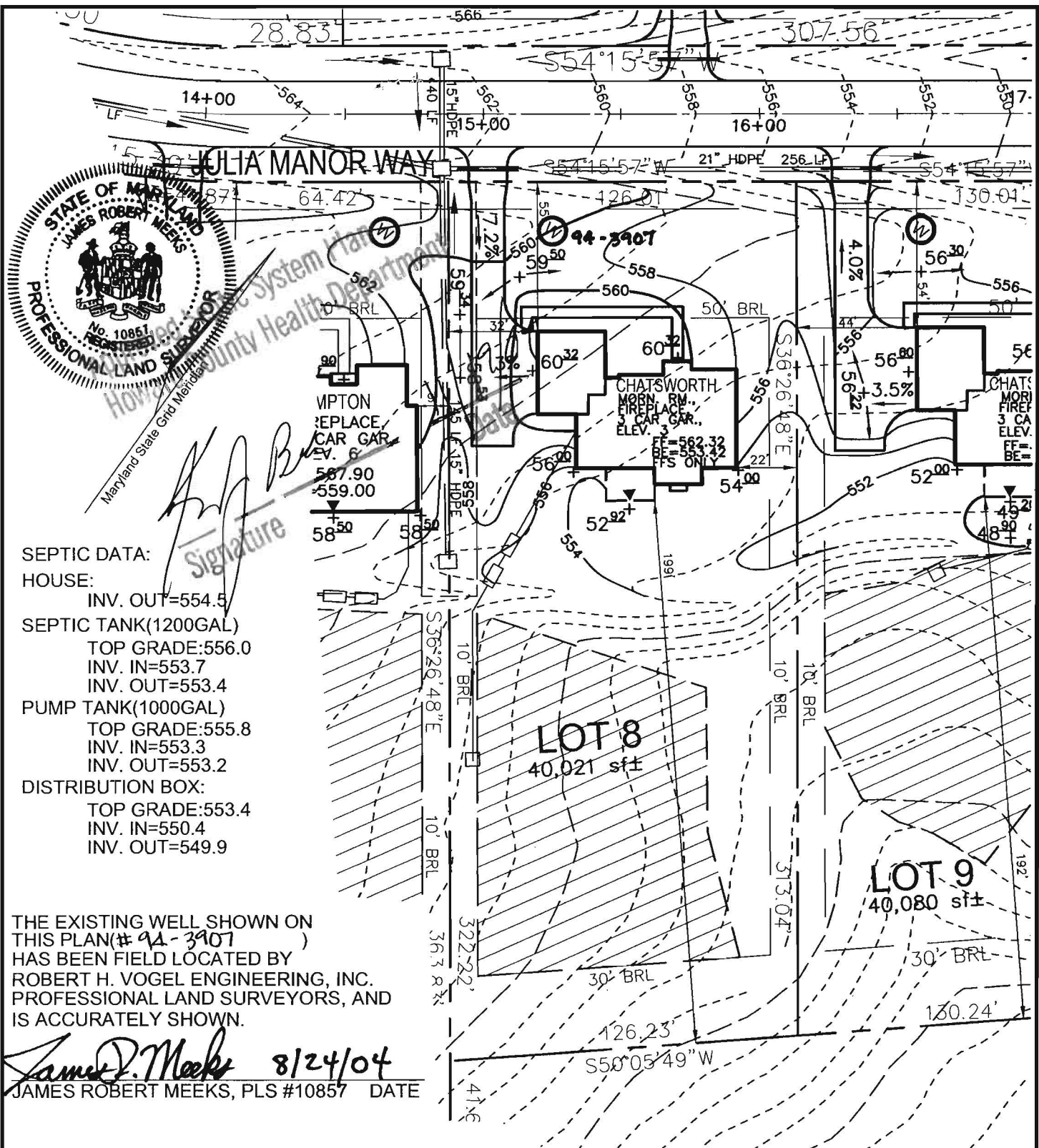

Signature

SEPTIC DATA:
 HOUSE:
 INV. OUT=554.5
 SEPTIC TANK(1200GAL)
 TOP GRADE:556.0
 INV. IN=553.7
 INV. OUT=553.4
 PUMP TANK(1000GAL)
 TOP GRADE:555.8
 INV. IN=553.3
 INV. OUT=553.2
 DISTRIBUTION BOX:
 TOP GRADE:553.4
 INV. IN=550.4
 INV. OUT=549.9

THE EXISTING WELL SHOWN ON THIS PLAN (# 91-3907) HAS BEEN FIELD LOCATED BY ROBERT H. VOGEL ENGINEERING, INC. PROFESSIONAL LAND SURVEYORS, AND IS ACCURATELY SHOWN.

James R. MEEKS 8/24/04
 JAMES ROBERT MEEKS, PLS #10857 DATE

SCALE 1"=50'
 DRAWN BY CMH
 CHECKED BY JCO
 DATE AUG. 11, 2004
 W. O. # 2034058
 SHEET# 1 OF 1

TAX MAP 22
 3RD ELECTION DISTRICT
**PULTE HOMES
 PADDOCKS EAST**
 PARCEL 7
 HOWARD COUNTY, MARYLAND
LOT 8
**ROBERT H. VOGEL
 ENGINEERING, INC.**
 ENGINEERS • SURVEYORS • PLANNERS
 8407 MAIN STREET TEL: 410.461.7666
 ELLICOTT CITY, MD 21043 FAX: 410.461.8961

