

GP-8964

DEPARTMENT OF INSPECTIONS, LICENSES AND PERMITS  
300 COURT HOUSE DRIVE  
ELLCOTT CITY, MD 21043  
PERMITS (410) 313 2455 INSPECTIONS (410) 313 1810  
AUTOMATED INFORMATION (410) 313 3800

# HOWARD COUNTY PERMIT APPLICATION

PERMIT NUMBER  
B.02150 999 **KTB**

Building Address 1357 1/2 Julia Manor  
Way, West Friendsrip  
Suite/Apt. # TAX ID# 03341836 SDP/WP/Petition #: 04-67  
Census Tract 603000 Subdivision Paddocks EAST  
Section \_\_\_\_\_ Area \_\_\_\_\_ Lot 9  
Tax Map 22 Parcel 7 Grid 8  
Zoning RR-D-0 Map Coordinates 958 Lot size \_\_\_\_\_

Property Owner's Name Pulte Homes, Inc  
Address 15015 Edgewood Street  
City Baltimore State Md Zip Code 21227  
Home Phone \_\_\_\_\_ Work Phone 410-644-5003  
Applicant's Name & Mailing Address, (if other than stated hereon):  
Phone \_\_\_\_\_ Fax \_\_\_\_\_

Existing Use VACANT LOT  
Proposed Use SFD  
Estimated Construction Cost \$ 250,000  
Description of Work CHATS WORTH 4 w/ MORN.  
ROOM, DR, 2 FB, 1 HB, 3 car gar.  
4 bed OPT: FIN. BSMT, BATH,

Contractor Company Pulte Homes  
Contact Person Dianna Wenzlaff  
Address 15015 Edgewood St  
City Balt State Md Zip Code 21227  
License No. 516  
Phone \_\_\_\_\_ Fax 410-644-2643

Occupant or Tenant WALKOUT BSMT  
Contact Name \_\_\_\_\_  
Address \_\_\_\_\_  
City \_\_\_\_\_ State \_\_\_\_\_ Zip Code \_\_\_\_\_  
Phone \_\_\_\_\_ Fax \_\_\_\_\_

Engineer or Architect Company \_\_\_\_\_  
Contact Person \_\_\_\_\_  
Address \_\_\_\_\_  
City \_\_\_\_\_ State \_\_\_\_\_ Zip Code \_\_\_\_\_  
Phone \_\_\_\_\_ Fax \_\_\_\_\_

BUILDING DESCRIPTION - <u>COMMERCIAL</u>	
Building Characteristics	Utilities
Height: _____	Water Supply: Public _____ Private _____
No. of stories: _____	Sewage Disposal: Public _____ Private _____
Gross area, sq. ft. per floor: _____	Electric Yes <input type="checkbox"/> No <input type="checkbox"/>
Use group: _____	Gas Yes <input type="checkbox"/> No <input type="checkbox"/>
Construction type: Reinforced Concrete _____ Structural Steel _____ Masonry _____ Wood Frame _____	Heating System: Electric <input type="checkbox"/> Oil <input type="checkbox"/>
State Certified Modular _____	Natural Gas <input type="checkbox"/>
	Propane Gas <input type="checkbox"/>
	Sprinkler system: N/A <input type="checkbox"/>
	Full _____
	Partial _____
	Other Suppression _____
	# of Heads _____

BUILDING DESCRIPTION - <u>RESIDENTIAL</u>	
Building Characteristics	Utilities
SF Dwelling <input checked="" type="checkbox"/> SF Townhouse <input type="checkbox"/>	Water Supply: Public _____ Private <input checked="" type="checkbox"/>
1st floor: Depth <u>62</u> Width <u>72</u>	Sewage Disposal: Public _____ Private <input checked="" type="checkbox"/>
2nd floor: <u>41</u> <u>58</u>	Electric Yes <input type="checkbox"/> No <input type="checkbox"/>
Basement: <u>62</u> <u>58</u>	Gas Yes <input checked="" type="checkbox"/> No <input type="checkbox"/>
Finished Basement <input checked="" type="checkbox"/> Unfinished Basement <input type="checkbox"/>	Heating System: Electric <input type="checkbox"/> Oil <input type="checkbox"/>
Crawl space <input type="checkbox"/> Slab on Grade <input type="checkbox"/>	Natural Gas <input checked="" type="checkbox"/>
No. of Bedrooms <u>4</u>	Propane Gas <input type="checkbox"/>
Multi-family dwellings: No. of efficiency units: _____	Sprinkler system: N/A <input checked="" type="checkbox"/>
No. of 1 BR units: _____	NFPA #13D _____
No. of 2 BR units: _____	NFPA #13R _____
No. of 3 BR units: _____	Other: _____
Other Structure: _____	
Dimensions: _____	
Footings: _____	
Roof: _____	
State Certified Modular _____	
Manufactured Home _____	

THE UNDERSIGNED HEREBY CERTIFIES AND AGREES AS FOLLOWS: (1) THAT HE/SHE IS AUTHORIZED TO MAKE THIS APPLICATION; (2) THAT THE INFORMATION IS CORRECT; (3) THAT HE/SHE WILL COMPLY WITH ALL REGULATIONS OF HOWARD COUNTY WHICH ARE APPLICABLE THERETO; (4) THAT HE/SHE WILL PERFORM NO WORK ON THE ABOVE REFERENCED PROPERTY NOT SPECIFICALLY DESCRIBED IN THIS APPLICATION; (5) THAT HE/SHE GRANTS COUNTY OFFICIALS THE RIGHT TO ENTER ONTO THIS PROPERTY FOR THE PURPOSE OF INSPECTING THE WORK PERMITTED AND POSTING NOTICES.

Dianna Wenzlaff  
Applicant's Signature  
Pulte Homes  
Title/Company

Dianna Wenzlaff  
Print Name  
11-1-04  
Date

Checks payable to: **DIRECTOR OF FINANCE OF HOWARD COUNTY**  
\*\* PLEASE WRITE NEATLY AND LEGIBLY. \*\*  
- FOR OFFICE USE ONLY -

AGENCY	DATE	SIGNATURE APPROVAL
<input checked="" type="checkbox"/> Land Development, DPZ		
<input checked="" type="checkbox"/> State Highways		
<input checked="" type="checkbox"/> Building Official		
<input checked="" type="checkbox"/> Dev. Engineering, DPZ		
<input checked="" type="checkbox"/> Health	<u>11/10/04</u>	<u>[Signature]</u>
<input checked="" type="checkbox"/> Fire Protection		
Is Sediment Control approval required prior to issuance?		
YES <input type="checkbox"/> NO <input checked="" type="checkbox"/>		
CONTINGENCY CONSTRUCTION START: <input type="checkbox"/>		
ONE STOP SHOP: <input type="checkbox"/>		

DPZ SETBACK INFORMATION	PROPERTY ID#:
Front: _____	<u>63857</u>
Rear: _____	Filing fee \$ _____
Side: _____	Permit fee \$ _____
Side St: _____	Excise tax \$ _____
All minimum setbacks met?	Add'l per. fee \$ _____
YES <input type="checkbox"/> NO <input type="checkbox"/>	TOTAL FEES \$ _____
Is Entrance Permit required?	Sub-total paid \$ _____
YES <input type="checkbox"/> NO <input type="checkbox"/>	Balance due \$ _____
Historic District?	Check # <u>100374</u>
YES <input type="checkbox"/> NO <input type="checkbox"/>	Validation # <u>77510</u>
Lot Coverage for New Town Zone _____	
SDP/Red-line approval date _____	Accepted by <u>[Signature]</u>

Distribution of Copies - White: Building Official Green: LDD, DPZ Yellow: DED, DPZ Pink: Health Gold: SHA

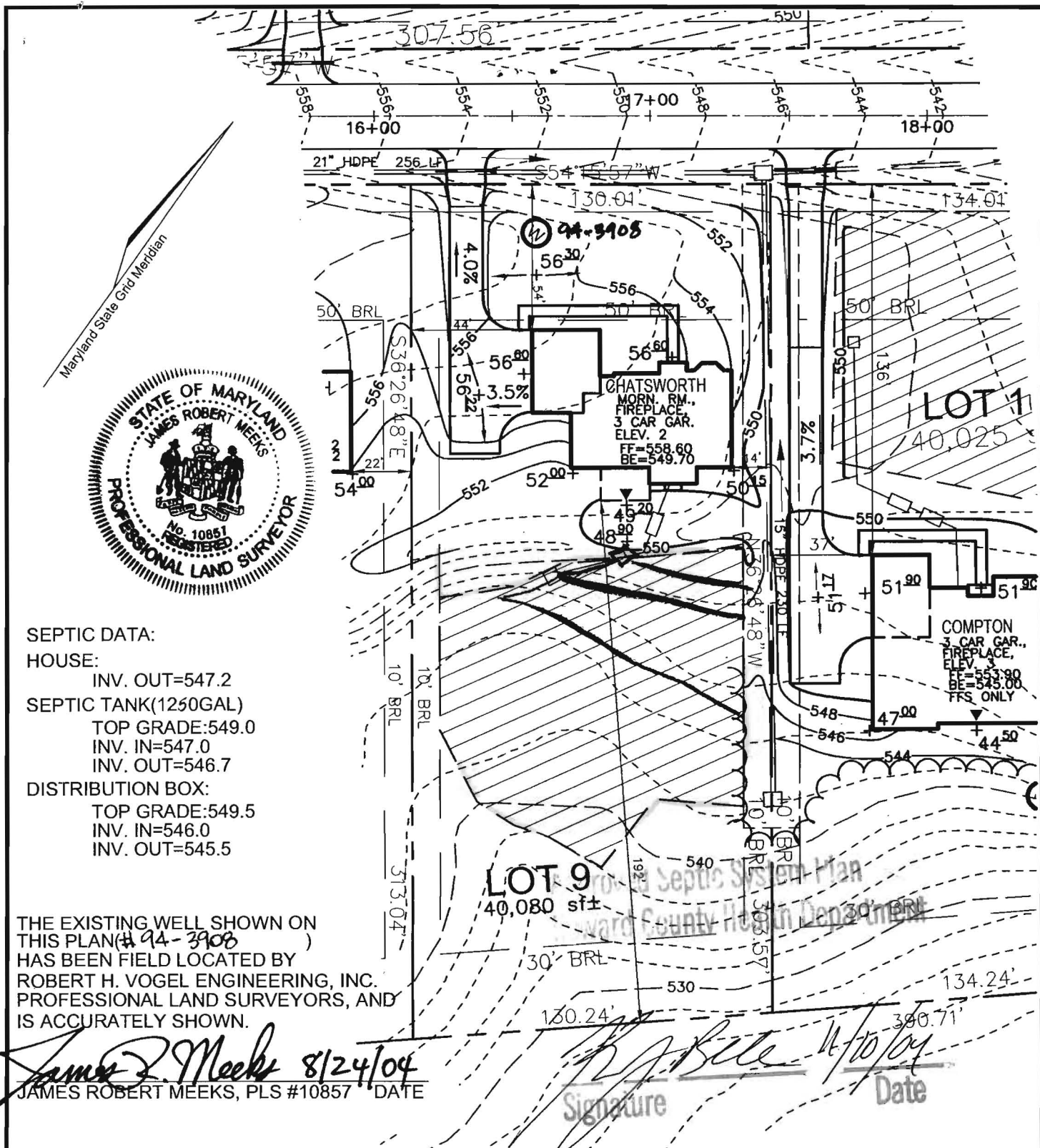

SEPTIC DATA:  
 HOUSE:  
 INV. OUT=547.2  
 SEPTIC TANK(1250GAL)  
 TOP GRADE:549.0  
 INV. IN=547.0  
 INV. OUT=546.7  
 DISTRIBUTION BOX:  
 TOP GRADE:549.5  
 INV. IN=546.0  
 INV. OUT=545.5

THE EXISTING WELL SHOWN ON THIS PLAN (# 94-3908) HAS BEEN FIELD LOCATED BY ROBERT H. VOGEL ENGINEERING, INC. PROFESSIONAL LAND SURVEYORS, AND IS ACCURATELY SHOWN.

*James R Meeks* 8/24/04  
 JAMES ROBERT MEEKS, PLS #10857 DATE

*[Signature]* 8/24/04  
 Signature Date

SCALE 1"=50'  
 DRAWN BY CMH  
 CHECKED BY JCO  
 DATE AUG. 11, 2004  
 W. O. # 2034058  
 SHEET# 1 OF 1

TAX MAP 22  
 3RD ELECTION DISTRICT  
 PULTE HOMES  
 PADDOCKS EAST  
 LOT 9  
 ROBERT H. VOGEL  
 ENGINEERING, INC.  
 ENGINEERS • SURVEYORS • PLANNERS  
 8407 MAIN STREET  
 ELLICOTT CITY, MD 21043  
 TEL: 410.461.7666  
 FAX: 410.461.8961  
 PARCEL 7  
 HOWARD COUNTY, MARYLAND