

LAYOUT 10/22/10 INSP 4 _____
 INSP 2 11/1/10 INSP 5 _____
 INSP 3 _____ INSP 6 _____

ISSUE DATE: 10-6-10
 APPROVAL DATE: 11/1/10

PERMIT

P 54053
 A _____

Tax ID #
ON-SITE SEWAGE DISPOSAL SYSTEM
HOWARD COUNTY HEALTH DEPARTMENT
BUREAU OF ENVIRONMENTAL HEALTH

Wimberlock and Company IS PERMITTED TO INSTALL ALTER

ADDRESS: 2391 A.E. Yellamy Rd Woodbine MD 21797 PHONE NUMBER: 301-854-6838
 SUBDIVISION: Asbury Property LOT NUMBER: 2

ADDRESS: 2710 Jennings Chapel Road PROPERTY OWNER: Ronald Asbury

SEPTIC TANK CAPACITY (GALLONS): 2000 OUTLET BAFFLE FILTER REQUIRED

PUMP CHAMBER CAPACITY (GALLONS): _____ COMPARTMENTED TANK REQUIRED

NUMBER OF BEDROOMS: 3 APPLICATION RATE: 1.2

SQUARE FOOTAGE OF HOUSE: 5151 ^(12pm)

LINEAR FEET OF TRENCH REQUIRED: 120

TRENCHES:	Trenches to be 2.0 feet wide. Inlet 40 ⁶⁰ feet below original grade. Bottom maximum depth 60 ⁶⁰ feet below grade. Effective area begins at 4.0 feet below original grade with 2.0 feet of stone below distribution pipe.
LOCATION:	Set septic tank approx. per plan. Set distribution box 42' south of NE septic reserve corner. Install 3x40' trenches on contour.
NOTES:	Do not order the septic tank until after layout inspection and Sanitarian approval. Stake easement corners. Call for layout inspection. Mark utilities. Gravel tickets must be available for Environmental Sanitarians. Stone must be approved by the Howard County Health Department. A written variance request is required for tanks deeper than 3 feet. A traffic bearing lid is required for tanks deeper than 4 feet.

PLANS APPROVED: Robert Bricker DATE: 2/4/10

- NOTE: PERMIT VOID AFTER 2 YEARS
- NOTE: CONTRACTOR RESPONSIBLE FOR SCHEDULING A PRE-CONSTRUCTION INSPECTION FOR ALL INSTALLATIONS
- NOTE: WATERTIGHT SEPTIC TANKS REQUIRED
- NOTE: ALL PARTS OF SEPTIC SYSTEM SHALL BE 100 FEET FROM ANY WATER WELL
- NOTE: MANHOLE RISERS REQUIRED ON ALL SEPTIC TANKS AND PUMP CHAMBERS

NEITHER THE HOWARD COUNTY COUNCIL OR THE HEALTH DEPARTMENT IS RESPONSIBLE FOR THE SUCCESSFUL OPERATION OF ANY SYSTEM
PERMITTEE RESPONSIBLE FOR OBTAINING FINAL APPROVAL ON THIS PERMIT
CALL 410-313-1771 FOR INSPECTION OF SEPTIC SYSTEM

NOT TO SCALE

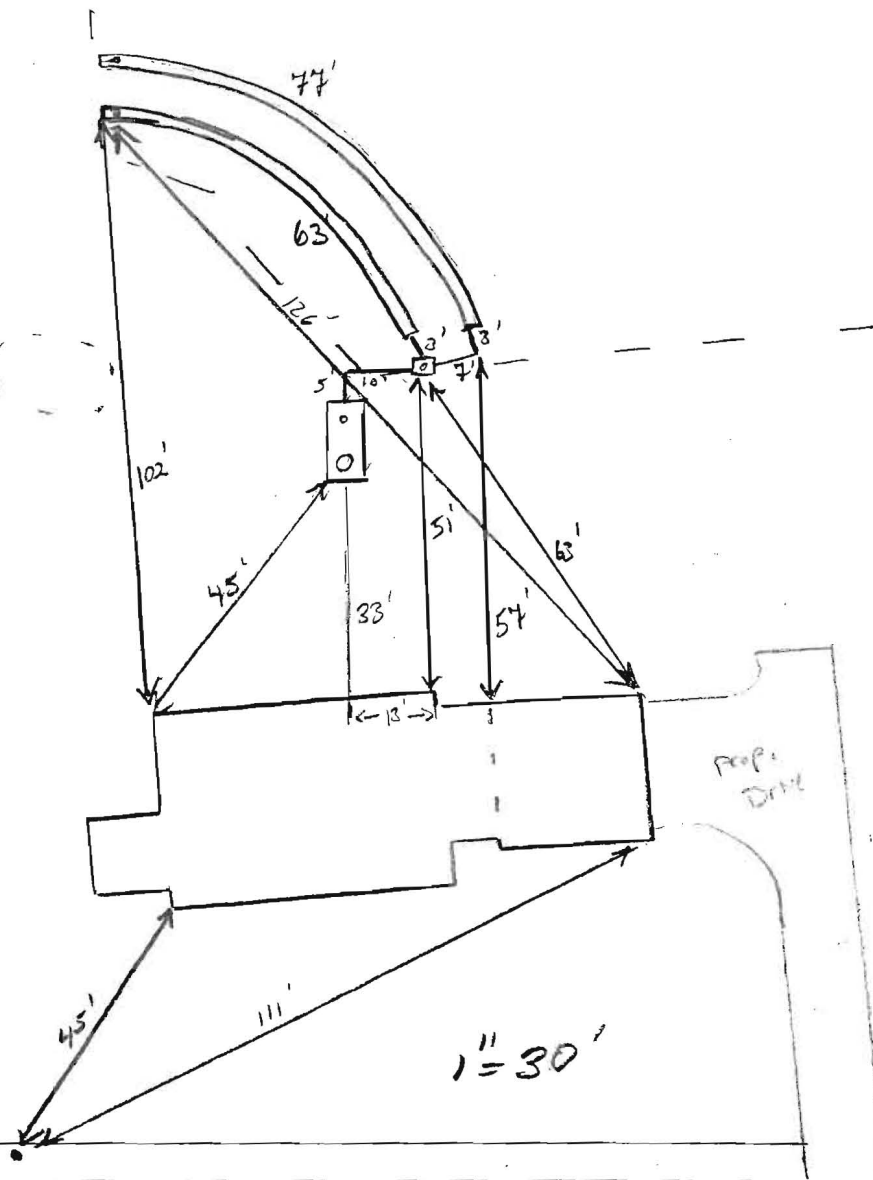

TRENCH/DRAINFIELD DATA		
WIDTH	INLET	BOTTOM
2	4	6'
NUMBER OF TRENCHES		2
TOTAL LENGTH		140
ABSORPTION AREA		280 + 5W
DISTRIBUTION BOX LEVEL		Levelled
DISTRIBUTION BOX BAFFLE		Yes
DISTRIBUTION BOX PORT		Yes

SEPTIC TANK DATA	
SEPTIC TANK 1 LEVEL	Yes
MANUFACTURER	Babylon
CAPACITY	2000 GAL
SEAM LOC	Top
TANK LID DEPTH	2.5'
BAFFLES	Yes
BAFFLE FILTER	
MANHOLE LOC	Front
6" PORT LOC	Rear
WATERTIGHT TEST	
SLOTTED	Yes 9/5/10
PUMP/SEPTIC TANK LEVEL N/A	
MANUFACTURER	
CAPACITY	
SEAM LOC	
TANK LID DEPTH	
BAFFLES	
BAFFLE FILTER	
MANHOLE LOC	
6" PORT LOC	
WATERTIGHT TEST	
SLOTTED	✓

PRE-CONSTRUCTION
 10/22/10 Install S.T. and D box per plan. Install 2x60' on contour. Trenches pointed out in field. Call for

inspection (K)

INSTALLATION: 11/1/10 4" SHC installed to tank. Tank set per plan. D box set and levelled. Trenches complete. Contractor added 17' more feet in bottom trench. OK to cover all work

FINAL INSPECTOR K. Wall DATE OF APPROVAL 11/1/10

GENERAL NOTES:

- 1) THIS LOCATION DRAWING IS PREPARED FOR THE BENEFIT OF THE CLIENT SIGNING THE HOUSE LOCATION SURVEY APPROVAL FORM INsofar AS IT IS REQUIRED BY A LENDER OR TITLE INSURANCE COMPANY OR ITS AGENTS IN CONNECTION WITH THE CONTEMPLATED TRANSFER, FINANCING OR REFINANCING OF THE PROPERTY SHOWN HEREON. UNLESS INDICATED AS BEING A BOUNDARY SURVEY, THIS LOCATION DRAWING IS NOT INTENDED FOR USE IN THE ESTABLISHMENT OF PROPERTY LINES AND IS NOT TO BE RELIED UPON FOR THE ESTABLISHMENT OR LOCATIONS OF FENCES, GARAGES, BUILDINGS OR OTHER EXISTING OR FUTURE IMPROVEMENTS. AS A RESULT, THIS LOCATION DRAWING DOES NOT PROVIDE FOR ACCURATE IDENTIFICATION OF PROPERTY LINES, BUT SUCH IDENTIFICATION MAY NOT BE REQUIRED FOR THE TRANSFER OF TITLE OR SECURING FINANCING FOR RE-FINANCING.
- 2) SUBJECT PROPERTY IS SHOWN IN ZONE C ON THE NATIONAL FLOOD INSURANCE PROGRAM FLOOD INSURANCE RATE MAP OF HOWARD COUNTY, MARYLAND, COMMUNITY PANEL No. 240044007B EFFECTIVE DEC. 4, 1986.
- 3) THE OFFSETS FROM BUILDING LINE TO PROPERTY LINE AS SHOWN ON THE PLAT HEREON ARE TO AN ACCURACY OF PLUS OR MINUS 1' (+)
- 4) NO TITLE REPORT FURNISHED. SUBJECT TO ALL EASEMENTS, RIGHTS OF WAY AND CONDITIONS OF RECORD.
- 5) THE EXISTING WELL(S) SHOWN ON THIS PLAN (IDENTIFIED WITH THE ATTACHED WELL TAG NUMBER HO-95-1610 HAS BEEN FIELD LOCATED BY FISHER, COLLINS AND CARTER, INC. PROFESSIONAL LAND SURVEYORS AND IS ACCURATELY SHOWN.
- 6) SEE PLAT *20030 FOR ADDITIONAL EASEMENTS AND RIGHT-OF-WAYS OUT TO JENNINGS CHAPEL ROAD.
- 7) BUILDING PERMIT *B-09001647

EXISTING 40' WIDE PRIVATE RIGHT-OF-WAY FOR INGRESS AND EGRESS DESCRIBED IN THE FOLLOWING DEEDS:
3496/318, 6109/420, 8772/667, 8077/157.

PRIVATE ACCESS EASEMENT FOR THE USE AND BENEFIT OF LOT 1 ASBURY PROPERTY.

DETAIL:
1"=30'

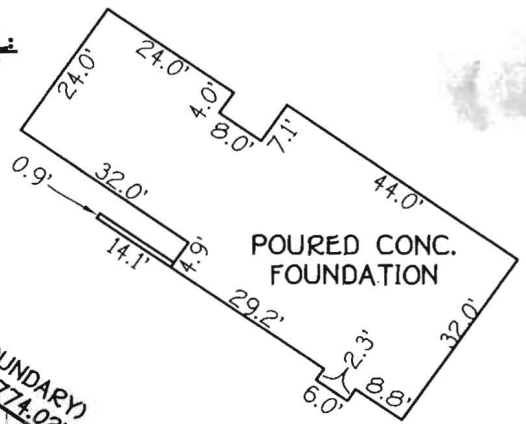

PROPERTY OF MATTHEW A SAVAGE
4001/448

(TRACT BOUNDARY)
S54°58'11"E 774.02'

POURED CONC. FOUNDATION

TO JENNINGS CHAPEL ROAD

N54°58'11"W 200.42'

N35°01'49"E 229.36'
10' B.R.L.

LOT 2

50' B.R.L.
SEE DETAIL

EX. WELL
HO-95-1610

PRIVATE ACCESS EASEMENT FOR THE USE AND BENEFIT OF LOT 2 ASBURY PROPERTY.

AGRICULTURAL LAND PRESERVATION EASEMENT
HO-90-12E

LOT 2
AGRICULTURAL PRESERVATION SUBDIVISION PLAT FOR ASBURY PROPERTY LOTS 1, 2 AND 3 FOURTH ELECTION DISTRICT HOWARD COUNTY, MARYLAND PLAT *20028-20030

AGRICULTURAL LAND PRESERVATION EASEMENT
HO-90-12E

*2710 JENNINGS CHAPEL ROAD
B.R.L.= BUILDING RESTRICTION LINE
TOP OF FOUNDATION ELEV.= 586.3'

SEPTIC AREA
30' B.R.L.
554°58'11"E 173.51'

10' B.R.L.
N43°34'45"E 181.01'

FISHER, COLLINS & CARTER, INC.
CIVIL ENGINEERING CONSULTANTS & LAND SURVEYORS
CENTENNIAL SQUARE OFFICE PARK - 10272 BALTIMORE NATIONAL PIKE
ELLICOTT CITY, MARYLAND 21042
(410) 461 - 2855



PROFESSIONAL LAND SURVEYOR DATE
REG. *539

HOUSE LOCATION DRAWING

FOUNDATION LOCATION: 9/22/10
FINAL LOCATION: _____
BOUNDARY SURVEY: _____

SCALE: 1"=60'
DATE: 10/4/10
DRAWN BY: JIMP
CHECKED BY: MLR
PROJECT No.: 30735-0001