

10/30/01 11 A.M. Repair

ISSUE DATE: 10/12/01

APPROVAL DATE: 10/30/01

# PERMIT INDEXED

P 516071-B

A REPAIR

## ON-SITE SEWAGE DISPOSAL SYSTEM HOWARD COUNTY HEALTH DEPARTMENT BUREAU OF ENVIRONMENTAL HEALTH

05-355079

K & K Excavating IS PERMITTED TO INSTALL  ALTER

ADDRESS: 14960 Frederick Road, Woodbine PHONE NUMBER: 410-442-1336

SUBDIVISION: EASTERN VIEW LOT NUMBER: 13

ADDRESS: 11719 Janney Court PROPERTY OWNER: Kevin O'Malley

SEPTIC TANK CAPACITY (GALLONS): EX. 1500

PUMP CHAMBER CAPACITY (GALLONS): N/A

NUMBER OF BEDROOMS: 4

SQUARE FEET PER BEDROOM: 180

LINEAR FEET OF TRENCH REQUIRED:

TRENCHES:	Trench to be 3.0 feet wide. Inlet 4.0 feet below original grade. Bottom maximum depth 6.0 feet below original grade. Effective area begins at _____ feet below original grade. _____ feet of stone below distribution pipe.
LOCATION:	
PURPOSE:	In support of B00129627. Expansion of existing 3 BR system to 4 BR system--Install one 80 foot trench. Call when ground is opened so sanitarian can recommend repair.

PLANS APPROVED: Mark Rifkin DATE: 10/12/01

- NOTE: PERMIT VOID AFTER 2 YEARS
- NOTE: CONTRACTOR RESPONSIBLE FOR SCHEDULING A PRE-CONSTRUCTION INSPECTION FOR ALL INSTALLATIONS
- NOTE: WATERTIGHT SEPTIC TANKS REQUIRED
- NOTE: ALL PARTS OF SEPTIC SYSTEM SHALL BE 100 FEET FROM ANY WATER WELL
- NOTE: MANHOLE RISERS REQUIRED ON ALL SEPTIC TANKS AND PUMP CHAMBERS

**NEITHER THE HOWARD COUNTY COUNCIL NOR THE HEALTH DEPARTMENT IS RESPONSIBLE FOR THE SUCCESSFUL OPERATION OF ANY SYSTEM PERMITTEE RESPONSIBLE FOR OBTAINING FINAL APPROVAL ON THIS PERMIT CALL 410-313-2640 FOR INSPECTION OF SEPTIC SYSTEM**

**BUILDING PERMIT SIGNED  
AND RETURNED**

11106 B00159002-IG POOL

516071-B

NOT TO SCALE

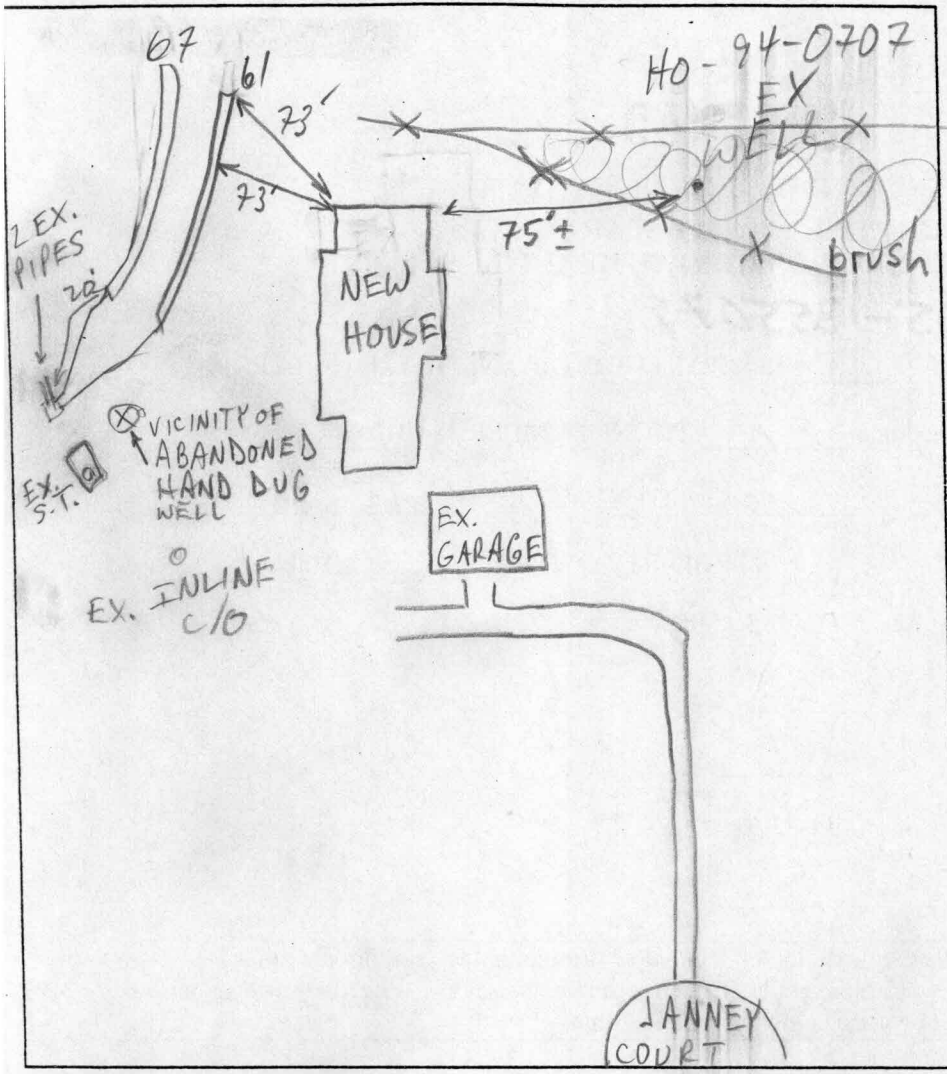

**TRENCH DATA**

TRENCH WIDTH 3  
 TRENCH INLET DEPTH 4 1/2  
 TRENCH BOTTOM DEPTH 6 1/2  
 DEPTH OF STONE 2  
 NUMBER OF TRENCHES 2  
 TOTAL TRENCH LENGTH 128+180=300  
 ABSORBENT AREA 900 TOTAL  
 DISTRIBUTION BOX LEVEL EX.  
 BAFFLE IN DISTRIBUTION BOX EX.

**SEPTIC TANK DATA**

SEPTIC TANK EX 1500 GALLONS  
 MANHOLE RISER ✓  
 6 INCH INSPECTION PORT EX.

**PUMP CHAMBER DATA**

PUMP CHAMBER GALLONS \_\_\_\_\_  
 MANHOLE RISER \_\_\_\_\_  
 ALARM \_\_\_\_\_  
 PUMP PERFORMANCE TEST \_\_\_\_\_

PRE-CONSTRUCTION INSPECTION: 10/30/01<sup>AM</sup> OK TO START; INSTALLER WANTS TO ADD

(2) 60' TRENCHES - OK (MR)

INSPECTION COMMENTS: 10/30/01 PM OK TO COVER MR

INSPECTOR

M. Litkin

DATE SYSTEM APPROVED

10/30/01

AND RETURNED BUILDING PERMIT SIGNED